

Place of Origin



Searching for a current
vernacular for the
St. Croix River Valley.

Interpretation Center
Stillwater, MN

Problem Statement

How do natural and cultural context inform and coexist within contemporary design?

How do natural and cultural context inform
and coexist within contemporary design?

CLAIM

Present day architecture grown out of its environment can embody and respect all the traditions, identity, and spirit of its place.

PREMISES

Universalization of production, knowledge, construction, and technology has changed the way we design and build our structures and buildings.

Great designers have an opportunity as well as an obligation to compliment and emphasize a given area while paying respect to its past.

True inspiration comes from every person with a story to tell, every trail with something to discover, and every idea that is worth trying.

Research



TOPICS

Theoretical

Regionalism

Globalization vs. Anti globalization

Vernacular Architecture

Contemporary Architecture

Tourism

Site

The Nature and Culture of the St. Croix River Valley





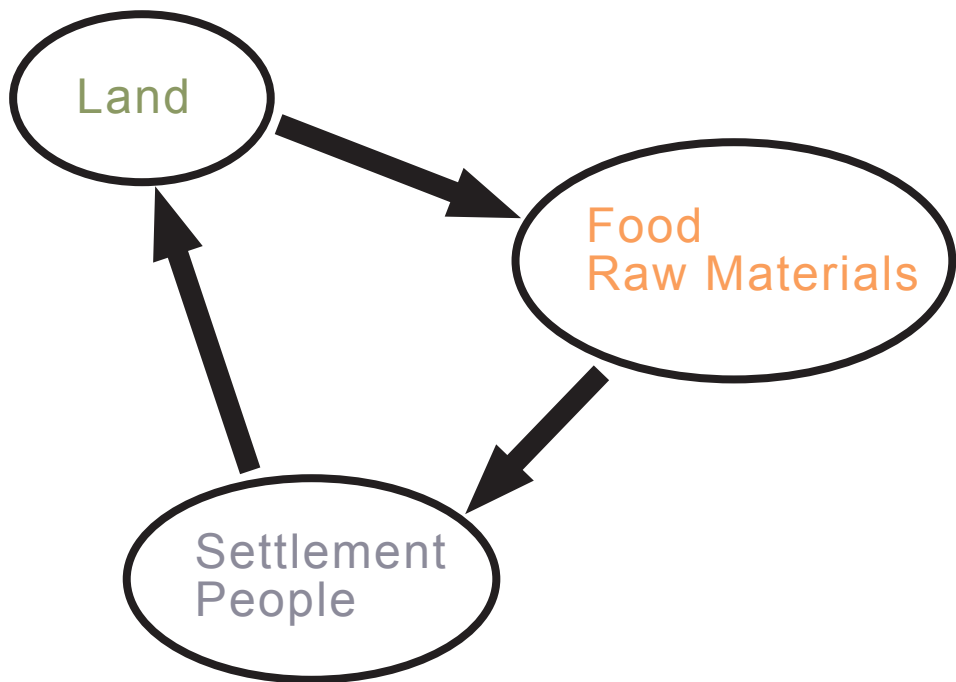

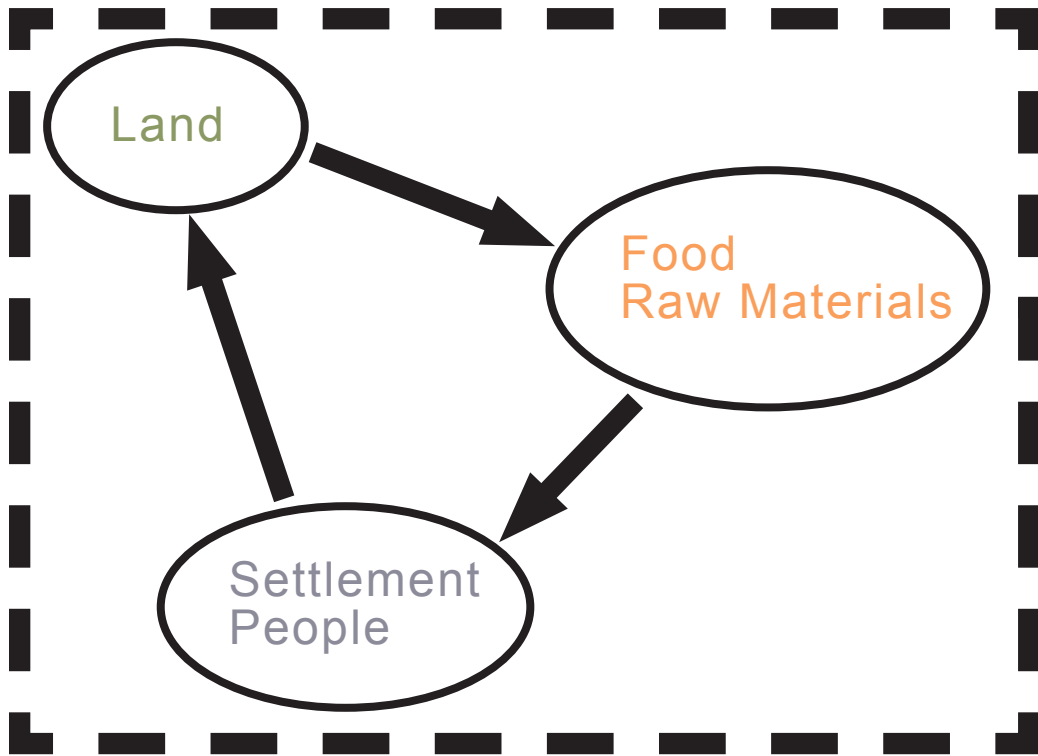

CONSTRAINT:

Existed through necessity and was limited by distance, technology, and tradition

PLACE

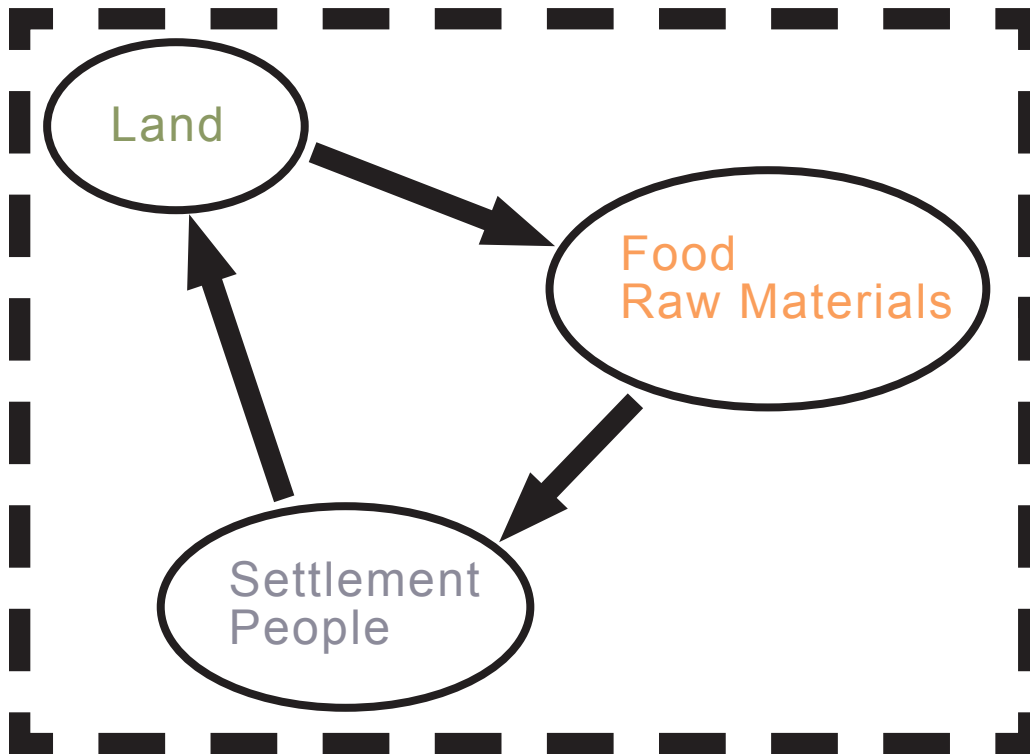

CONSTRAINT:

Existed through necessity and was limited by distance, technology, and tradition

RESULTS:

Distinctive regionalism/vernacular whose inherent natural character was shaped into a cultural landscape by human activity over generations.

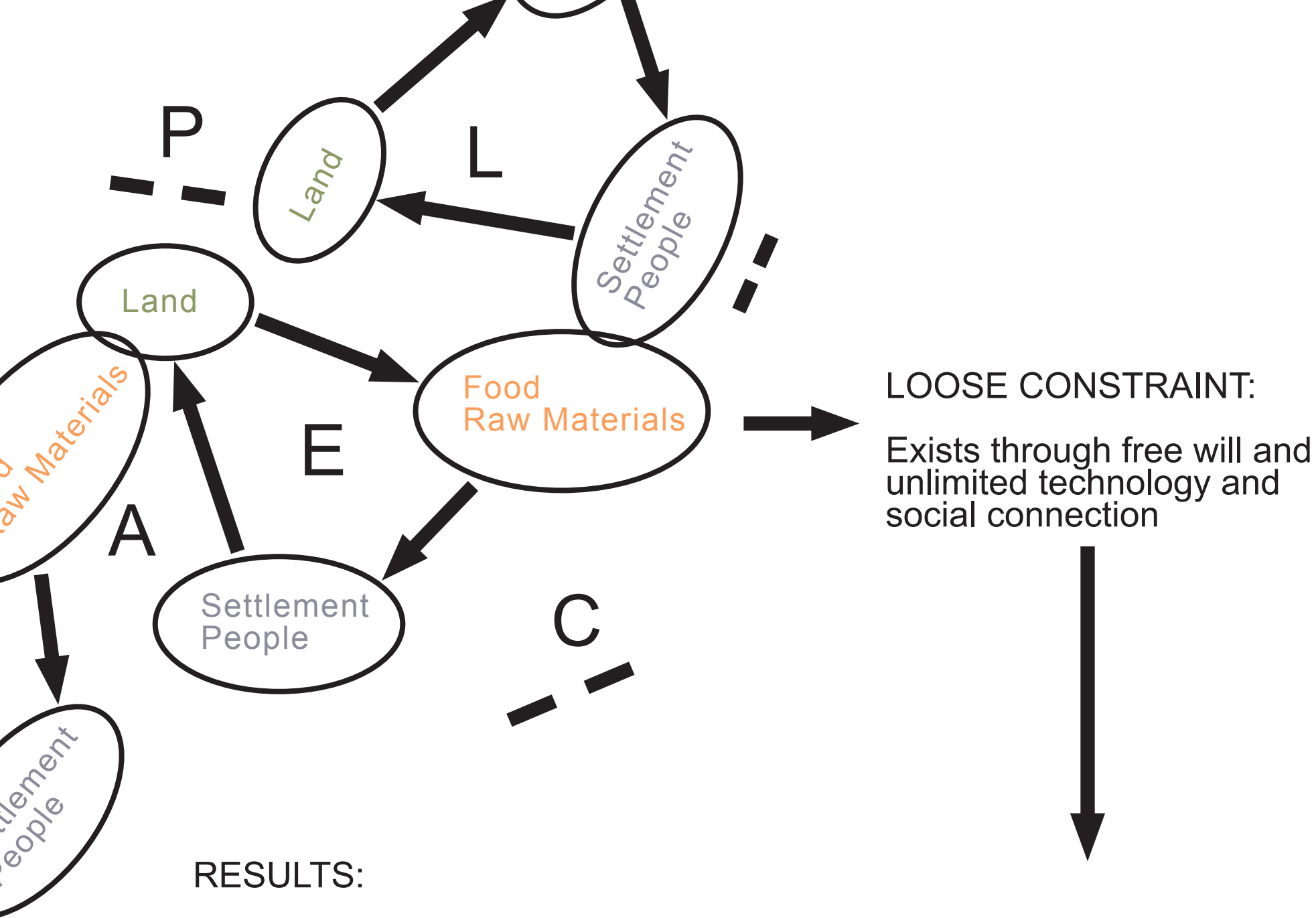

RESULTS:

Markers, reference points, and boundaries become blurred. Subtle natural and cultural destruction due to contaminations and contradictions.



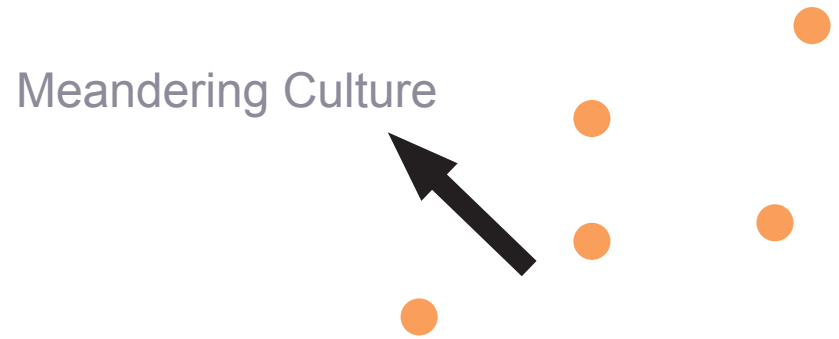
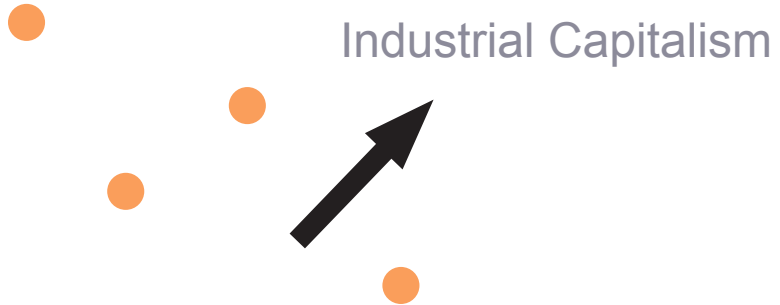

HIGH RISE
FREEWAY

Industrial Capitalism

Meandering Culture



PLACELESS MEGAPOLIS

HIGH RISE
FREEWAY

Industrial Capitalism

Meandering Culture

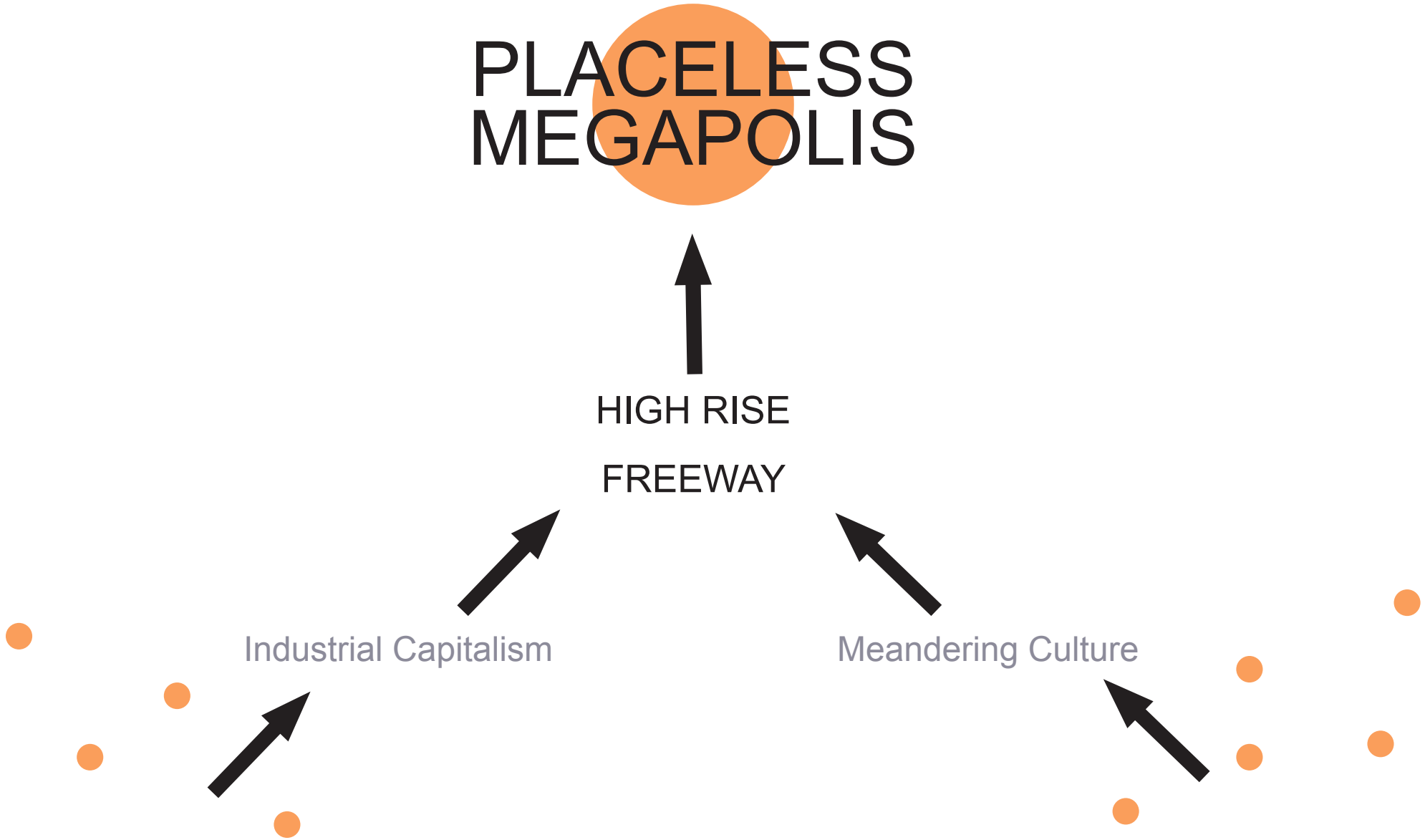

NEW WORLD ORDER ?

“Architecture can only be sustained today as a critical practice if it assumes a position which distances itself equally from the enlightenment myth of progress and from a reactionary, unrealistic impulse to return to the architectonic forms of the pre-industrial past.

It has to remove itself from both the optimization of advanced technology and the ever present tendency to regress into nostalgic historicism or the glibly decorative, only this has the capacity to cultivate a resistant identity-giving culture while at the same time having discreet recourse to universal technique” (Frampton, 1983).

MAIN POINTS

A cultural group has stability as people feel invested in the land because survival and well being depend on it.

Modern buildings are now conditioned uniformly by optimized technology which limits our ability as designers to create significant form.

Utopian ideals work directly against natural and cultural diversity.

Building and places are popping up all over the world with a dishonest representation of authenticity, identity and meaning defiant of surrounding context.

Architecture acts as identity confirming symbols to tourists and travelers.

Frampton's approach suggests finding ways to complement our normal scenic experience by retracing our tactile range of perceptions.



Site

ST. CROIX RIVER VALLEY

252 mile stretch

Glacial melt

Healthy waters and riparian zones

94 species of fish

40 mussel species



Confluence of coniferous forests, deciduous forests, and prairie

Ojibwa and Dakota tribes

Burial mounds

French Fur Trade

Scandinavian immigrants

Protected riverway under NPS

Invasive species

(2009) lower section landed #10 spot on Americas most endangered river's list



LOGGING



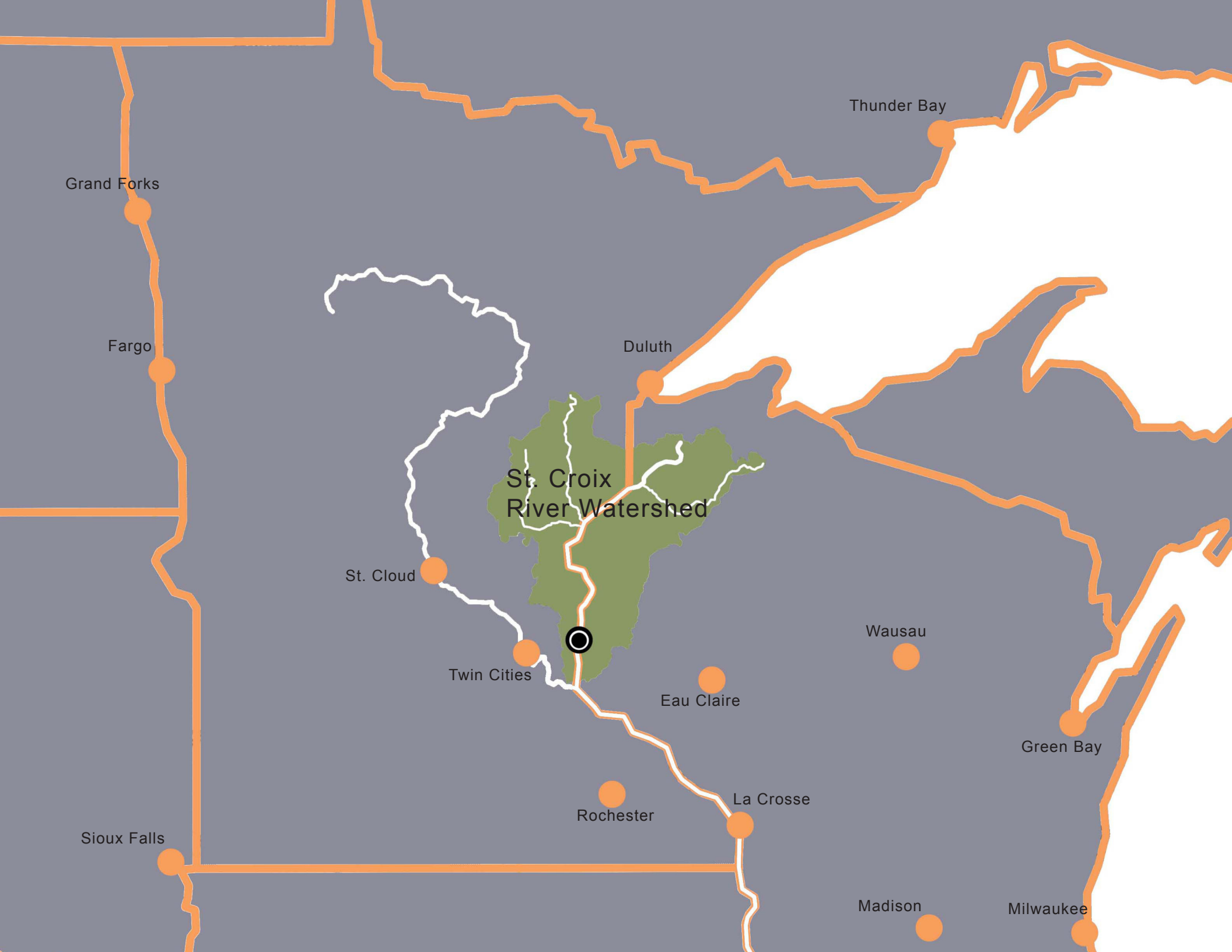

St. Croix
River Watershed

Grand Forks

Fargo

St. Cloud

Twin Cities

Rochester

Eau Claire

La Crosse

Wausau

Green Bay

Madison

Milwaukee

Duluth

Thunder Bay

Sioux Falls

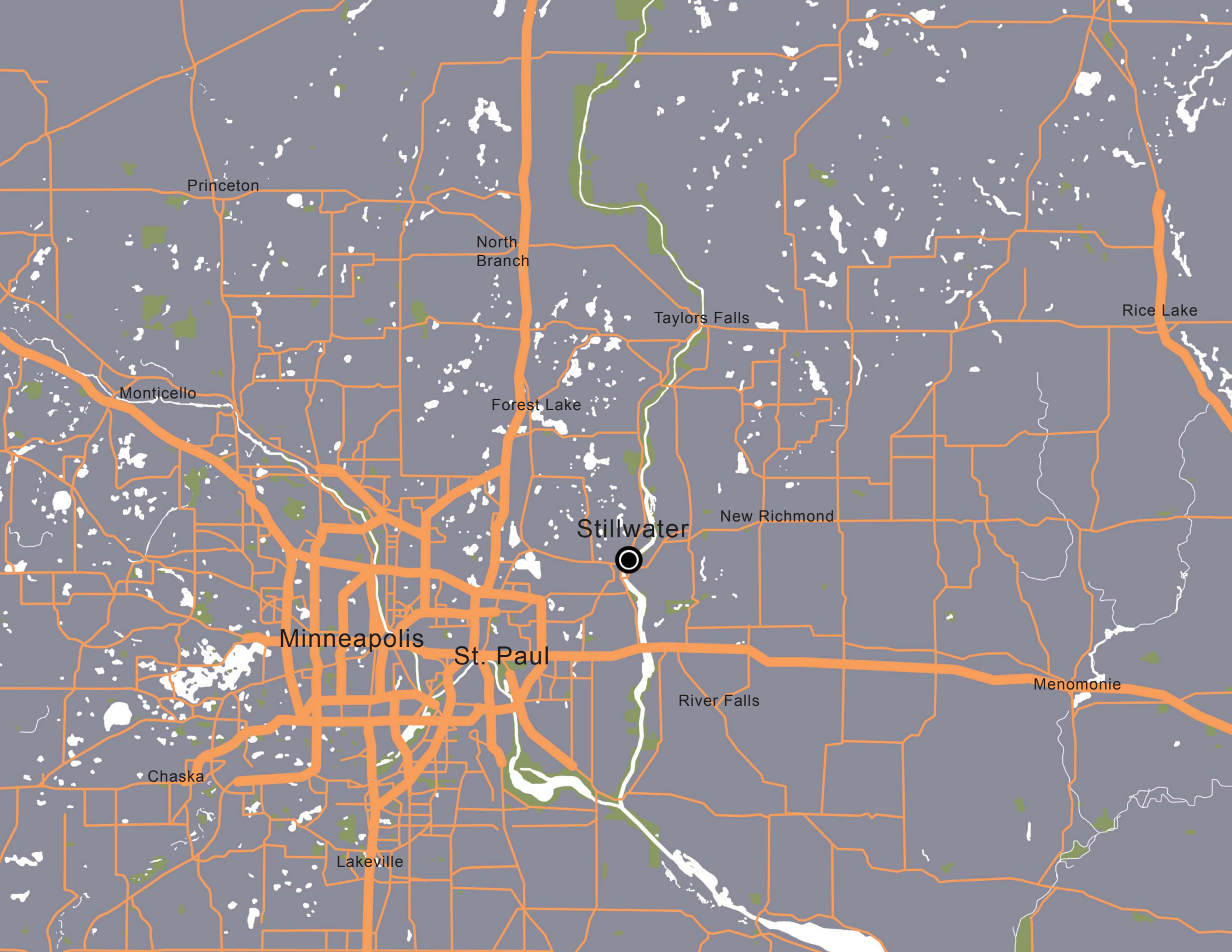

Princeton

North Branch

Taylors Falls

Rice Lake

Monticello

Forest Lake

Stillwater

New Richmond

Minneapolis

St. Paul

River Falls

Menomonie

Chaska

Lakeville



DAY 1





DAY 2





DAY 3



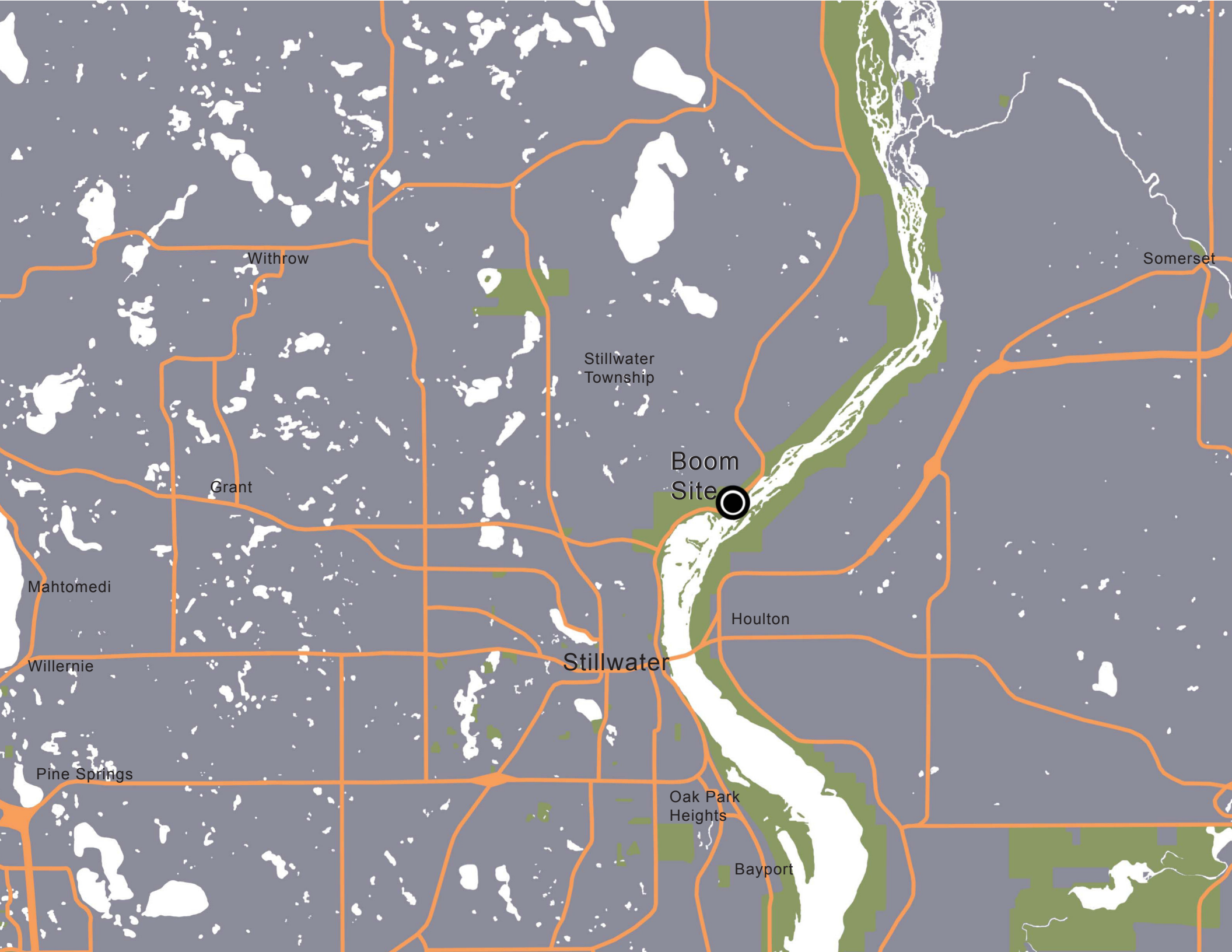

Withrow

Somerset

Stillwater
Township

Boom
Site

Grant

Mahtomedi

Houlton

Willernie

Stillwater

Pine Springs

Oak Park
Heights

Bayport



Stillwater
Township

Boom
Site

St. Croix Islands
State Recreation
Area

Houlton

95

95

95

95

96

95

Stillwater



ST. CROIX BOOM SITE

CENTER OF LOG AND LUMBERING ACTIVITIES IN THIS REGION FOR OVER HALF A CENTURY PRIOR TO 1914.

HERE MILLIONS OF LOGS FROM THE UPPER ST. CROIX AND TRIBUTARIES WERE HALTED, SORTED, AND RAFTED, LATER TO BE SAWED INTO LUMBER AND TIMBER PRODUCTS. MORE LOGS WERE HANDLED HERE THAN AT ANY SIMILAR PLACE IN THIS SECTION.



2011 REPLICA OF ORIGINAL PLAQUE



LOG BOOM

















Design Concept



How do natural and cultural context inform and coexist within contemporary design?

Seasonality

Levels of perception

Logging

Abundance of
Water

A hand-drawn conceptual diagram on a light-colored background. At the top, there is a simple sketch of a structure with a peaked roof. Below this, several horizontal layers are drawn with colored pencils. From top to bottom, these layers are: a thin orange layer, a green layer, a thick orange layer, a thin green layer, a thin orange layer, and a thin green layer. A vertical line, representing a trunk or stem, passes through the center of these layers. To the left of this vertical line, there are several horizontal black lines of varying lengths, suggesting branches or logs. The word "Logging" is written in black text to the right of these black lines. Below the colored layers, there is a wide, textured blue area representing water. The words "Abundance of Water" are written in black text in the center of this blue area. To the right of the main vertical line, the words "Levels of perception" are written in green text, spanning across the green and orange layers. The word "Seasonality" is written in orange text on the left side, overlapping the orange and green layers.

Seasonality

Levels of perception

Logging

Abundance of
Water

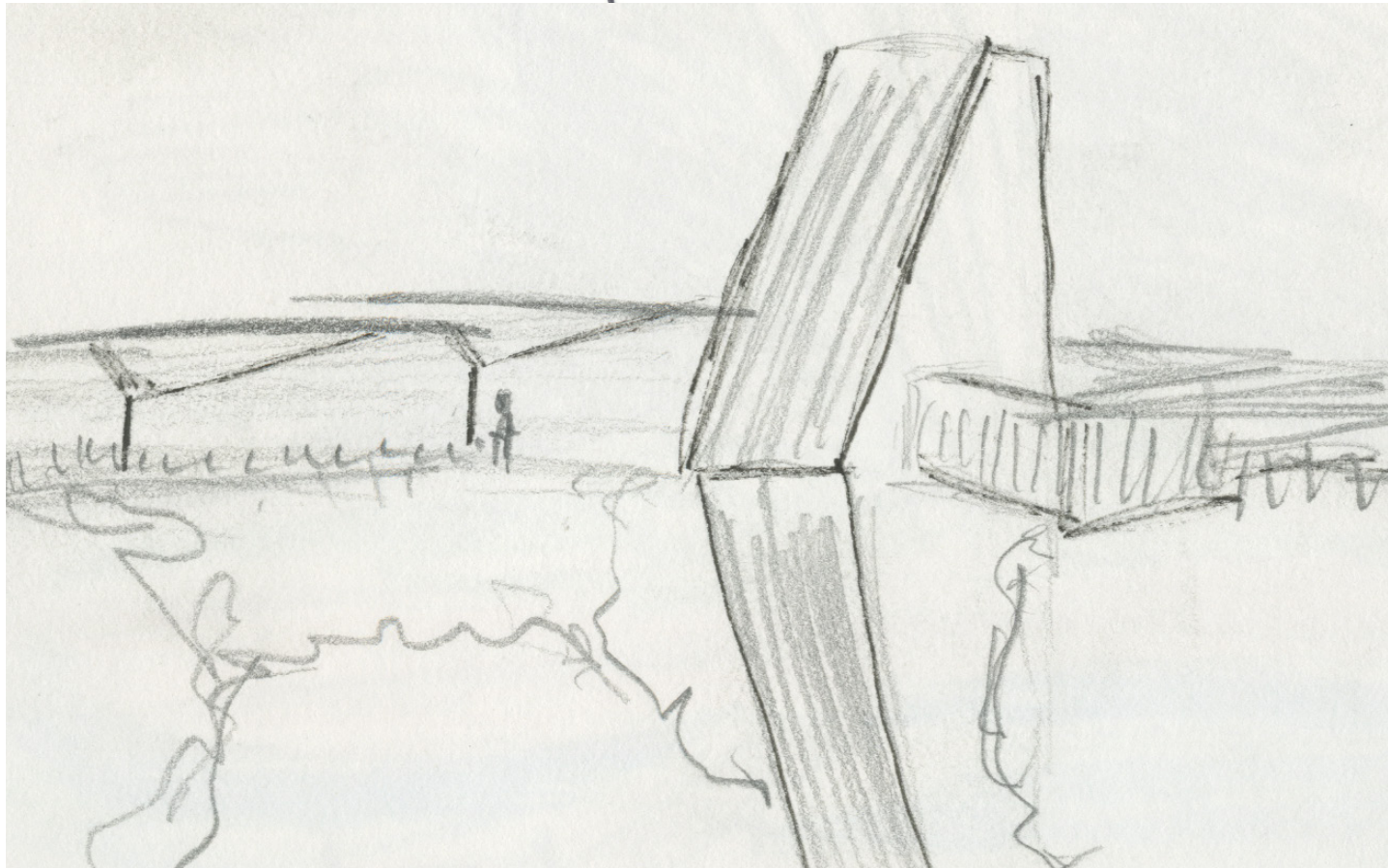
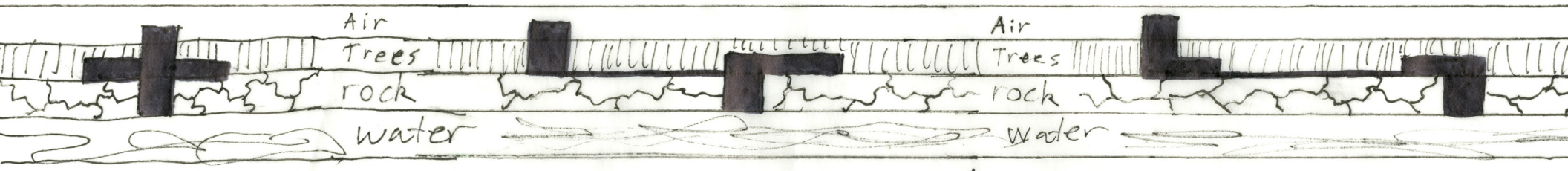
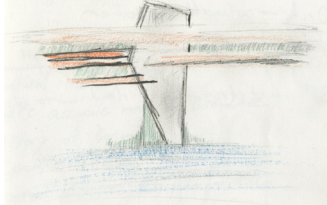

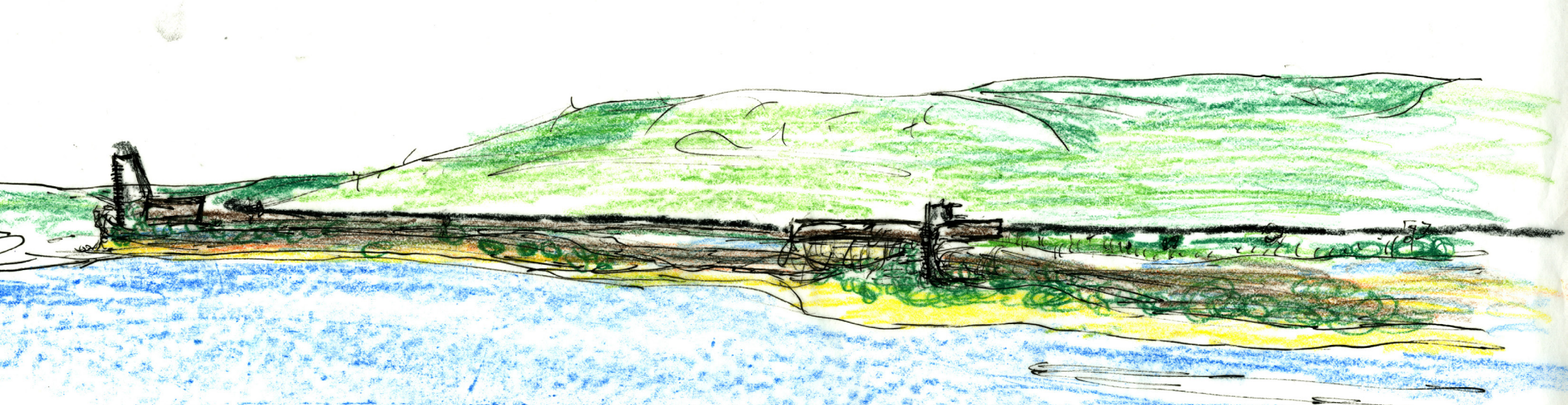
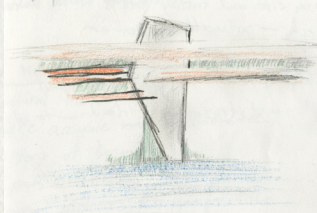
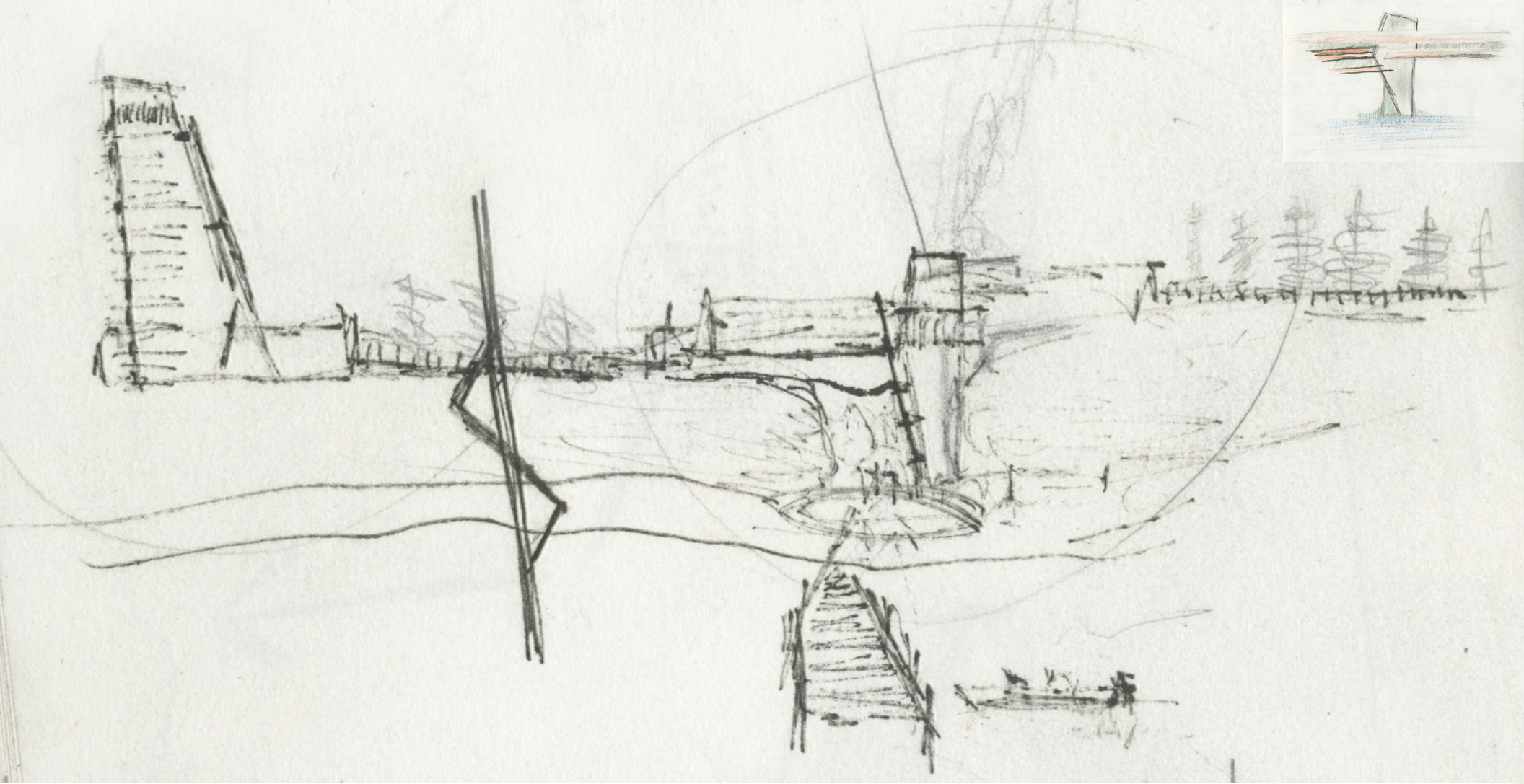

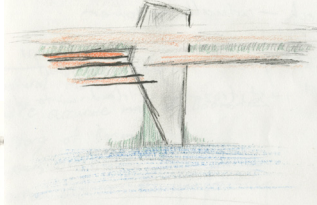

Auditorium

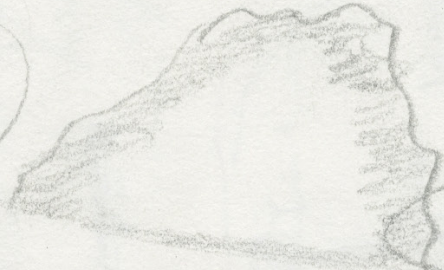

multi display

admirer

Deck

Entry parking

Scenography

Observation

Lobby

class



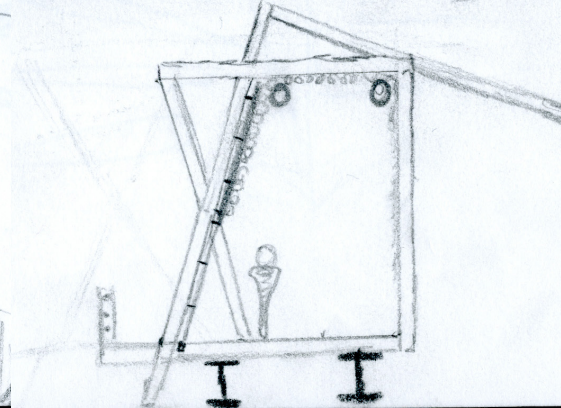
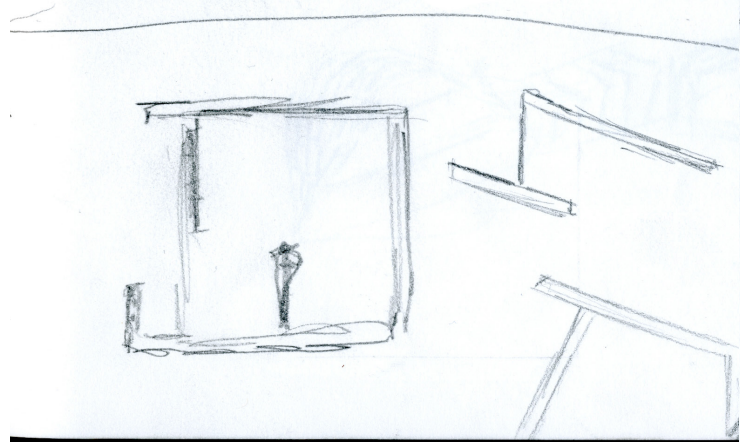
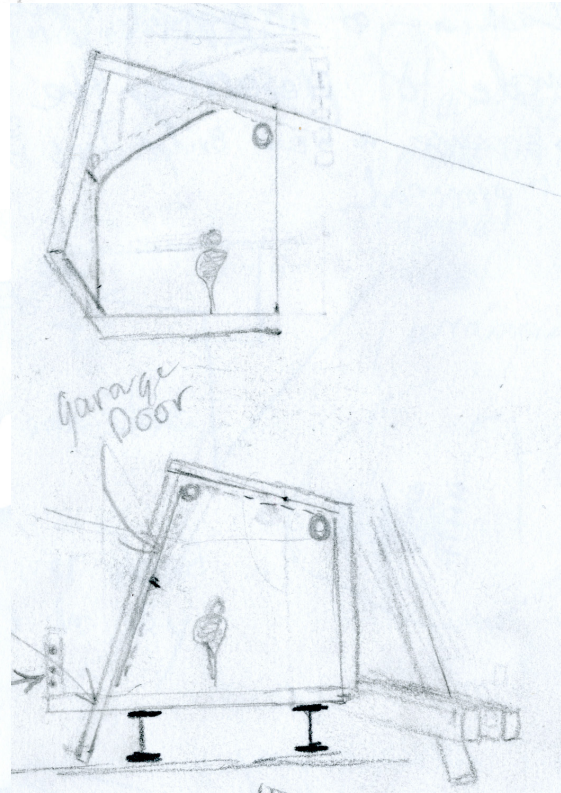
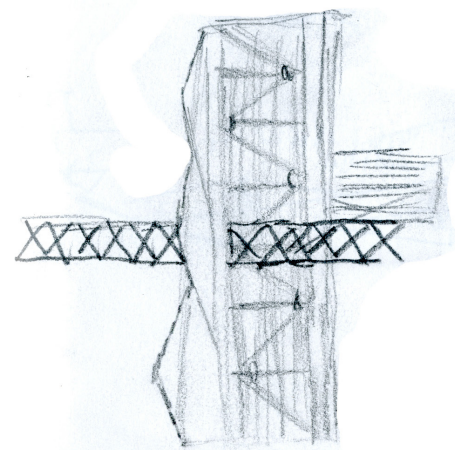
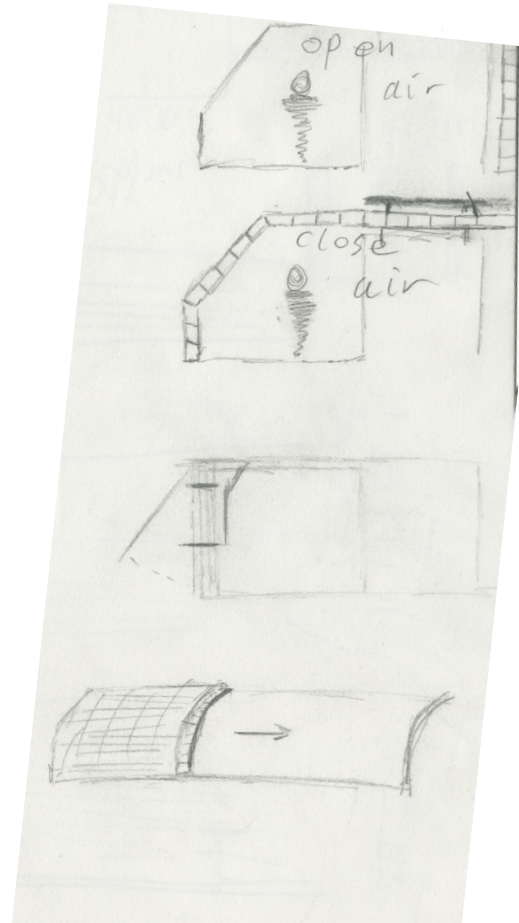
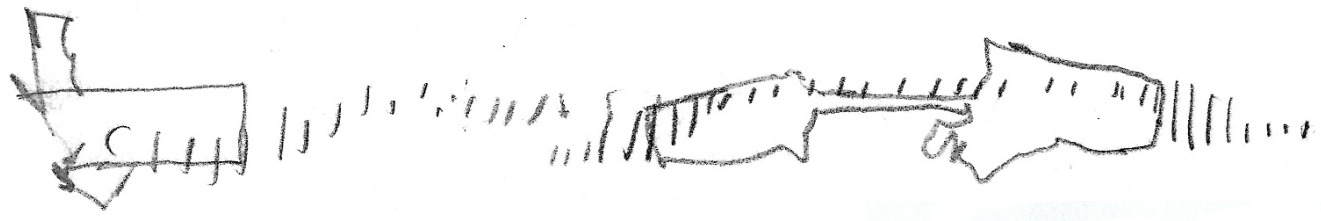
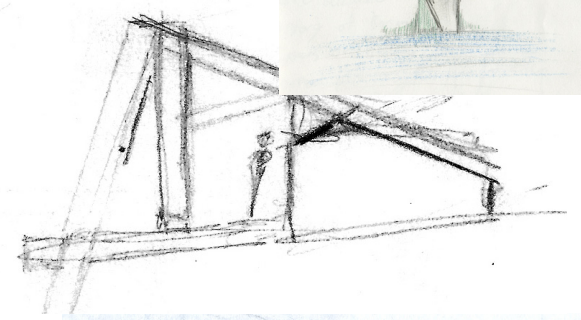
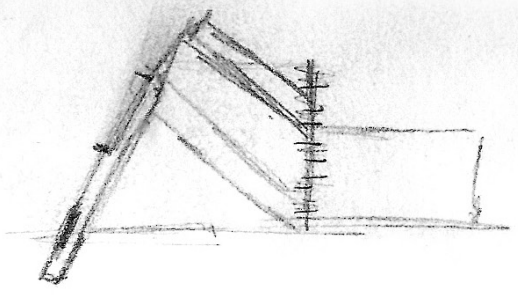
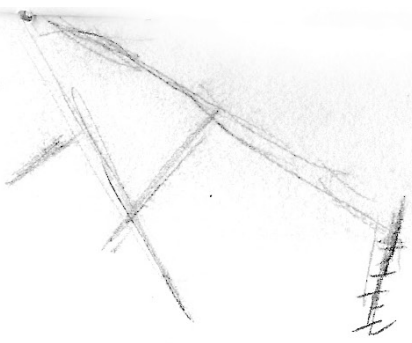
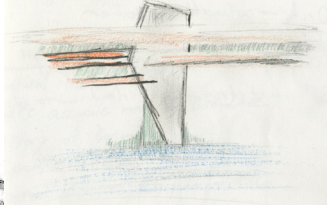

Interpretive
Panel

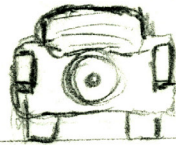
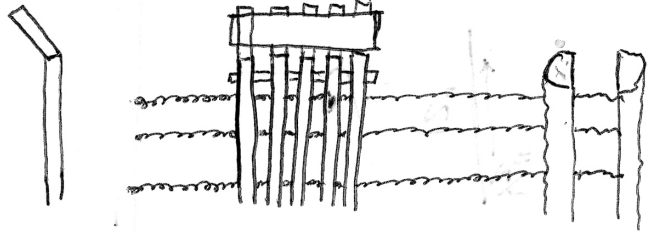

Recycled
Stone from site

Deciduous
Trees

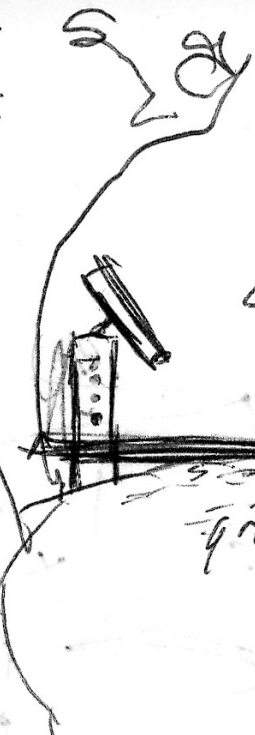

white pine

prairie grass

steel Barricade



Local
stone
masonry

gravel

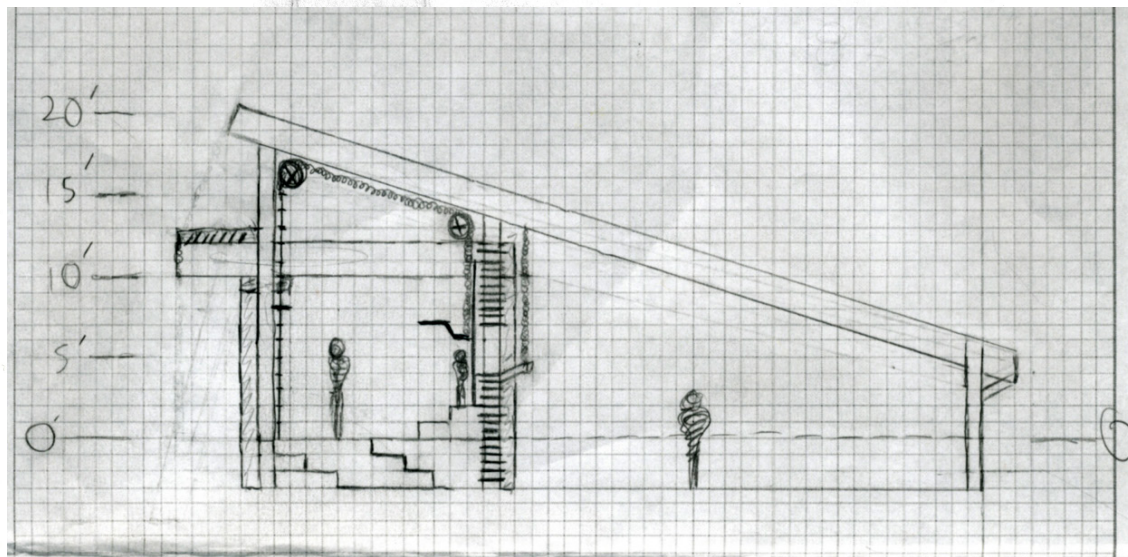
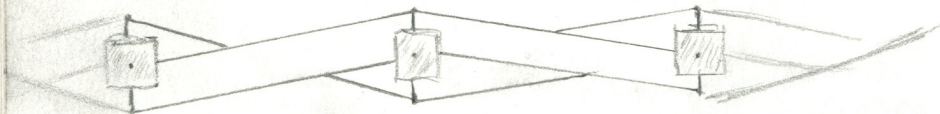
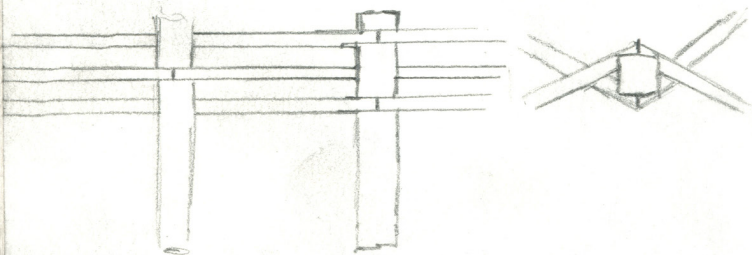
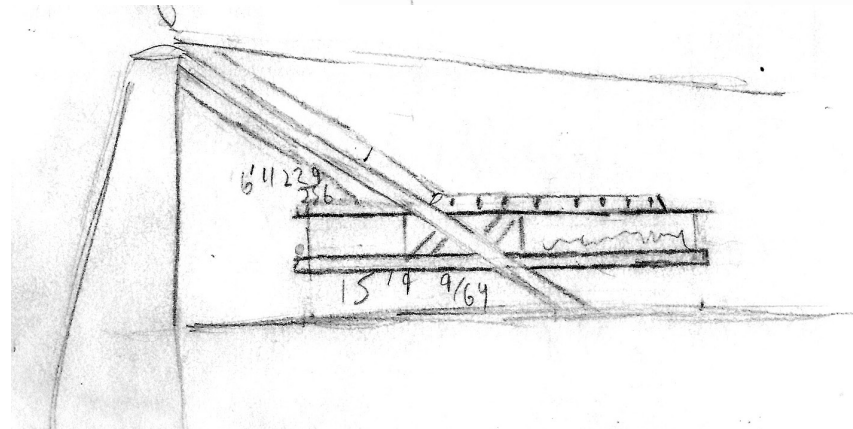
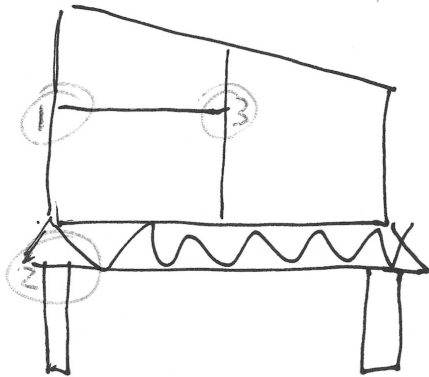
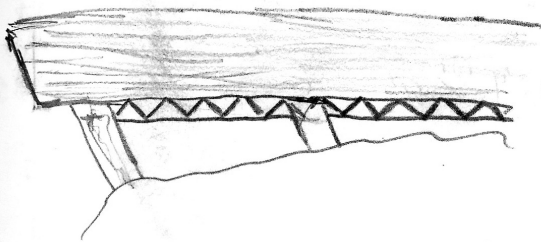
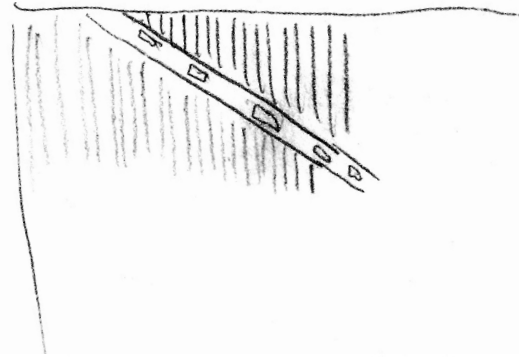
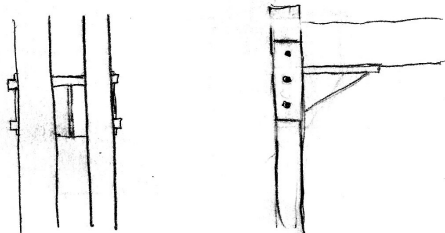
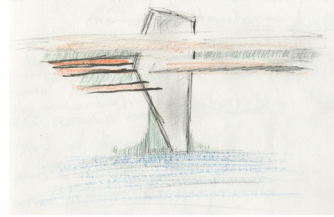
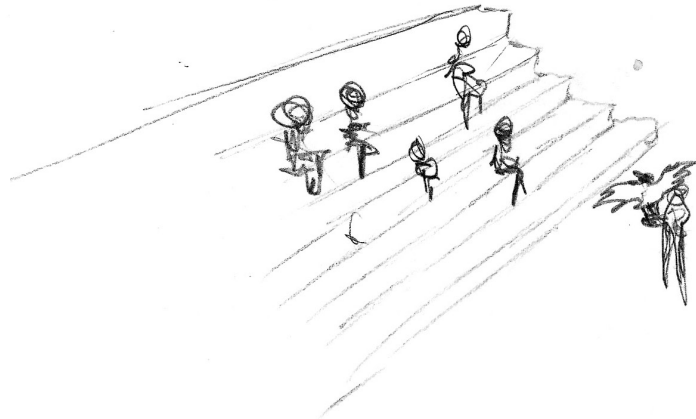
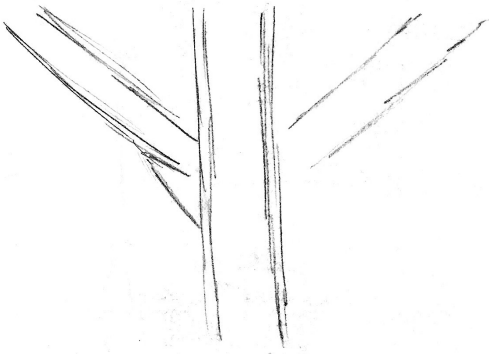

MIDTERM REVIEW

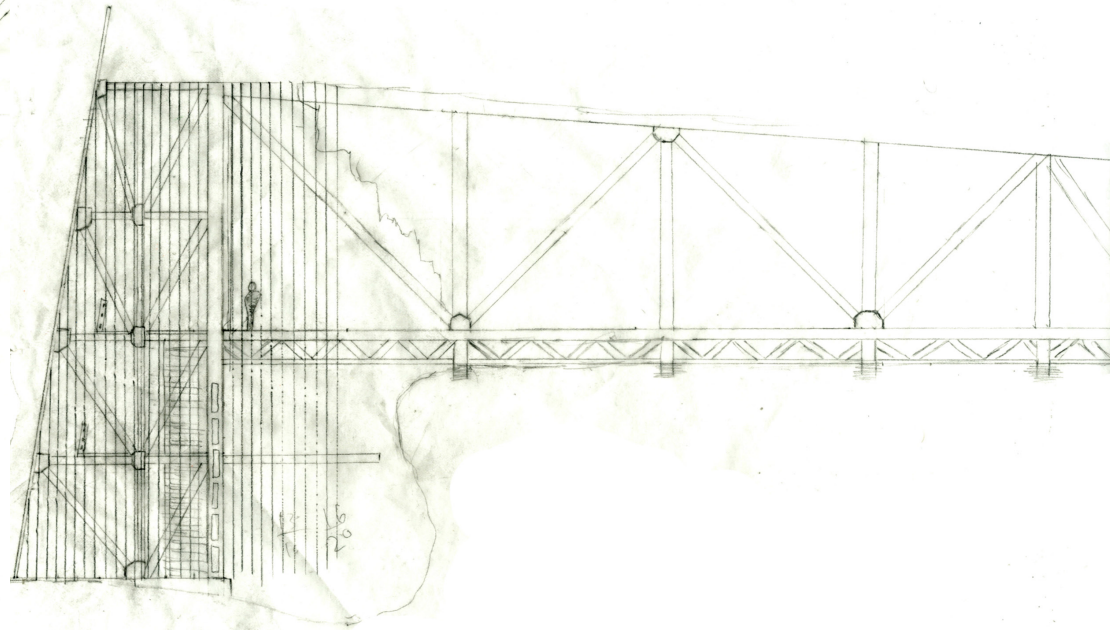
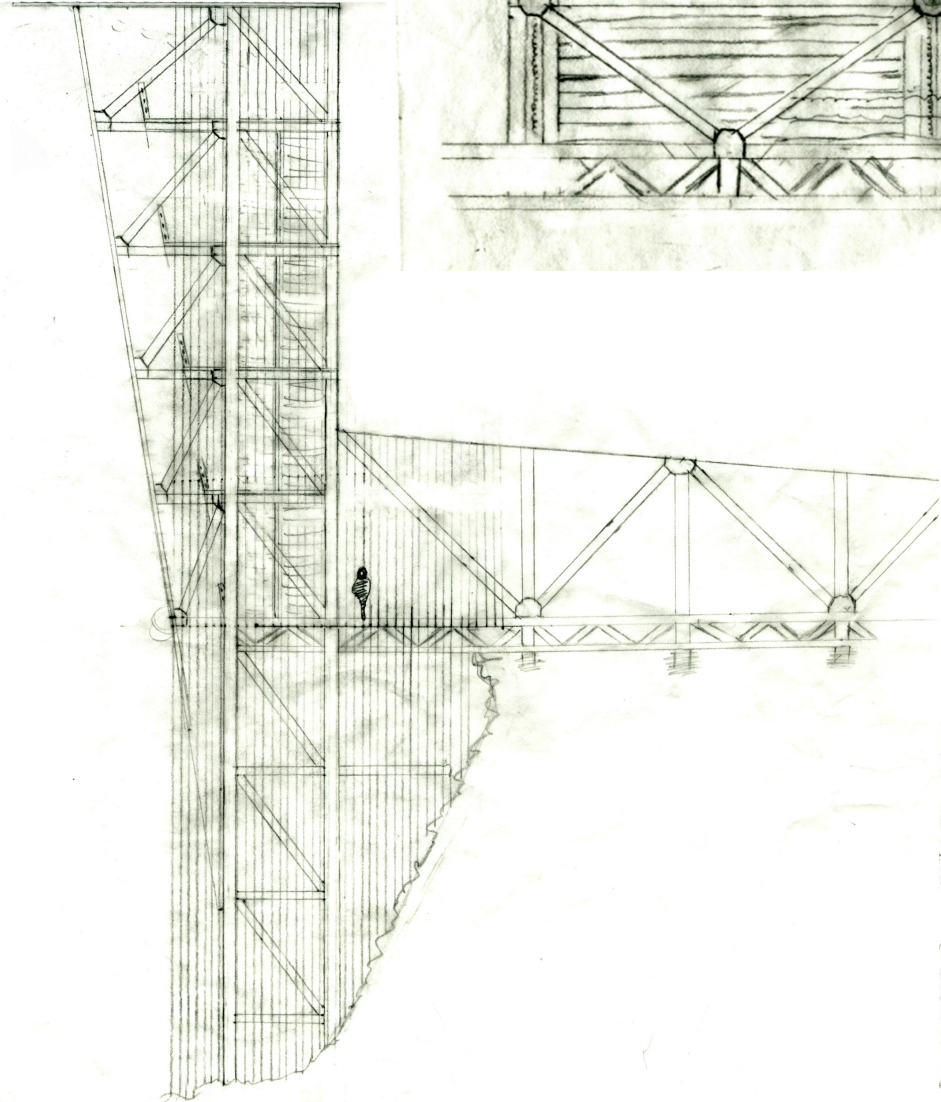
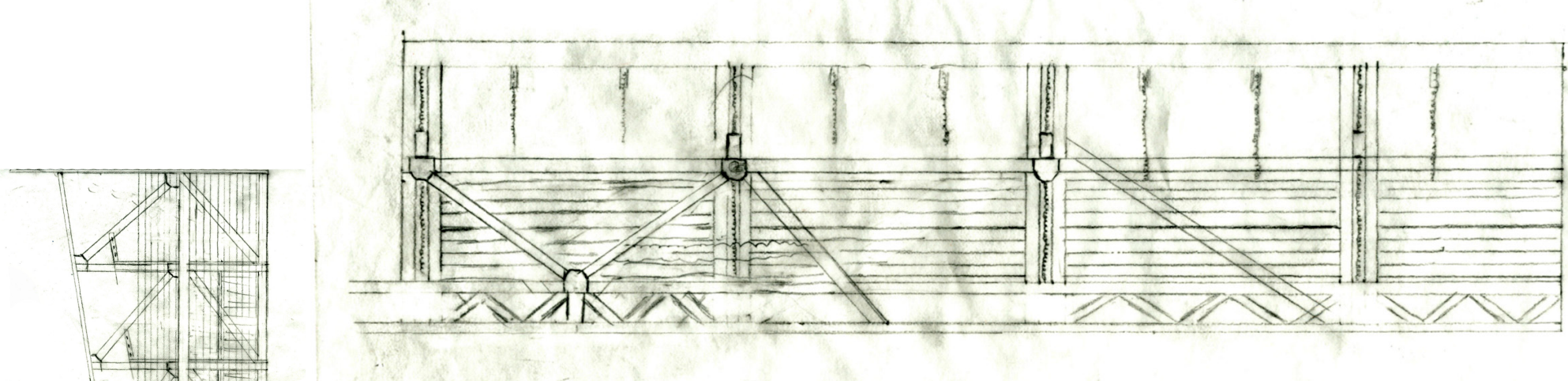

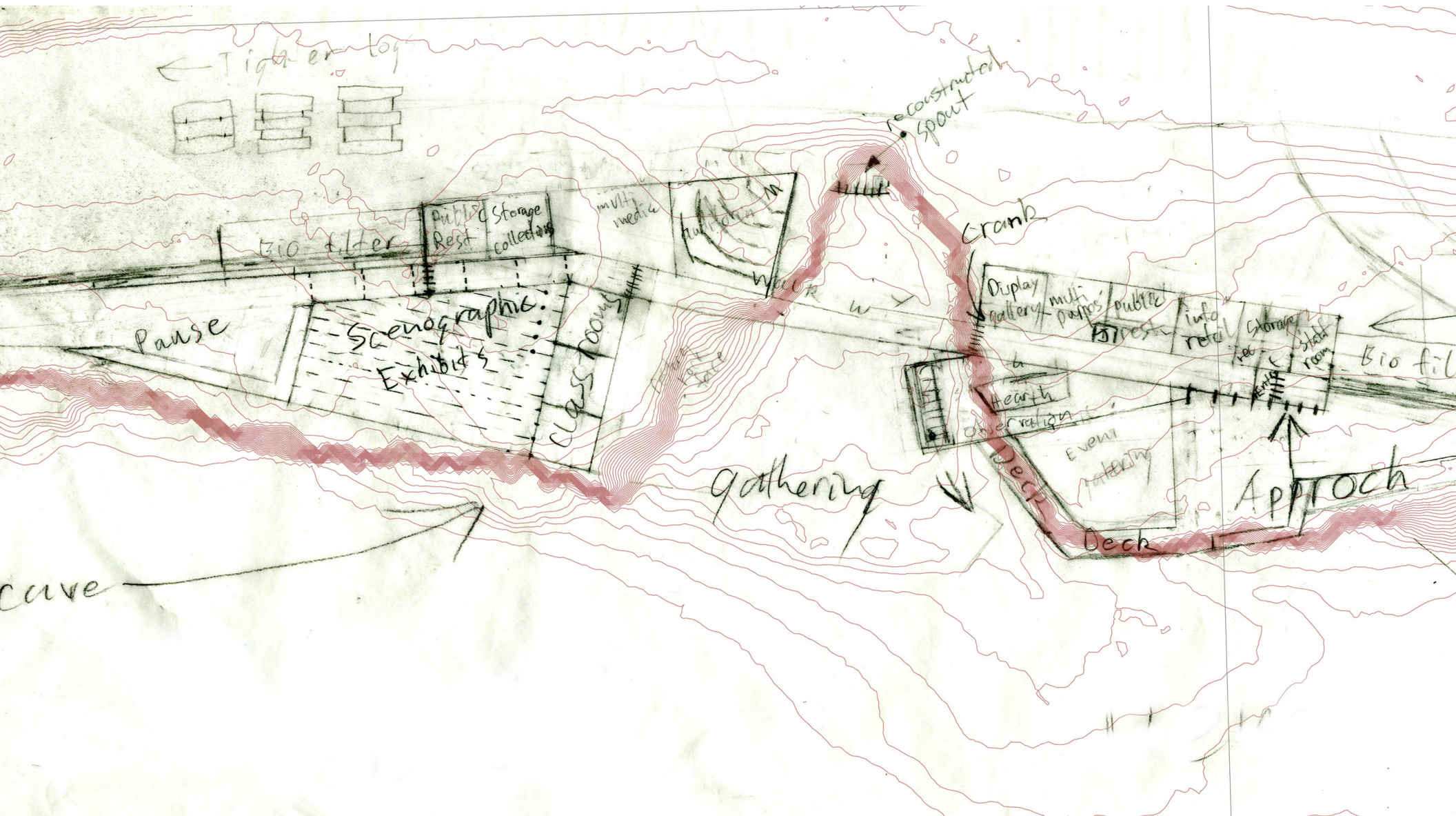

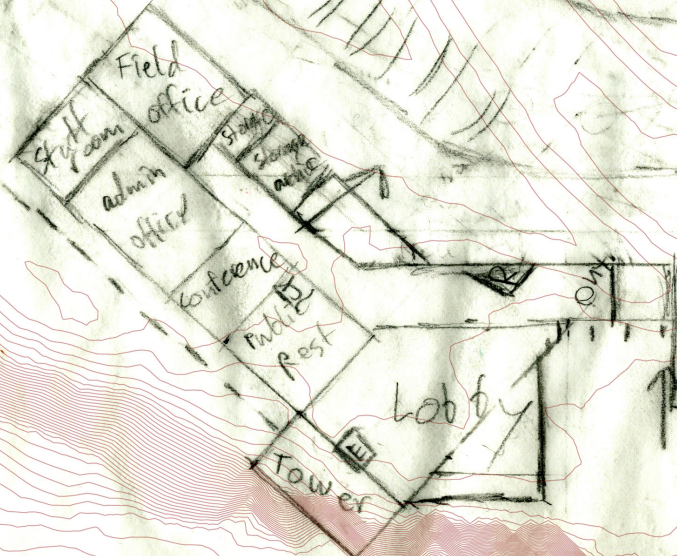

approach

Lobby

Tower

Field office

admin office

conference

rest

staff room

Storage

office

ON

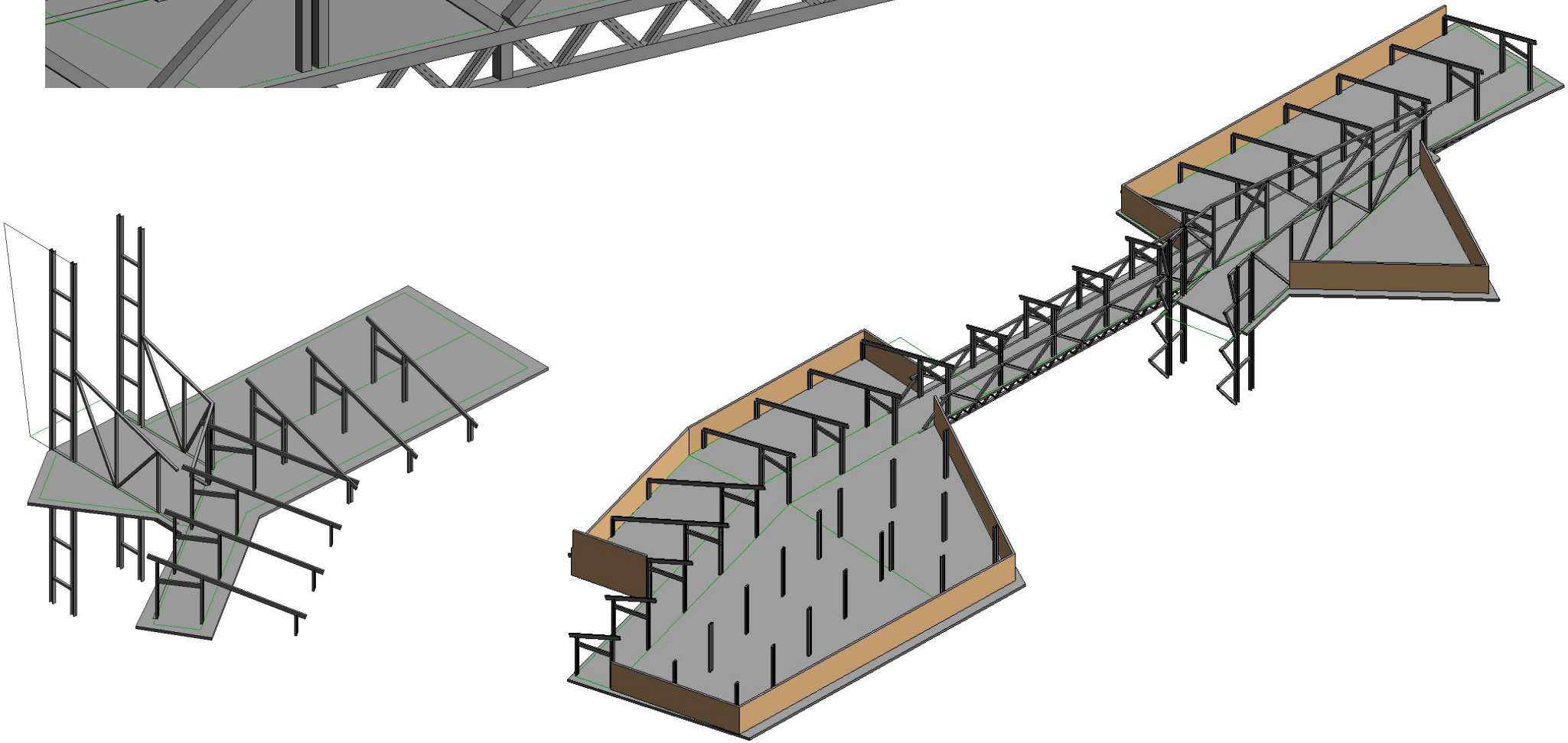
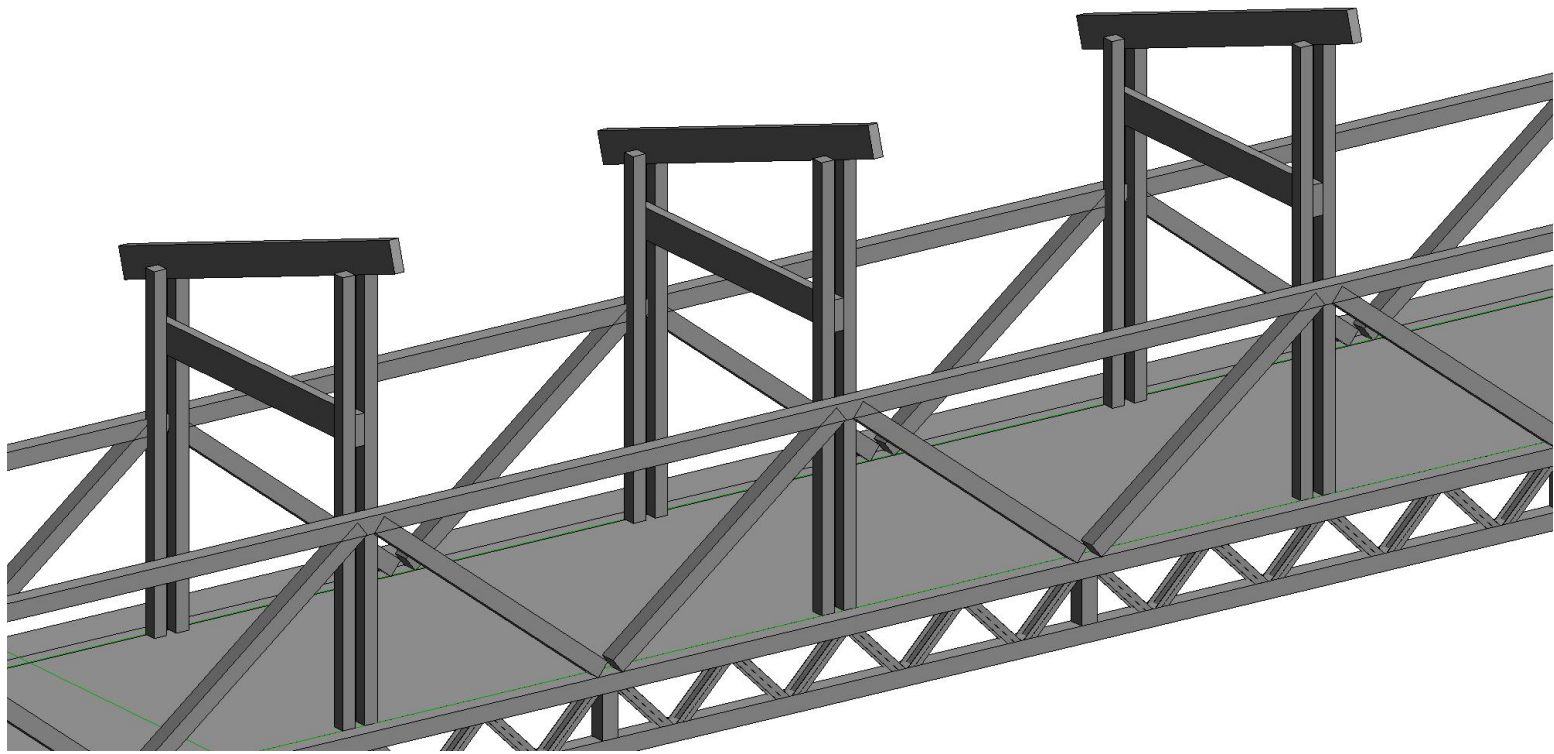

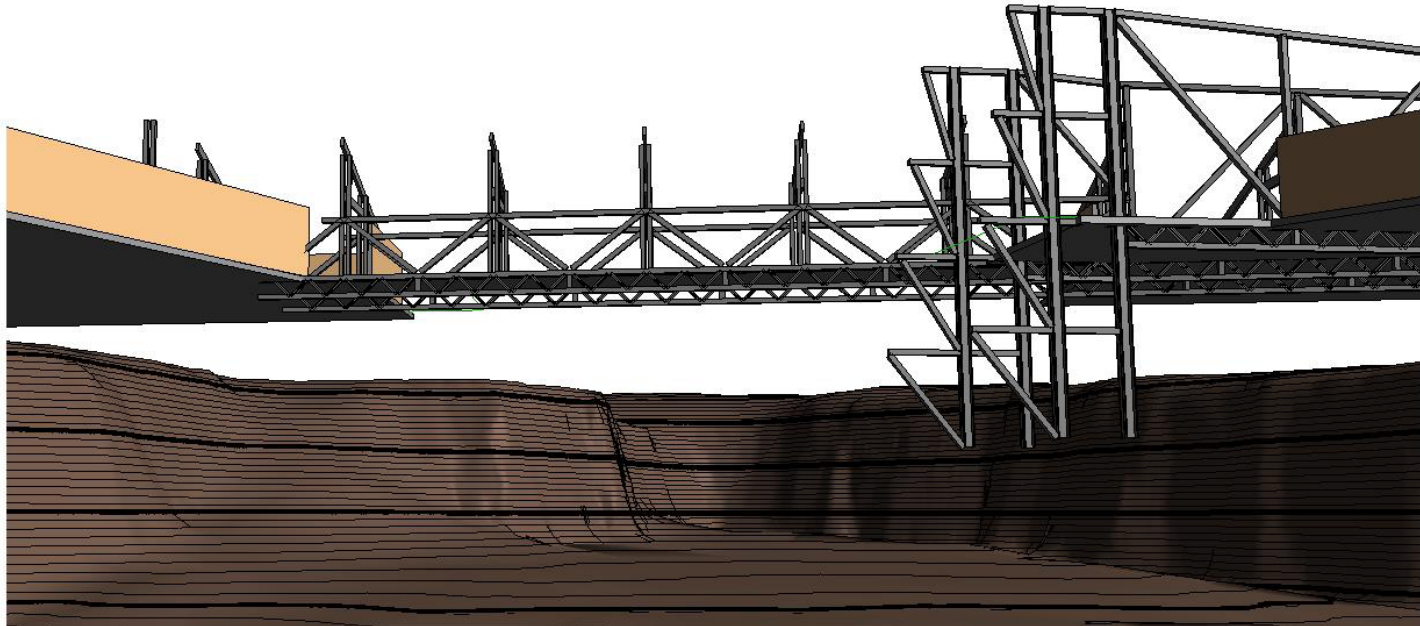

Final Design



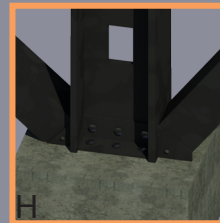
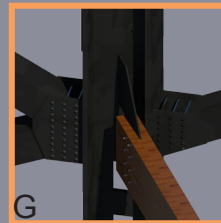
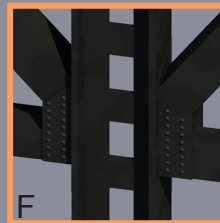
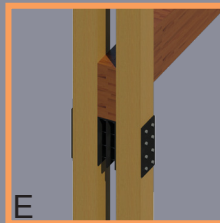
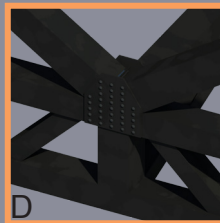
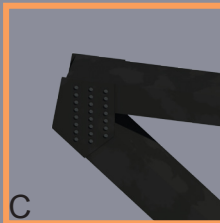
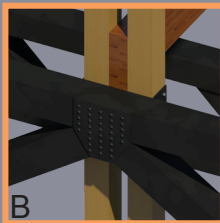
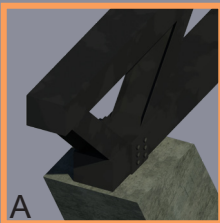
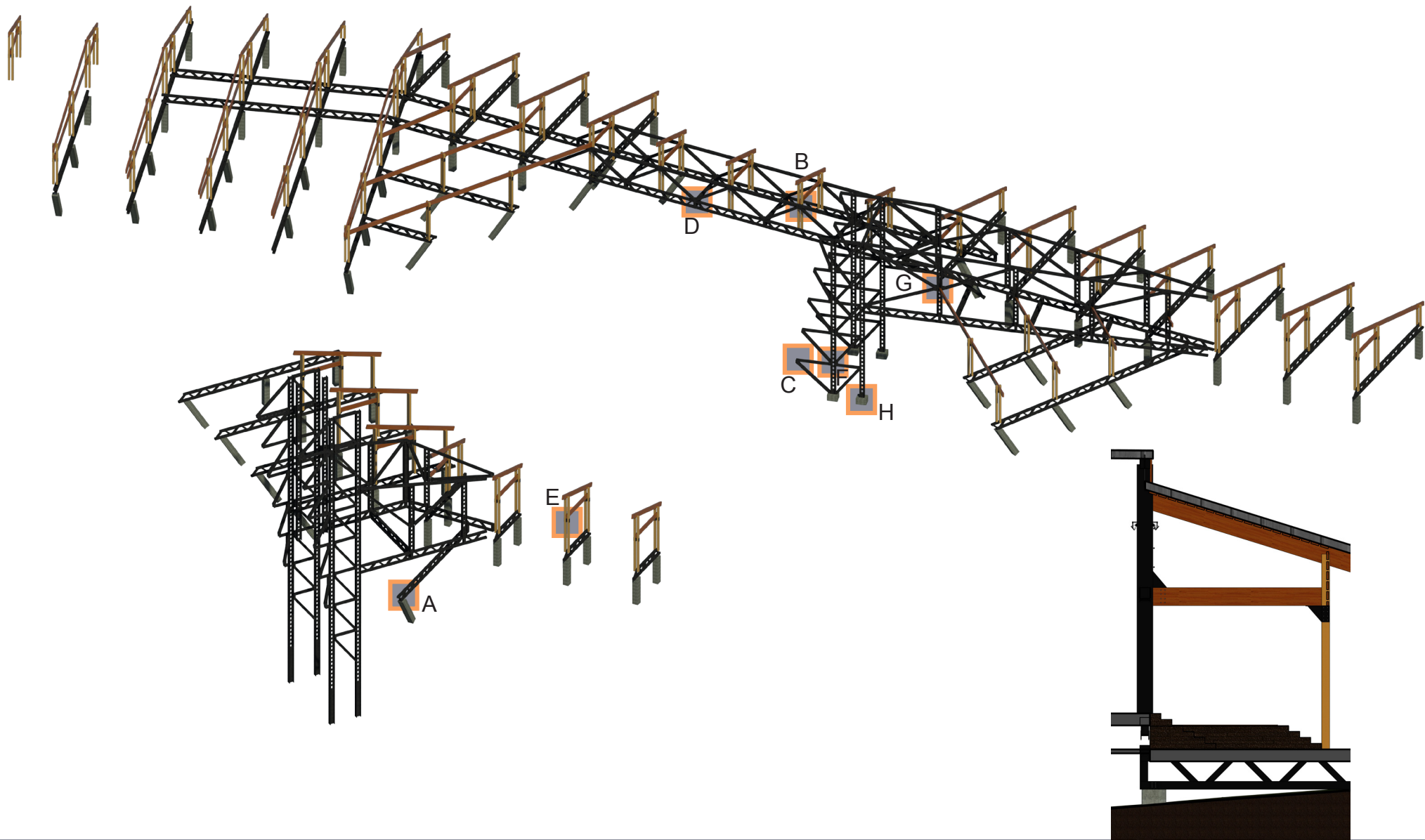

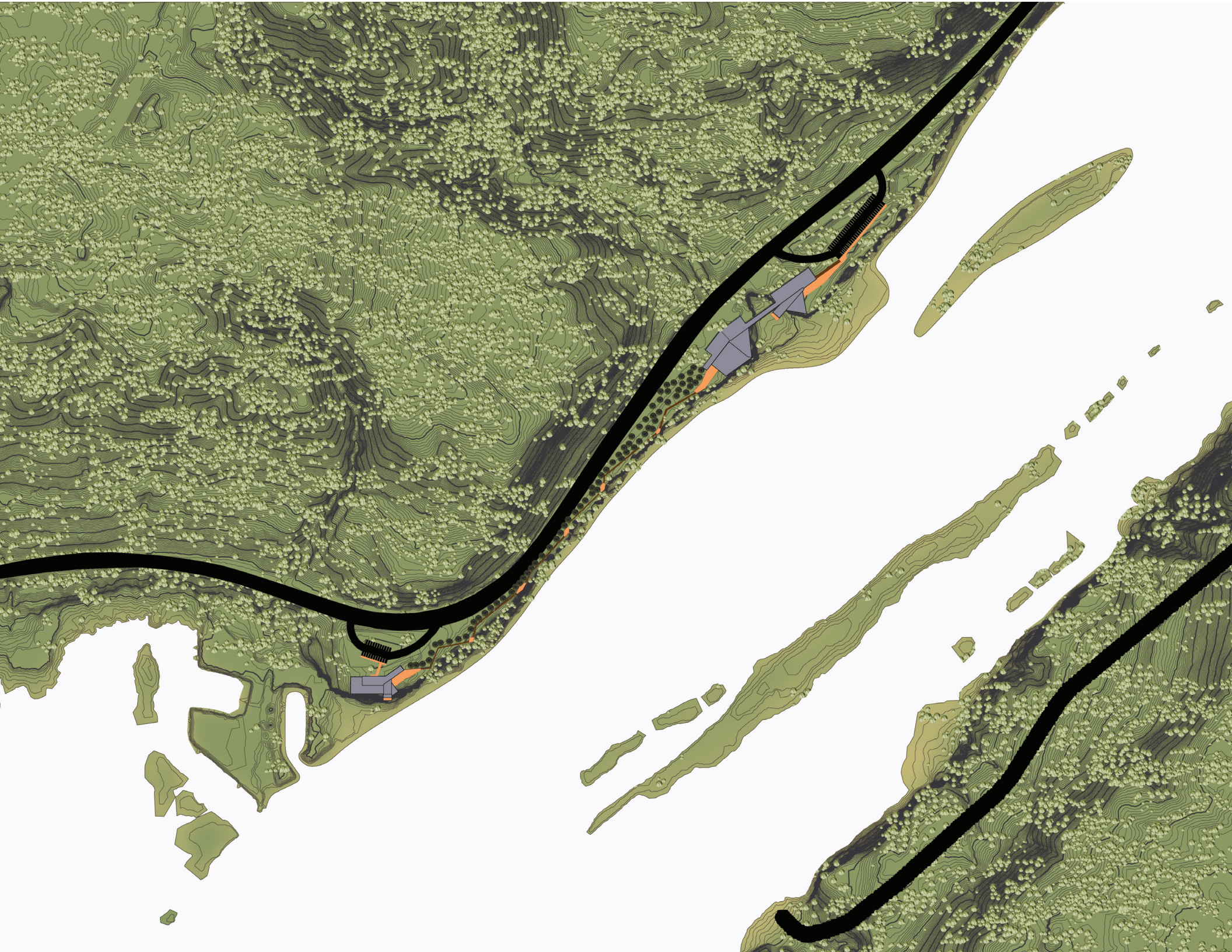

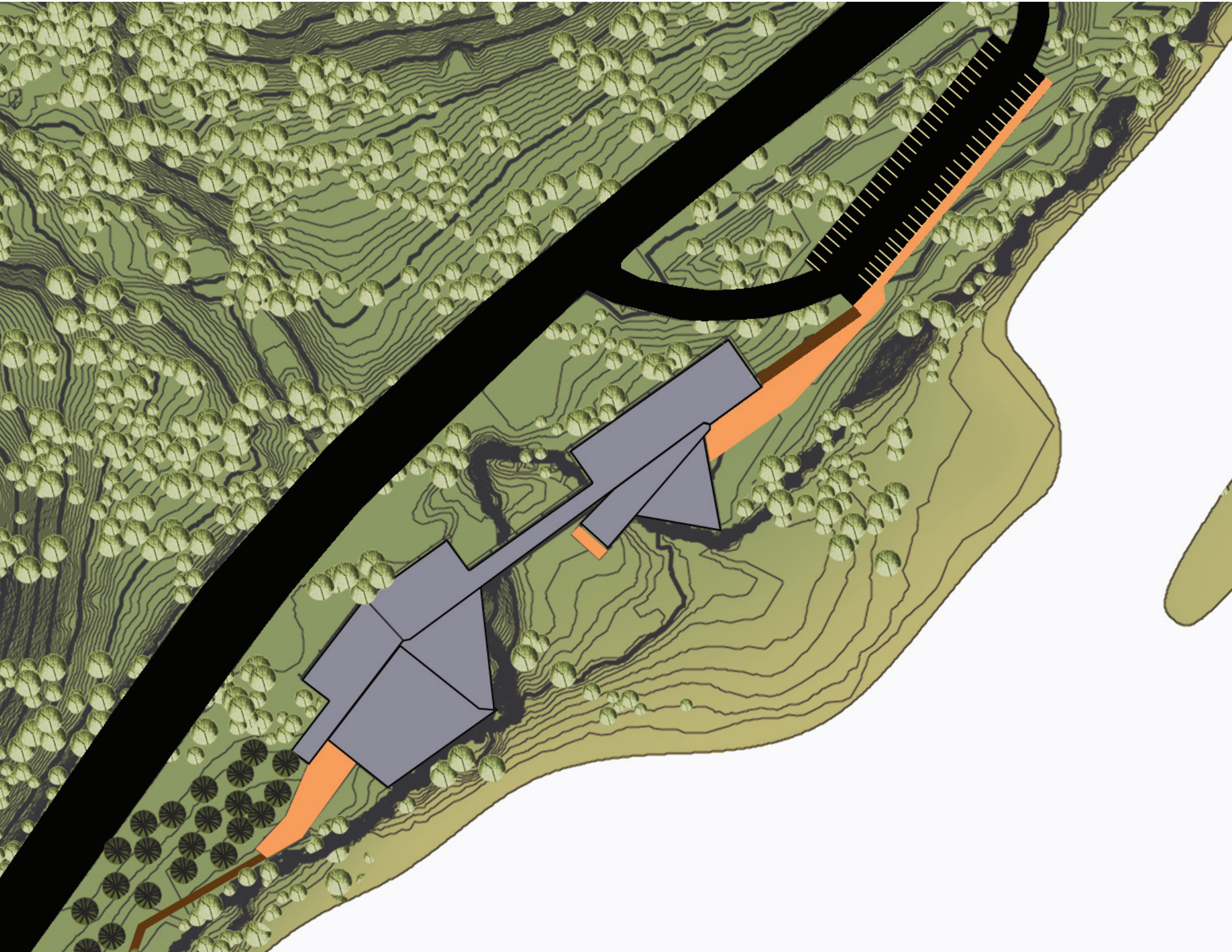



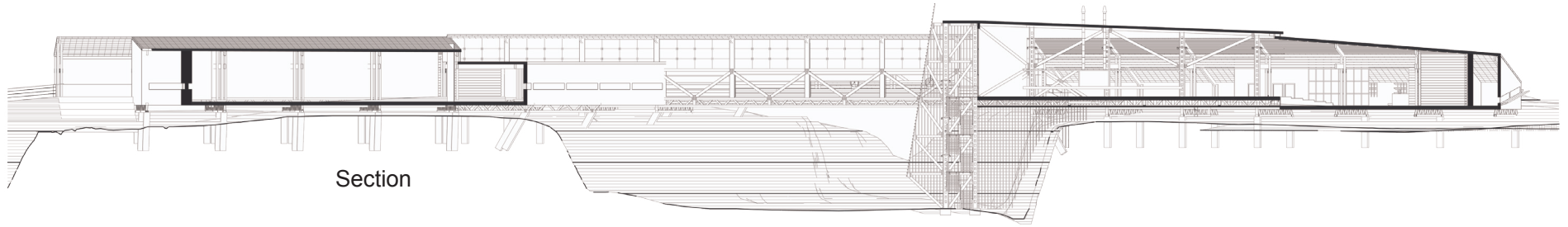

Section

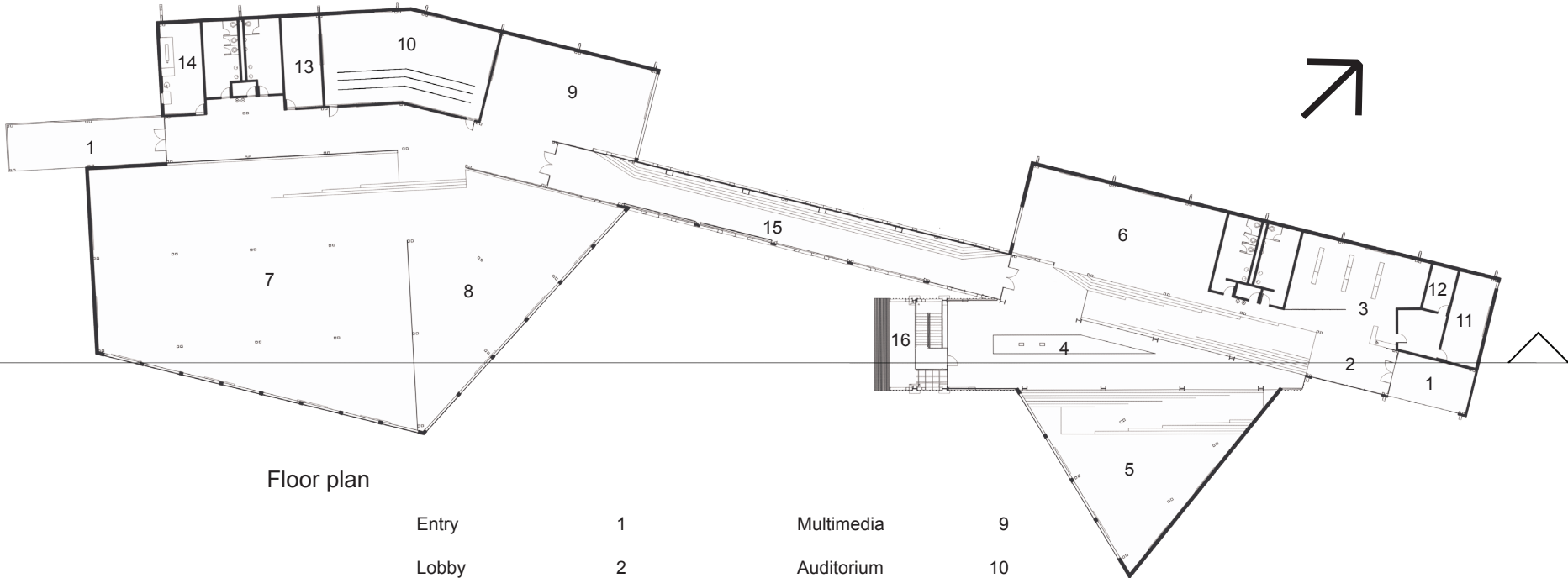

Floor plan

Entry	1	Multimedia	9
Lobby	2	Auditorium	10
Info/Retail	3	Break Room	11
Hearth Room	4	Storage	12
Gathering/Event	5	Storage(collections)	13
Gallery	6	Mechanical	14
Scenographic Exhibits	7	Observation Bridge	15
Children's Exhibits	8	Tower	16



St. Croix River
Interpretive Center

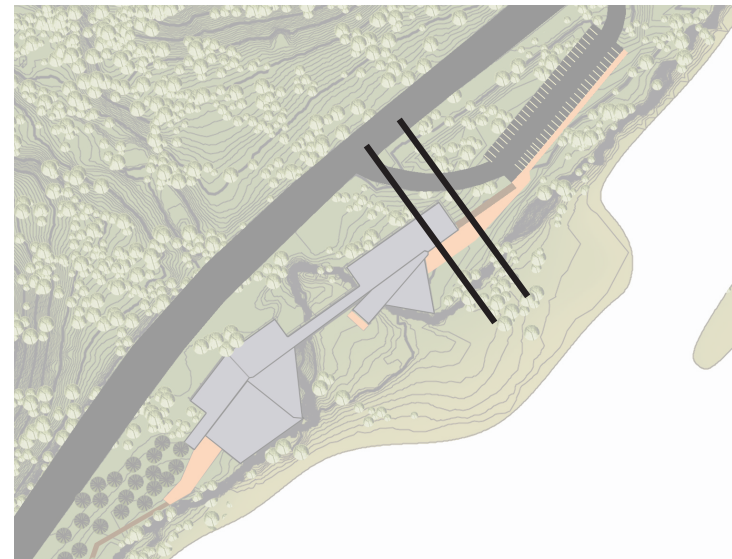
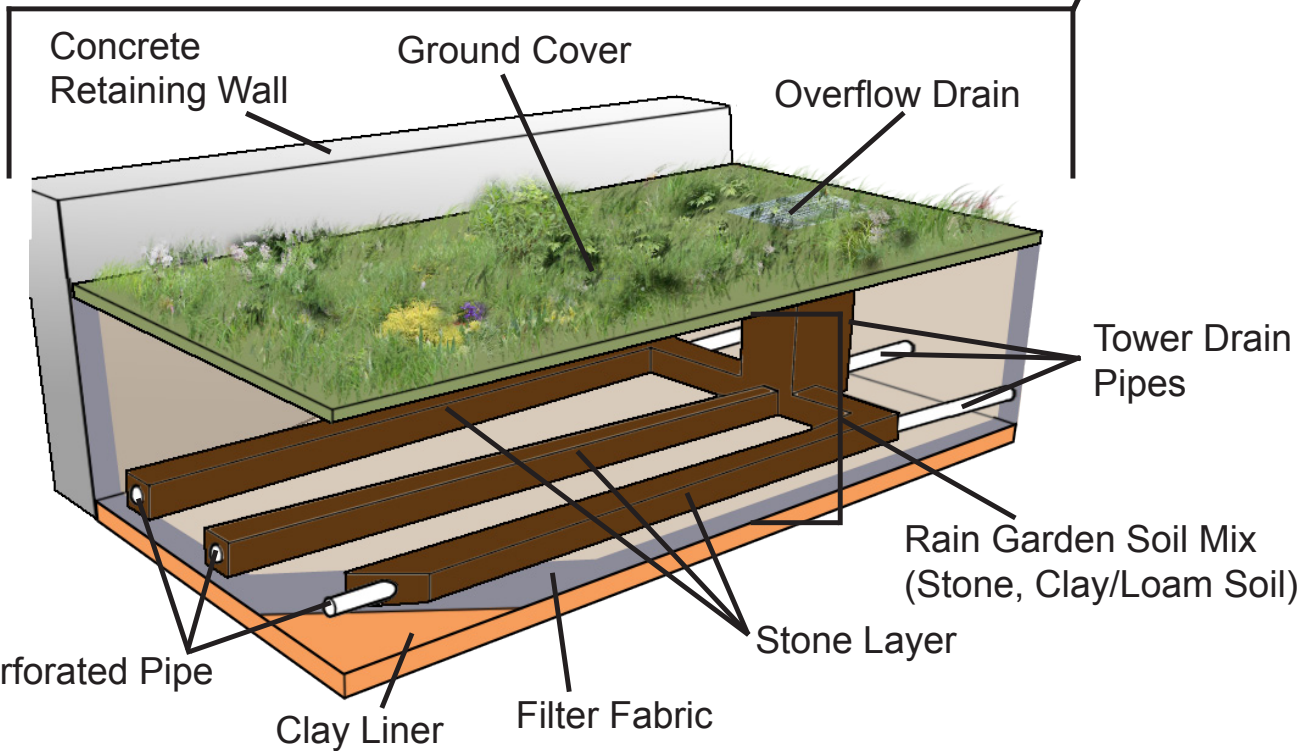
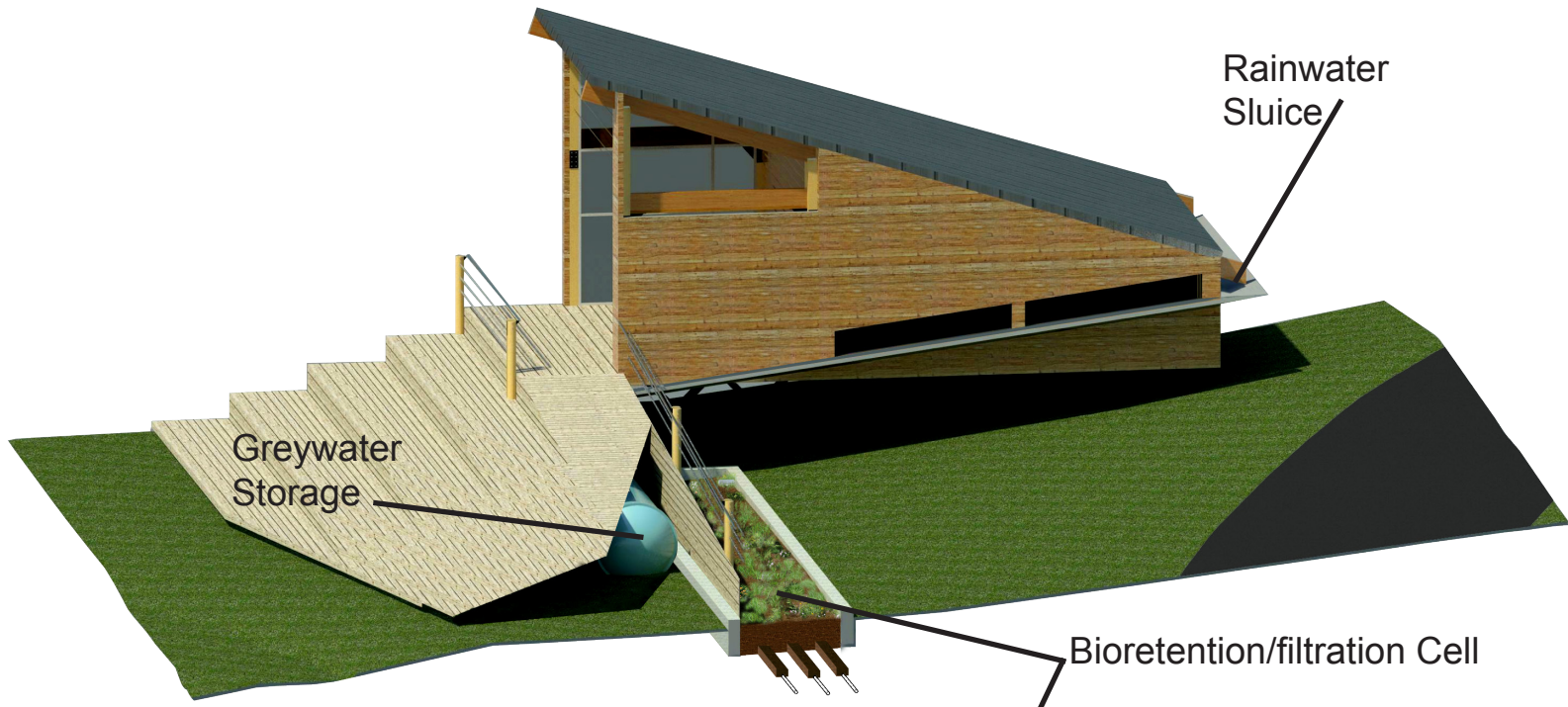





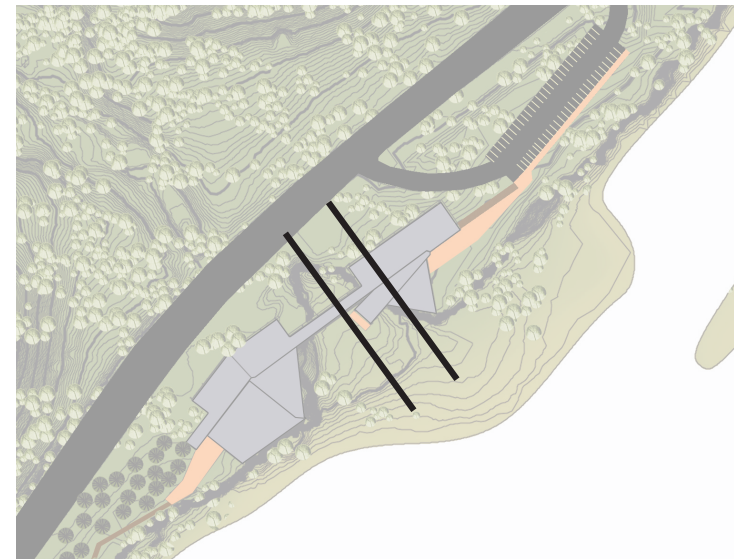
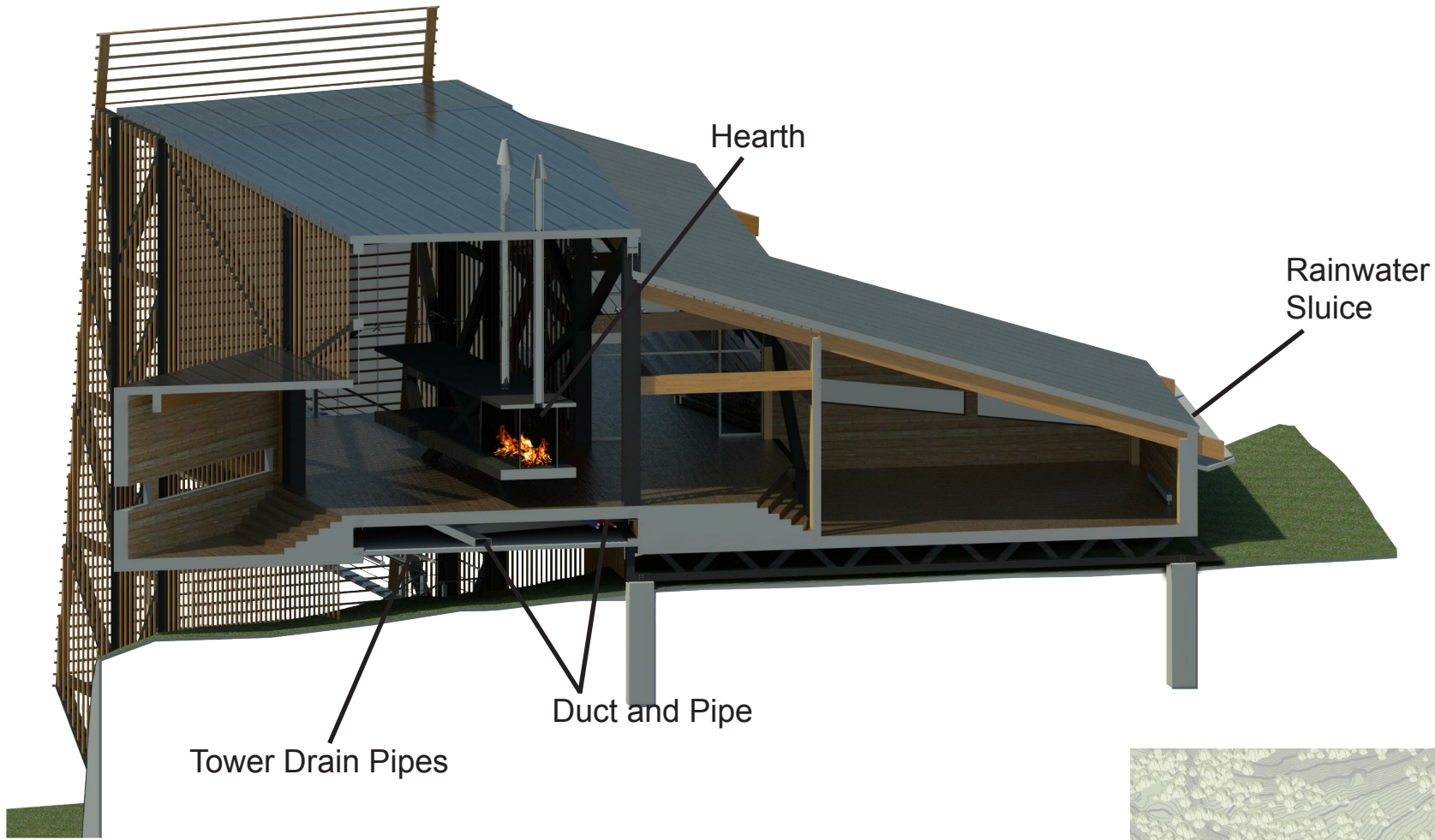



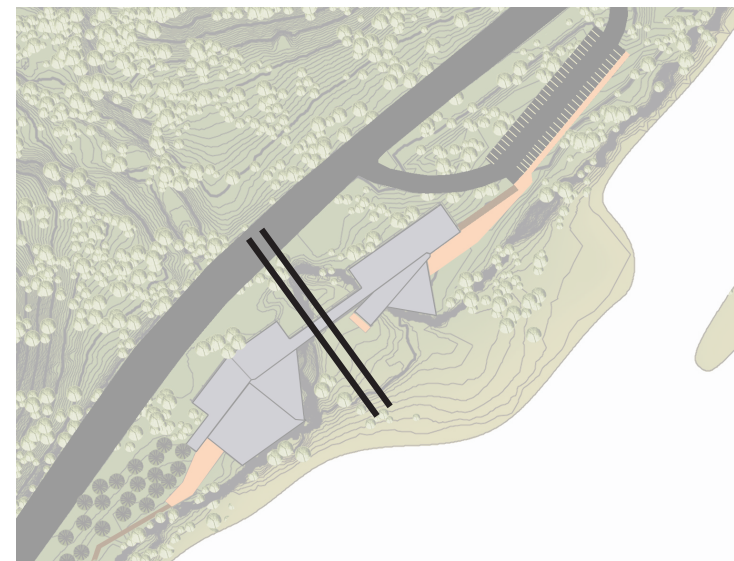
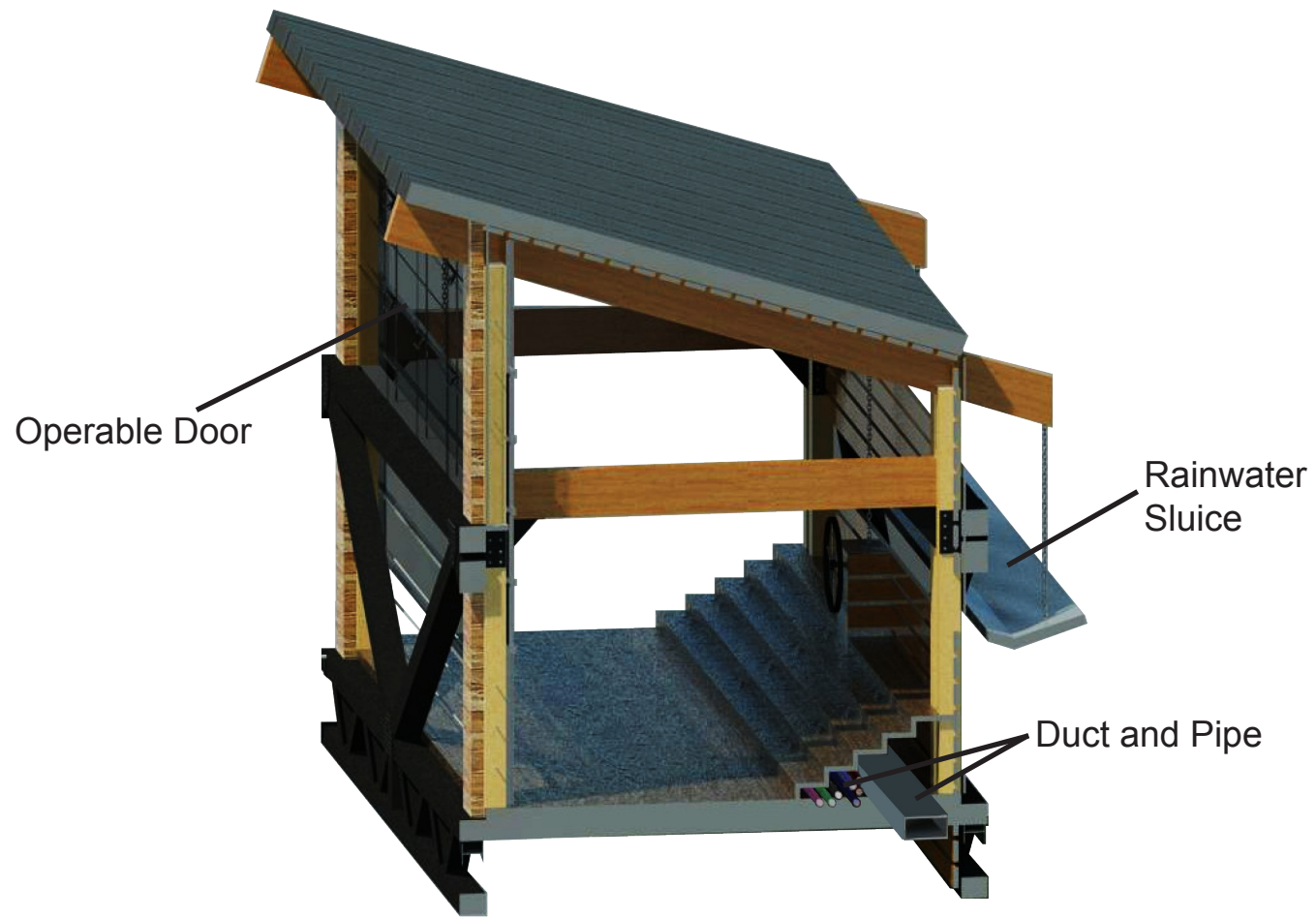

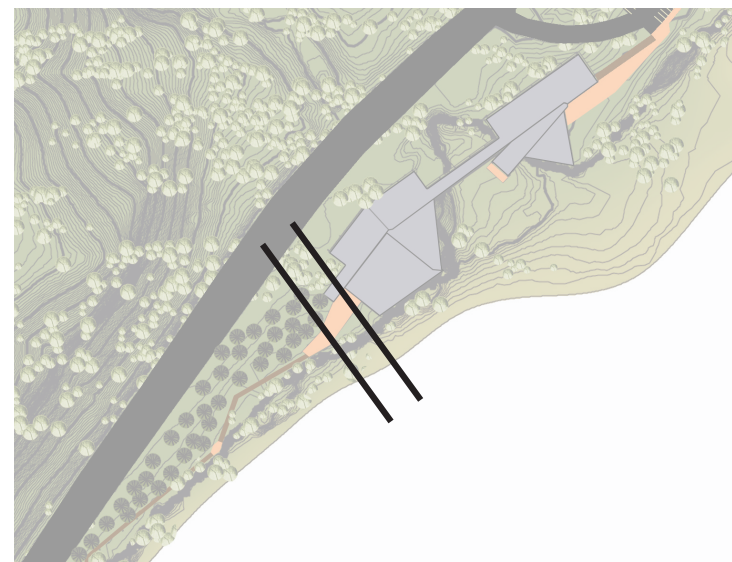
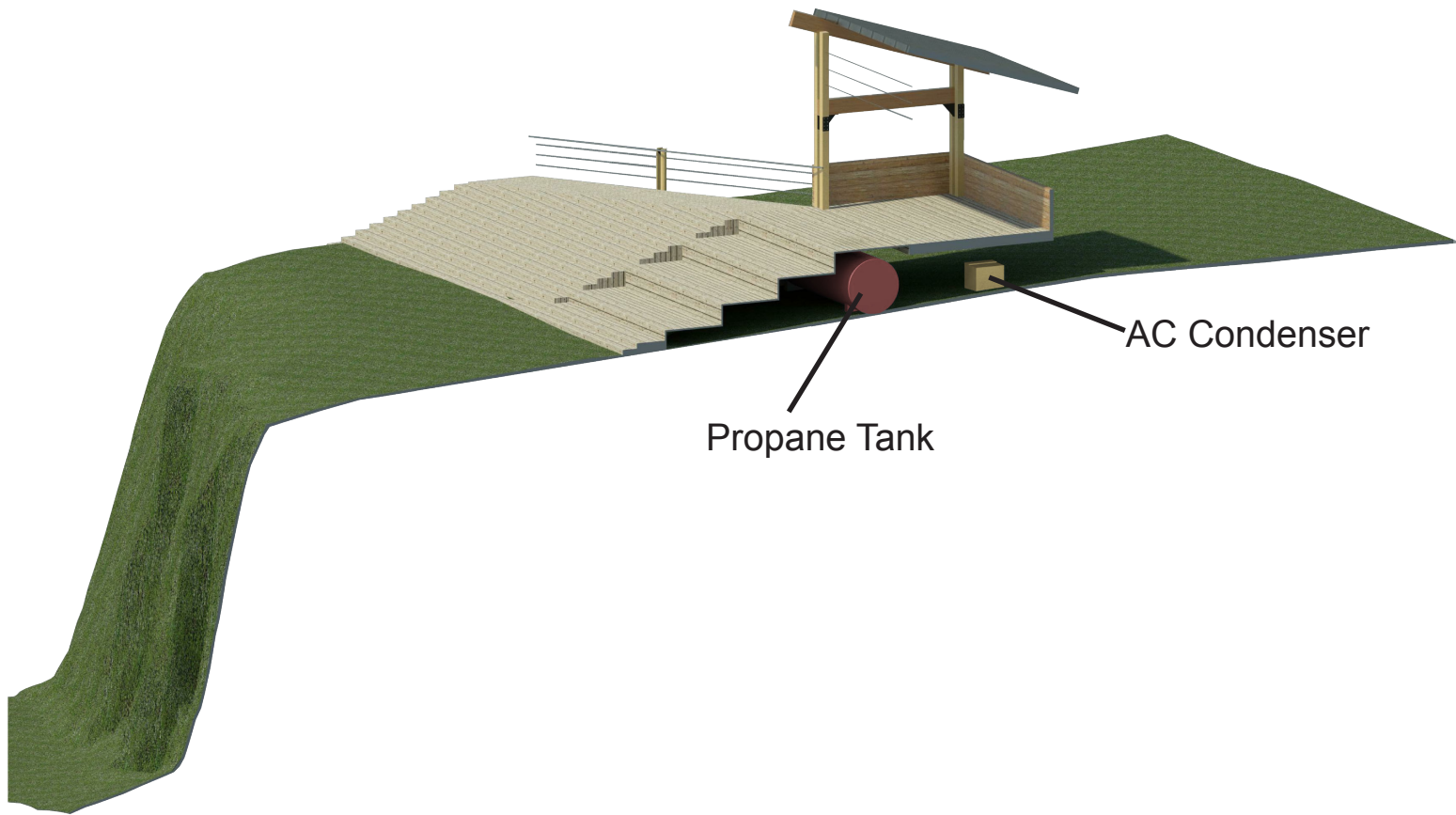





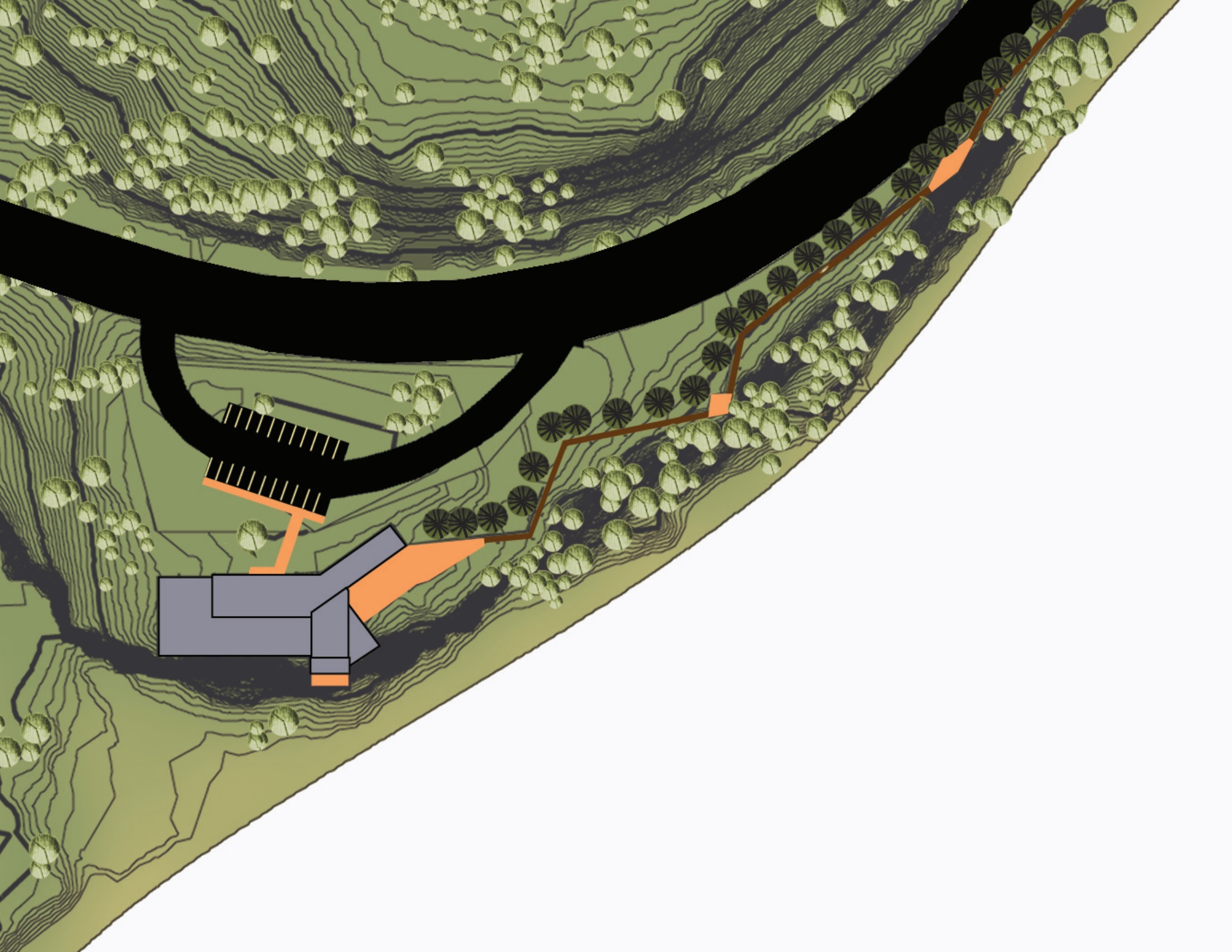

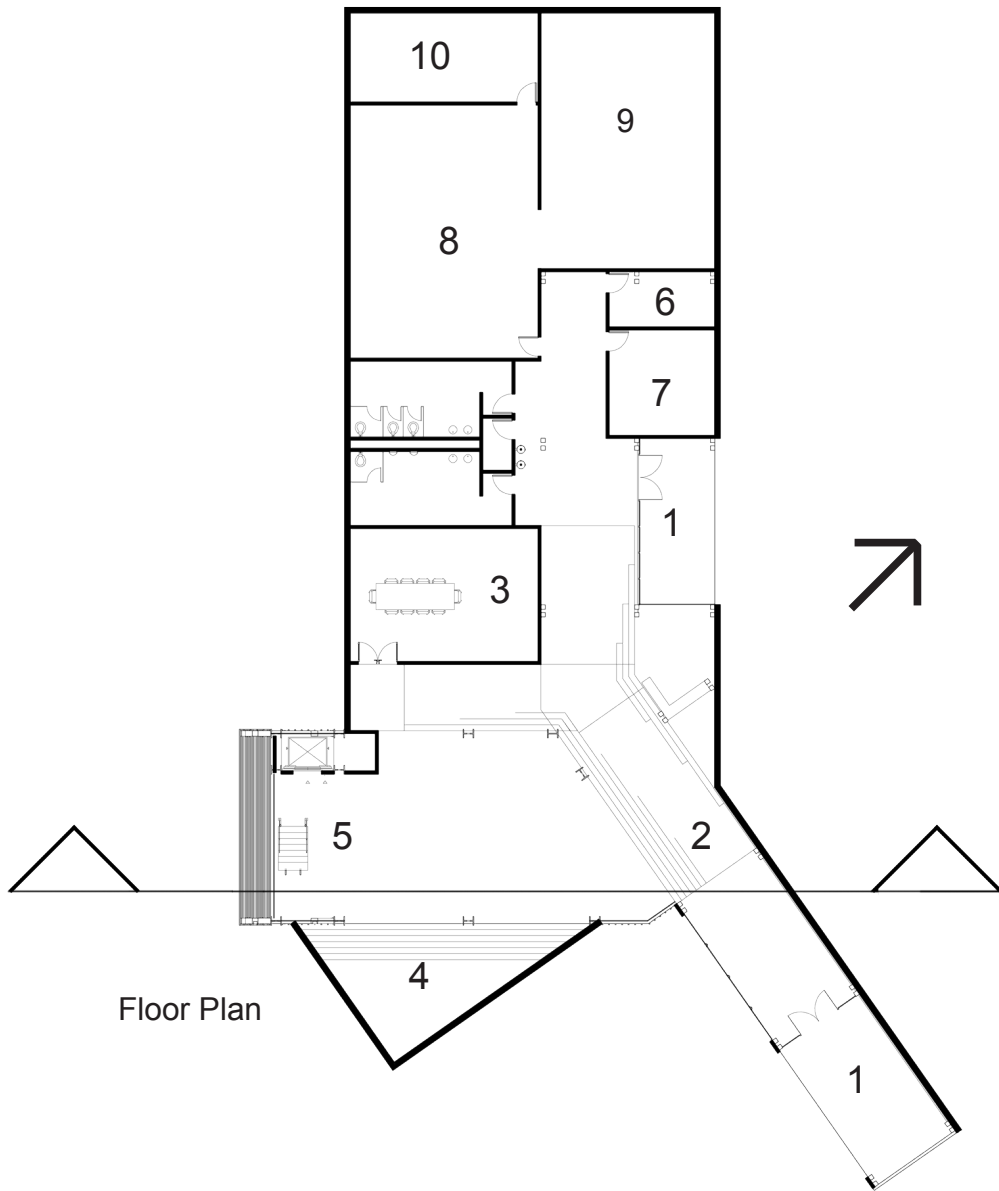

Floor Plan

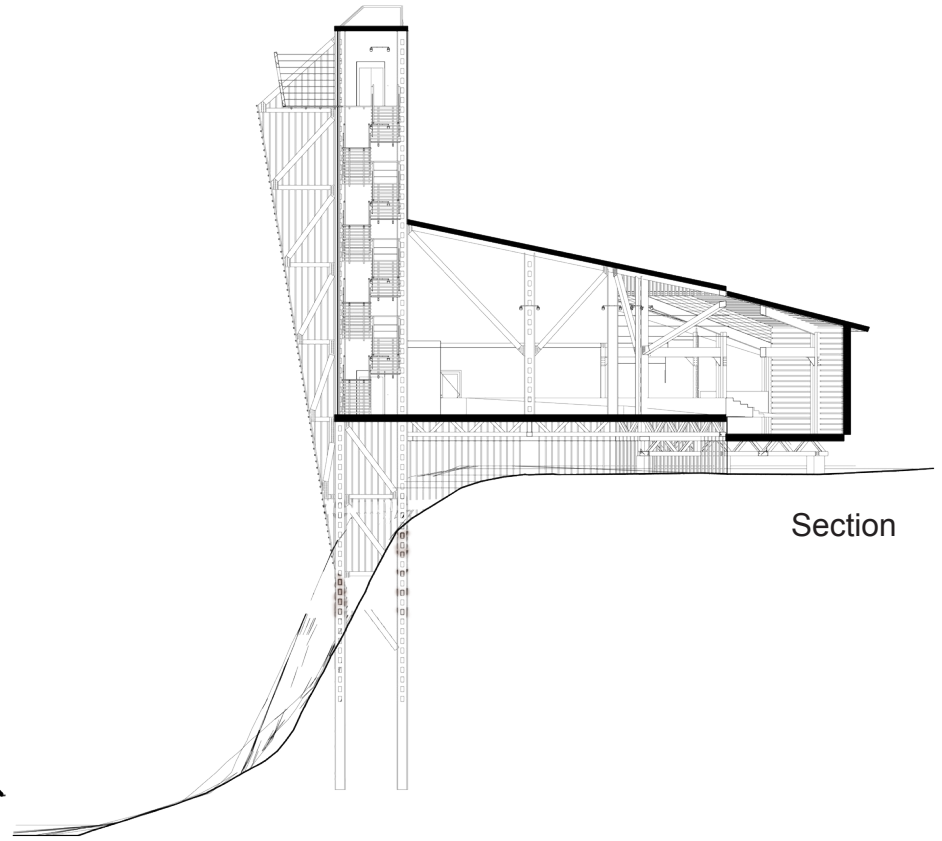

Section

Entry	1	Storage(archive)	7
Lobby	2	Administration Of-fices	8
Conference	3	Field Offices	9
Gathering	4	Staff Room	10
Tower	5		
Storage	6		

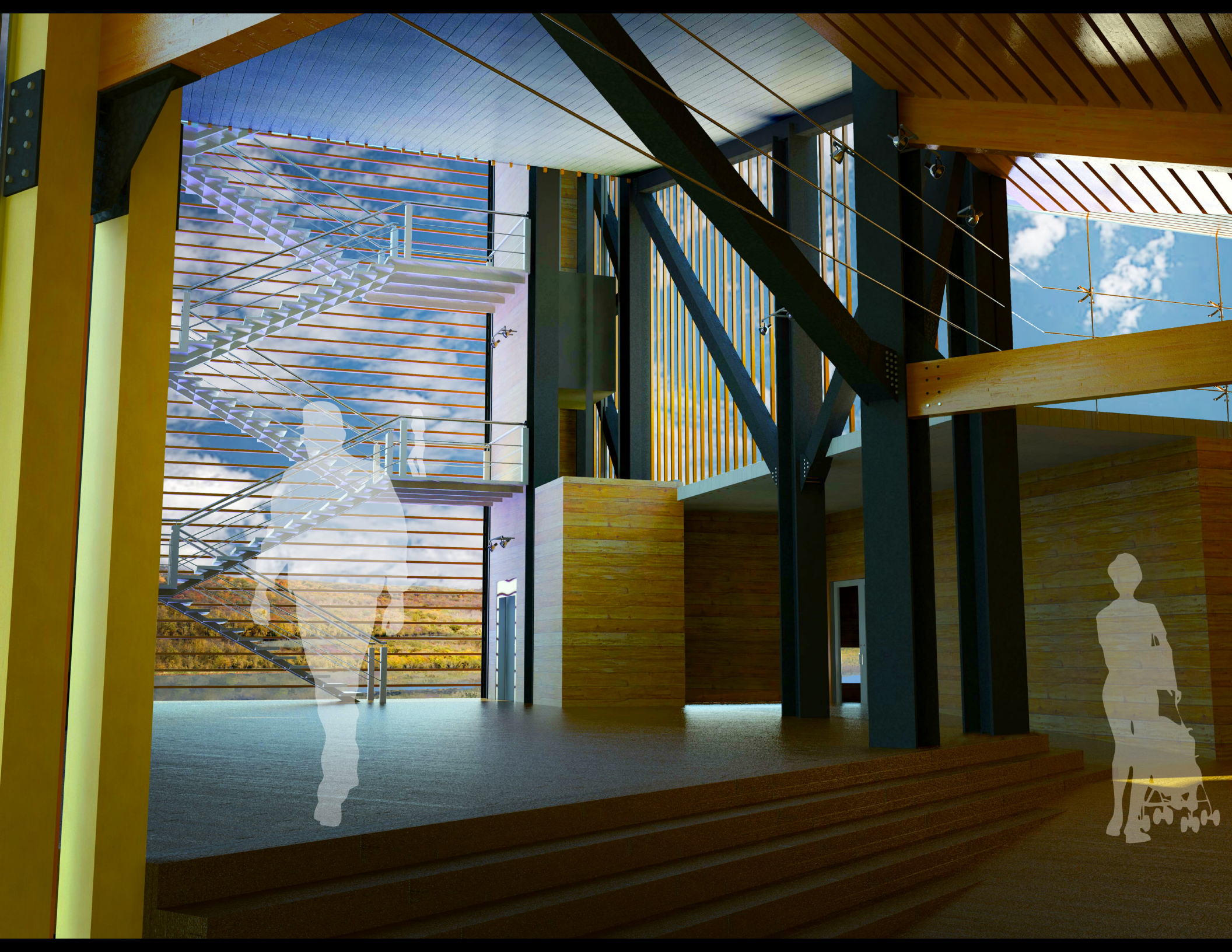



How do natural and cultural context inform and coexist within contemporary design?

Thank you

