

Waterfront Discovery

Site Context



Structures

- 1 Existing Childrens Park
- 2 Existing Aquarium Parking
- 3 Great Lakes Aquarium
- 4 Green Roof Parking Structure
- 5 Waterfront Discovery Visitor Center
- 6 Bayfront Concert Stage
- 7 Bayfront Square (North)
- 8 Bayfront Square (South)
- 9 LaFarge Concrete Plant
- 10 Mixed-Use Residential Building
- 11 Mixed-Use Residential Building (Green Roof)
- 12 Green Roof Parking Structure
- 13 Green Roof Bayfront Hotel
- 14 Rental Hut

Planting Plan

- Large Deciduous Tree
- Large Coniferous Tree
- Ornamental Tree
- Small Deciduous Tree
- Deciduous Shrubbery

Building Uses



Open Space Analysis



Paths & Connections

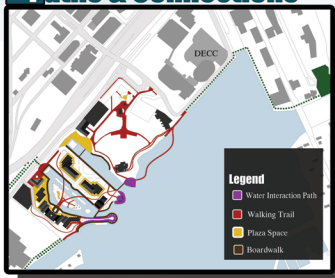

The building uses on the Bayfront site vary widely to accommodate both visitors and residents alike, however most buildings will feature retail on the lower floor to provide a source of sustenance for the development.

The open Spaces on the Bayfront Site feature four primary types of design: active, passive, remediation, and plaza. Each of these link to one another throughout the site as well as to other important connection nodes off of the Bayfront Site.

Various paths and connections will be implemented to establish connections both on the Bayfront site and its surrounding context. The primary connections will be made to Canal Park, Harbor Drive, and the Superior Hiking Trail.

DULUTH, MN

How can a Waterfront development intervention react to its adjacent body of water as become an epicenter for growth and overall well being of a community?

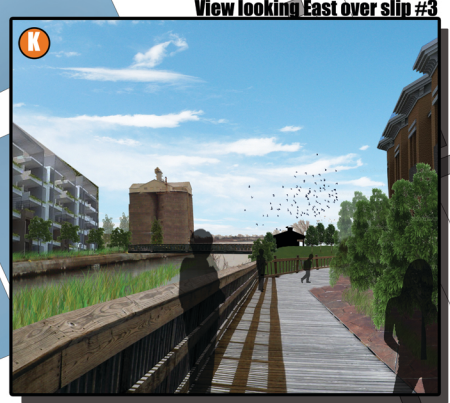
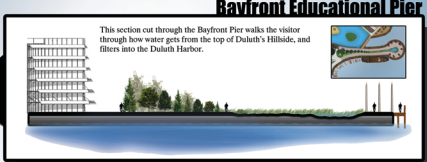
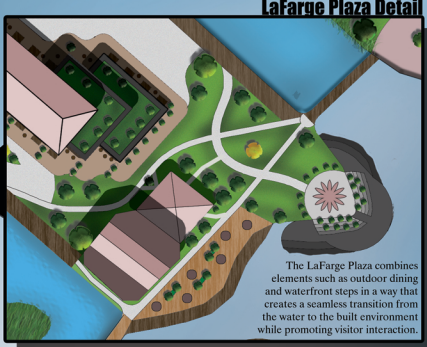

Waterfront Discovery Amenities

- A Entrance Promenade
- B Lakewalk
- C Riparian Buffer
- D Lookout Plaza
- E Sunken Plaza
- F Bayfront Entrance
- G Green Roof
- H Waterfront Steps
- I LaFarge Outdoor Dining
- J Boardwalk
- K Slip #3 Lookout
- L Bayfront Island
- M Bayfront Beach
- N Remediation Island
- O Educational Pier
- P Train Plaza
- Q Walking Park

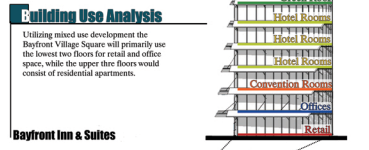
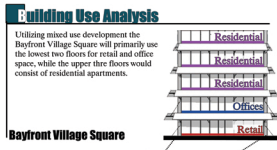

This panorama shows the Bayfront Site at the height of the shipping industry. The port area was best known as a primary exporter of timber, fur, wheat, and other minerals. The Bayfront site has never been a place for entertainment, but rather was where the area derived its collective source of income.