

Sustenance

(Football Field)

Terrace 3 - Upper Level

Terrace 2 - Middle Level

Terrace 1 - Lower Level

(Parking Lot)

SPATIAL ADAPTABILITY

Though most classrooms in the building are of set dimensions, the fact is that one size doesn't fit all. To help accommodate variable classroom size, the west wing of the building is an area that can be partitioned into separate spaces by "Nana-Doors," dimensioned 2 feet wide, 3 inches deep, with a height of approximately 9 feet. The panelized partitions are sound damped to isolate unwanted noise, with a neoprene gasket connection to the floor surface. The changes in space configuration are done internally, the space sharing one continuous exterior wall. The partition spacing aligns with that of the overhead structural floor joists.

AREA: 21,228' of Adaptable Classroom Space

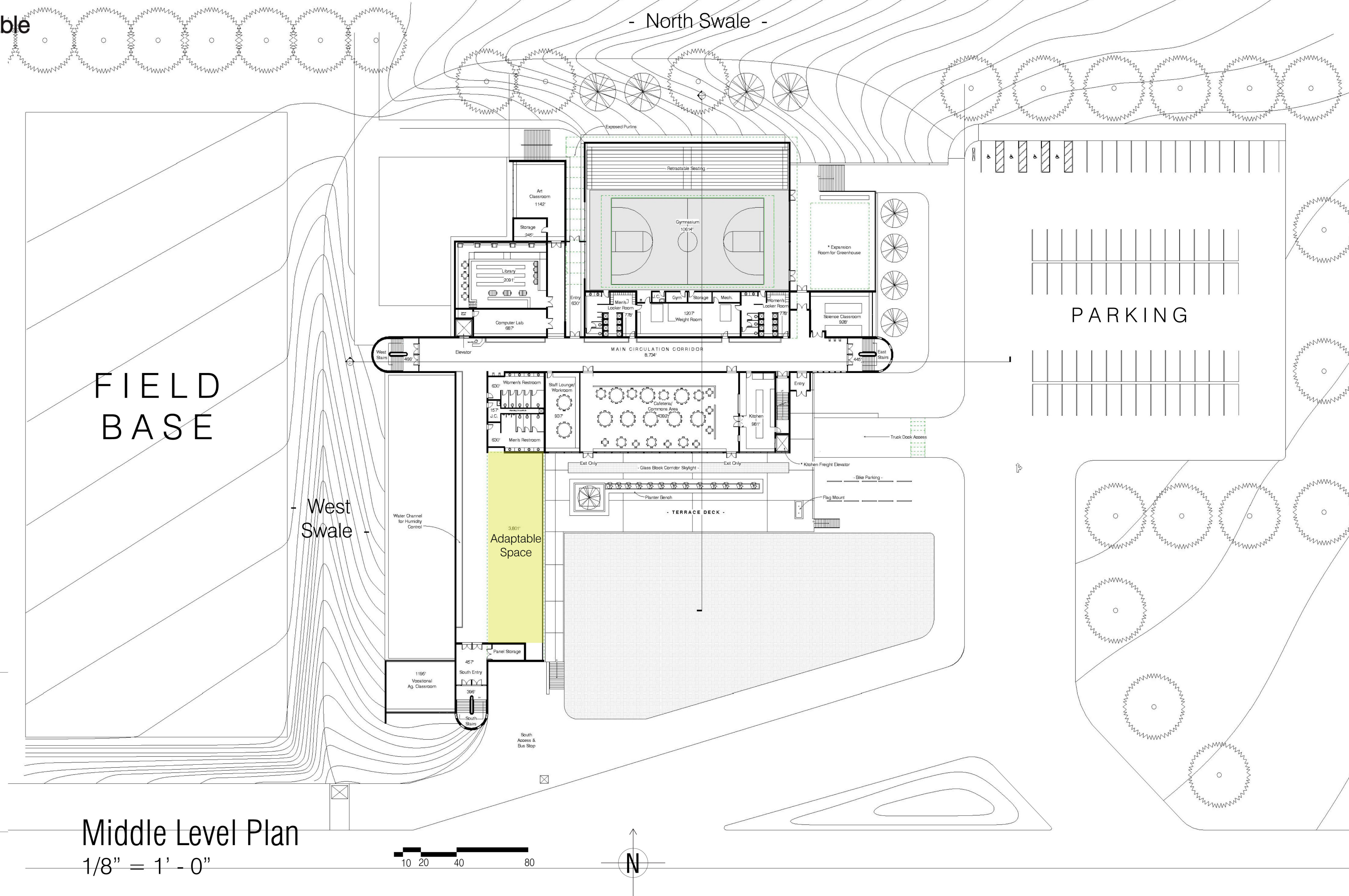
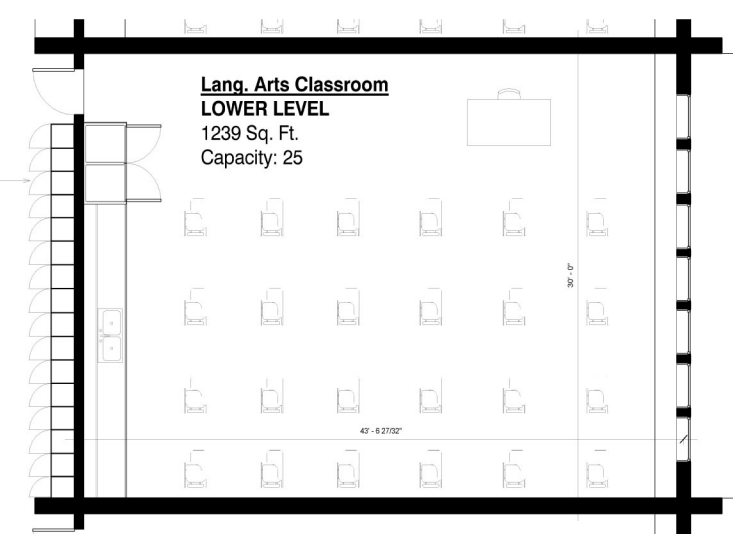
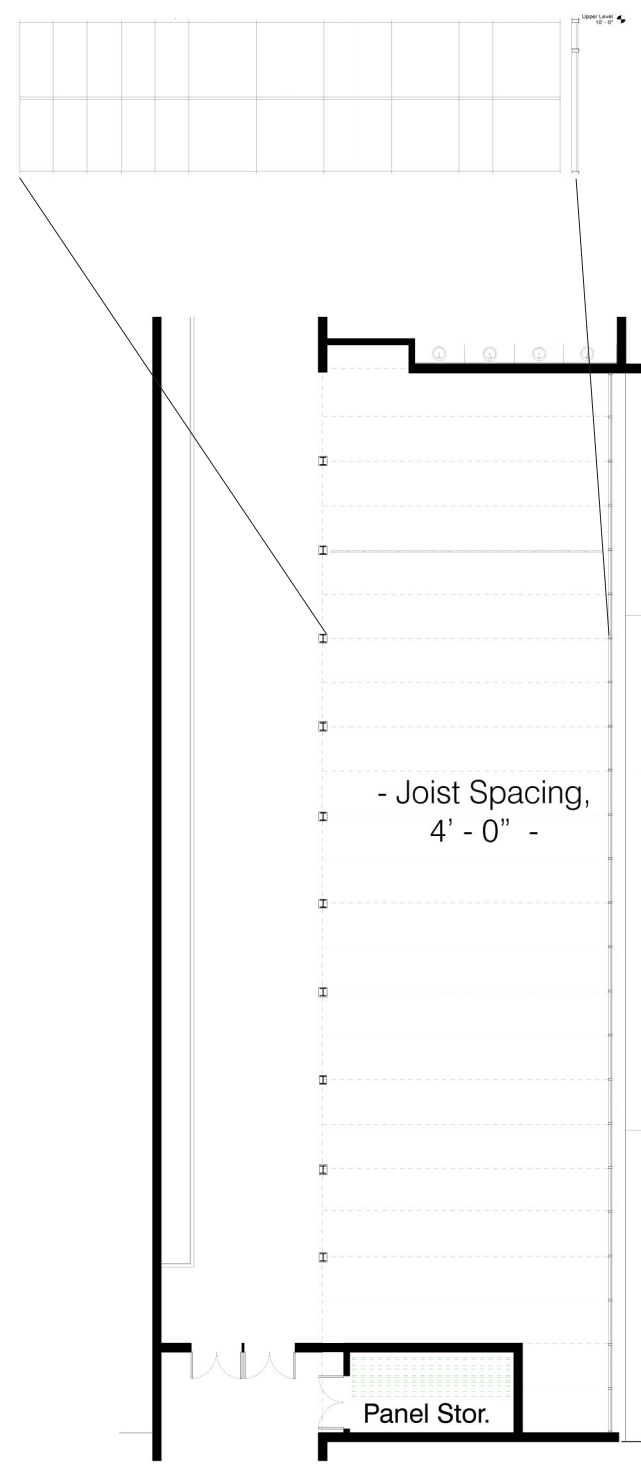

Middle Level Plan

1/8" = 1' - 0"

S
S
P
R
O
C
E
S

Department of Architecture & Landscape Architecture, NDSU
ARCH 772, Design Thesis, Spring 2013

"Nurturing Sustenance", Middle School
101,698 Square Feet Total

STUDENT: Dominic Monson
THESIS ADVISOR: Ganapathy Mahalingam

Programs Used:
Revit Architecture, SketchUp,
Illustrator, Photoshop