

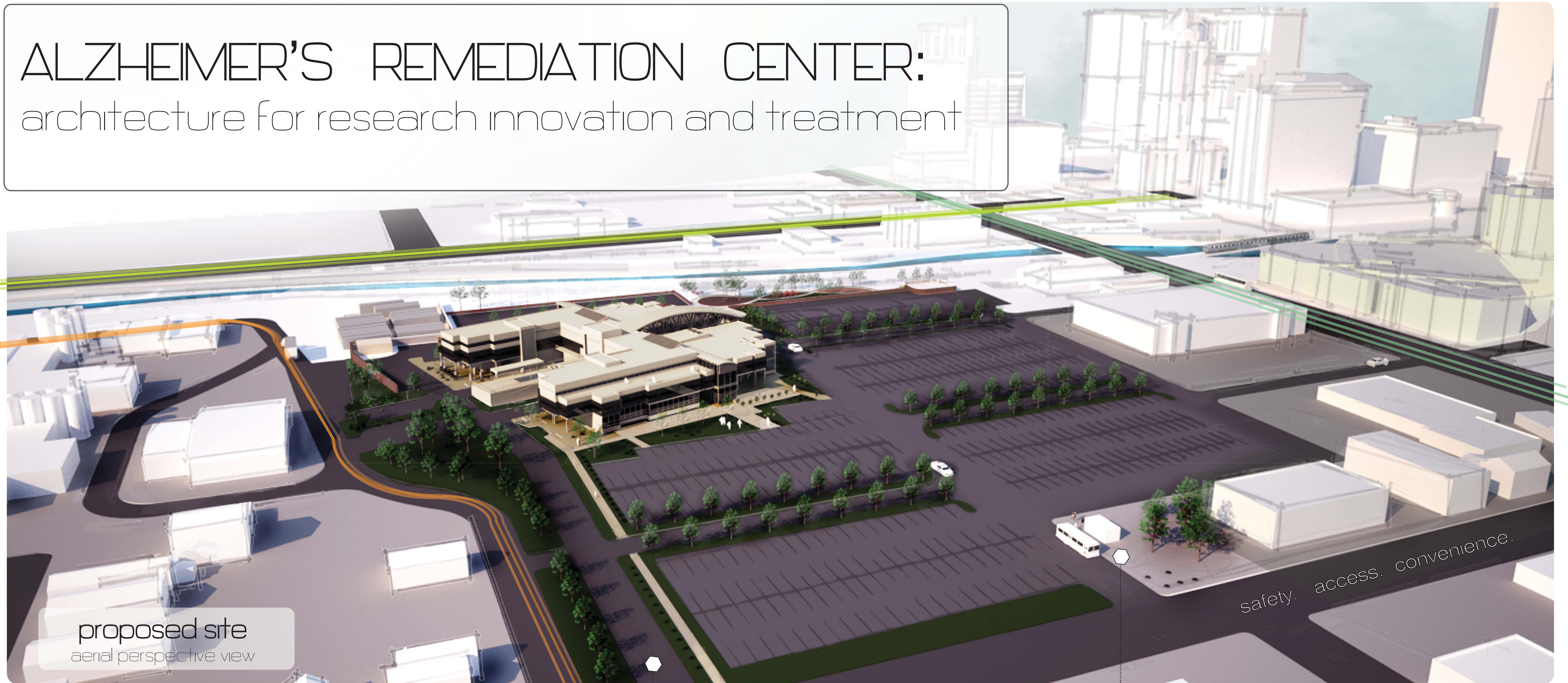

# ALZHEIMER'S REMEDIATION CENTER: architecture for research innovation and treatment



proposed site  
aerial perspective view

safety. access. convenience.

## traffic analysis

-  truck + industrial traffic
-  moderate traffic
-  moderate-heavy traffic

how can perceived spaces within a structure affect memory retention?



The building's slight orientation towards the West maximizes views of the current downtown area and Zumbro riverfront. In the same way, views and access to the current industrial district south of the site are minimized.

views

proposed frontage road  
ambulance access + service truck entry

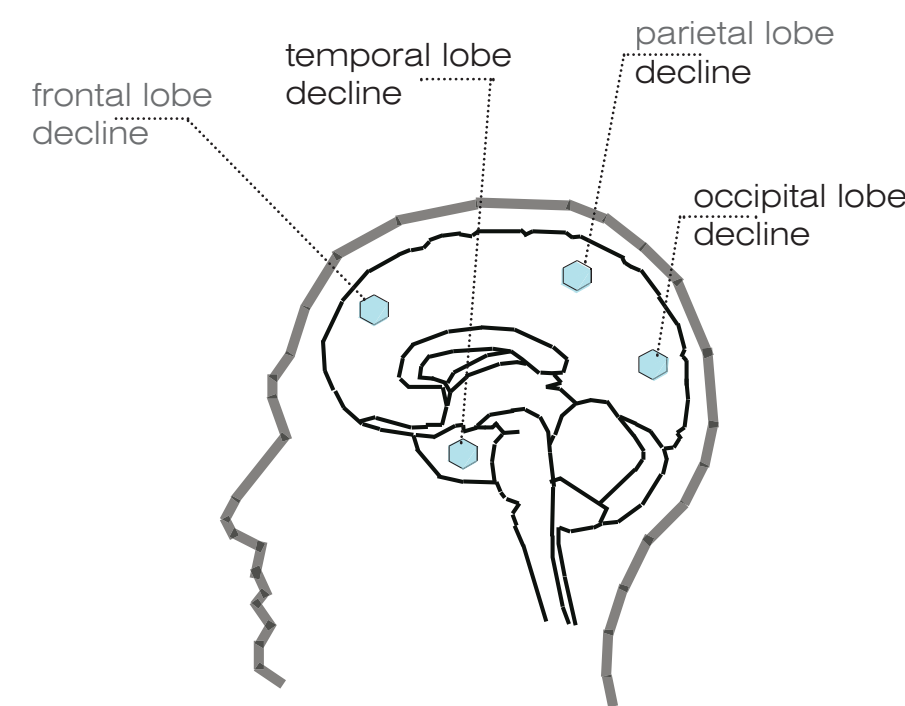

sector-based brain changes

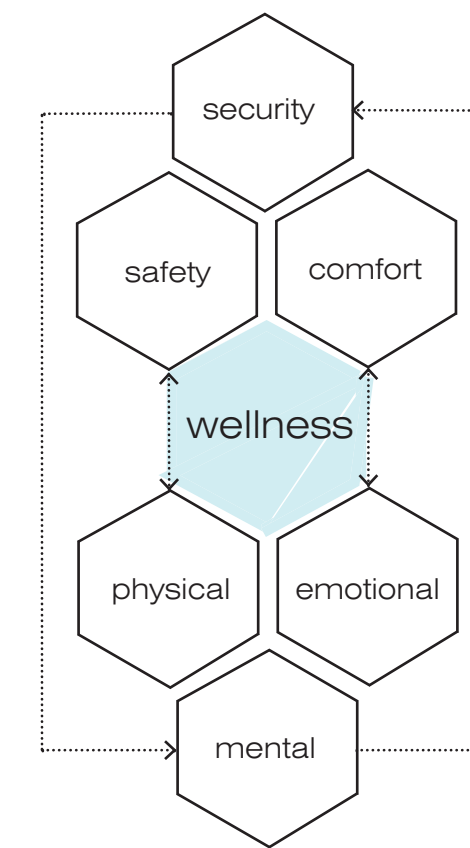

directives

existing bus stop  
existing parking entry + public parking

The site choice is the result of a series of observations and factual information. According to the 2012 Alzheimer's Disease Facts and Figures, "70,474 people living in Minnesota reside in nursing homes. 70% (49,332) of those residents suffer from some form of cognitive impairment." With those staggering rates, Minnesota is one state among many in need of attention. A project of this typology will thrive in an area where medical researchers/specialists are readily available. Rochester has these characteristics. Close proximity to the Mayo Clinic plays a vital role in the collaboration of medical studies performed in this building. Located at the intersection of 1st Ave SE and 4th St SE, this location also has plenty of existing parking for all users of the building.

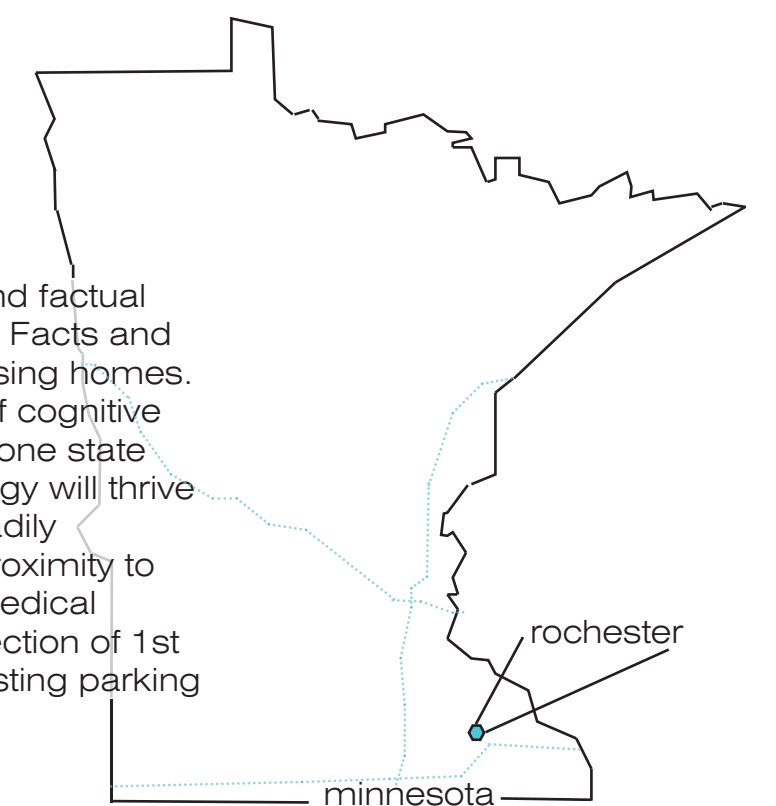

Design challenges addressed are the locations of a nearby industrial park, river, and railroad track. The building footprint is set back far enough from the moderately busy traffic of 4th St SE to uphold safety of the residents. Other nearby functions surrounding the site are a bike path, residential area, some small commercial facilities, and apartment complexes.