

The Soup Bowl

In the City of Lakes



Downtown

Lake Calhoun

38th St.

Grand Rounds

King's Highway

City Context

Abundant parks +

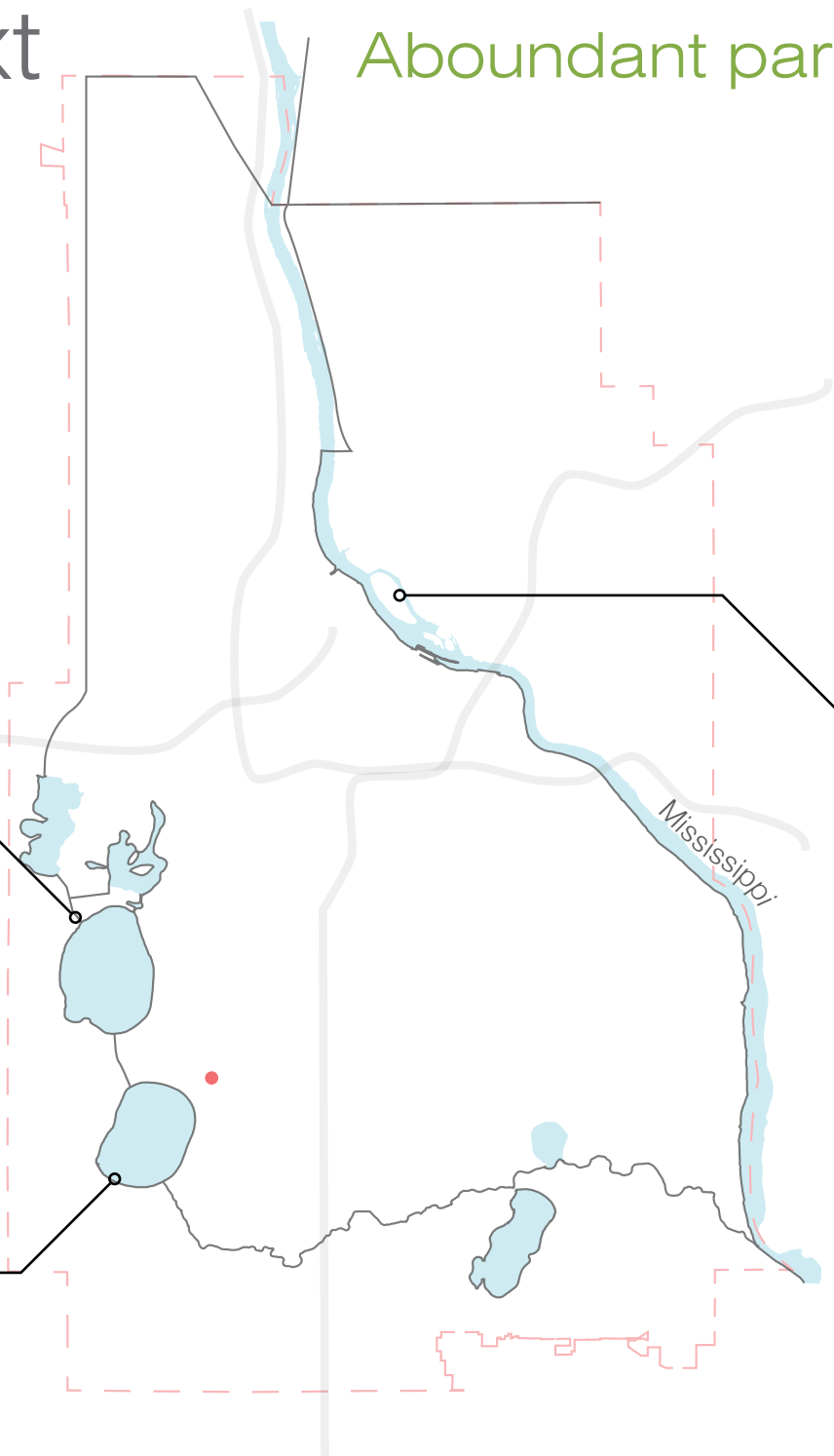

- Site
- Grand Rounds
- Expressways
- Water







City Context

Abundant parks +
Need to Improve stormwater =

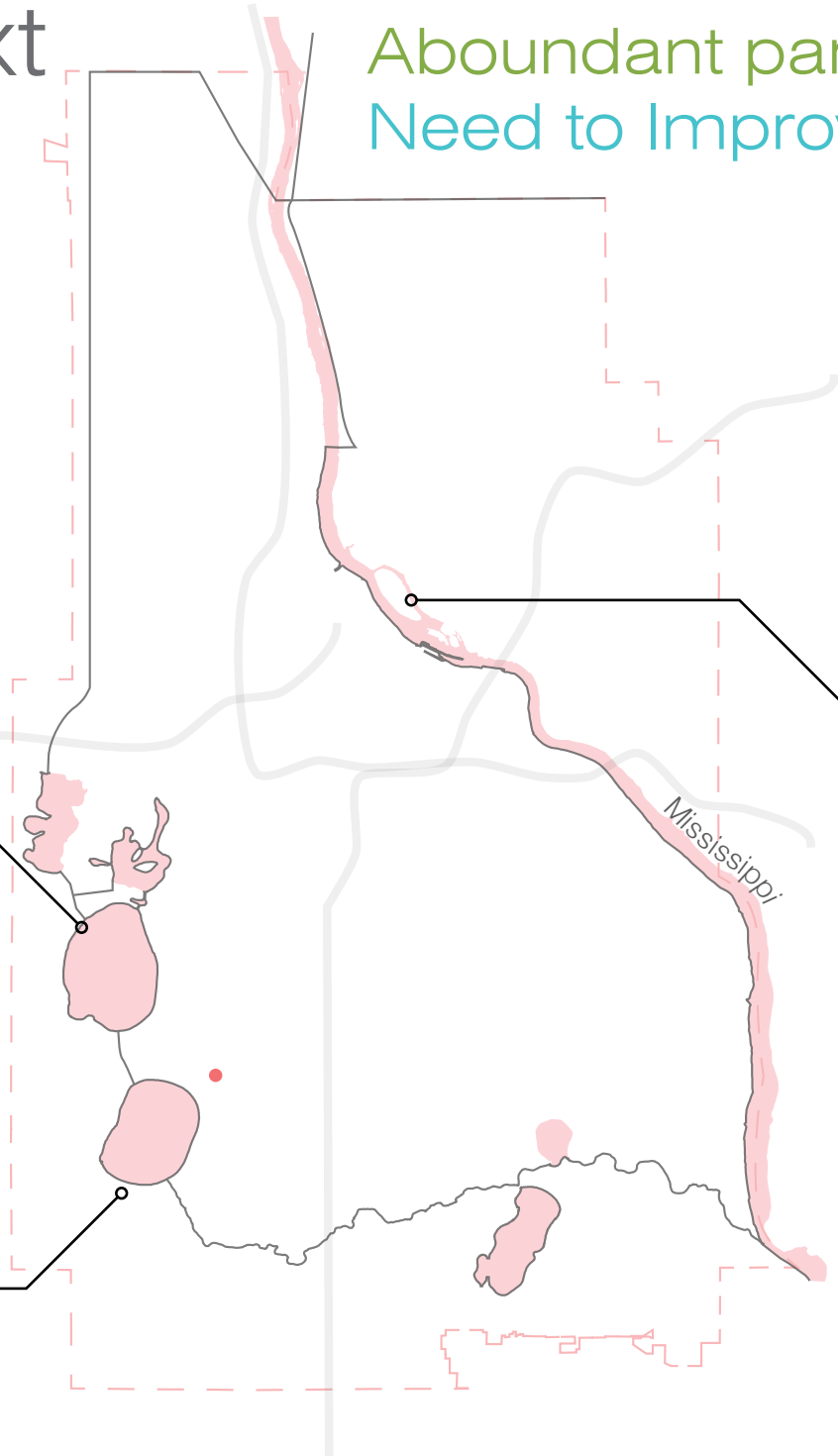

- Site
- Grand Rounds
- Expressways
- Impaired Waters

Opportunity

Abundant parks +
Need to Improve stormwater =

Opportunity for
Green Infrastructure!

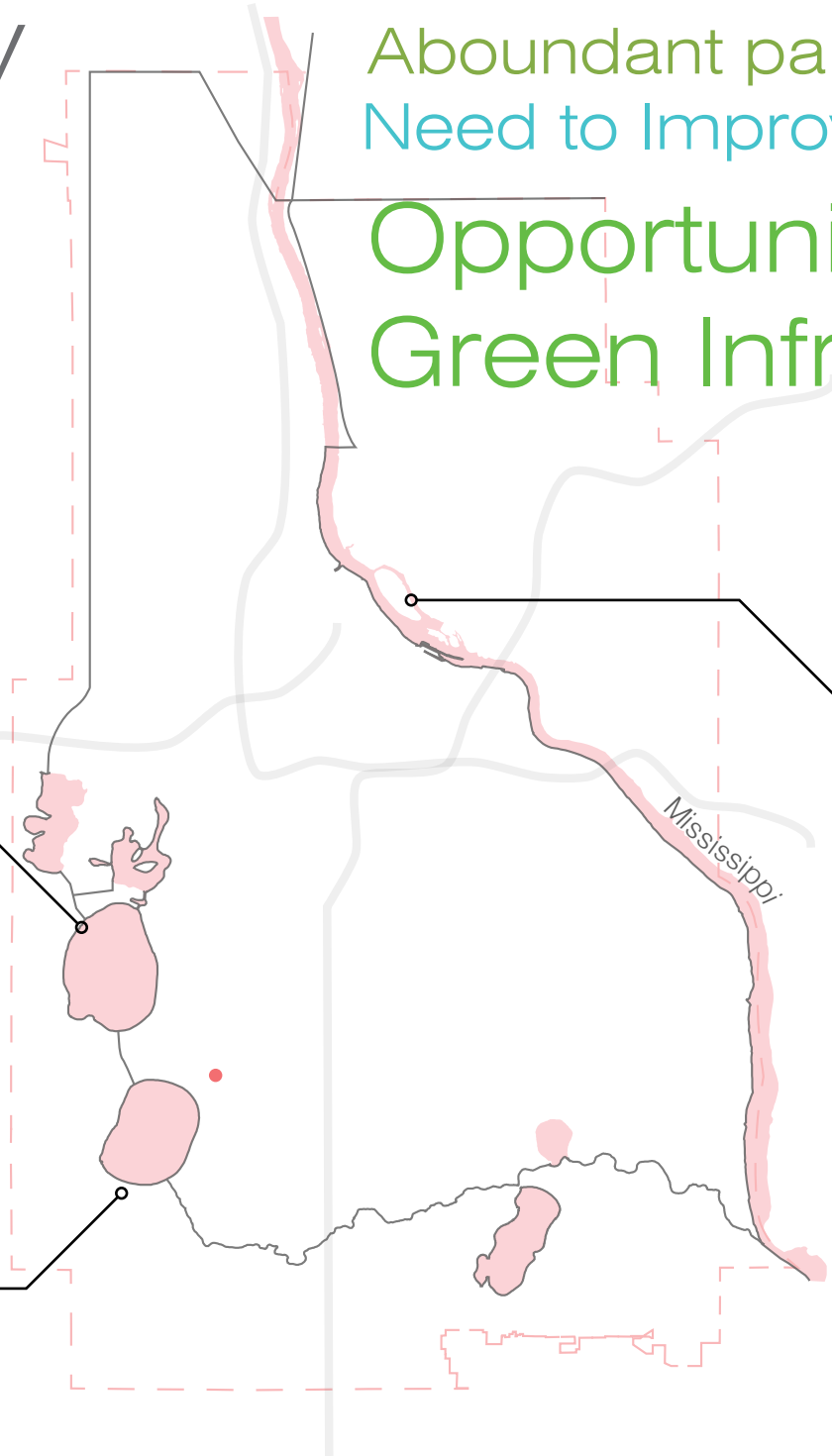

- Site
- Grand Rounds
- Expressways
- Impaired Waters

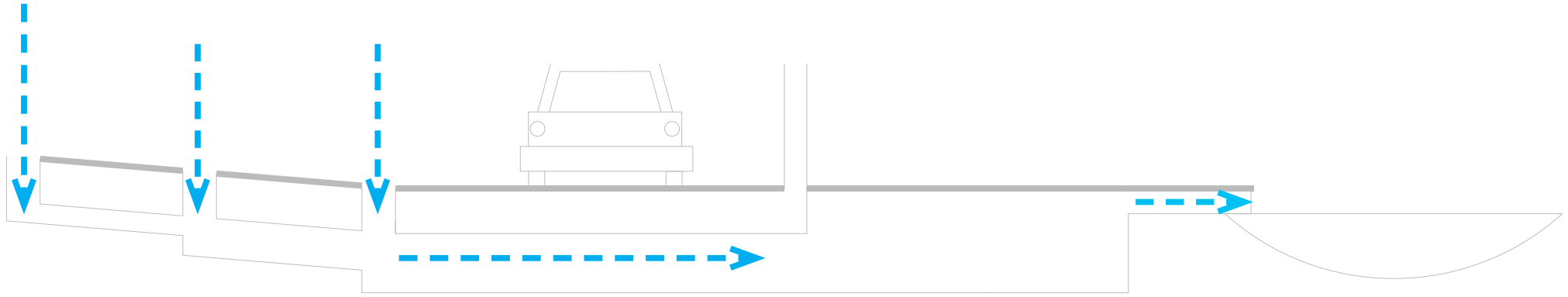

How can parks transform
stormwater from a

~~liability~~

into an

amenity?

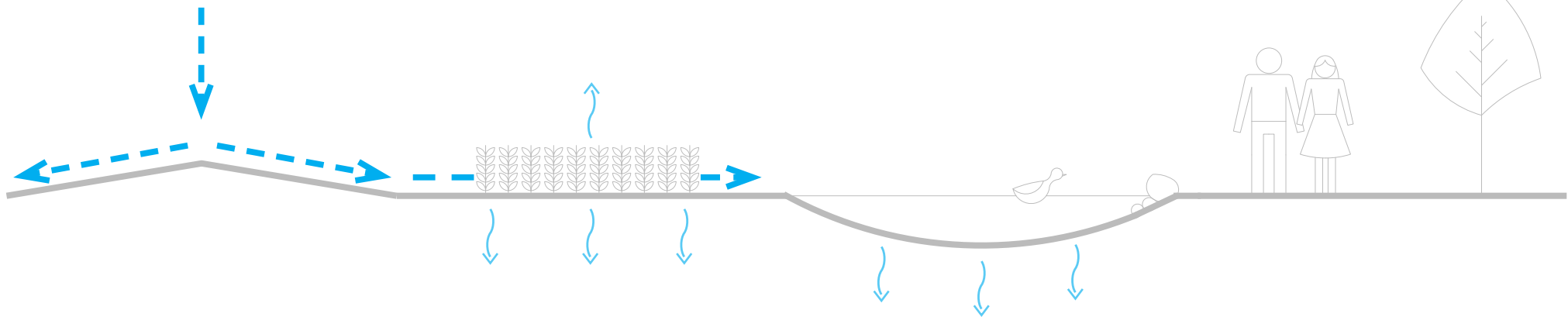

Orientation

38th St. Bryant Ave.

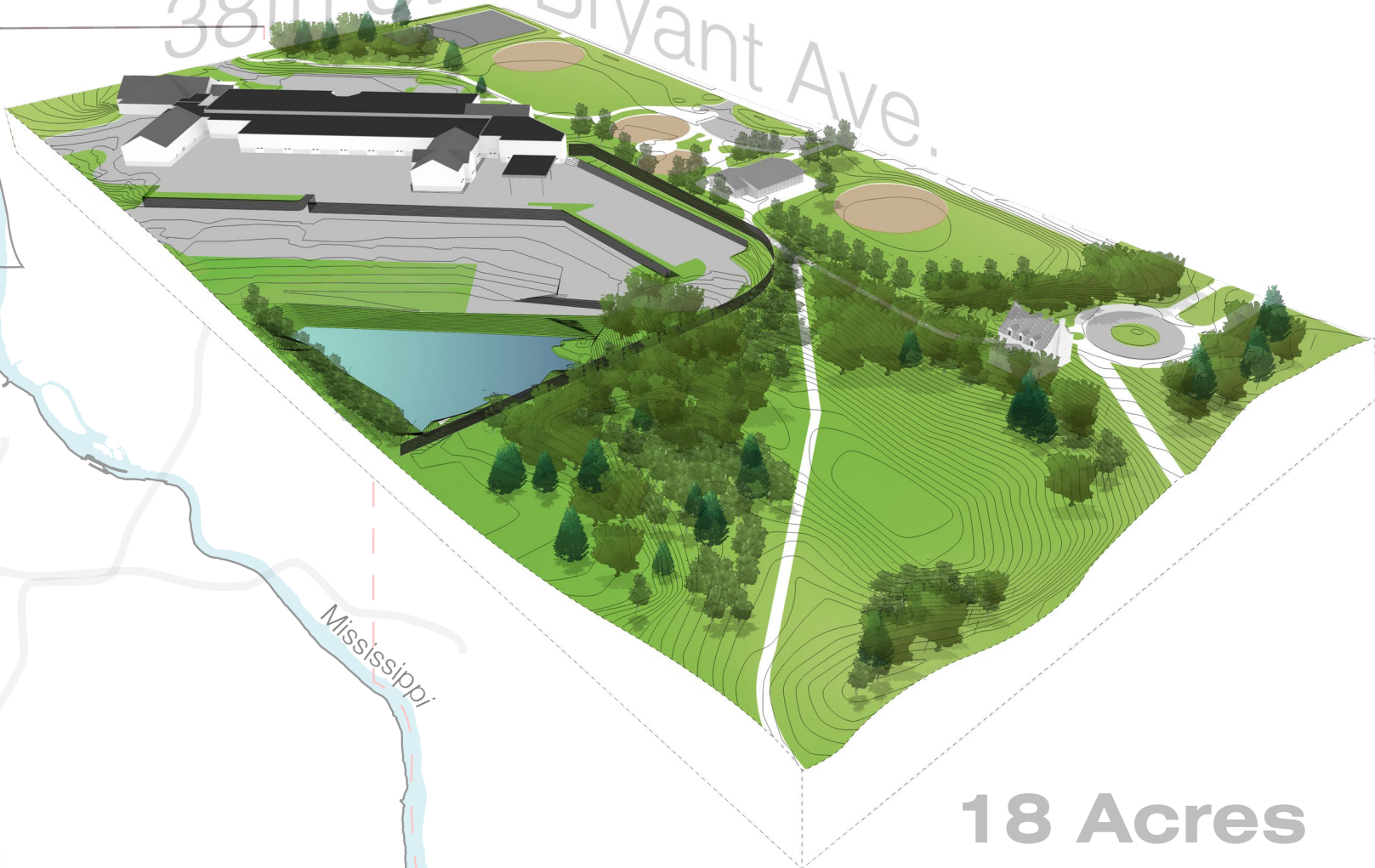

18 Acres

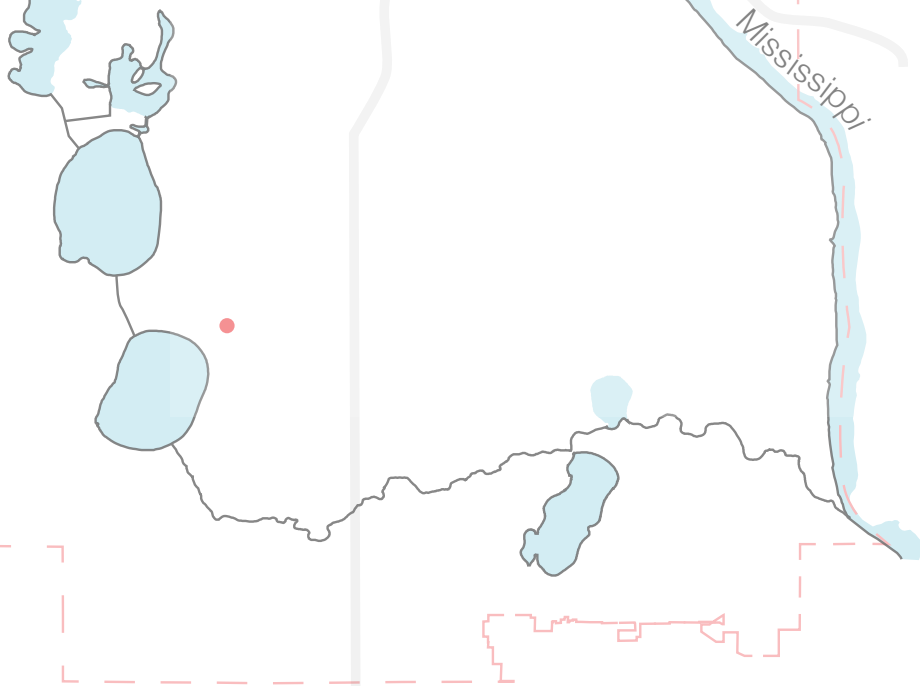

- Site
- Grand Rounds
- Expressways
- Water

History

H.W.S Cleveland

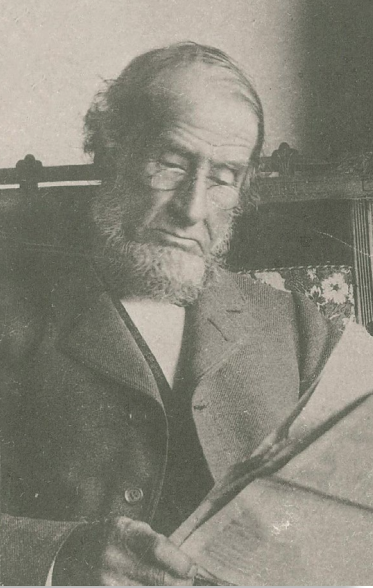

Lyndale Farmstead

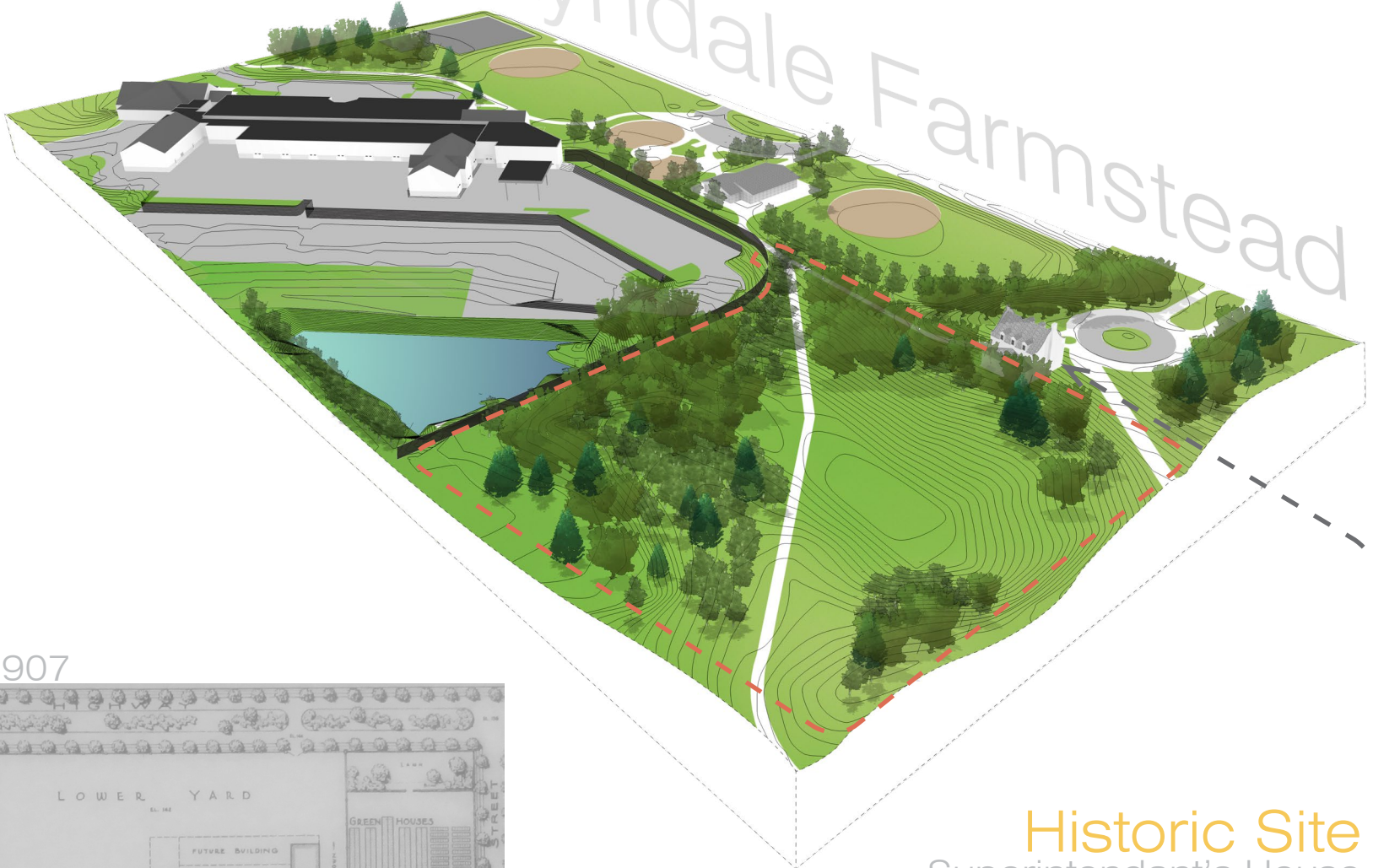

Wirth Site Plan - 1907

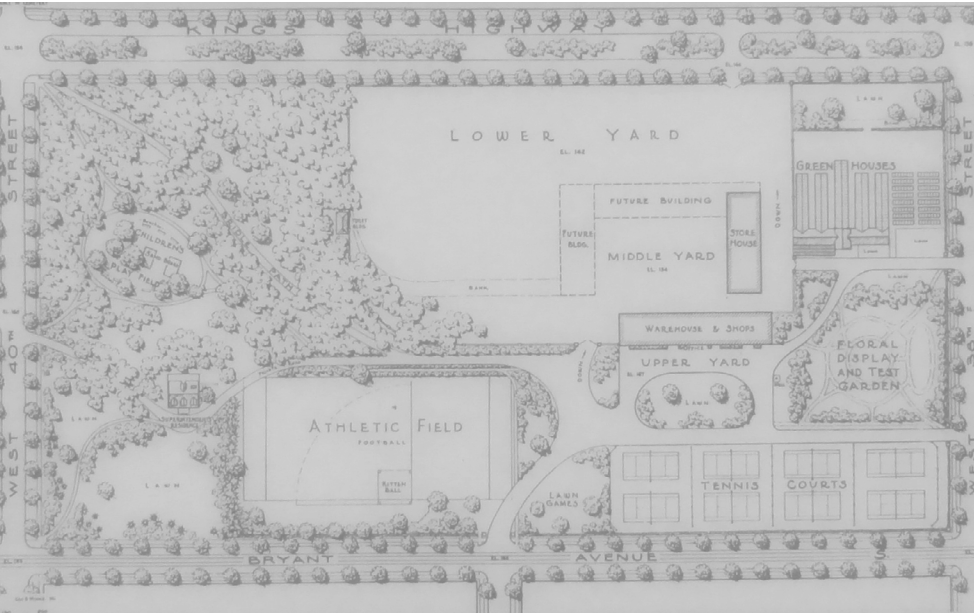

Historic Site Superintendent's House



Community



Block Dimensions:

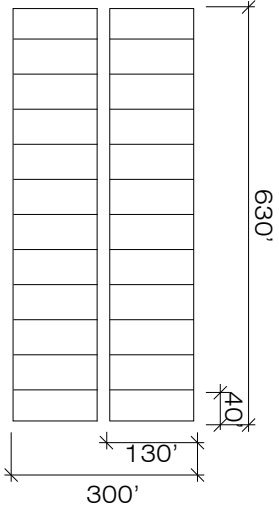

Building Types:



House + Detached Garage

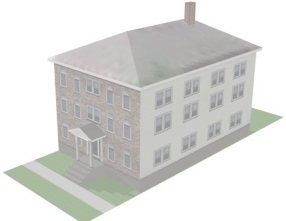

Multi-Story Apartment



Downtown

Lake Calhoun

38th St.

Grand Rounds

King's Highway

Catchment

Landform

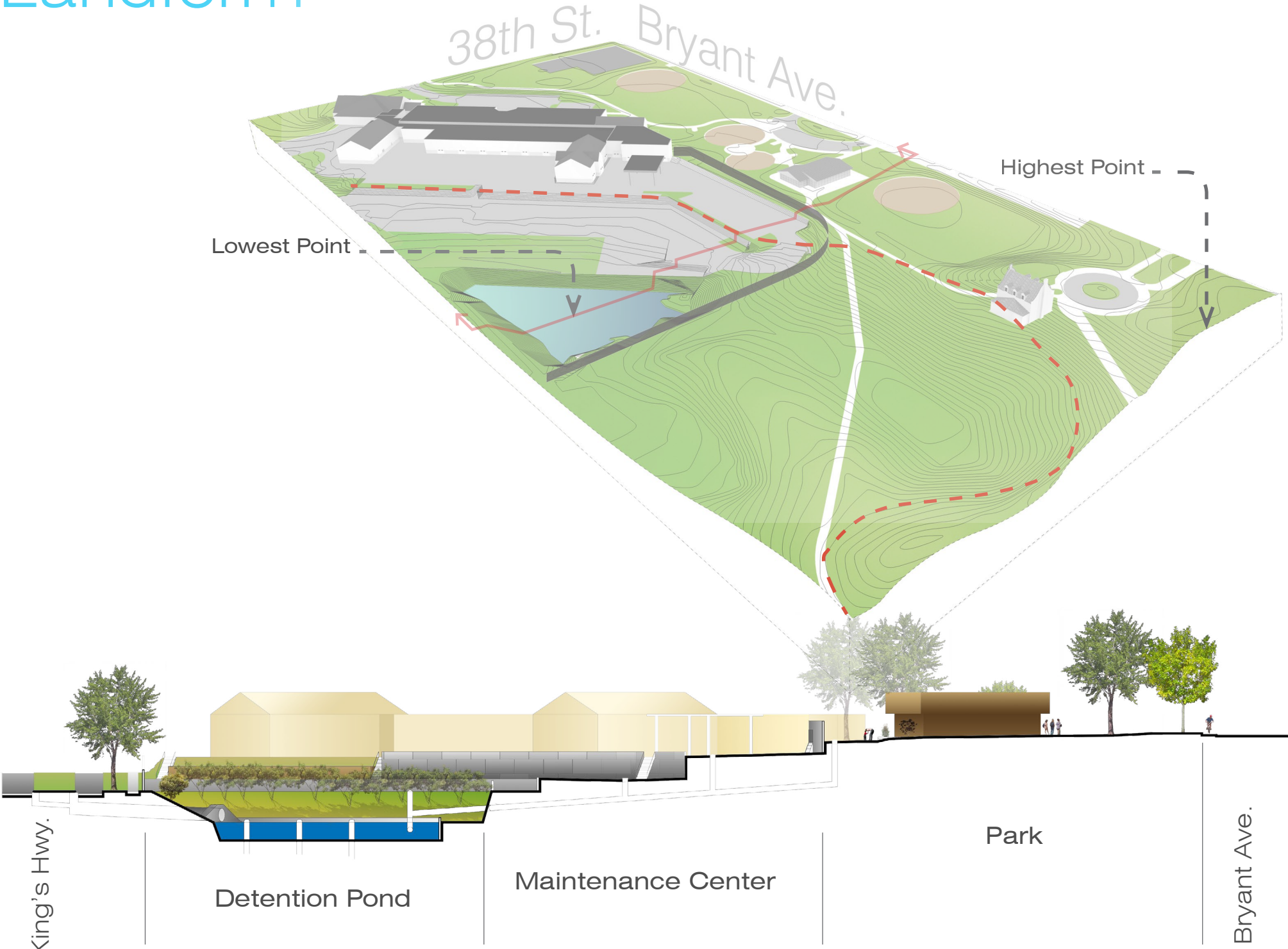

Runoff Volume

Roof - 2 acres = 12%
Asphalt - 5 acres = 31% } **42% Impervious**

Turf - 5.5 acres = 33%
Wooded - 4 acres = 24% } **68% pervious**

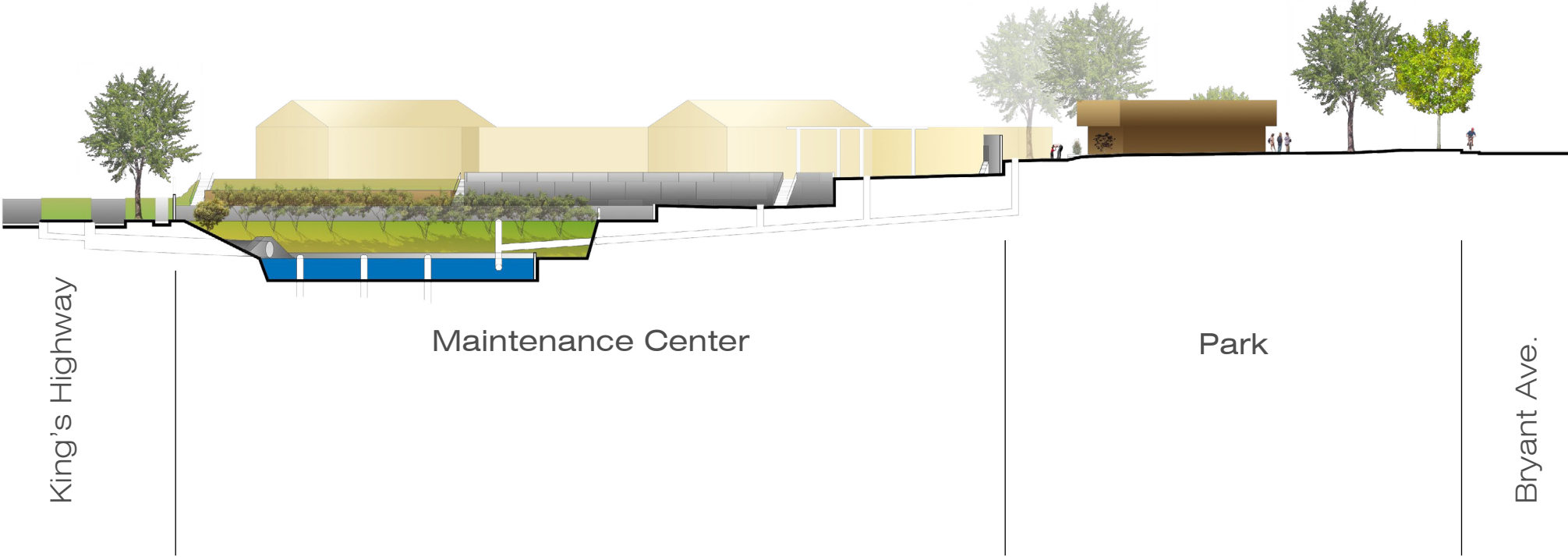
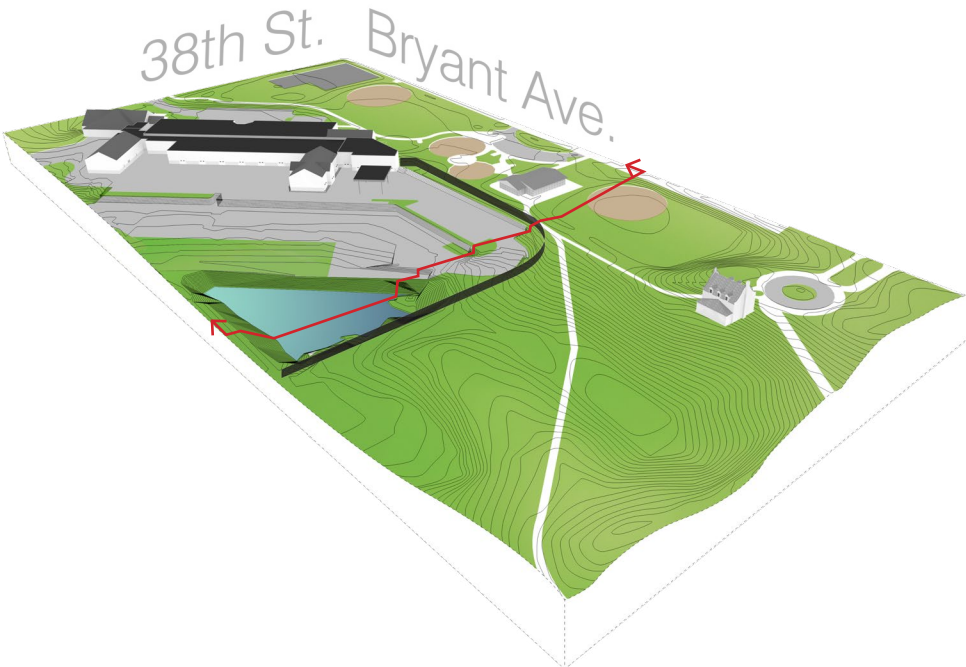

0' 5' 10' 25' 50' 100'

Runoff Volume

Annual [29.1 inches]

22.4 ac =

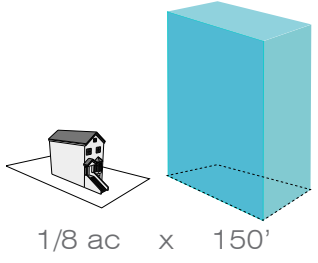

First Flush [.5 inches]

.4 ac =

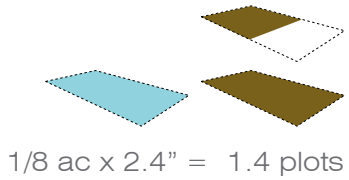

2yr / 1hr [1.25 inches]

1 ac =

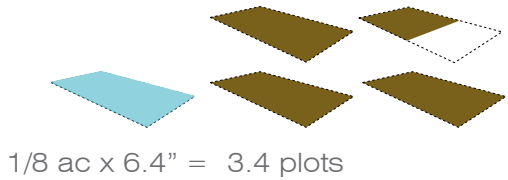

Common
Single
Event
Range

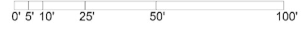
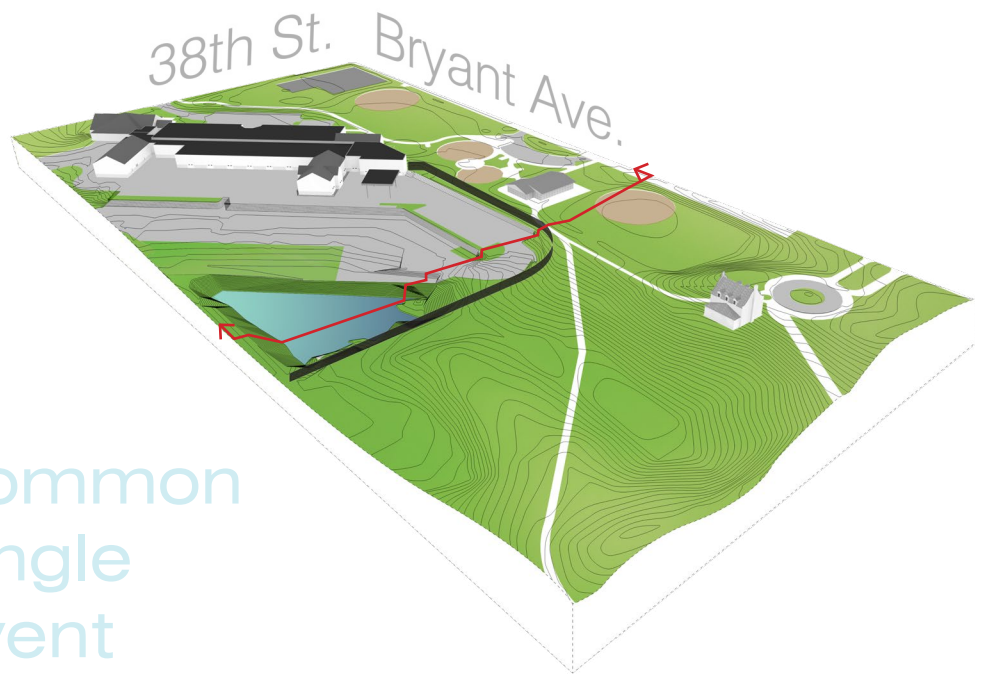

Runoff Cost

Water Use [122,860 gallons]

\$ 490

Sewer [122,860 gallons]

\$ 490

Stormwater

\$ 2,275

+

\$ 3,275

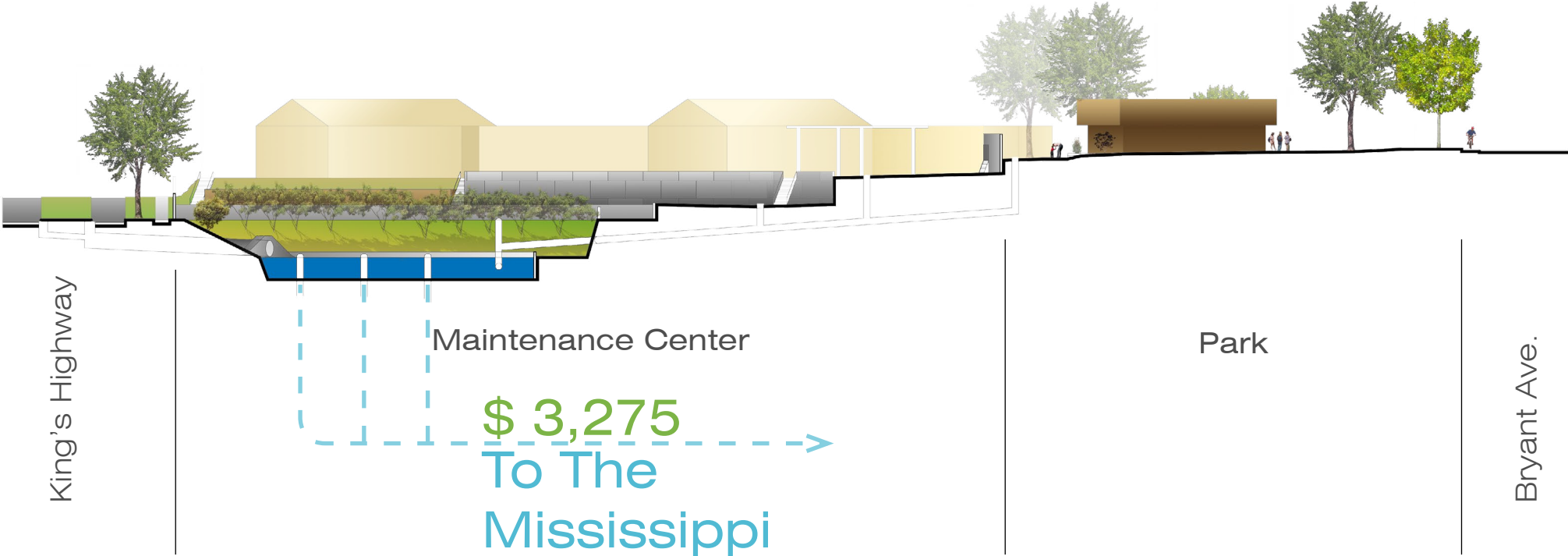
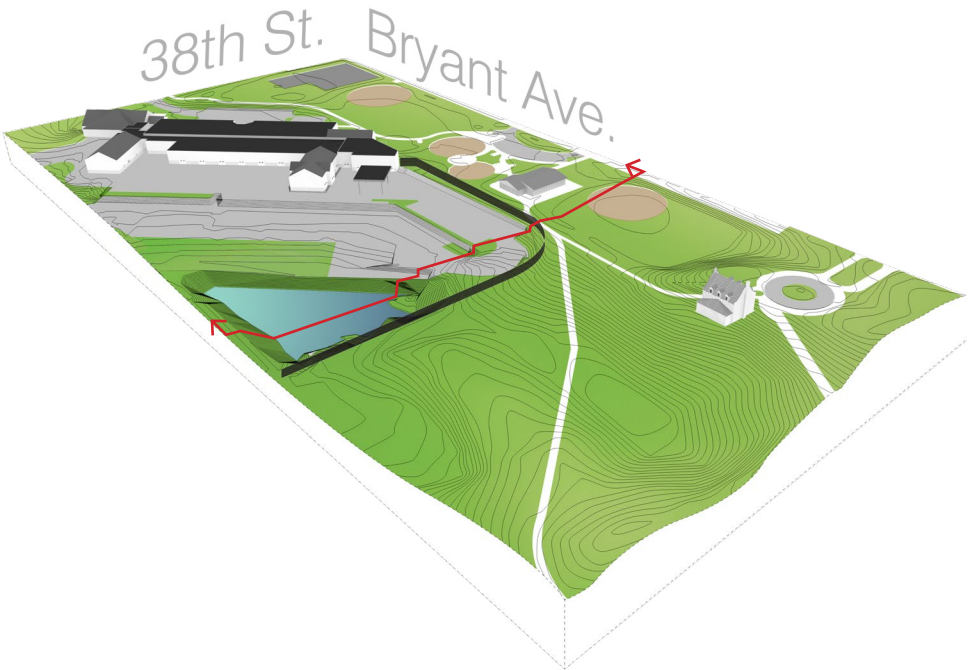

0' 5' 10' 25' 50' 100'

Pollution

Roof - 2 acres = 12%
 Asphalt - 5 acres = 31%

42% Industrial
 Industrial Pollution [heat, sediment, heavy metals]

Turf - 5.5 acres = 33%
 Wooded - 4 acres = 24%

68% Park
 Park Pollution [nutrients, sediment, organic waste]

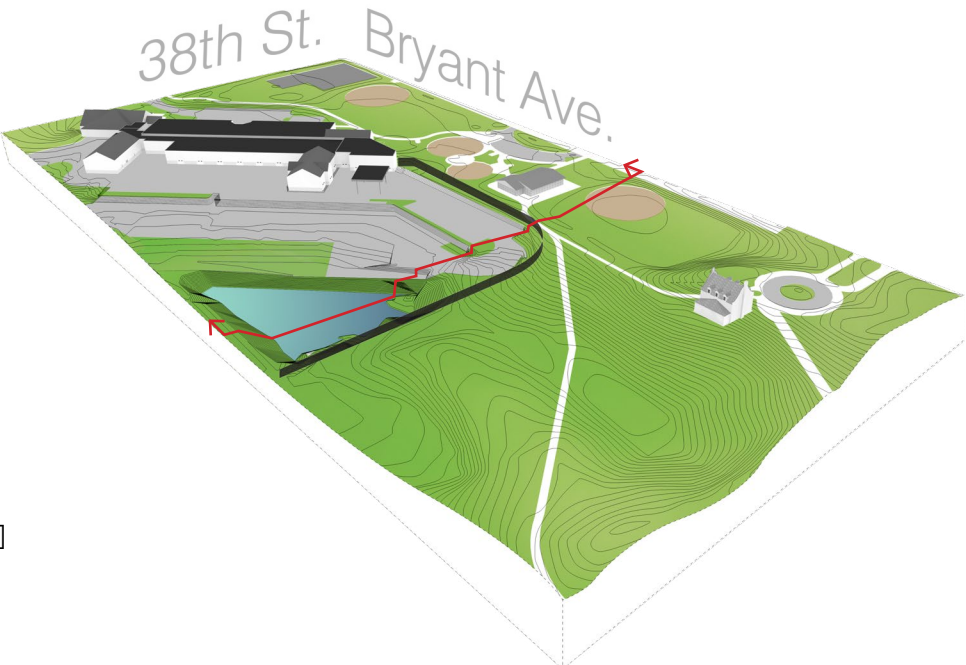

Solution

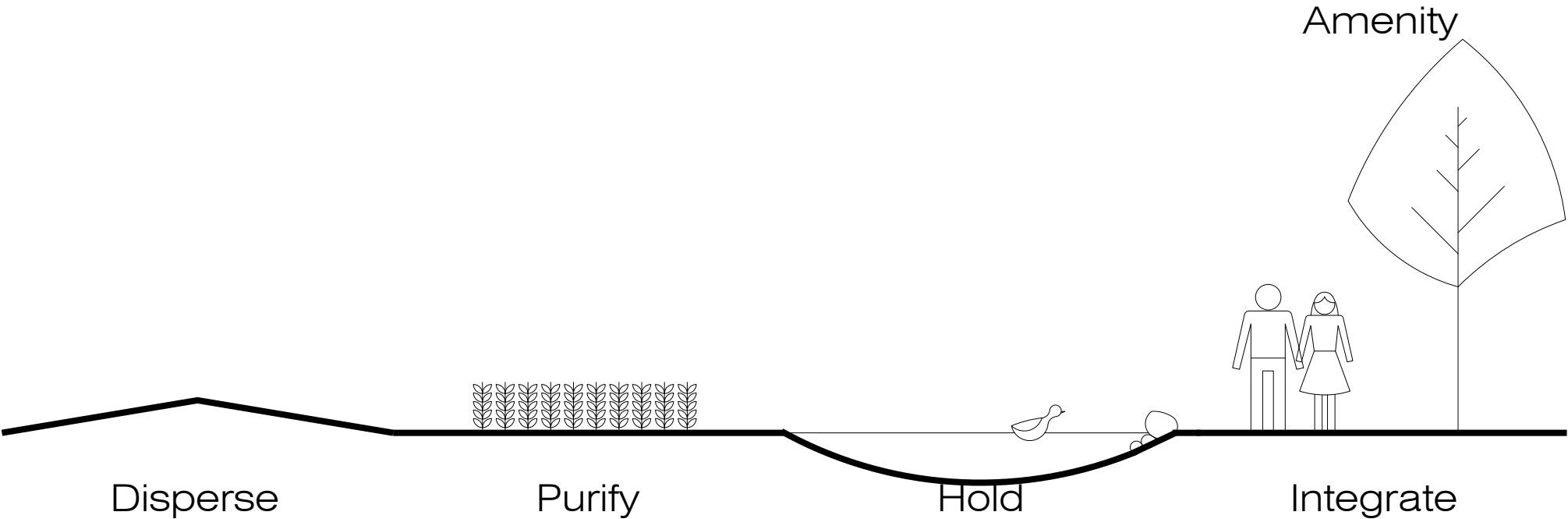
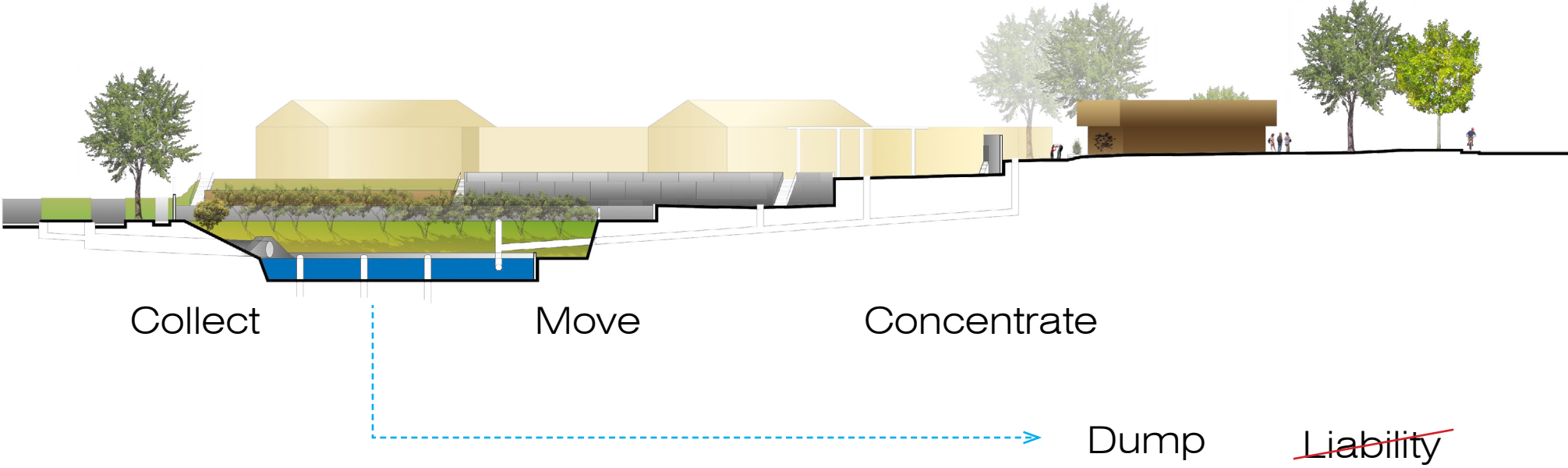

Solution

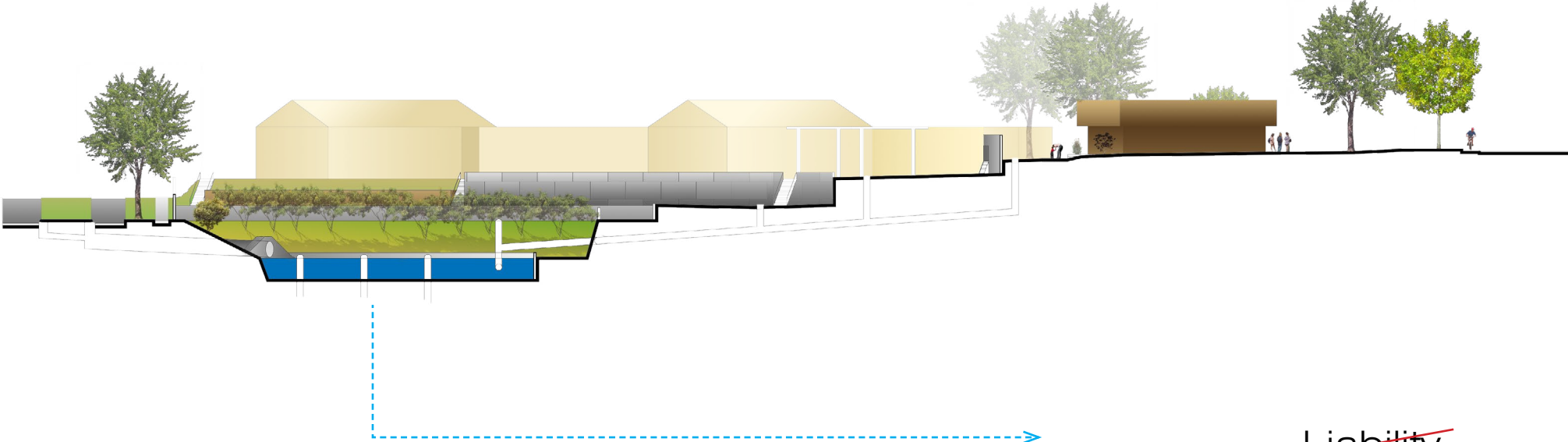

~~Liability~~

Amenity

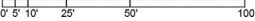
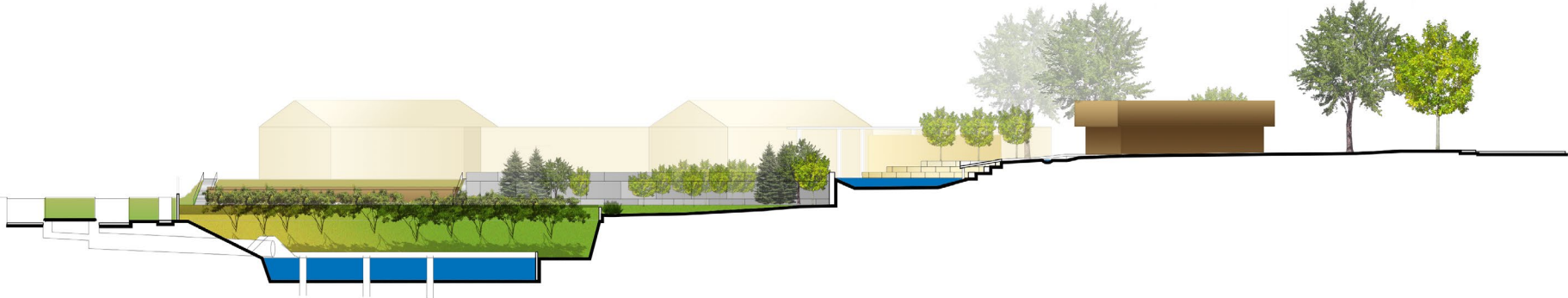

Primary Elements

Impervious

- 15%

Runoff

- 17 %

Annual on site

Runoff

- 100 %

10 yr storm

Dog Park Improvements

- Pond
- Raingardens
- Paved Paths
- Parking

Demonstration Pond

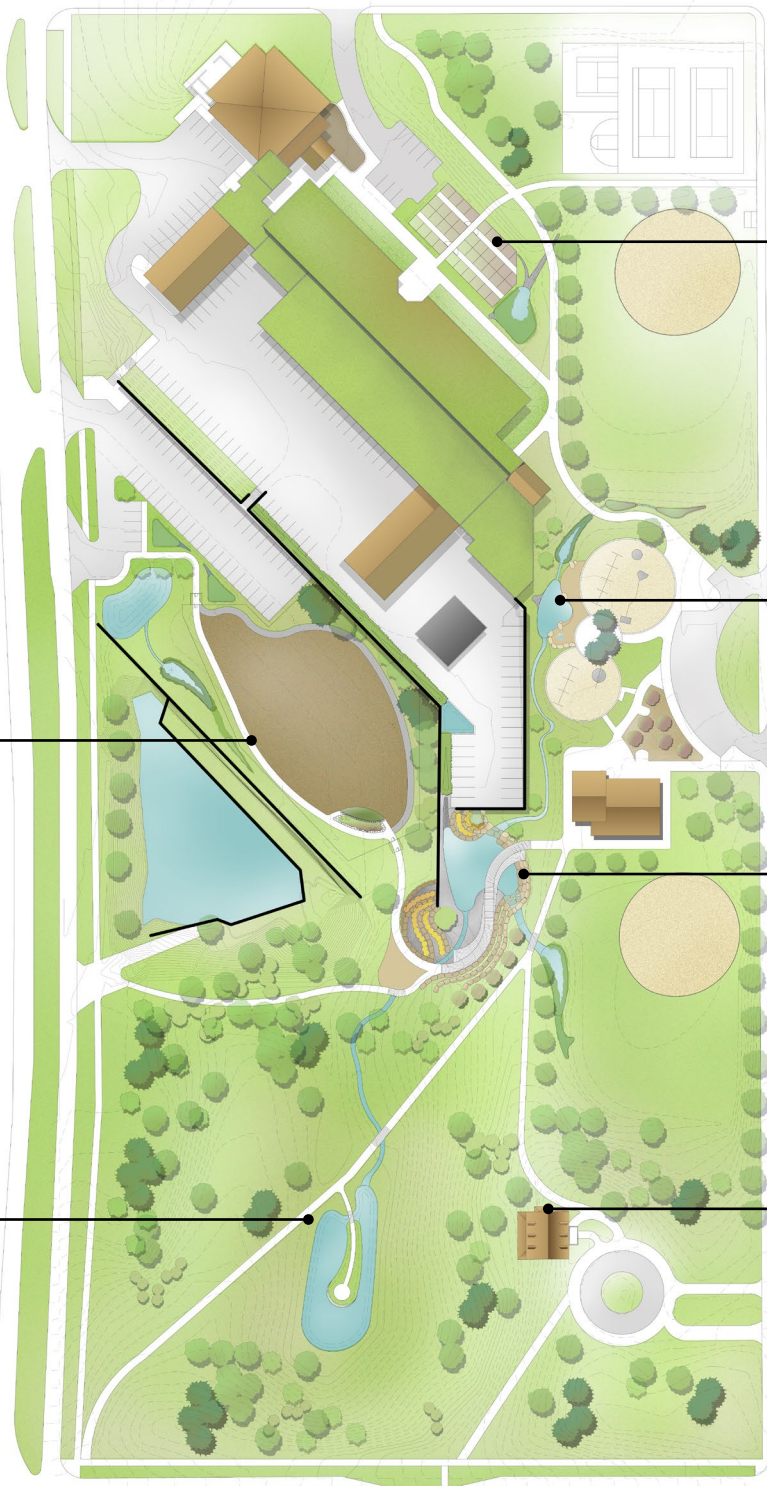

Community Garden

- Community Plots
- Rain garden
- 20 gal. Cistern

Splash Pad

- Interactive water jet
- wading pond
- Raingardens

Boardwalk Area

- Water falls
- Rock Garden
- Overlook

Historic Park

- Picturesque Pond
- Parks

Secondary Elements

Roof Improvements

- Extensive Green Roof
- Cistern 20,000 gallons

Parking Lot Improvements

- Raingardens/ Bio-Swales
- "Spots-for-Plots" Program

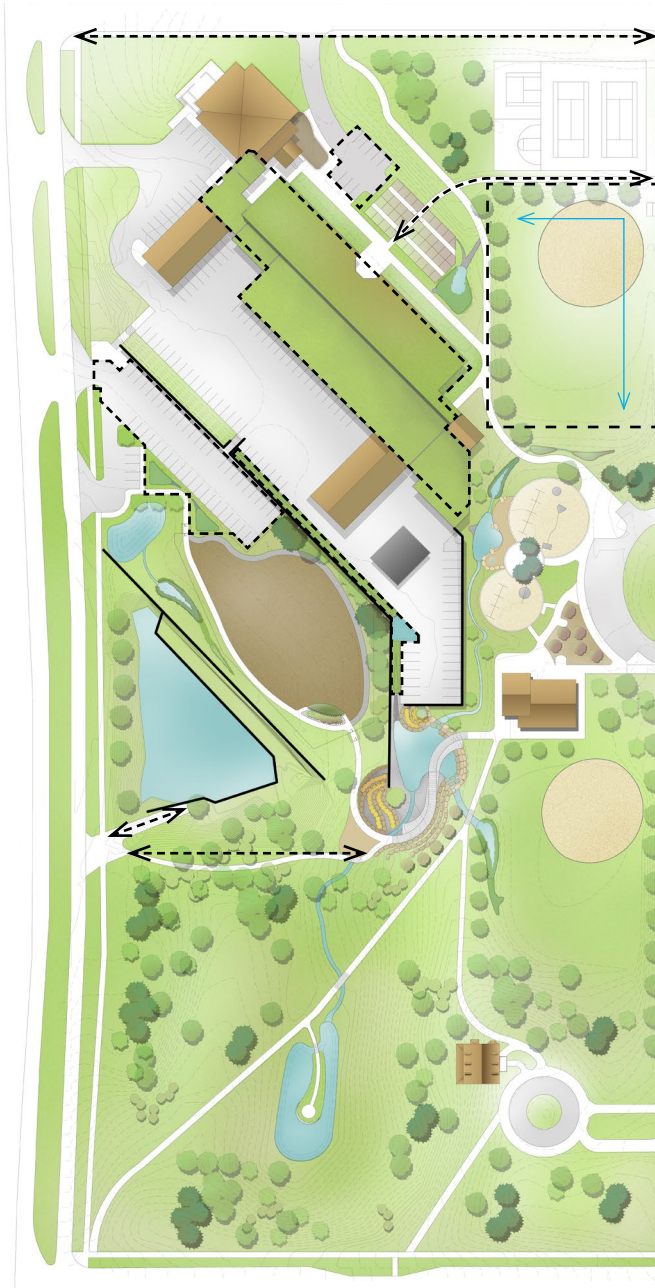

Field Improvements:

- Re-graded
- Trees added

Path Additions:

- Along 38th St
- Bus Stop to Service Center
- Outlook to King's Highway
- Re-surface path to Existing Pond

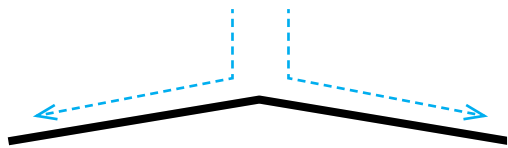
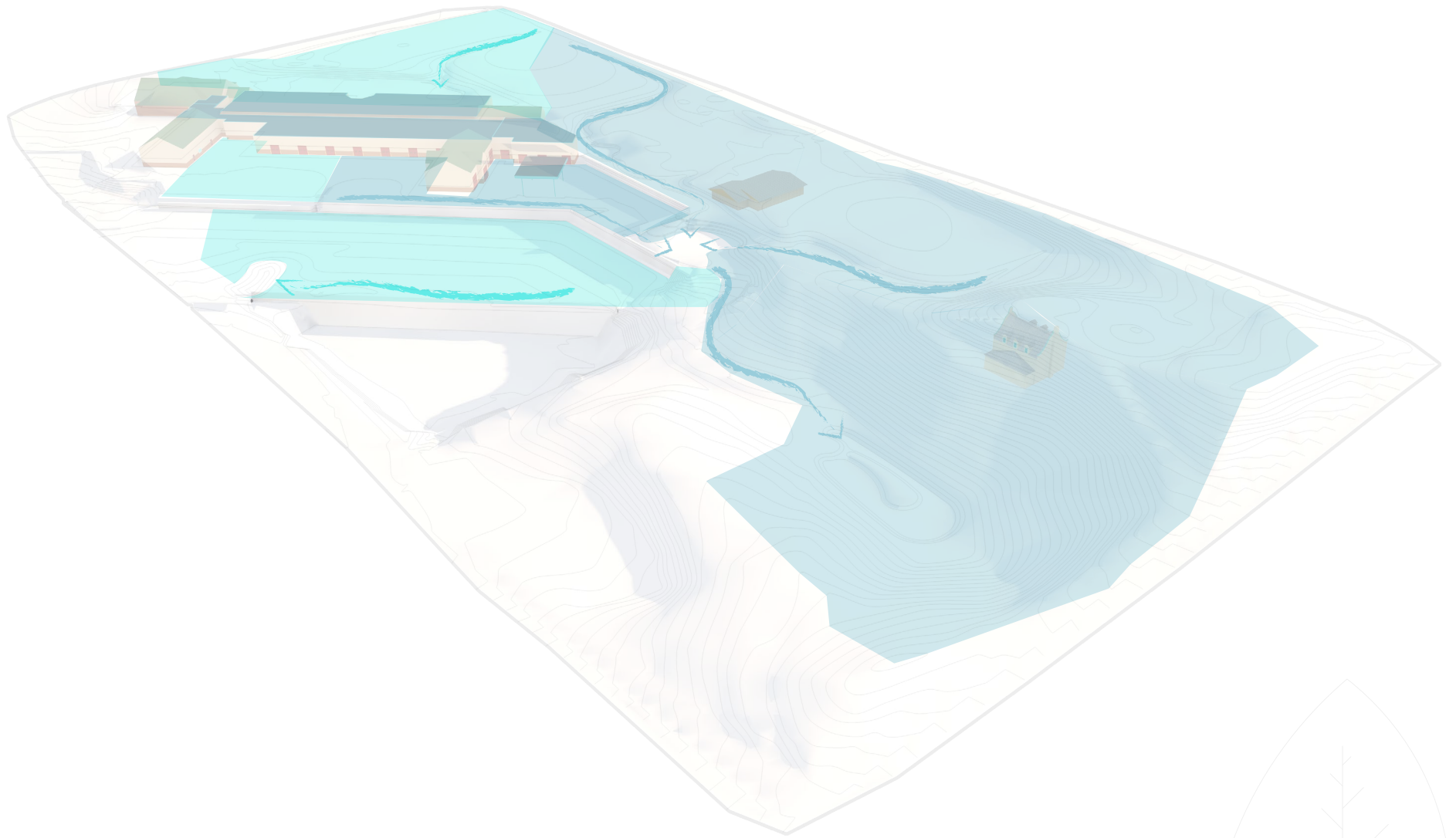

Disperse



Purify



Hold



Integrate



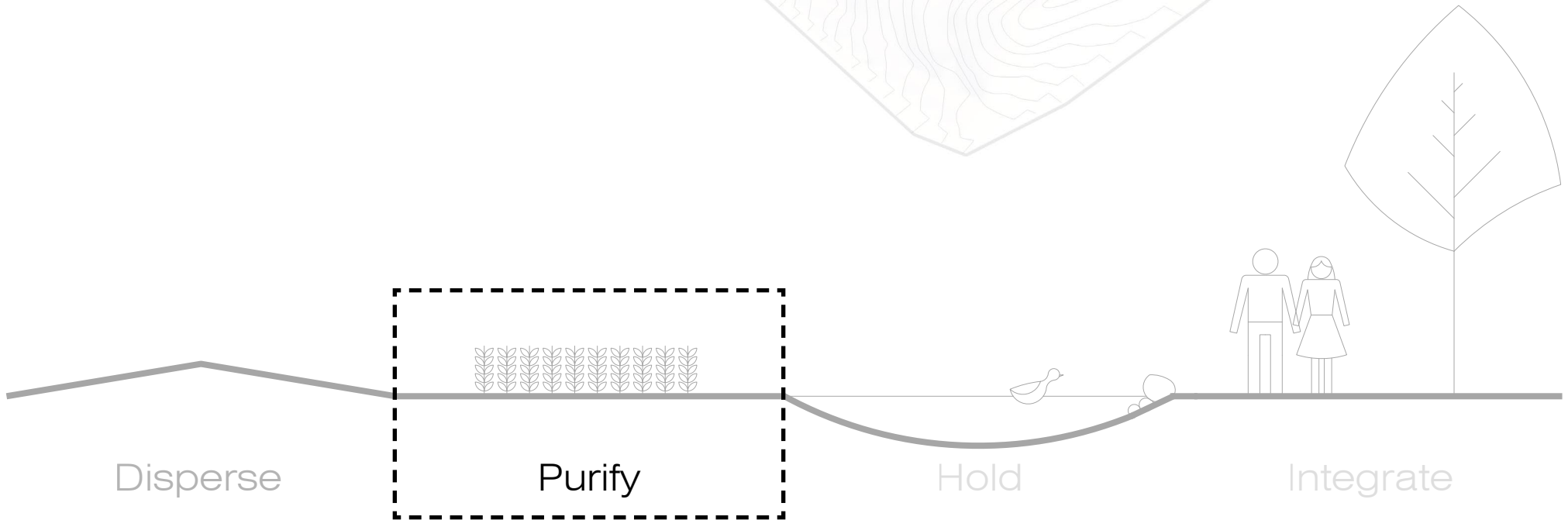
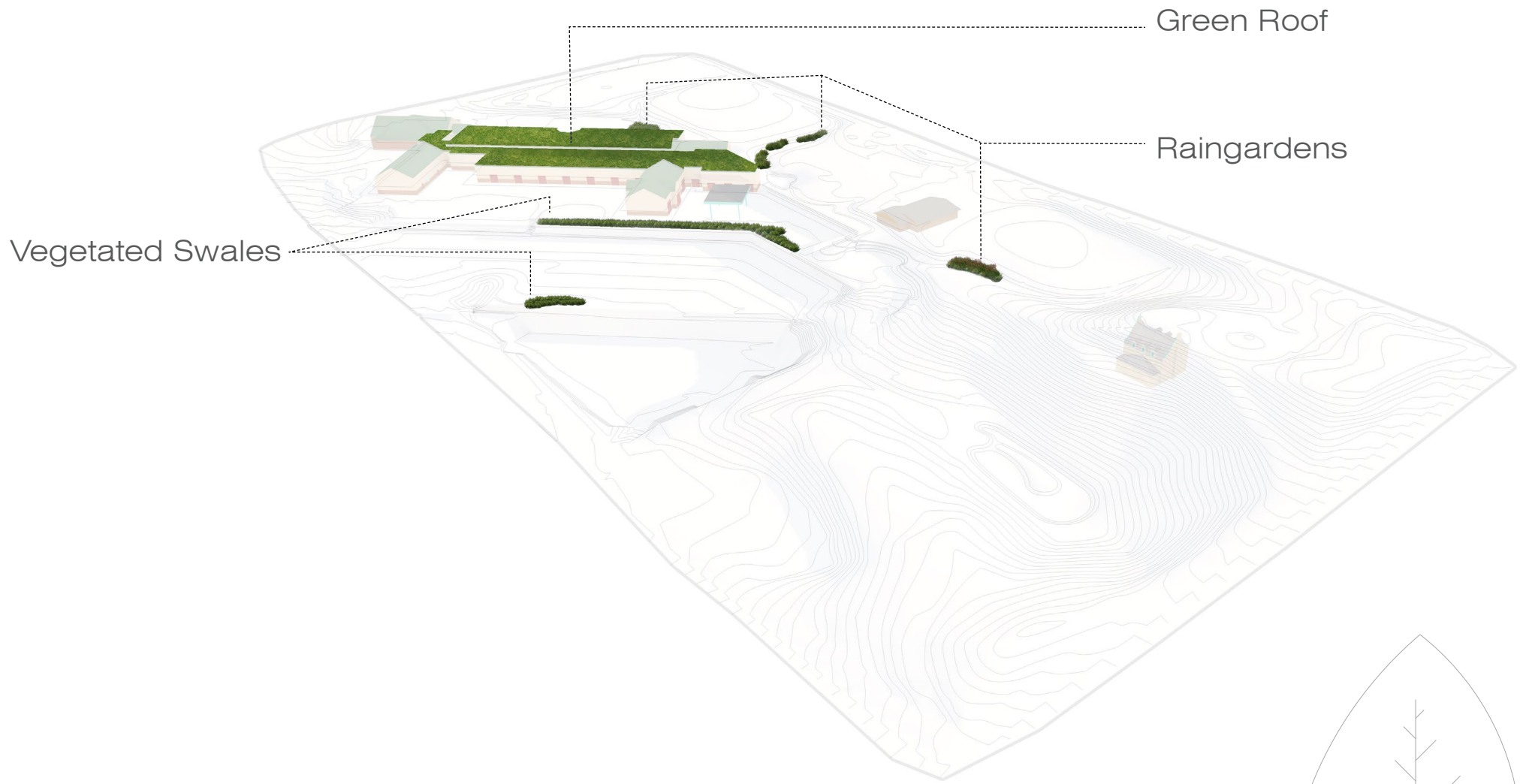

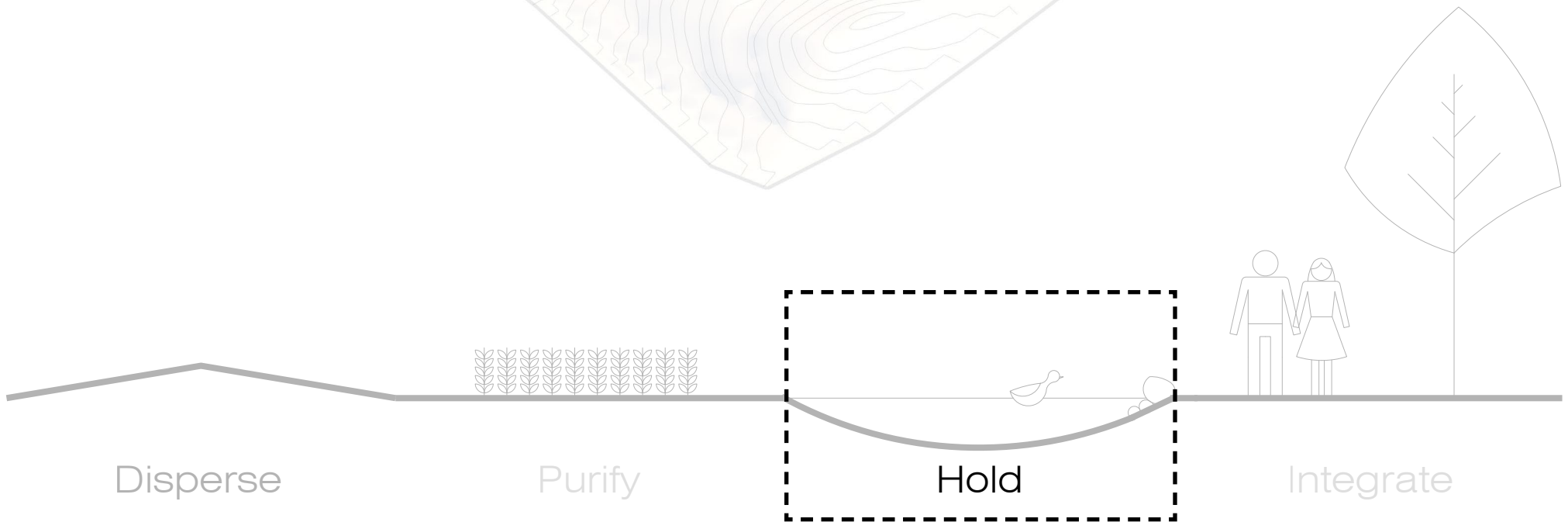
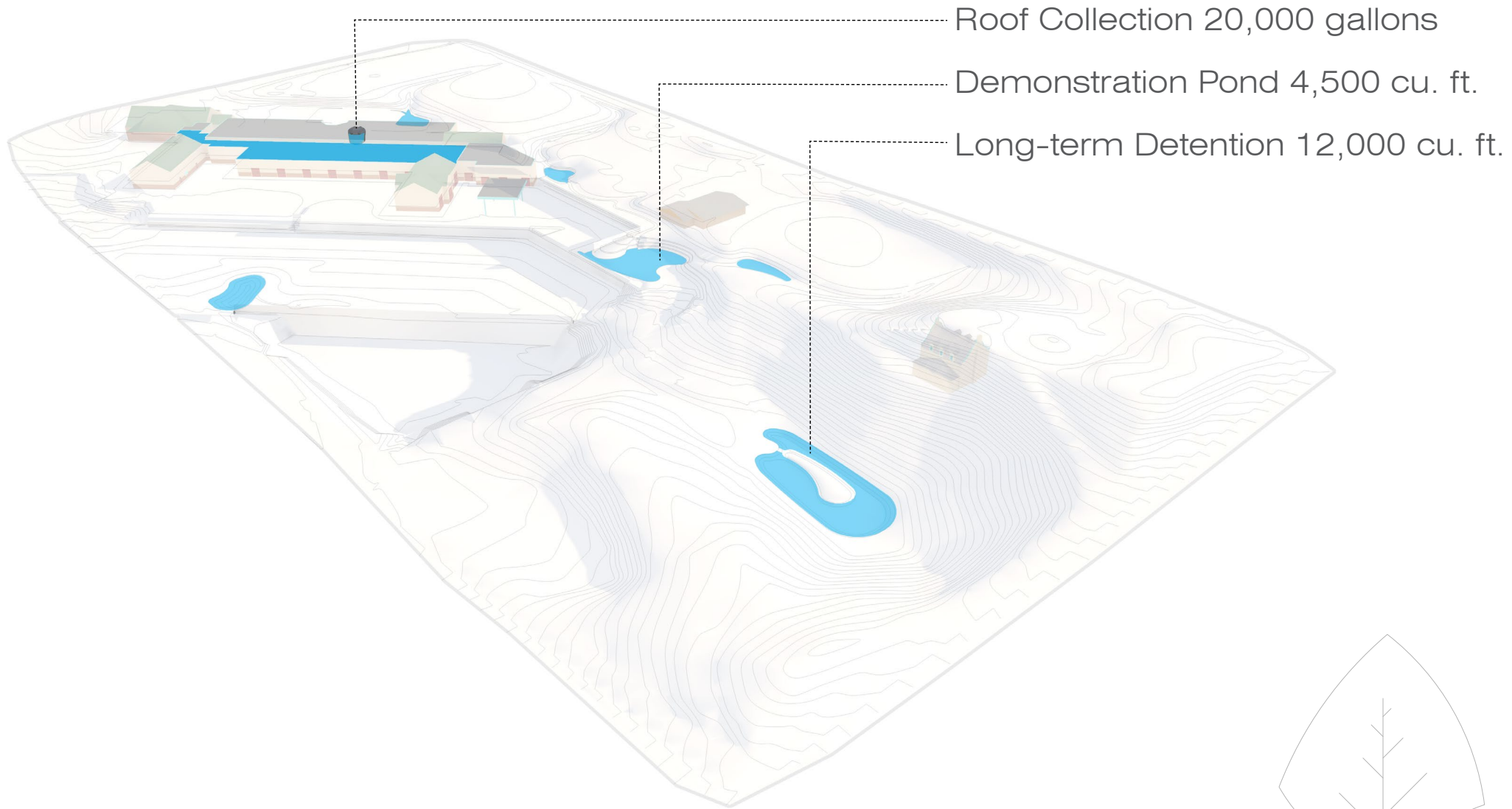

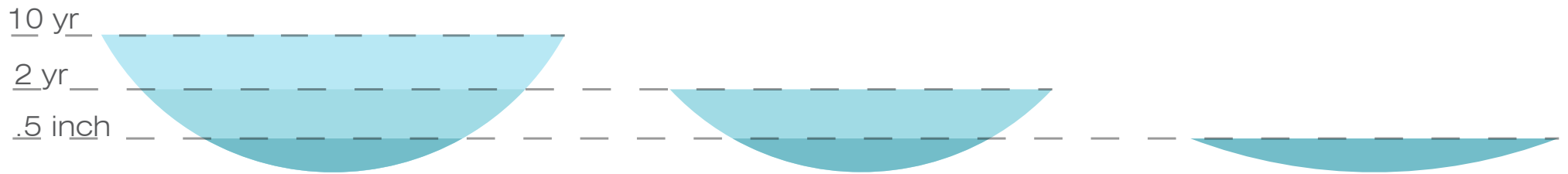
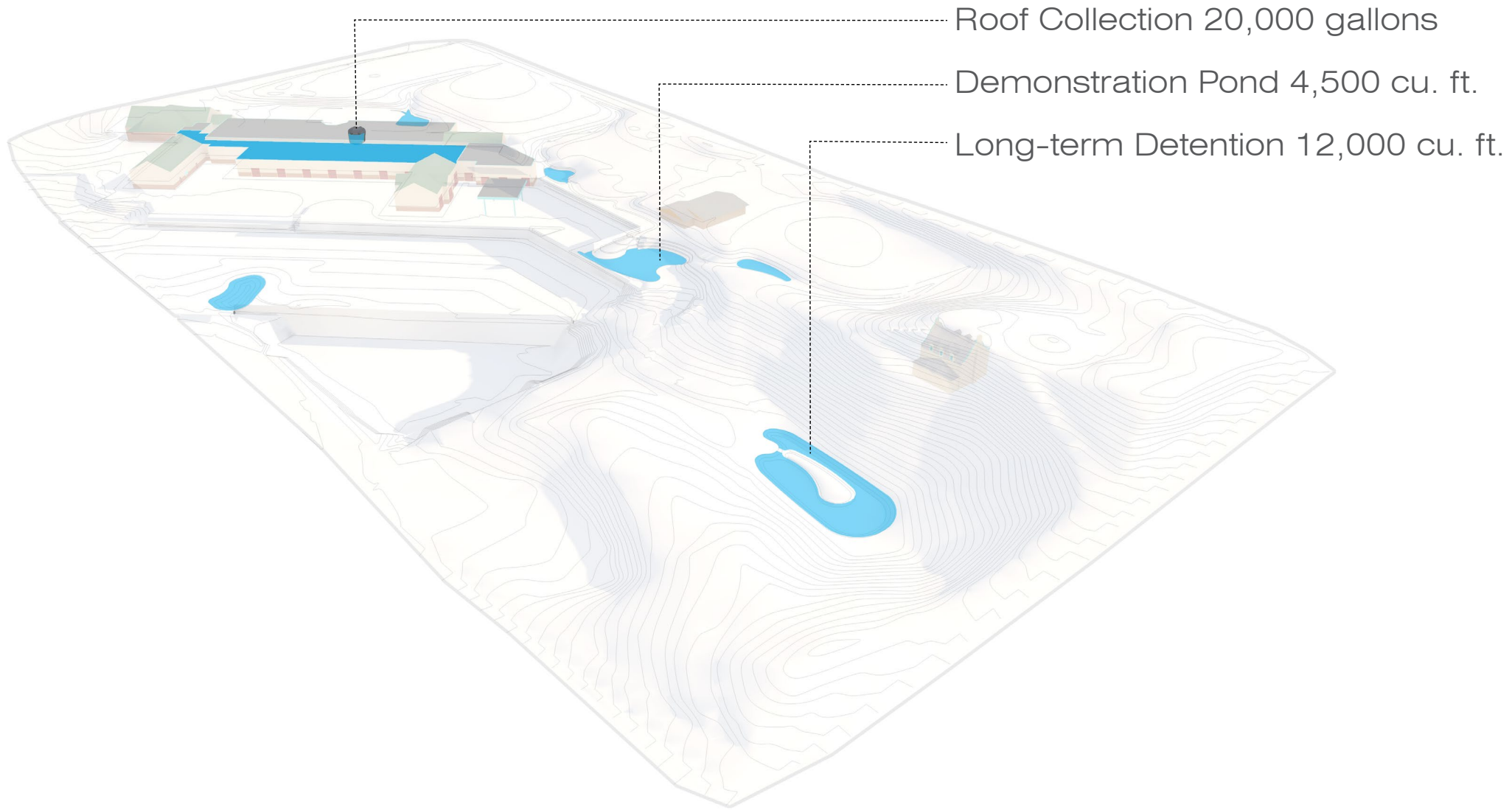

Cistern/Community Garden

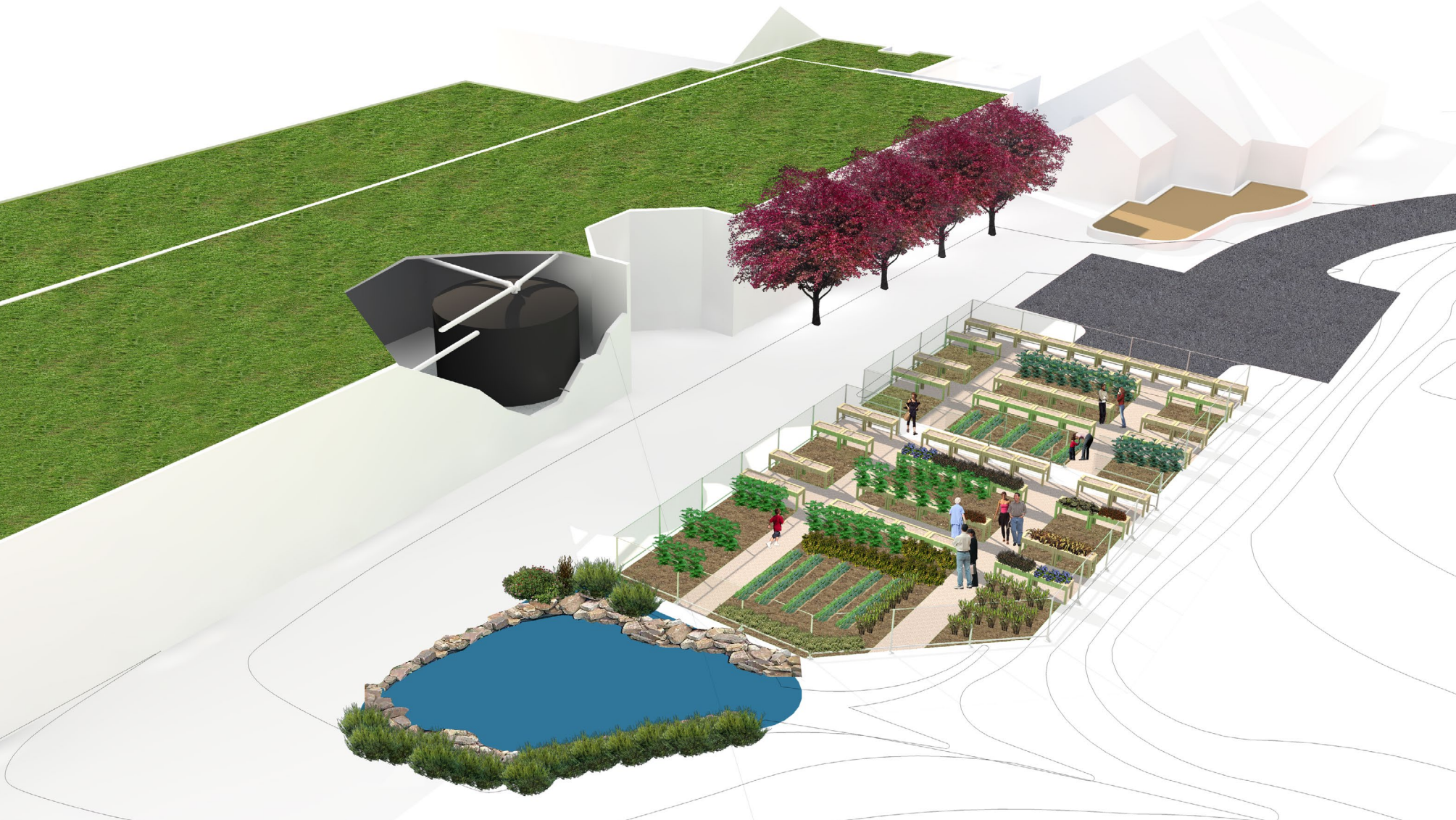

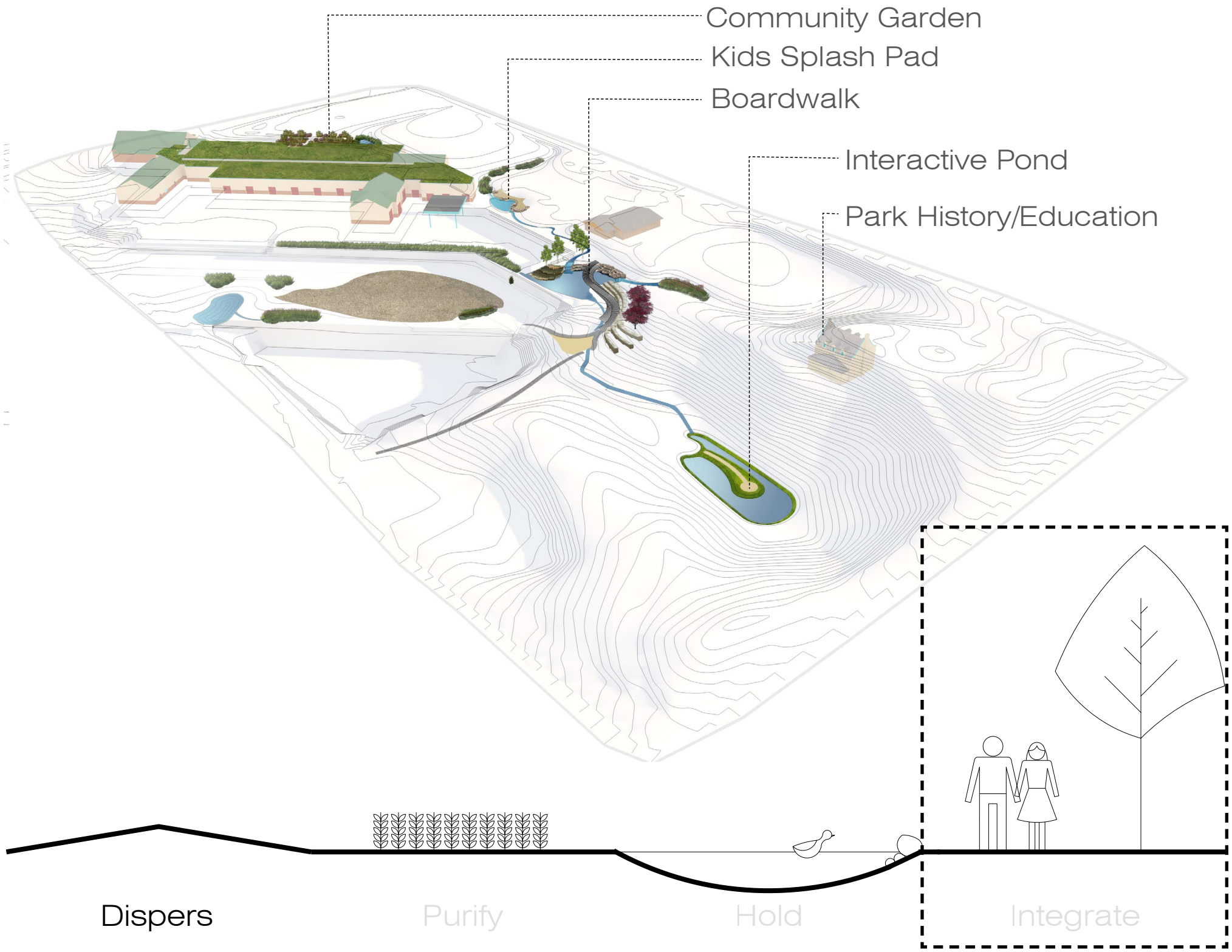

Community Garden

Kids Splash Pad

Boardwalk

Interactive Pond

Park History/Education

Dispers

Purify

Hold

Integrate

Boardwalk



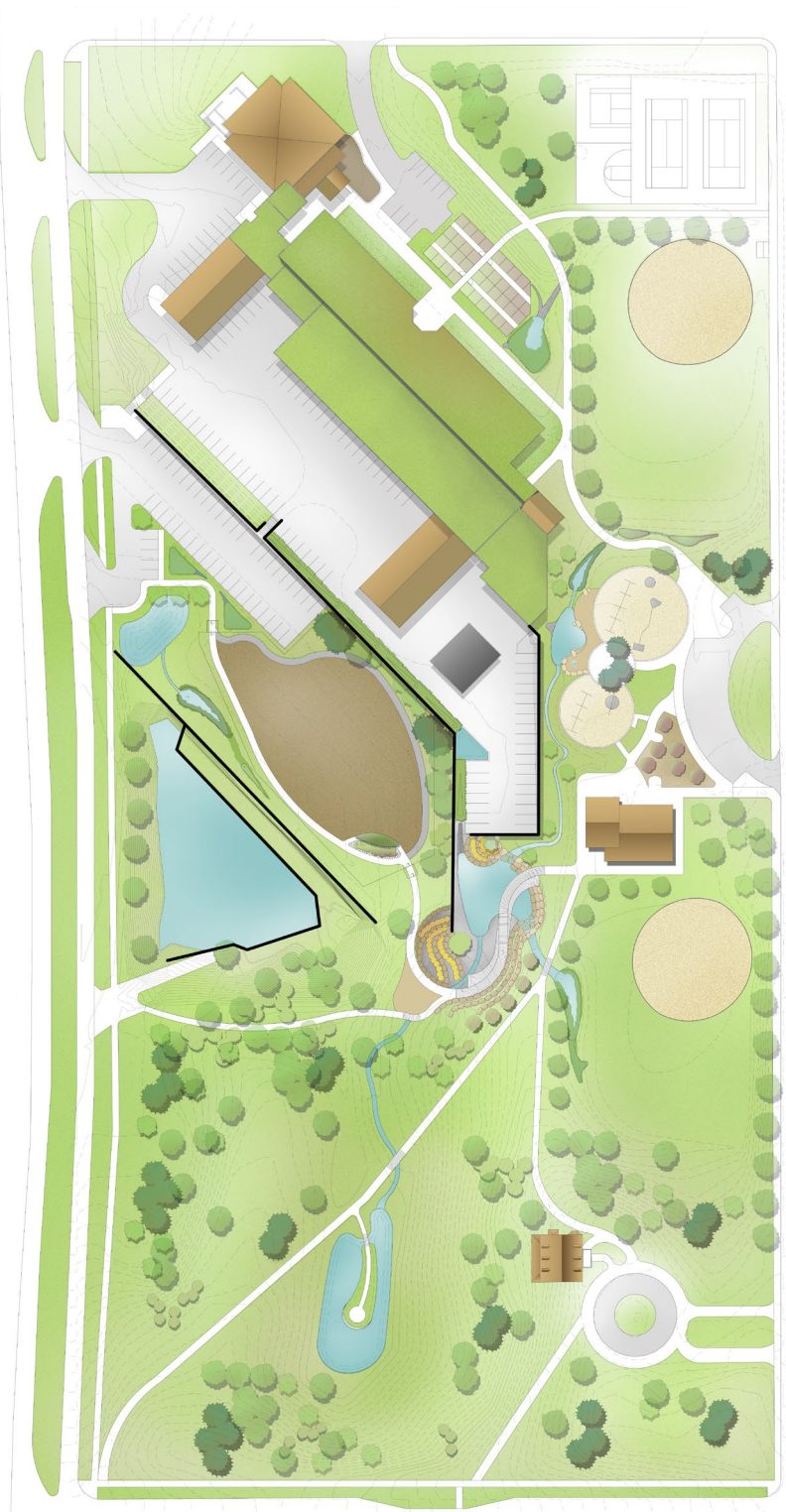
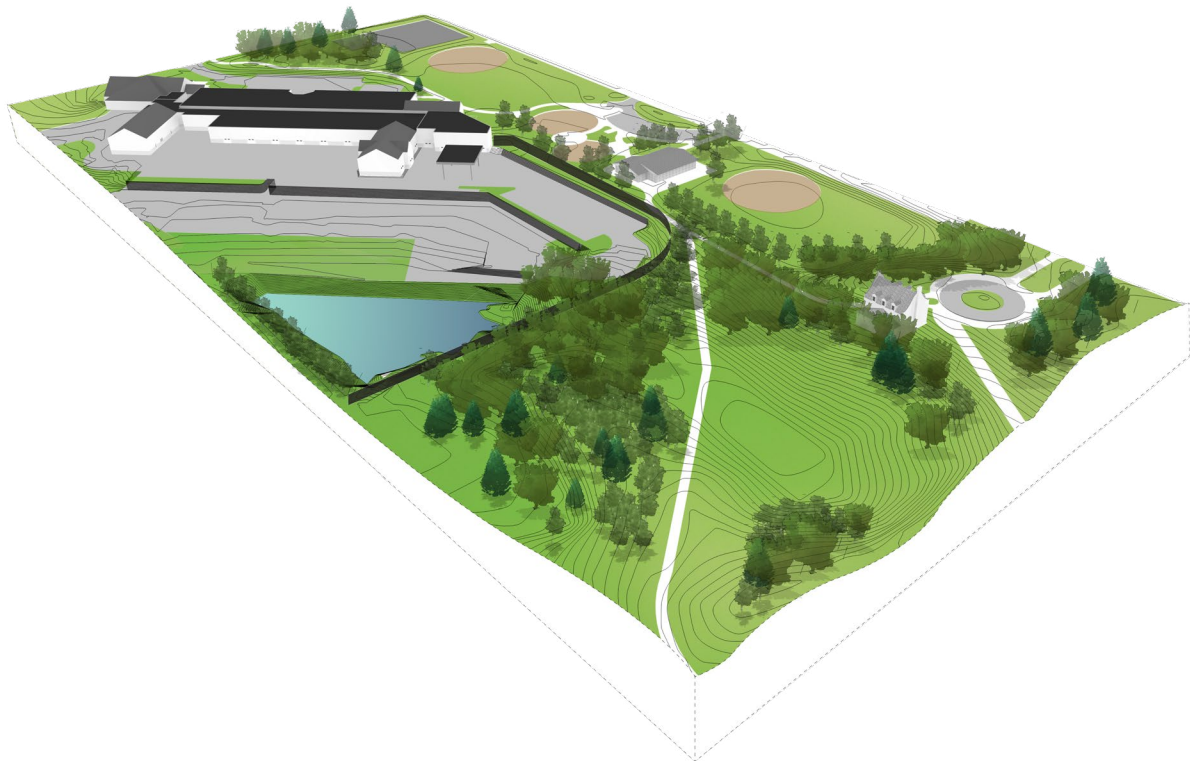

Impervious

- 15%

Runoff

- 17 %

Annual on site

Runoff

- 100 %

10 yr storm

Dog Park Improvements

- Pond
- Raingardens
- Paved Paths
- Parking

Demonstration Pond

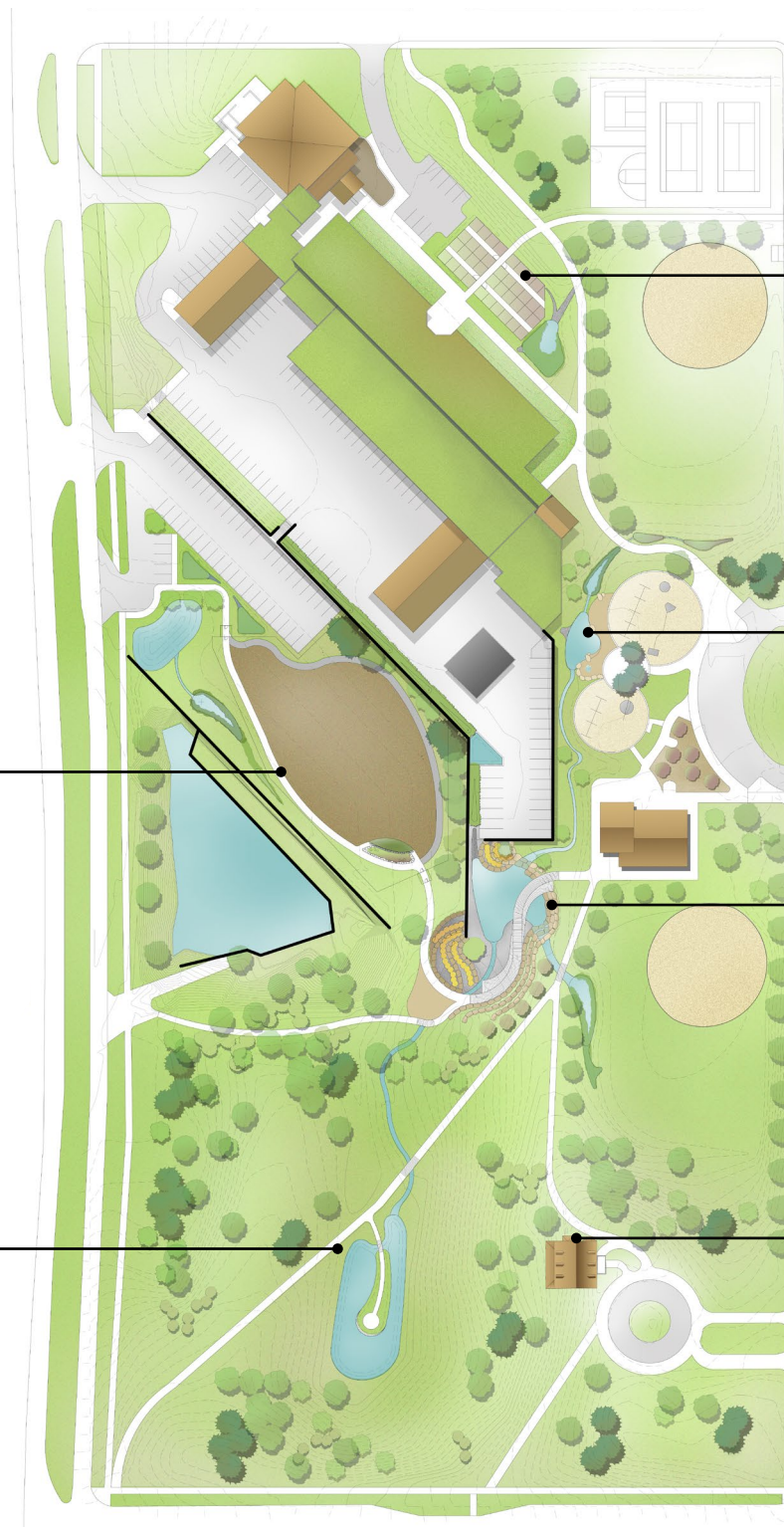

Community Garden

- Community Plots
- Rain garden
- 20 gal. Cistern

Splash Pad

- Interactive water jet
- wading pond
- Raingardens

Boardwalk Area

- Water falls
- Rock Garden
- Overlook

Historic Park

- Picturesque Pond
- Parks