

# EMERGING CONNECTIONS

Developing Transit Corridors in Minneapolis - St. Paul

North Dakota State University | Spring 2014 | Colby Judovsky and Nathan Stottler



# SITELLOCATION

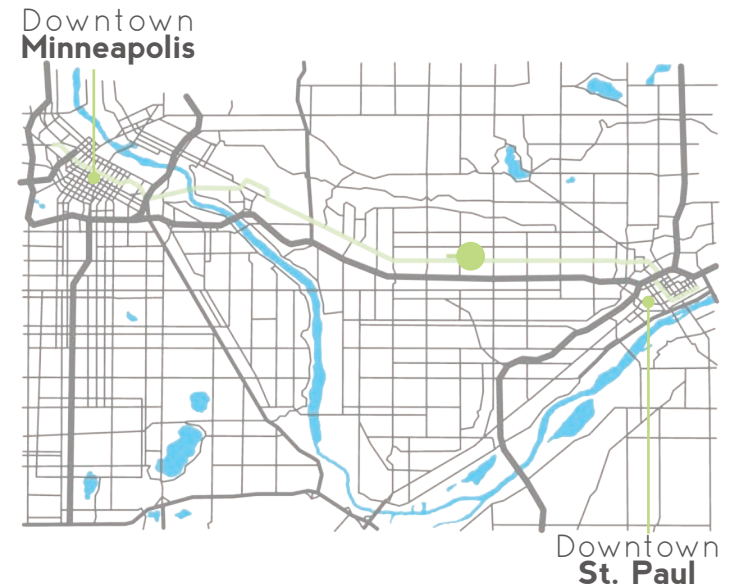
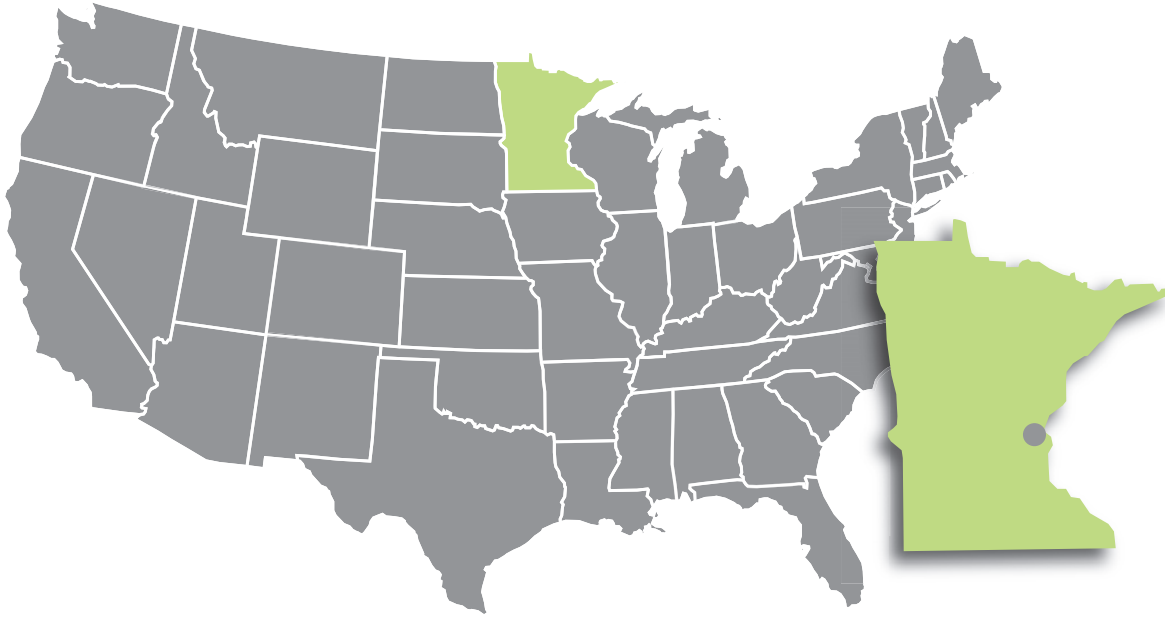

## THEORETICAL PREMISE

Our work explores the design of a public square and transit station at the intersection of University Avenue and Hamline Avenue in the Hamline-Midway neighborhood of St. Paul, Minnesota. Our focus is on responding to the need for transit-oriented development (TOD) through the exploration of the neighborhood place making principles of identity and growth. This focus upon identity and growth at the neighborhood scale allows us to define methods for improving transit corridor connections between major urban centers. Our secondary focus is on the collaboration of architecture and landscape architecture and how they work together to accomplish environmental design goals.

## PROBLEM STATEMENTS

What defines identity, and how can environmental design capitalize on it to influence transit-oriented development in a historically transit-based neighborhood?

How can the design of a public square and transit station influence the growth of transit-oriented development in a historically transit-based neighborhood?

# SPACE OR PLACE

## **Shamsuddin and Ujang**

Place Attachment - Interaction and Involvement

- Accessibility and Legibility
- Vitality and Diversity
- Transaction, Distinction and Comfort

## **Christian Norberg-Schulz**

Place Identity - Landscape and Settlement

- Things
- Cosmic Order
- Character
- Light
- Temporal Rhythms
- Location
- Spatial Configuration
- Articulation

# PLACEATTACHMENT



## ACCESSIBILITY AND LEGIBILITY

ADA AND UNIVERSAL DESIGN  
CONNECTION  
IDENTIFICATION AND UNIQUENESS

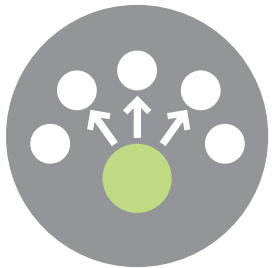

## VITALITY AND DIVERSITY

VARIETY OF PRODUCTS AND SERVICES  
VARIETY OF ACTIVITIES



## TRANSACTION, DISTINCTION COMFORT

PERSON TO PERSON INTERACTION  
VARIETY OF PRODUCTS AND SERVICES  
VARIETY OF SCALED SPACES  
DESIGNATION OF PUBLIC VS PRIVATE



# PLACEIDENTITY: LANDSCAPE



## THINGS

NATURAL MATERIALS  
BEDROCK OF PLACE

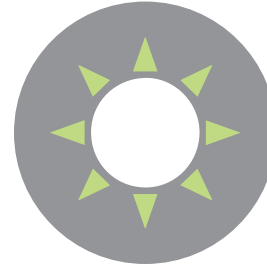

## LIGHT

ILLUMINATION  
SYMBOL OF HOLINESS



## COSMIC ORDER

PATH OF THE SUN  
ORIENTATION ALONG AXIS  
N, S, E, W



## TEMPORAL RHYTHMS

CONSTANTLY CHANGING  
SUN, WEATHER,  
TIME, VEGETATION, SEASONS

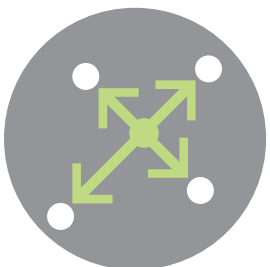

## CHARACTER

DEFINED BY MISSISSIPPI RIVER  
LINEAR SITE  
TRANSITION ZONE  
FACILITATE PEOPLE

# PLACE IDENTITY: SETTLEMENT



## LOCATION

DERIVES FROM ANALYSIS  
MOST IMPORTANT



## SPATIAL CONFIGURATION

ORIENTATION OF SPACES  
SPACES MUST WORK TOGETHER  
COMFORT AND SECURITY



## ARTICULATION

ROOTED IN THE CULTURE OF PLACE  
LANGUAGE  
HOW DO WE VIEW PUBLIC TRANSIT?



# HISTORICAL CONTEXT





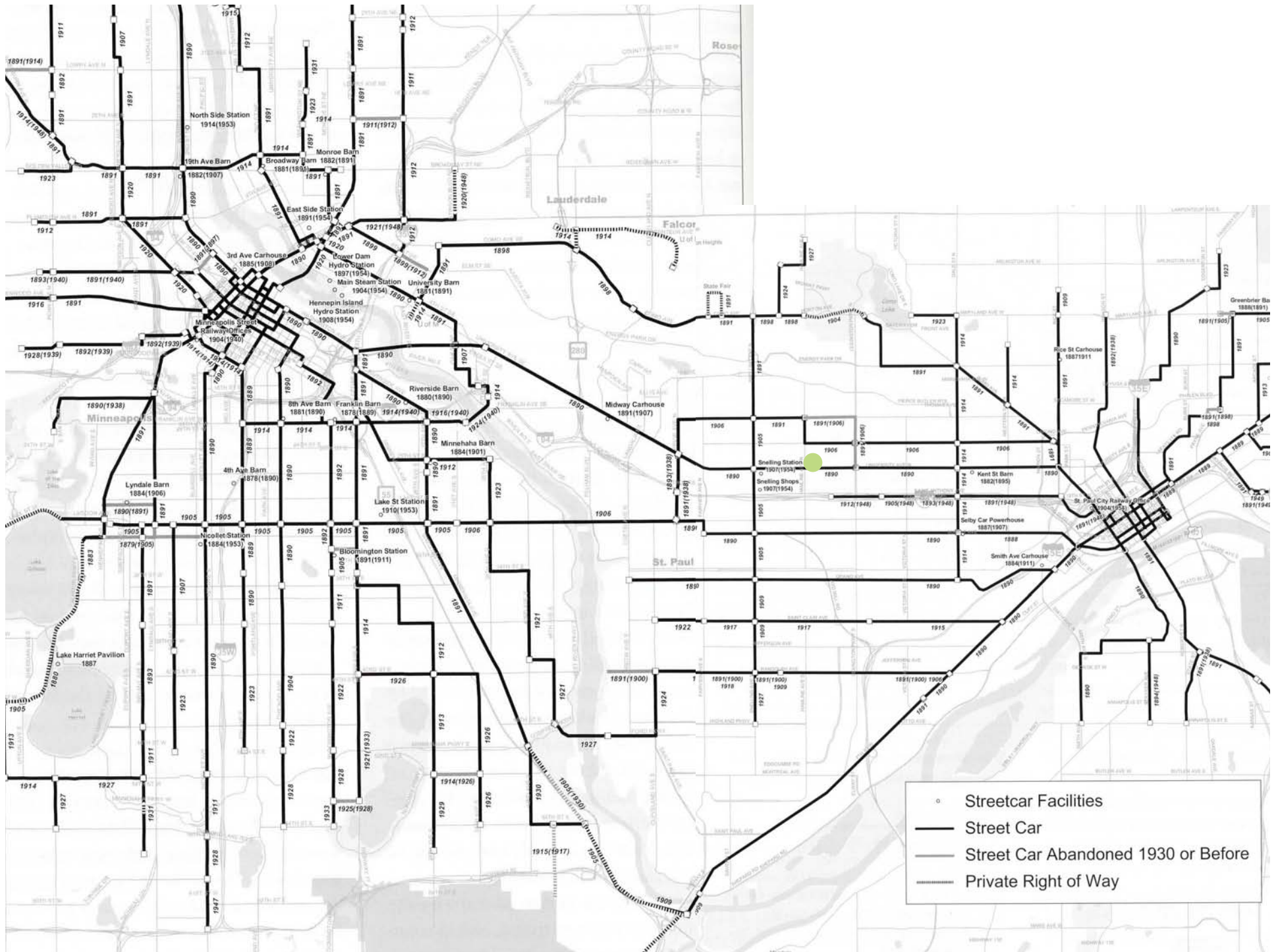

- Streetcar Facilities
- Street Car
- - - Street Car Abandoned 1930 or Before
- ⋯ Private Right of Way







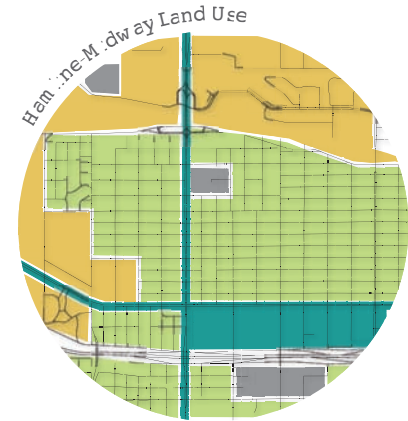
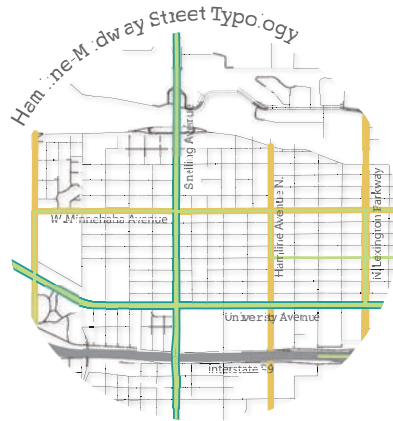
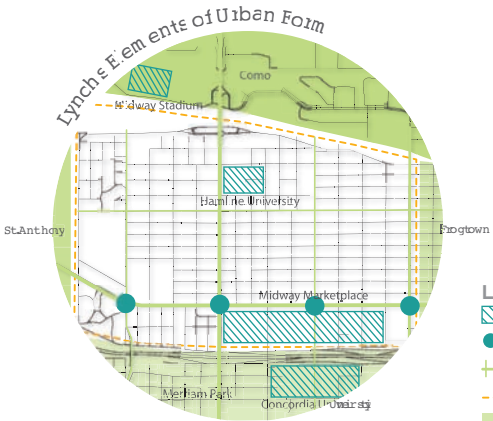
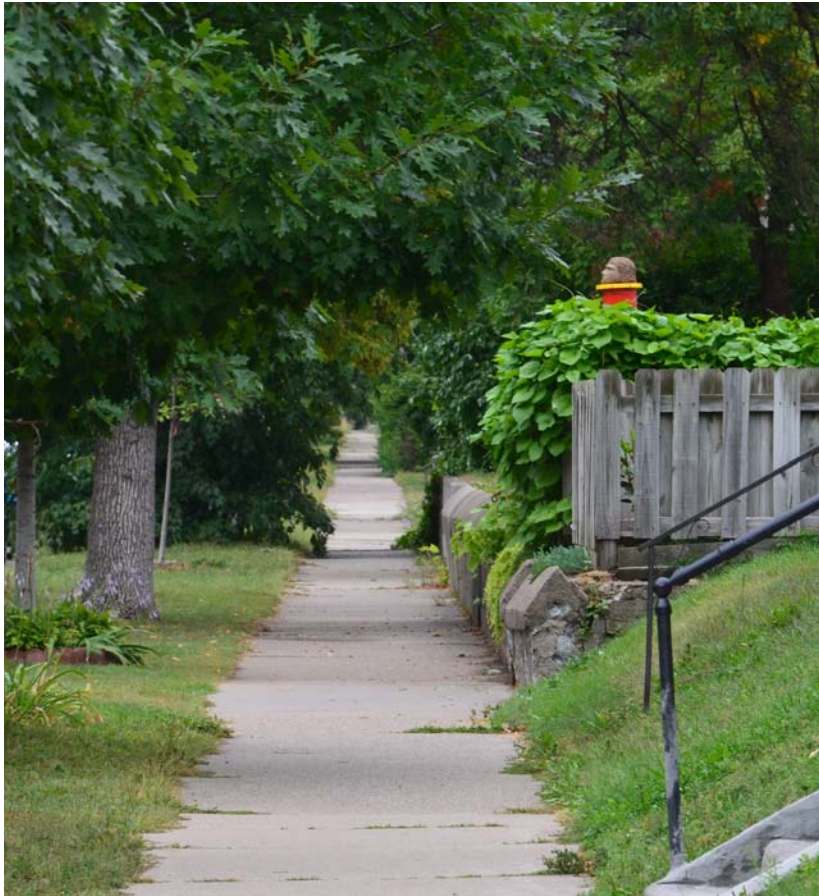



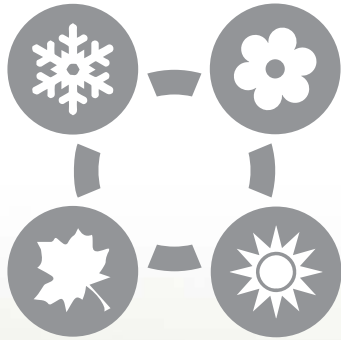

- LEGEND —
- Offices
  - Transit Spaces
  - Public Spaces
  - Retail Spaces
  - Market

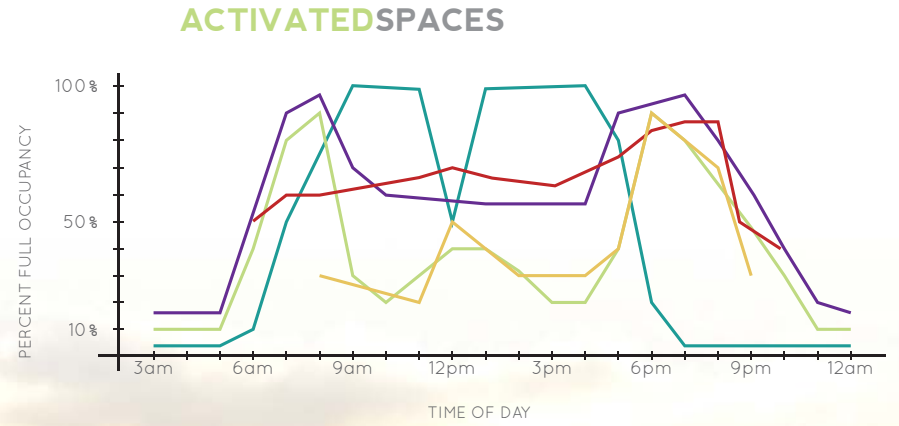

Part Diagram Path and Mode

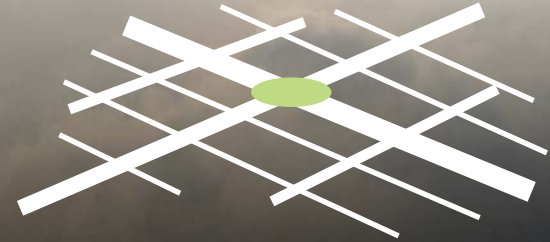

# FIRST LEVEL



- 1** Main Entry + Entry
- 2** Express Cafe
- 3** Cafeteria
- 4** Bus Stop Waiting Lounge
- 5** Metro Transit Ticketing + Security
- 6** Market @ Midway
- 7** The Midway Grill
- 8** Midway Bar + Grill Kitchen
- 9** Storage + Custodial
- 10** Residential Parking
- 11** Green Line Platform
- 12** Skyway Platform Access
- 13** Wheels Bike and Repair Shop
- 14** Mechanical
- 15** Underground Parking Access



# SECOND LEVEL



- 1 Open to Below
- 2 Green Line Waiting Lounge
- 3 Passenger Lounge
- 4 Newspaper + Magazine Sales
- 5 Metro Transit Offices
- 6 The Midway Bar
- 7 The Midway Bar + Grill Patio
- 8 Studio Apartments
- 9 Skyway
- 10 Mechanical



# THIRDFLOOR

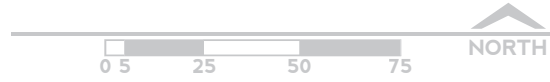

- 1 Leasable Office Space
- 2 Presentation Space
- 3 Office Skyline Lounge
- 4 Storage
- 5 Studio Apartments
- 6 Mechanical

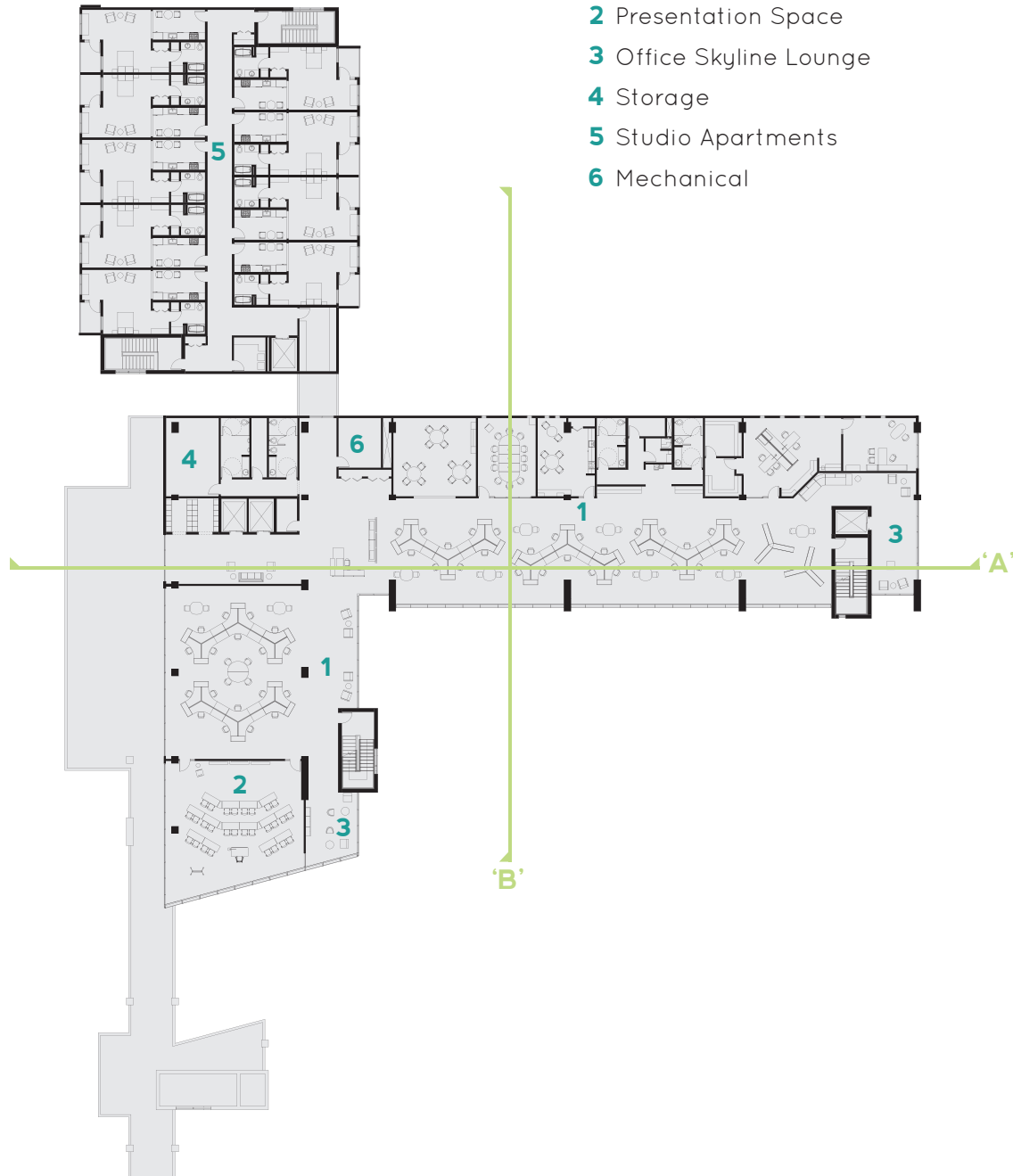



# SUBGRADEPARKING01

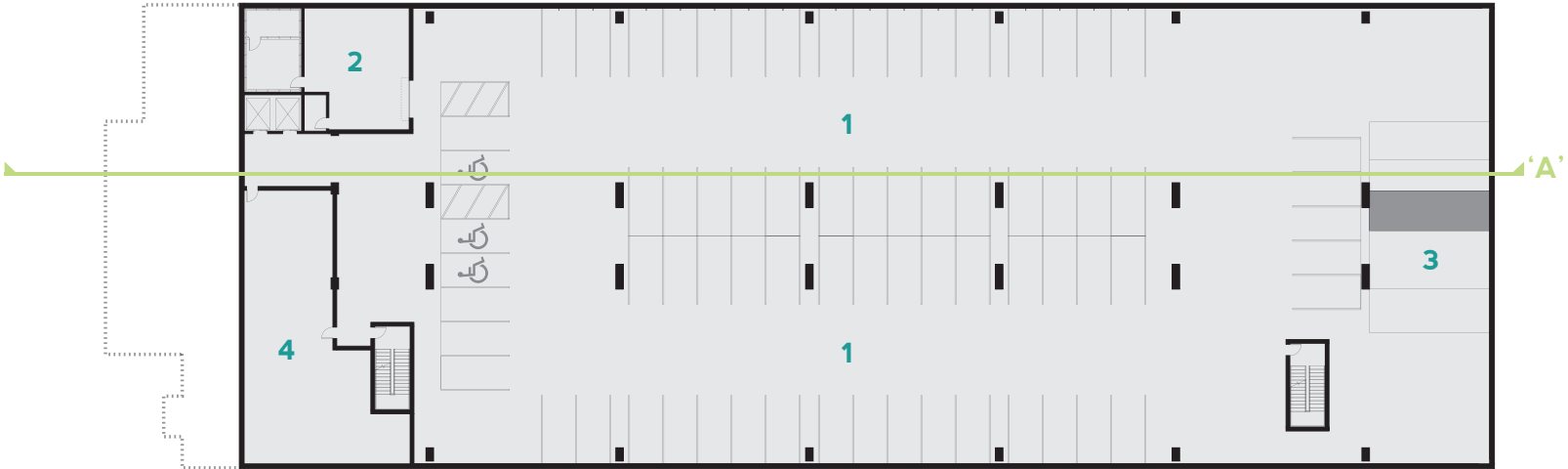

- 1 Short + Long Term Facility Parking
- 2 Market @ Midway Storage + Dropoff
- 3 Parking Access Ramp
- 4 Mechanical + Storage
- \* 146 Parking Stalls with 6 Handicap Accessible
- \* Room for Motorbike Parking and Storage

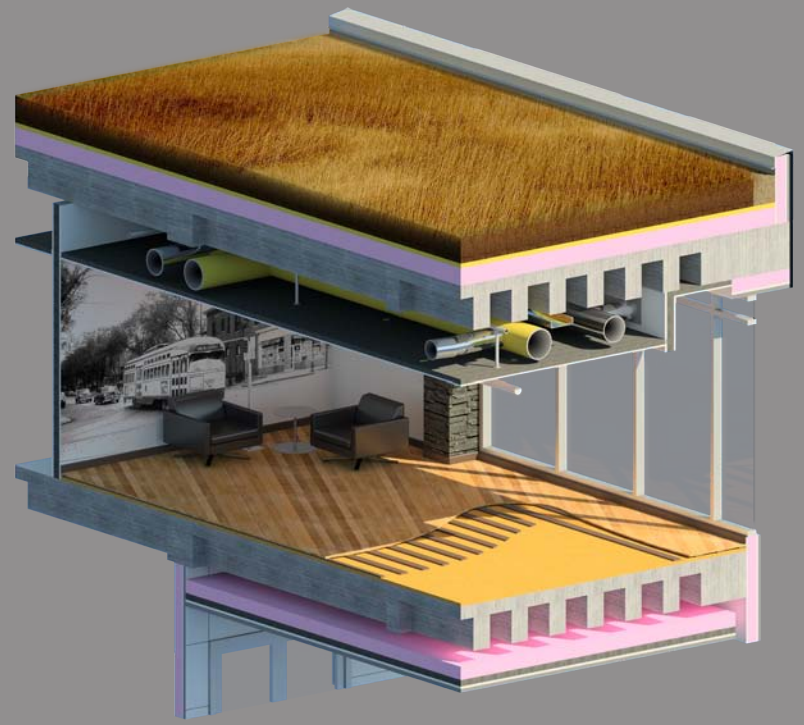
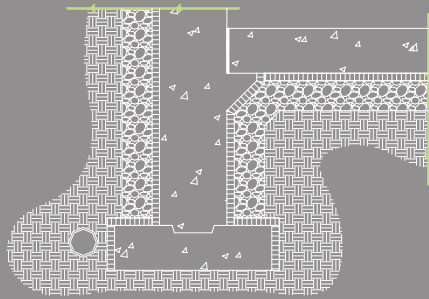
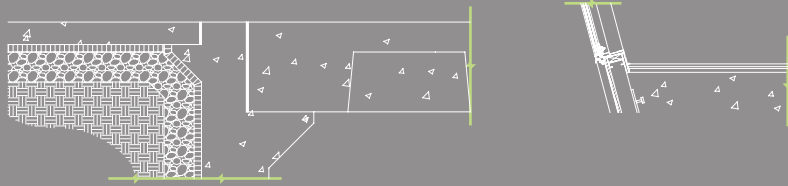
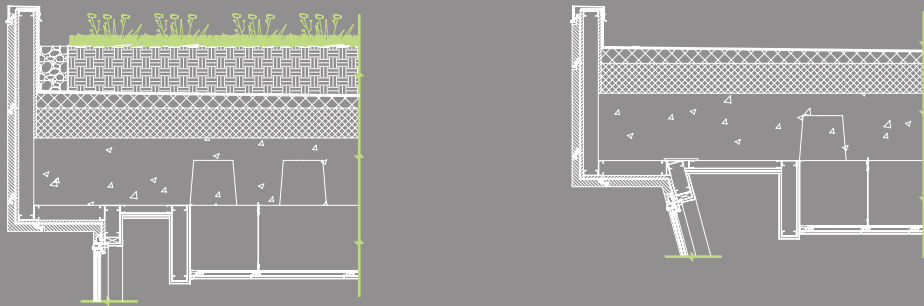



**TICKETING AND ENTRY ATRIUM**





MARKET@  
MIDWAY

MARKET @ MIDWAY





**THE MIDWAY GRILL**





**WHEELS BIKE AND REPAIR SHOP**





**GREEN LINE PASSENGER WAITING**

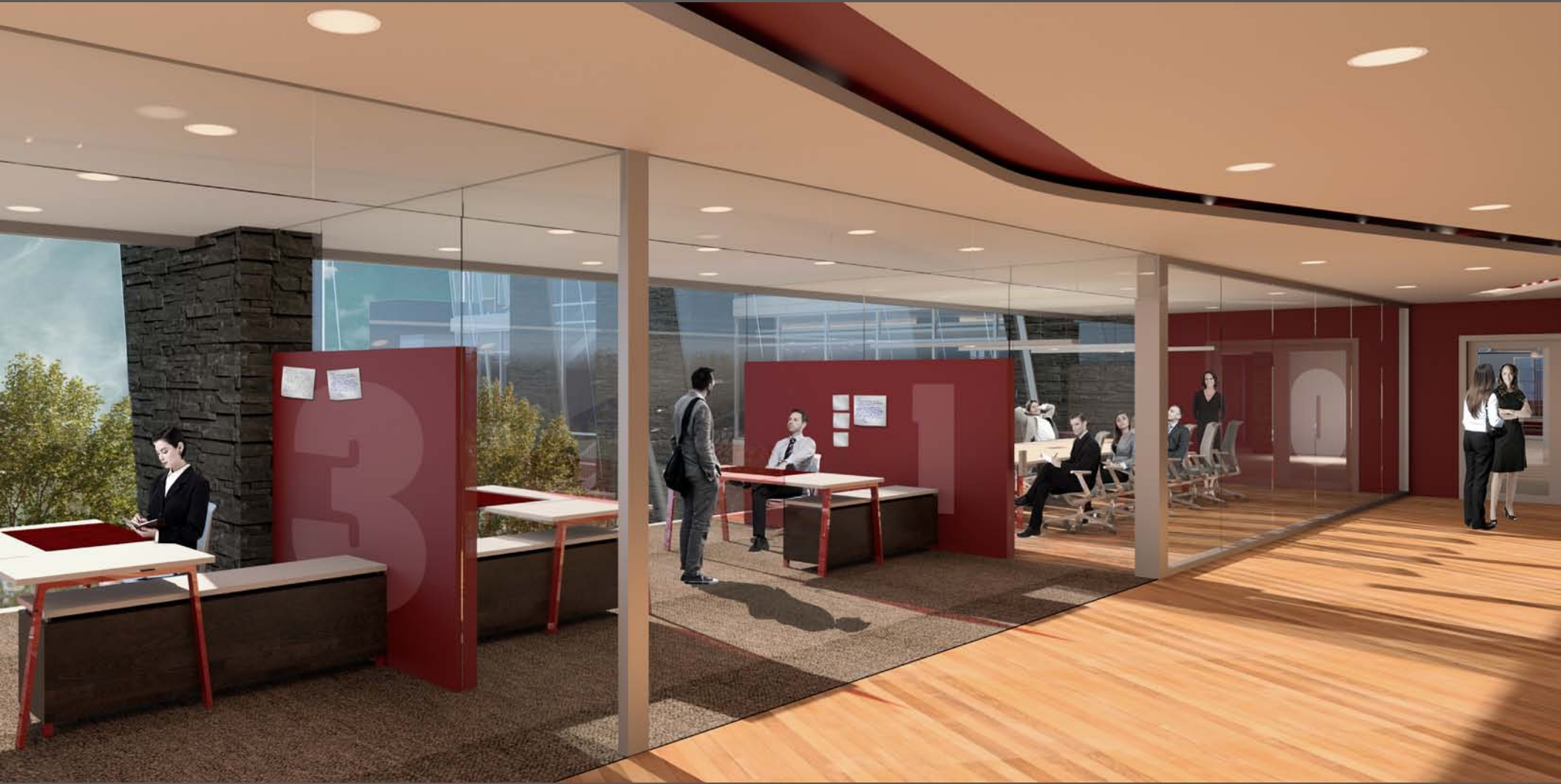

# METRO TRANSIT OFFICES





**SKYLINE LOUNGE**

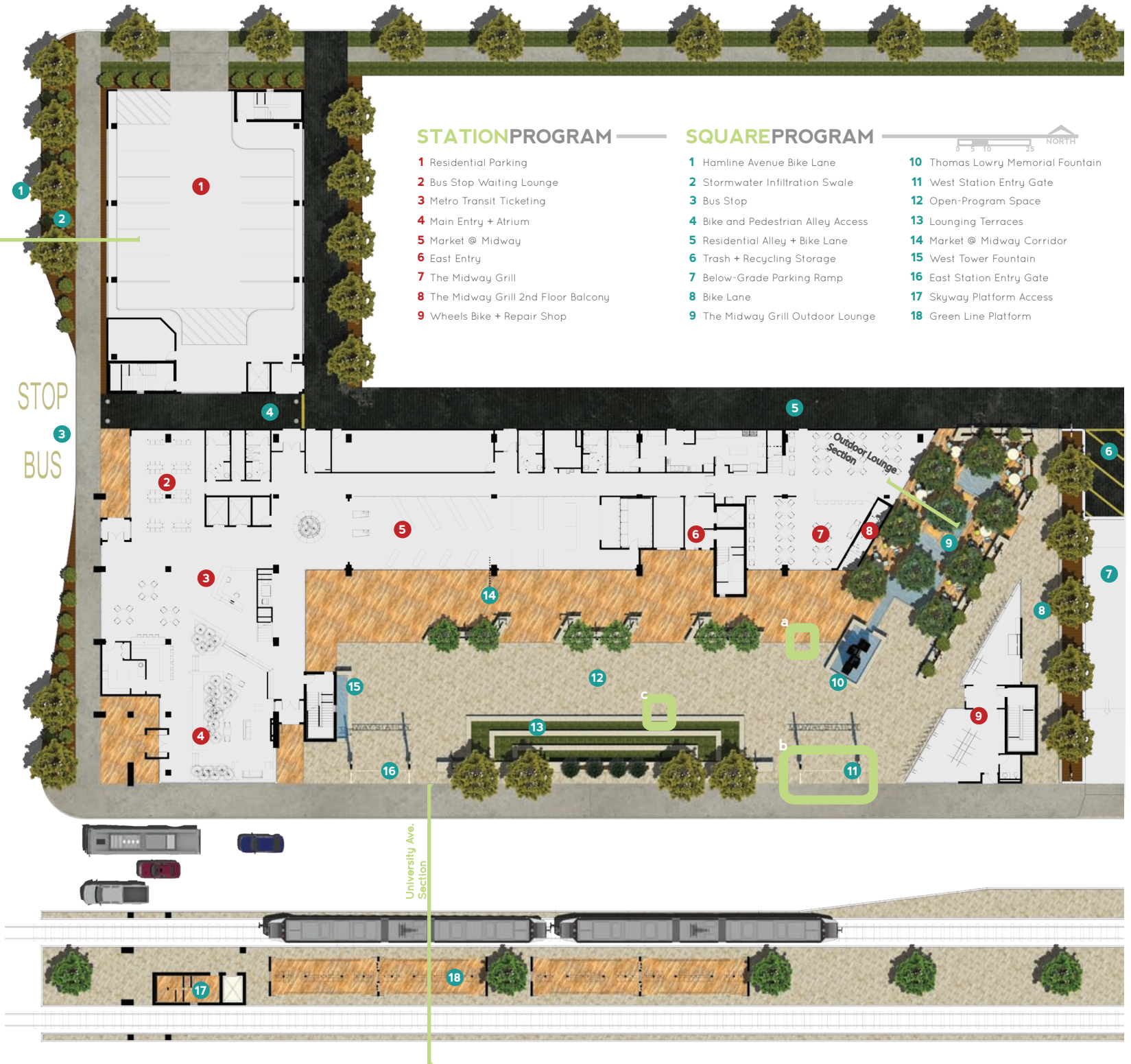

### STATION PROGRAM

- 1 Residential Parking
- 2 Bus Stop Waiting Lounge
- 3 Metro Transit Ticketing
- 4 Main Entry + Atrium
- 5 Market @ Midway
- 6 East Entry
- 7 The Midway Grill
- 8 The Midway Grill 2nd Floor Balcony
- 9 Wheels Bike + Repair Shop

### SQUARE PROGRAM

- 1 Hamline Avenue Bike Lane
- 2 Stormwater Infiltration Swale
- 3 Bus Stop
- 4 Bike and Pedestrian Alley Access
- 5 Residential Alley + Bike Lane
- 6 Trash + Recycling Storage
- 7 Below-Grade Parking Ramp
- 8 Bike Lane
- 9 The Midway Grill Outdoor Lounge

- 10 Thomas Lowry Memorial Fountain
- 11 West Station Entry Gate
- 12 Open-Program Space
- 13 Lounging Terraces
- 14 Market @ Midway Corridor
- 15 West Tower Fountain
- 16 East Station Entry Gate
- 17 Skyway Platform Access
- 18 Green Line Platform

Bioinfiltration Section

STOP  
BUS

University Ave.  
Section

Outdoor Lounge  
Section

a  
b  
c





**OUTDOOR LOUNGE SECTION**

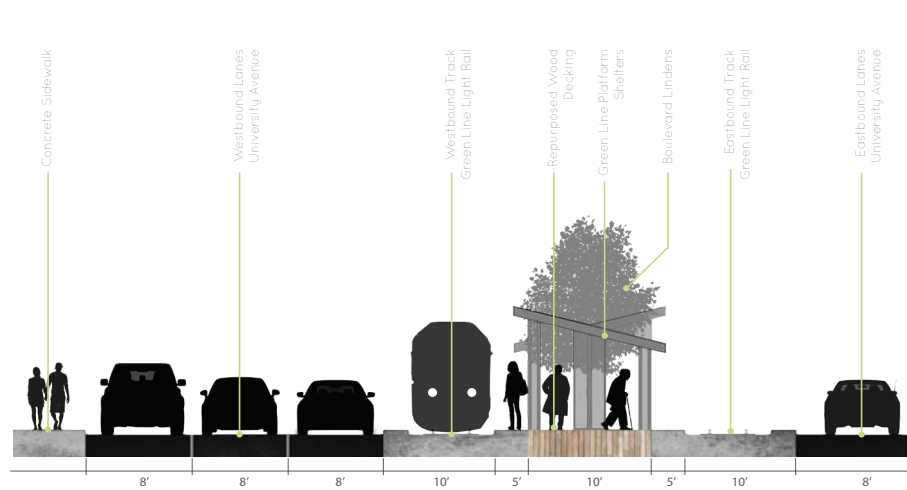

**UNIVERSITY AVE SECTION**



**BIOFILTRATION SECTION**

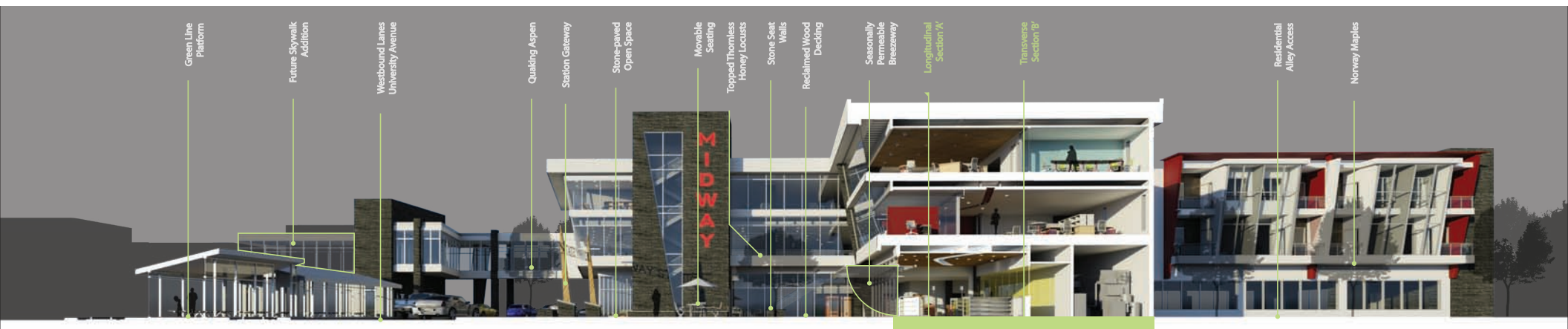

**EAST SECTION-ELEVATION**  
Transverse Section 'B'

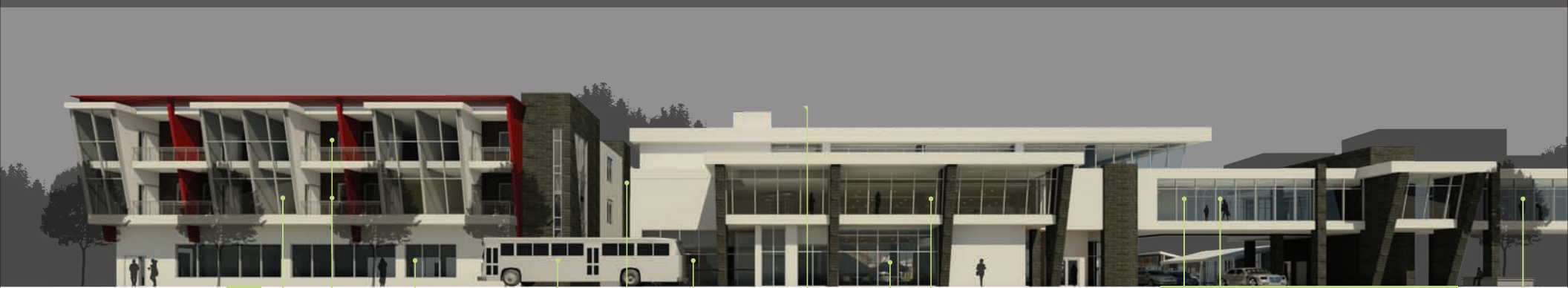

**WEST ELEVATION**



# MARKET @ MIDWAY CORRIDOR





**THOMAS LOWRY MEMORIAL FOUNTAIN**





**THE MIDWAY GRILL OUTDOOR LOUNGE**





- Lounge and Patio Furniture
- Local School Art Shows
- Standing Canopy Heaters around Furniture
- Fountains Begin in Late Spring
- Market Opens to Outside in Late Spring
- Bike Season Begins
- Street Performers
- Food Carts
- Gardening Fairs

## SPRING

## SUMMER

- Farmers Market
- Market is Open to Outside
- Fountains Remain Active
- Craft and Art Fairs
- Food / Cooking Contests
- Neighborhood Festival
- Concerts
- Street Performers
- Food Carts







- Farmers Market
- Market is Open through Early Fall
- Fountains Remain Active through Early Fall
- Lounge and Patio Furniture
- School and Local Art Shows
- Standing Canopy Heaters around Furniture
- Street Performers
- Food Carts
- Bike Season Closes

## FALL

## WINTER

- Snowman Building Contests
- Ice and Snow Carving Displays
- Holiday Light Display
- Winter Bike Storage for Residents
- Food Carts - Hot Drinks
- Cross Country Skiing in the Alley Bike Lane
- 'North Pole' Display and Holiday Tree Sales
- Neighborhood Winter Festival
- Snowtire Bike Race







# VISIONING PLAN

Though our design is a site-scale intervention, its intention is the creation of growth and identity in Hamline-Midway. This Visioning Plan displays the development zone (green underlay) surrounding our site that our design will influence. It shows the existing amenities in this development zone and projects the patterns in which the induced growth of the TOD will occur.

- LEGEND**
- Existing Institutional or Office Asset
  - Expected Induced Growth
  - Current and Proposed Bus Route
  - Bus Stop
  - Current Green Line Light Rail
  - Proposed Green Line Light Rail Station
  - Proposed Bike Lane
  - Bike Share Station
  - Educational Institution
  - Religious Institution

# COLLABORATIVE PROCESS

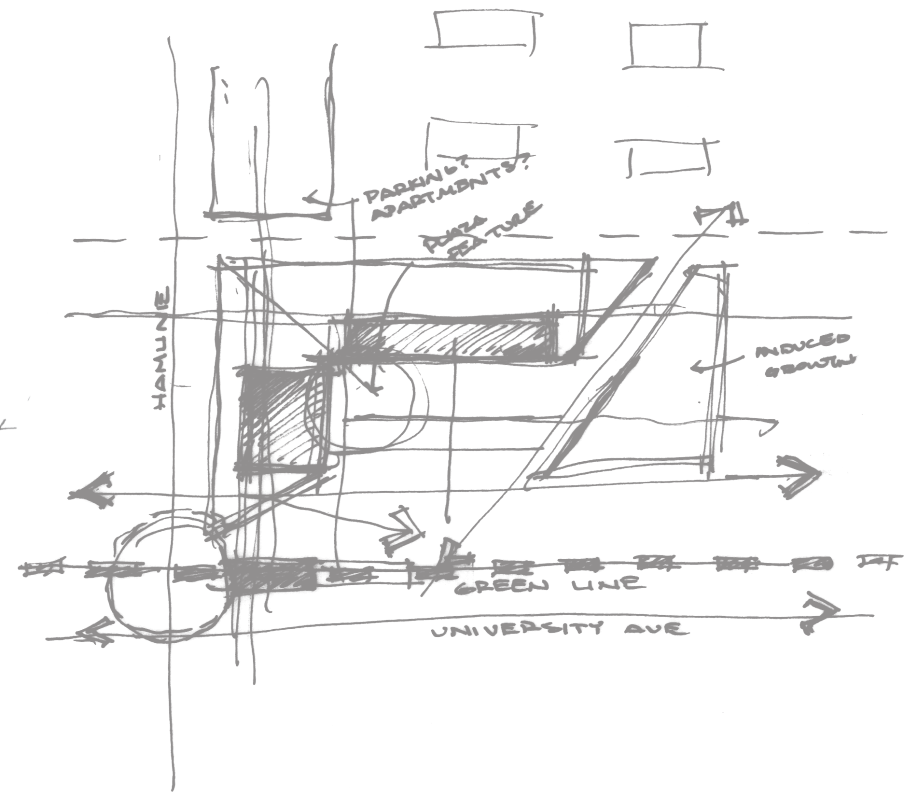
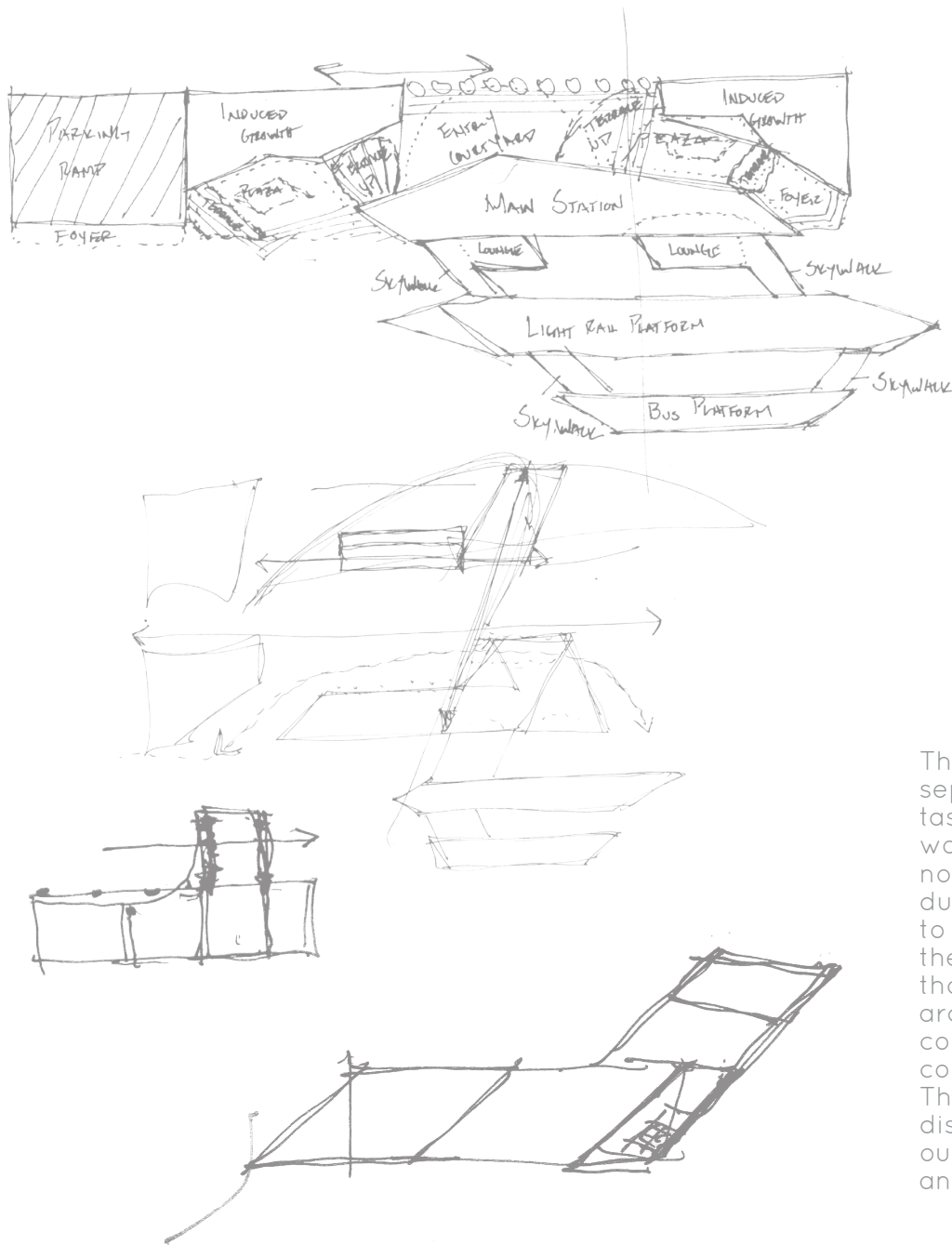

The collaborative effort on our thesis was highlighted not by the separate duties we each took on as joint designers, but by the tasks we accomplished collectively. Site selection, conceptual work, layout development, and foundational programming were not separated into 'architecture' and 'landscape architecture' duties. Instead, we worked together as environmental designers to create a place that reads as one unified design. It was not until the development of site forms - the step after programming - that we took on our respective roles as architect and landscape architect. Even as we moved forward with specialized tasks, we continually consulted each other on our design decisions, and constantly revised our plans through discussion with each other. The collaboration was not always smooth - we encountered disagreements at nearly all stages of the design. Yet through our combined experiences, we were able to identify the better answer - or compromise - in every difficult decision.



# RESEARCHFUL FILLMENT

## PLACE ATTACHMENT



### ACCESSIBILITY AND LEGIBILITY

ADA AND UNIVERSAL DESIGN  
PEDESTRIAN FRIENDLY  
ACCESS TO MULTIPLE TYPES OF TRANSIT  
ACCESS TO SERVICES AND AMENITIES  
CONNECTIONS TO GREATER NEIGHBORHOOD/REGION

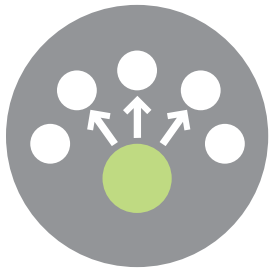

### VITALITY AND DIVERSITY

VARIETY OF PRODUCTS AND SERVICES  
VARIETY OF TRANSIT TYPES  
VARIETY OF PRE-PROGRAMMED SPACES  
VARIETY OF PROGRAMMABLE SPACE



### TRANSACTION, DISTINCTION COMFORT

VARIETY OF PRODUCTS AND SERVICES  
VARIETY OF SCALED SPACES  
DESIGNATION OF PUBLIC VS PRIVATE  
SECURE ENTRY TO RESIDENCES

# RESEARCHFUL FILLMENT

## PLACE IDENTITY: LANDSCAPE

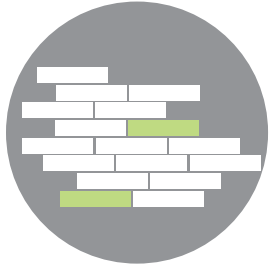

### THINGS

NATURAL MATERIALS  
BEDROCK OF PLACE  
MATERIALS FROM PAST  
GESTURE TOWARDS FUTURE

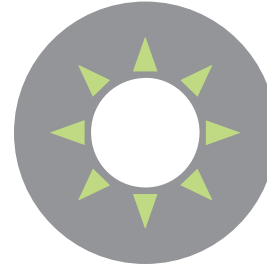

### LIGHT

NATURAL DAYLIGHT  
ACTIVE SPACES ORIENTED SOUTH



### COSMIC ORDER

ORIENTED ALONG AXIS  
DIRECTION TOWARDS CITIES  
CONFORMED TO GRID  
N,S,E,W ORIENTATION



### TEMPORAL RHYTHMS

WORK SCHEDULES  
RESTAURANT/MARKET  
SEASONAL PLAZA PROGRAM

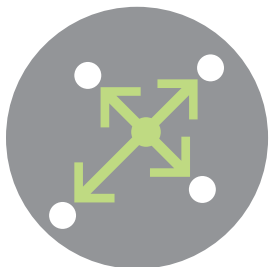

### CHARACTER

LINEAR DESIGN  
TRANSITION ZONE BETWEEN  
FACILITATE PEOPLE



# RESEARCHFUL FILLMENT

## PLACE IDENTITY: SETTLEMENT



### LOCATION

APPOINTED SITE BASED ON ANALYSIS



### SPATIAL CONFIGURATION

COLLABORATION!  
MERGE OF INTERIOR AND EXTERIOR  
SITE AND NEIGHBORHOOD CONNECTIONS



### ARTICULATION

TRANSIT FOCUSED DESIGN  
DEVELOP A NEW LANGUAGE  
HEALTHY LIFESTYLE  
ESTABLISH CONNECTIONS

# QUESTIONS COMMENTS?

