

# STILBESTROL IMPLANTS DO NOT IMPROVE GAINS OF NURSING STEER CALVES

Raymond J. Douglas, James L. Nelson and William E. Dinusson

A trial to determine the effect of stilbestrol (diethyl stilbestrol) implants on weight gains of nursing steer calves was begun at the Dickinson Experiment Station in June, 1967, and continued in the summers of 1968, 1969 and 1970. In each of the four years, all steer calves produced in the station herd were included in this trial.

The calves were divided into two groups each year, and were allotted to maintain equal age and weight between treatments. The calves were implanted on June 29 in 1967, and June 27 in 1968. In both years, 12-milligram implants were used. Treatment date in 1969 was June 26, and in 1970, June 25, with 15-milligram implants being used both years.

Individual calf weights were obtained at the beginning of each trial in June, again in mid-August, and at weaning in mid-October.

The cows and calves were pastured during the trial period on a western wheatgrass (needle and thread-type) native range. The pasture was in excellent condition, and ample grazing was available throughout the trial period. An adequate water supply was also available throughout the trial. A mineral mixture of one part dicalcium phosphate and

two parts trace mineral salt was provided on a free choice basis.

Gains recorded in this trial for the four-year period 1967 through 1970 are summarized in Table 1.

**Table 1. Gains of Nursing Steer Calves Implanted with Stilbestrol and Not Implanted.**

	Year	No. head	Avg. June wt.	Avg. Oct. wt.	Avg. summer gain	Days on trial	Avg. daily gain
Calves not implanted with stilbestrol	1967	27	185.9	396.9	211.0	119	1.77
	1968	23	173.7	382.2	208.5	110	1.90
	1969	21	179.8	383.6	203.8	113	1.80
	1970	20	179.5	395.5	216.0	110	1.96
	4-Yr. Avg.	22.3	179.7	389.6	209.9	113	1.86
Calves implanted with stilbestrol	1967	27	182.2	390.2	208.0	119	1.75
	1968	23	173.7	385.7	212.2	110	1.93
	1969	19	180.0	399.7	219.7	113	1.94
	1970	23	183.9	390.7	206.8	110	1.88
	4-Yr. Avg.	22.3	180.0	391.6	211.7	113	1.87

## Summary

These trials show no advantage for implanting nursing steer calves with stilbestrol.

*Douglas is animal husbandman, Nelson is assistant animal husbandman, Dickinson Experiment Station; Dr. Dinusson is animal nutritionist, Department of Animal Science.*

## Two New Midwest Planning Handbooks Now Available

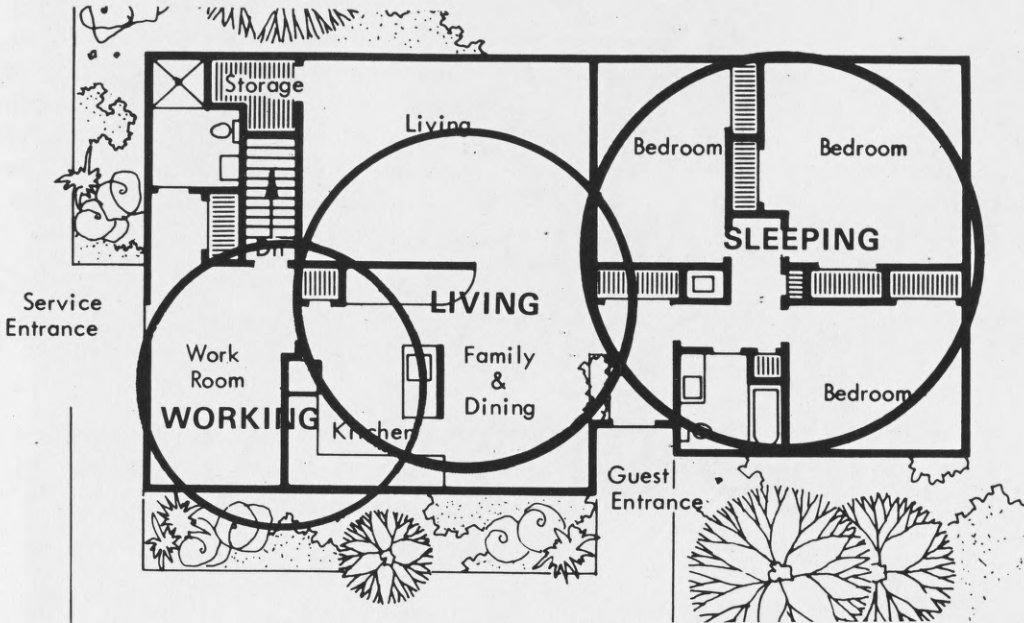

A good house plan divides into well-defined areas.

Two new handbooks have recently been made available through the Midwest Plan Service, an association of agricultural engineers from the land-grant universities in the 12 midwest states.

"Family Housing Handbook", MWPS-16, includes 74 pages of information and diagrams for planning the different parts of a home. Special home economics consultants helped prepare this booklet. "Family Housing Handbook" does not contain house plans that a family could use to build a house, but instead discusses in detail the "parts" of a home and considerations to be used in planning. The parts include kitchens, dining rooms, living rooms, bedrooms, bathrooms, clothes care centers, home offices, entryways, halls, stairways and garages. The information is helpful in planning a home, evaluating a standard house plan, or remodeling an existing home.

"Horse Housing and Equipment Handbook", MWPS-15, contains planning and design information on facilities to make horse care easier and add to personal satisfaction and riding enjoyment. Primary considerations in planning horse care facilities include health and safety of the animals and people who come in contact with them, sound construction at reasonable cost, labor-saving conveniences, and selecting a building style that fits the site.

Sound planning procedures provide room for expansion, and allow for such specific details as water supply, manure disposal, feed storage, exercise space, loading and unloading access, and legal

or other restrictions that may apply.

Both handbooks are available from your local County Extension Agent at \$2.00 each, or they may be ordered directly from the Extension Agricultural Engineer, North Dakota State University, Fargo, 58102.

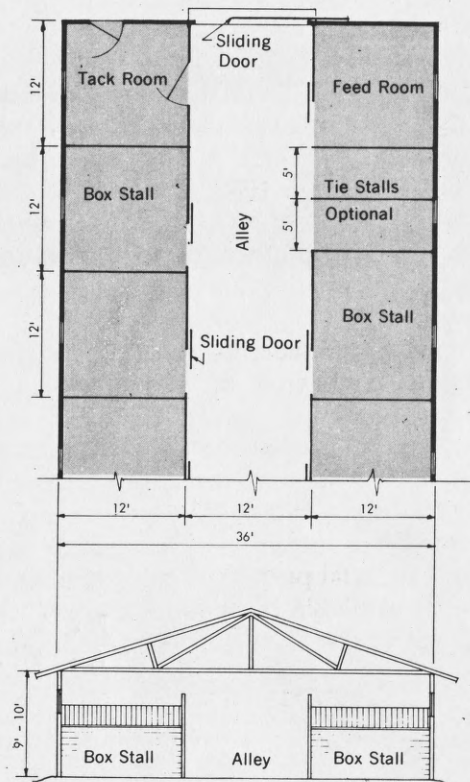

Two rows of box stalls (outside service).