

BOARDS EXPLAINED

BOARD A

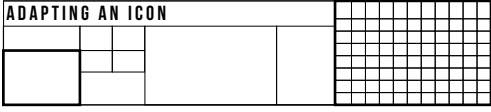

PRE-SEMESTER | Site Visits

A



In the summer leading up to fifth year I visited and recorded over 30 theaters in ND, MN and SD

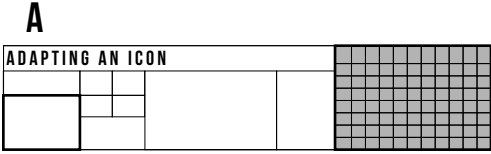

WEEK 01/02 | Theater Thumbnails

A

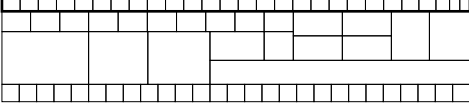

Initial investigation was done with 17 different theaters as a way of understanding characteristics and commonalities

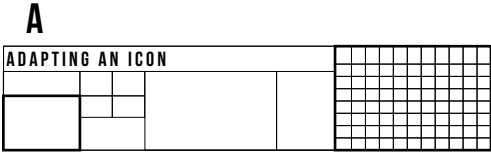

WEEK 03 | Section & Structure Study

A

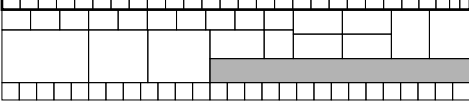

As a way to understand construction and assembly of these theaters a study was done that analyzed multiple theater section cuts

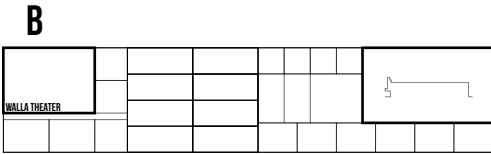

WEEK 04/05 | Schematic Design Models
* Five theaters chosen

C



Using multiple materials, over 80 models were built to investigate how different interventions interacted with the existing theater section

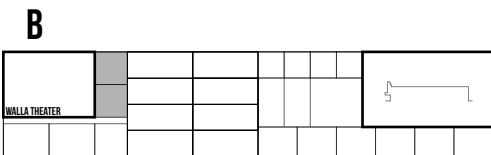

WEEK 06/07 | Site Study / Program

C

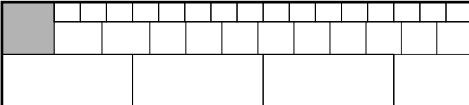

The five theater sites and communities were studied to find unique characteristics and niches that the theater could appeal to

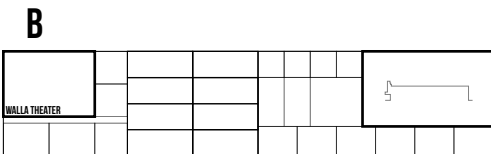

WEEK 08 | Schematic / Design Development

C

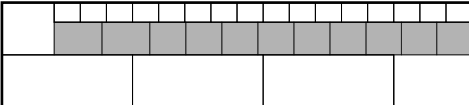

Using commonalities discovered in Week 01 and schematic models investigated in Week 04, designs continued to progress through hand drawing

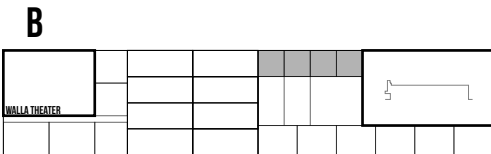

WEEK 09 | Midterm Presentation

C

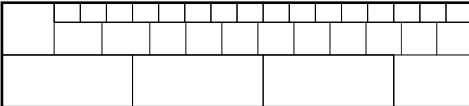

Five preliminary designs were brought to a presentation format as a way of communicating ideas

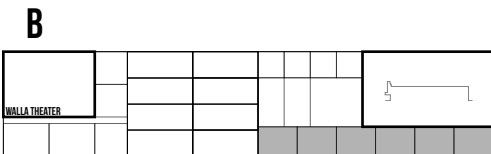

WEEK 11 | Section Sliver Models

C

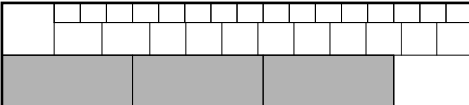

15 section "Sliver" models were created as a way of reevaluating some design decisions. The sliver models allowed for the comparison between existing and proposed

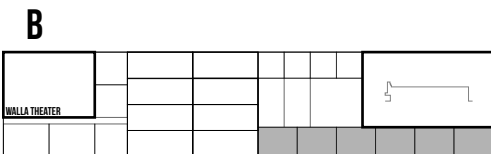

WEEK 12 | Mech / Structural Investigation

C

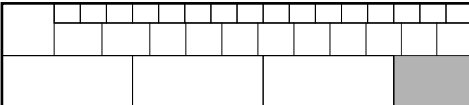

Integration of new structure and mechanical systems were explored using the models made in Week 11. Drawings were done to understand existing and integrated conditions

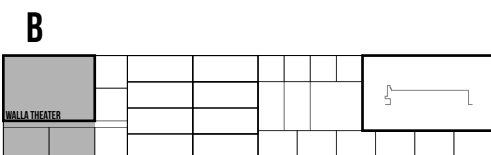

WEEK 13 | Composite Images

C

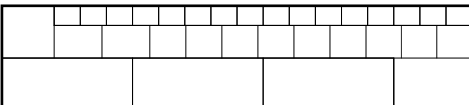

A composite image and subsequent line drawings were done to understand how interventions would interact with existing conditions and how spatial activities could fit into the

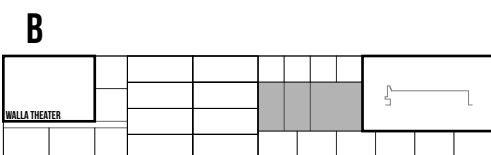

WEEK 14 | Assembly / Intervention Details

C

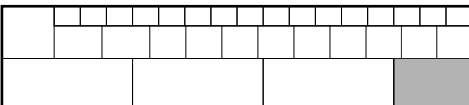

Time this week was invested in how existing construction could be adapted for new interventions

THESIS SHOW PRESENTATION

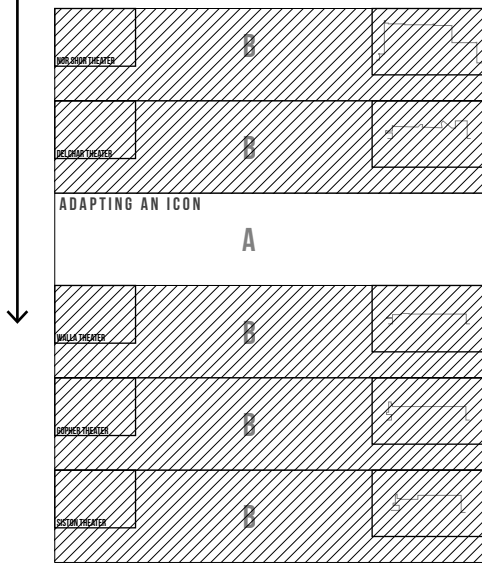

ADDITIONAL PROCESS BOARDS

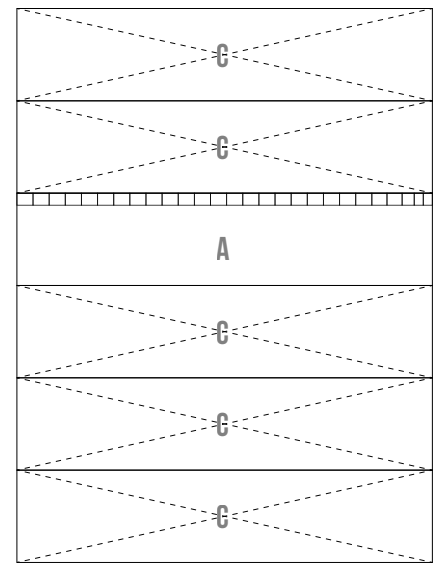

BOARD A

Overall project investigations exploring general theater studies

BOARD B

Theater specific drawings exploring and representing adaptive reuse interventions

BOARD C

Supplemental drawings, models, and photographs contributing to theater specific investigations