

Interaction Studies

In order to understand the specific interactions of coworking at a human scale, sound and sight paths were placed to visualize in plan. This showed how adjacencies and room size effected possible interactions.

The red, green, and blue sonar paths are to explain the sound produced by a person conversing at a table. Where these interfere are potentials for conversation. Sight paths are shown as yellow view cones. Darker shades of yellow symbolize the areas with the least visual privacy and would tend to feel most public.

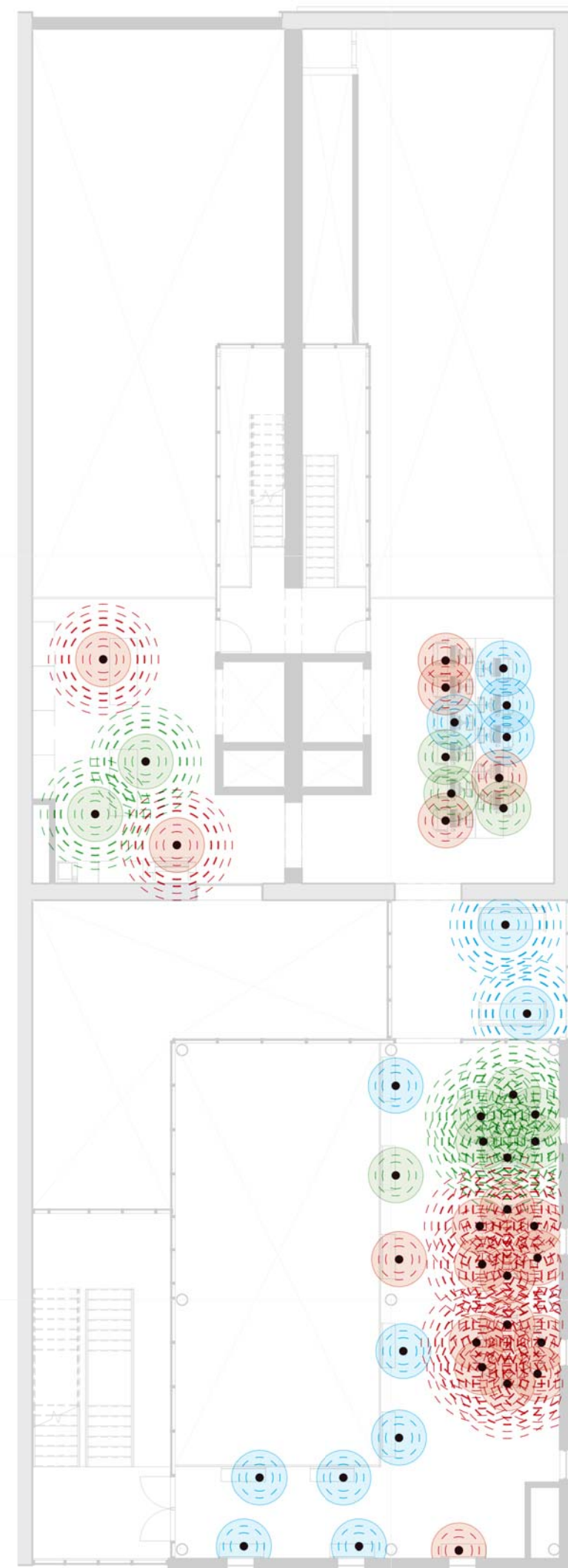
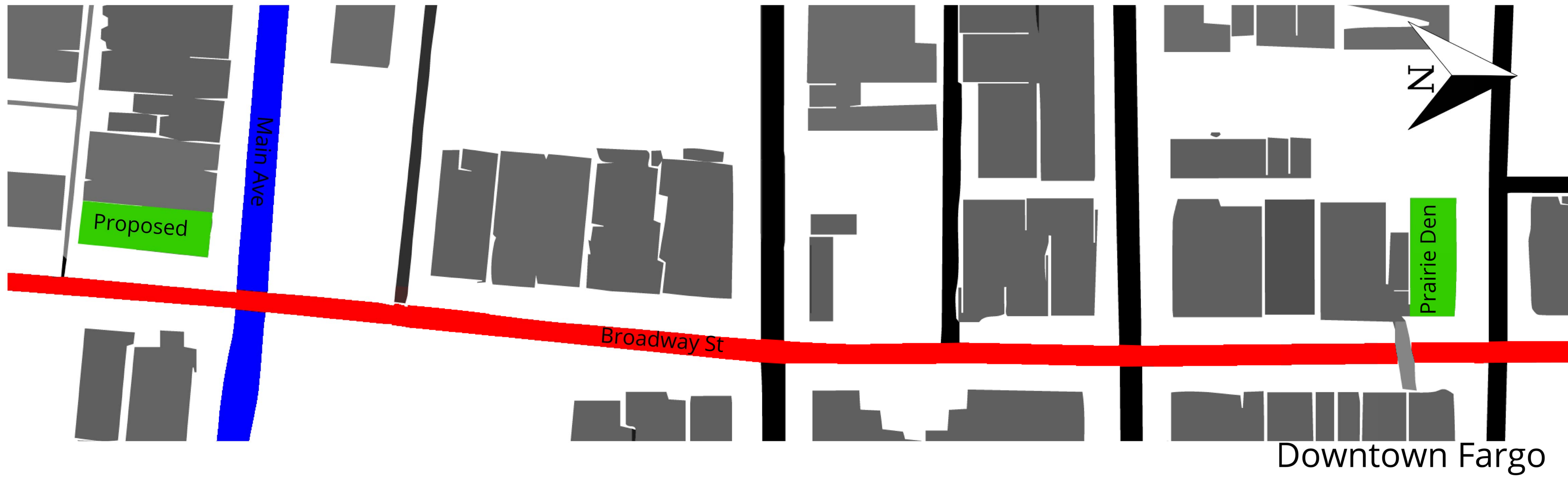

M1.5 Acoustic

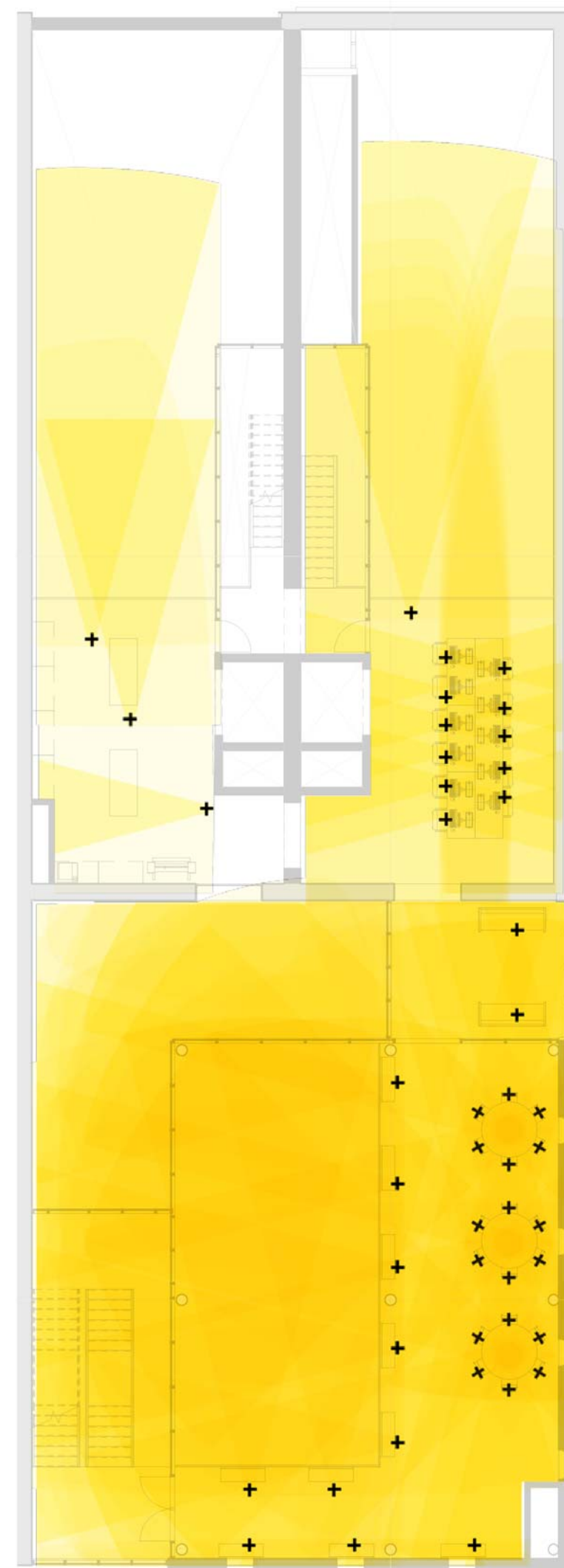

M1.5 Sight



M1.5 Circulation

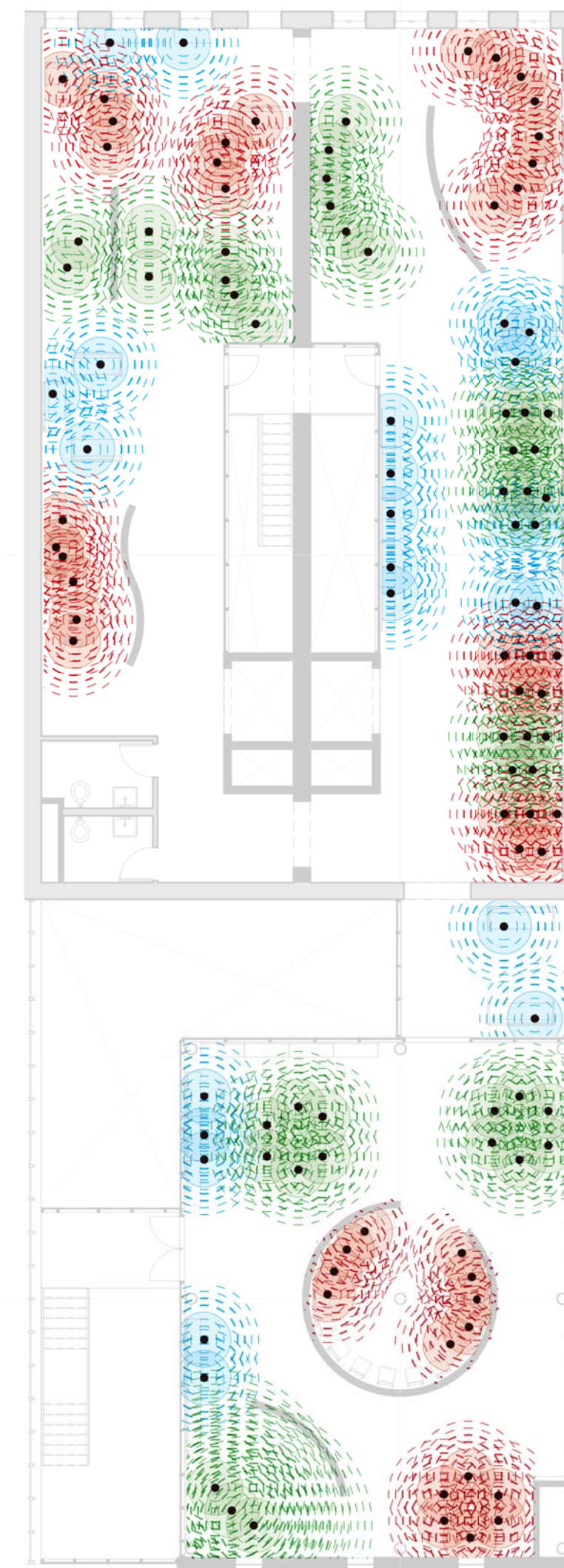

L2 Acoustic



L2 Sight

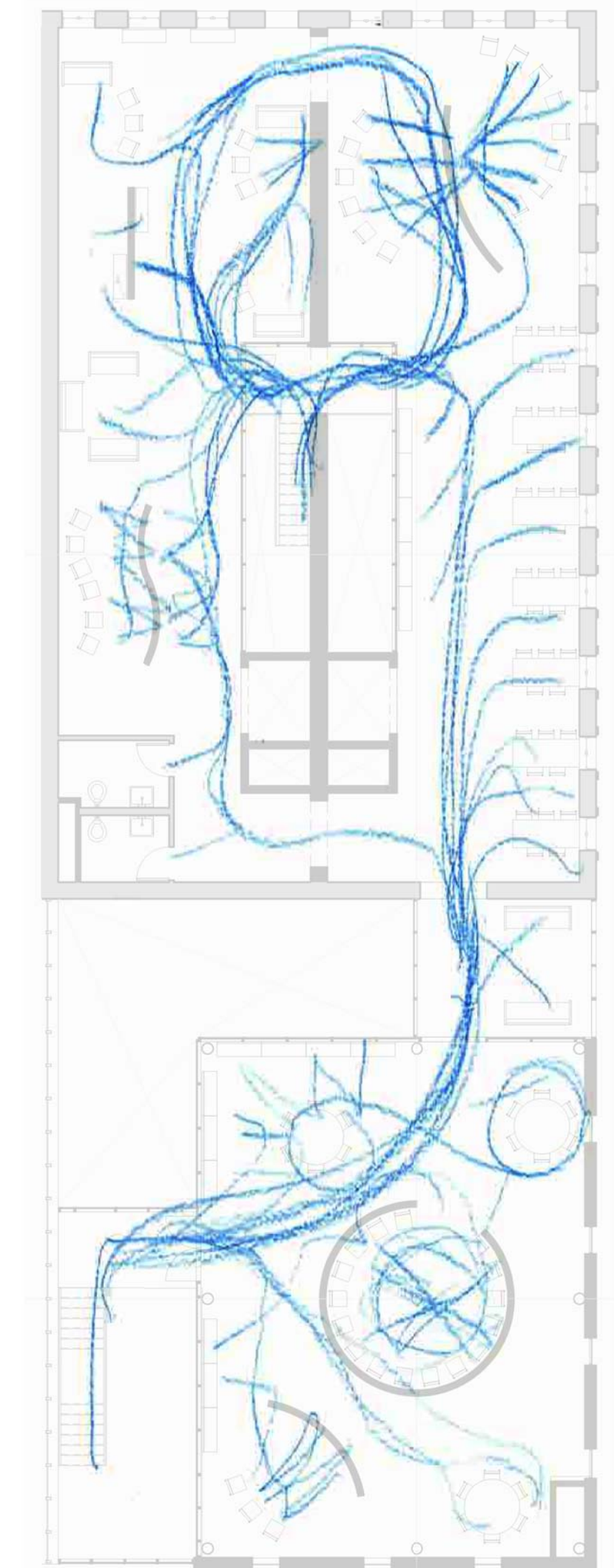

L2 Circulation