

SUMMIT'S RALLY

Corey K Smith LA 572

Preserving the ecological systems in the Ross Lake Subdivision of North Cascades National Park through recreational education.

Project Goals

1. Environment
2. Education

Emphasis: Eco-Tourism

Primary Design Typology

1. Environmental Planning
2. Parks and Open Spaces

Objectives

- To create a low-impact destination that will attract more visitors without sacrificing the soul of the park.
- To sustain, ameliorate, and advocate dynamic environmental systems.
- To educate visitors and spread awareness of present trans-boundary logging encroachment.

Site Context



Inventory Overview

236,000 acres of ancient forest within the North Cascades National Park.

26,972 visitors in 2015, compared to Yellowstone's 4.1 million.
North Cascades is currently the least visited National Park in the U.S.

1 Hour drive from Seattle

\$0 entrance fee

140 back country campsites, **6** within project site.

3,165 trans-boundary acres harvested for timber in 2015.

200 site acres razed prior to 1934 wilderness act.

≈400 miles of hiking trails, **5** existing park facilities.

Project Area: 620 Acres (**>.001%** of the park)

Aggregate Analysis

Altitude Zonation + Elevation Ecology +
Razing Zones + Slope Analysis =
Ecological Character Systems



RANGE	HEIGHT	SLOPE (%)
1	0-4	
3/4	4-6	
1/2	6-10	
1/4	10-30	
1/8	30-60	
1/16	60+	

Elevation Ecology + Soil Composition + Slope Analysis =
Stability Metric

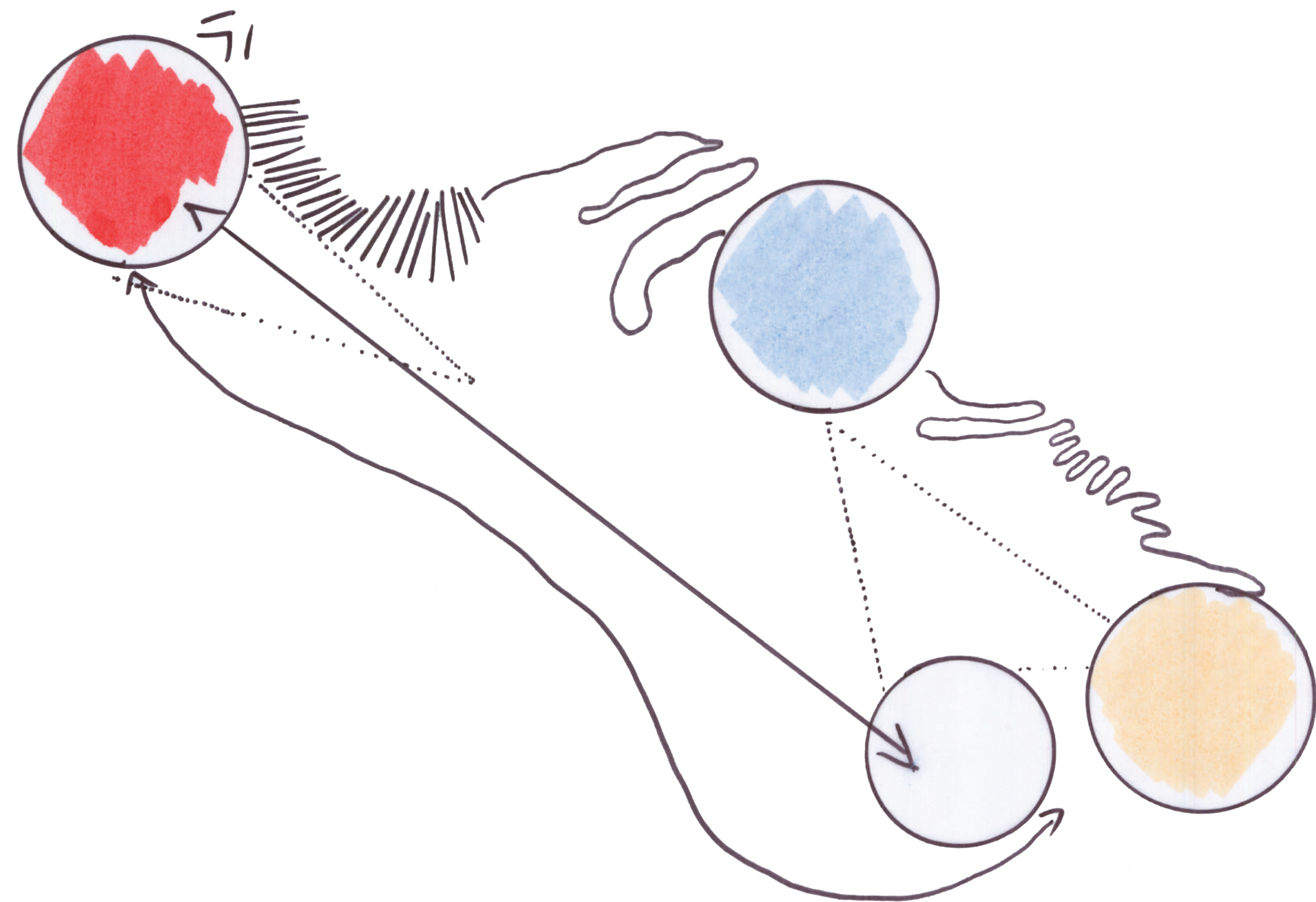

Ecological Character Systems + Stability Metric =
Project Sites

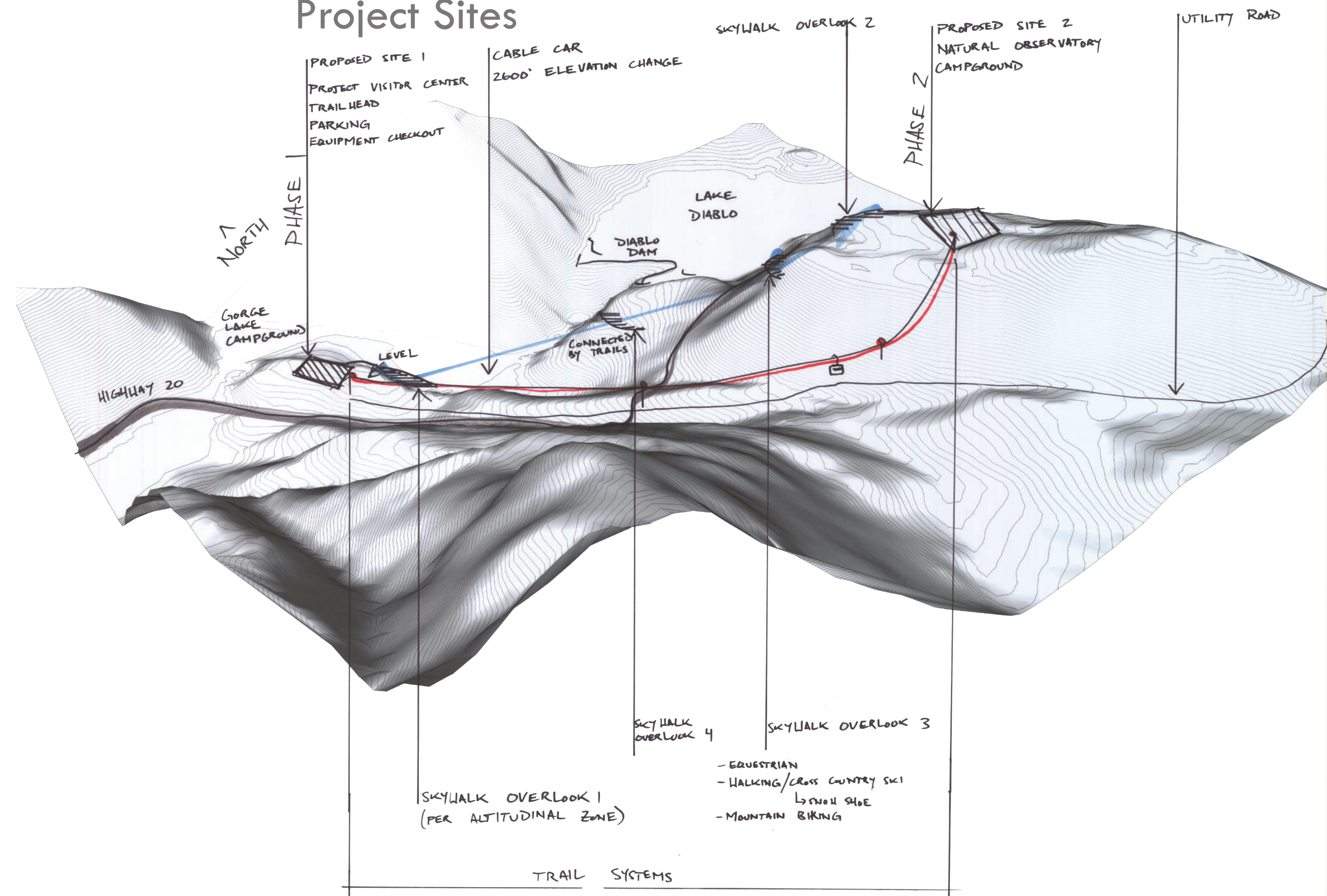

Master Plan

Primary Materials



Brushed Metal

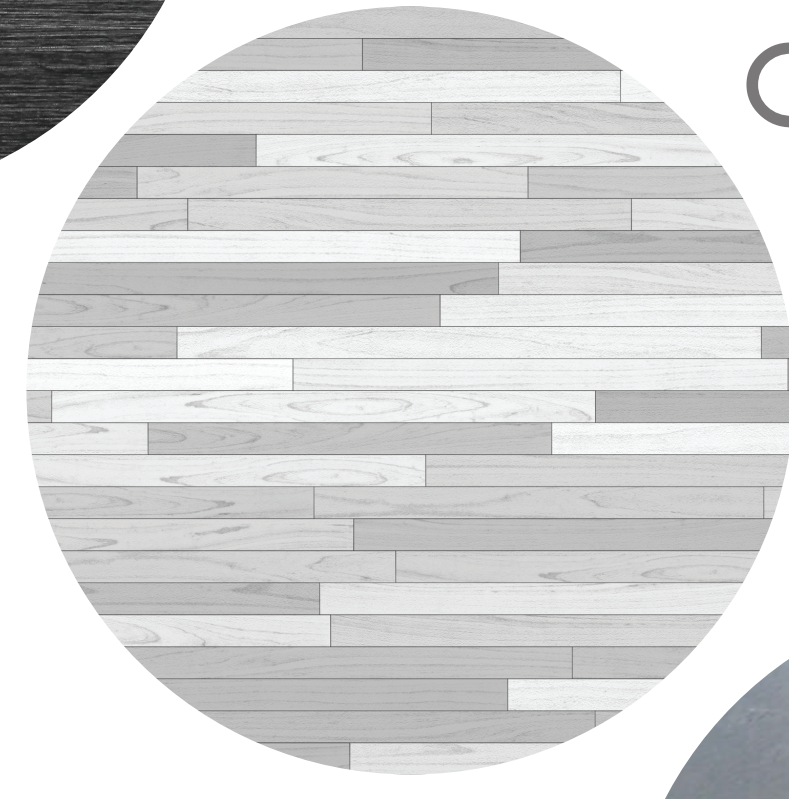

Concrete Blocks



Frosted Glass



Synthetic Wood



Fines

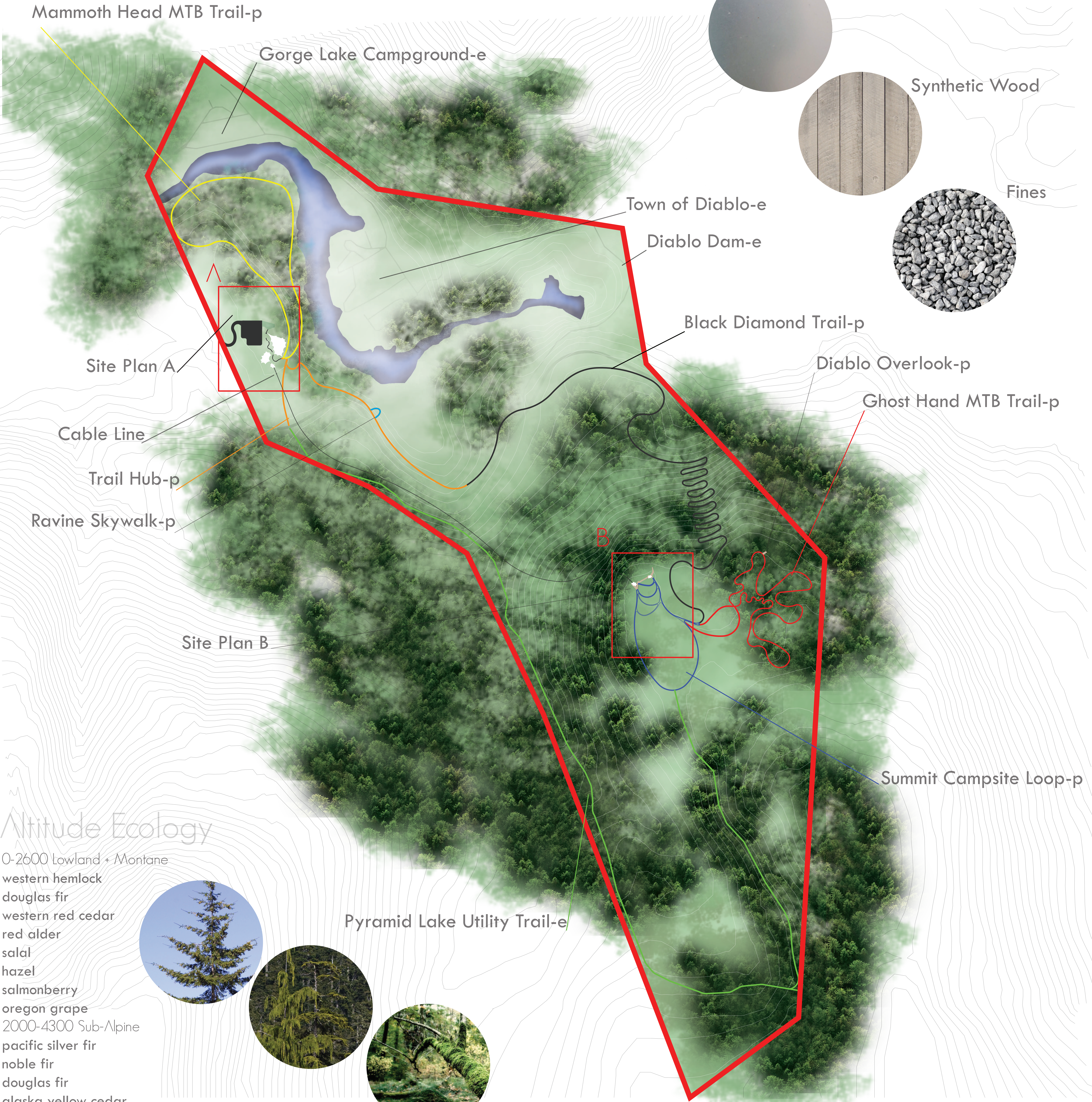

Altitude Ecology

0-2600 Lowland + Montane

- western hemlock
- douglas fir
- western red cedar
- red alder
- salal
- hazel
- salmonberry
- oregon grape

2000-4300 Sub-Alpine

- pacific silver fir
- noble fir
- douglas fir
- alaska yellow cedar
- vine maple
- salal
- mountain huckleberry
- devil's club



Amended Plants List

Common Name	Scientific Name	Sun	Height	Season	Comments
-snowberry	-symphoricarpos	-S	-8'-20'	-wi	-attractive foliage, waxy berries in winter.
-red flowering currant	-ribes sanguineum	-P	-10'-35'	-sp	-beautiful. Attracts butterflies, hummingbirds.
-henderson sedge	-carex hendersonii	-n/a	-8"-3'	-n/a	-acoustic quality in windy conditions.
-vine maple	-acer circinatum	-P	-5'-35'	-fa	-great fall color.
-western spirea	-spiraea douglasii	-F/P	-3'-6'	-su	-pink flowers in july. ornamental.

Scale: 1:500



Character Details

Cell-Ping Map Hubs

Multi-Use Trail System

Educational Signage

Crushed Fines

Native Plantings

Scale: 1:10

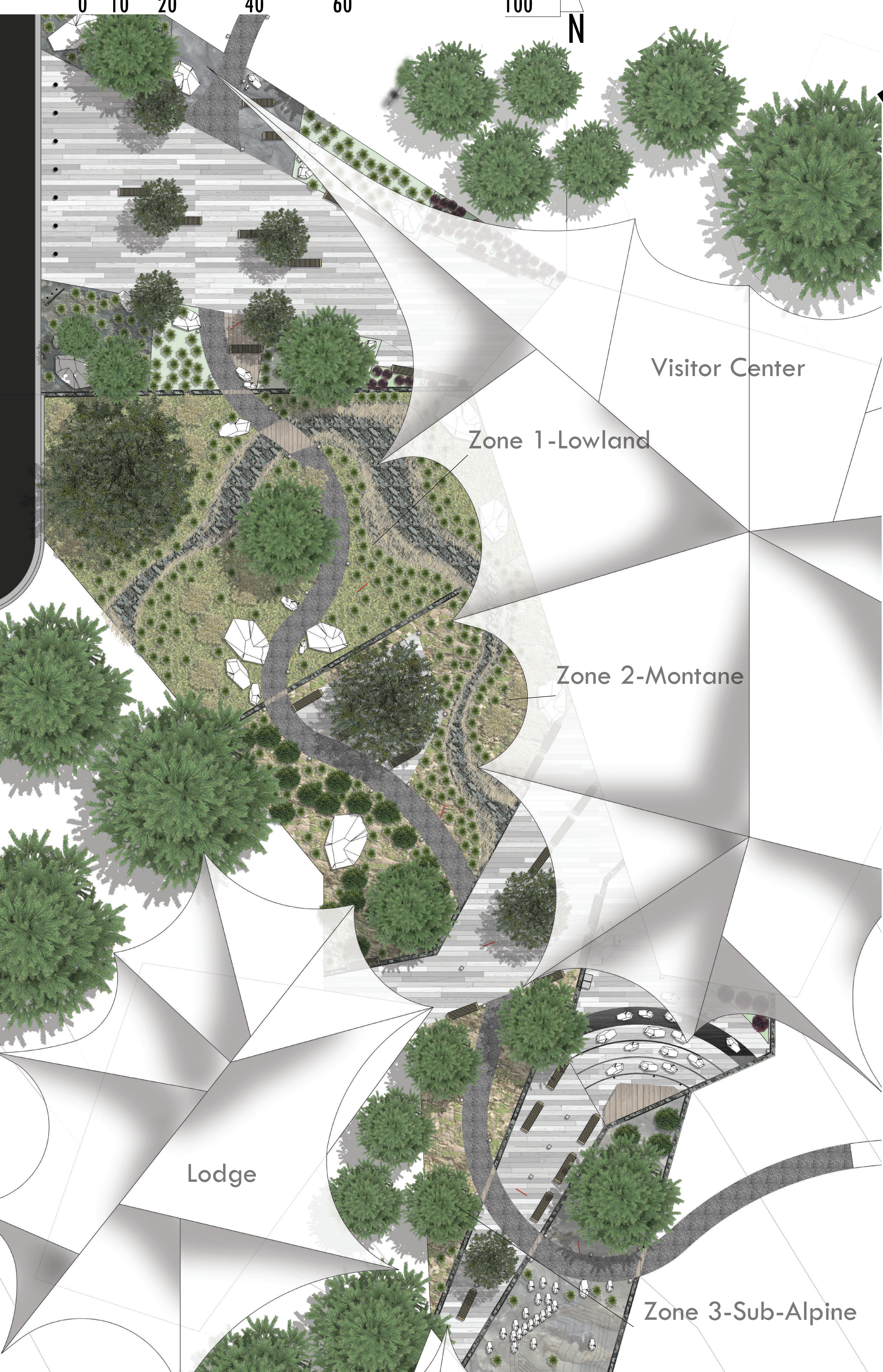
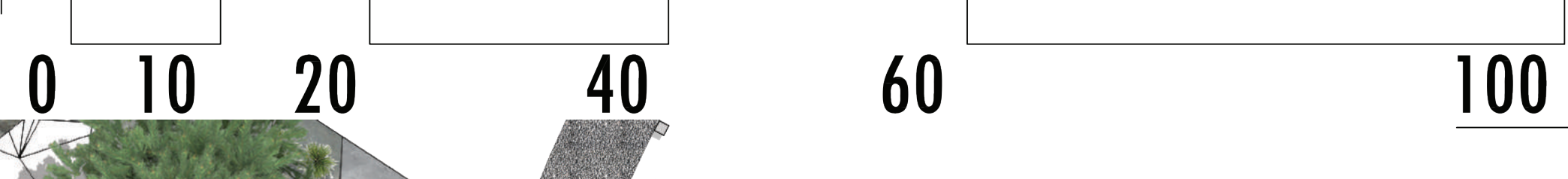

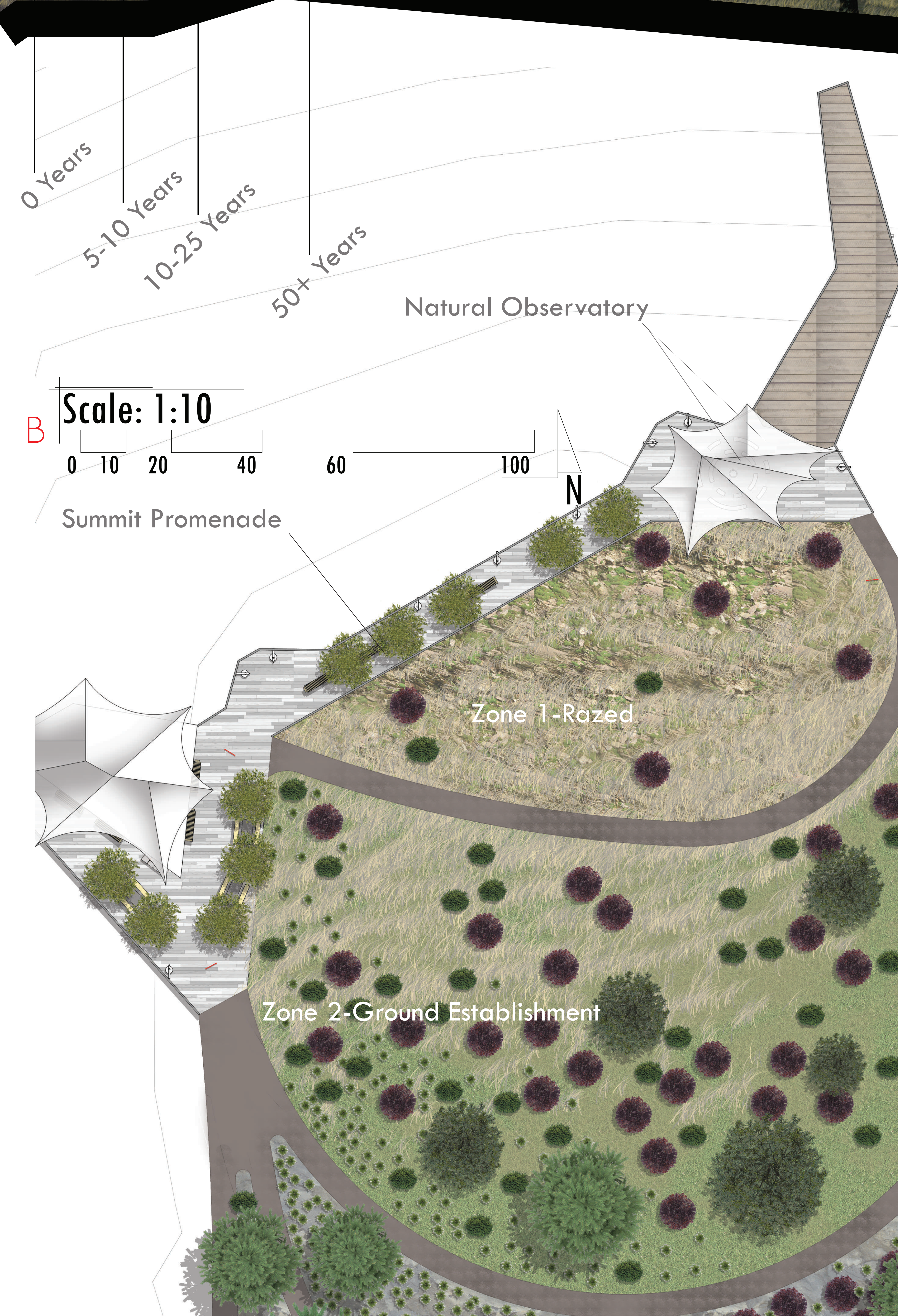
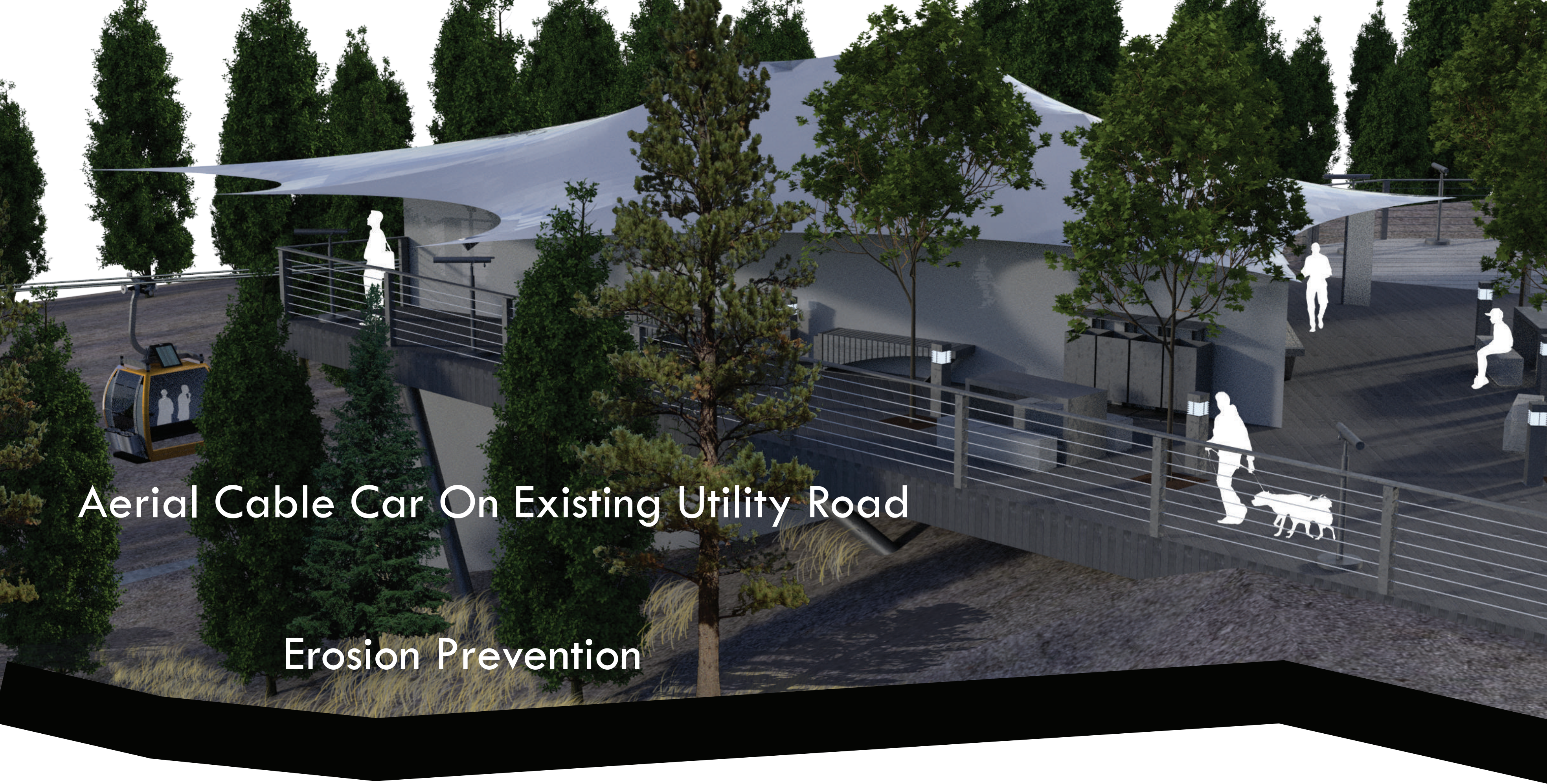

Altitudinal Landscape



Aerial Cable Car



Summit Overlook

