

A visitor's journey starts on top of the hill entering the site through a crack - a path in-between two structures which are part of the Earthquake Research Facility.

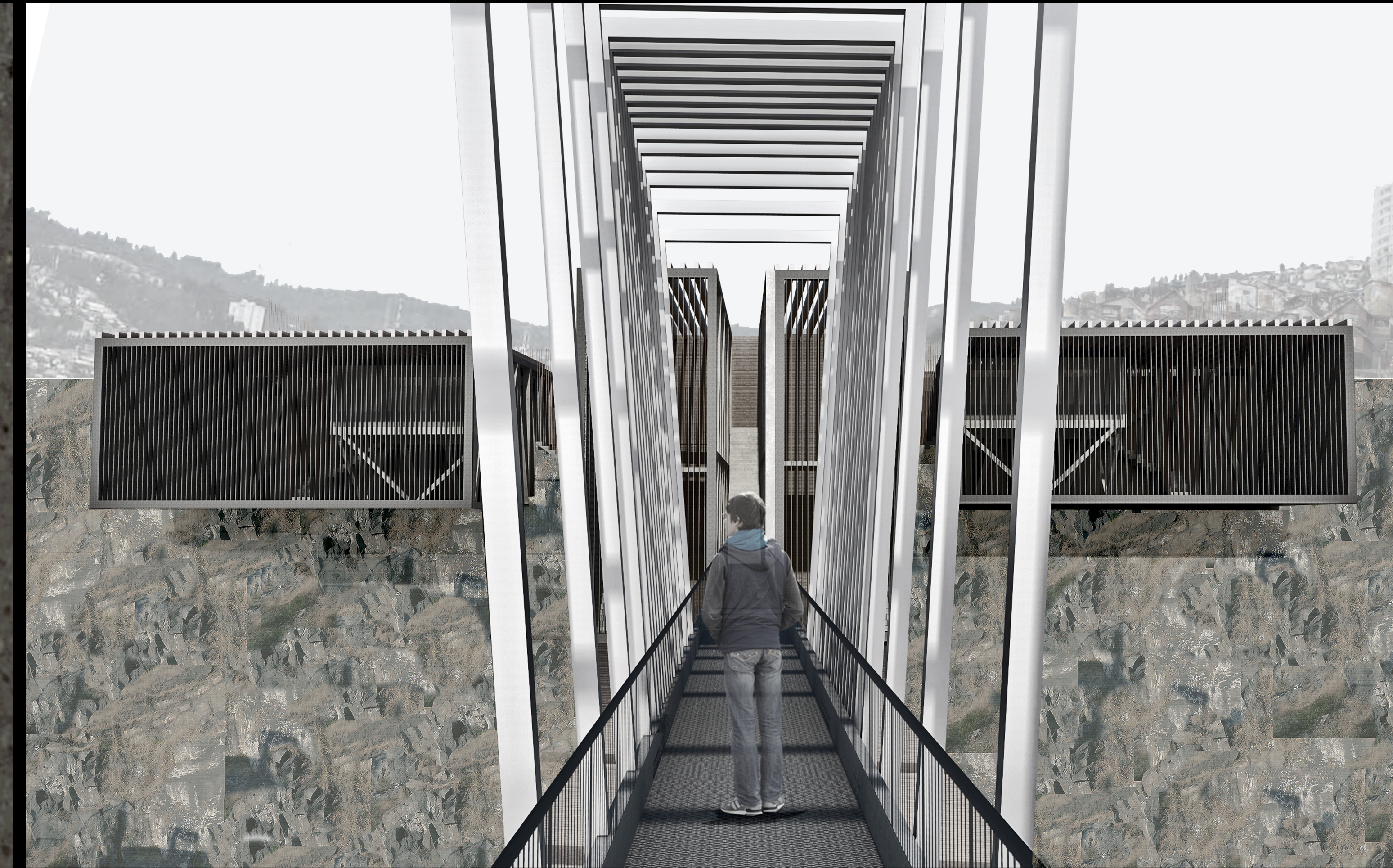

The facility's structure is anchored on the ground, growing out of it. Its walls are composed of the earth and rocks extracted while creating the void in the land, which now holds the research center. Displacing and placing the earth and its minerals in a different way.



The bridge is a connection and extension of the community - from the land into the ocean and to the memorial museum. A precarious landmark for the city to memorialize earthquakes, embodying the tension between the two imposing elements of the site (the hills and the ocean).

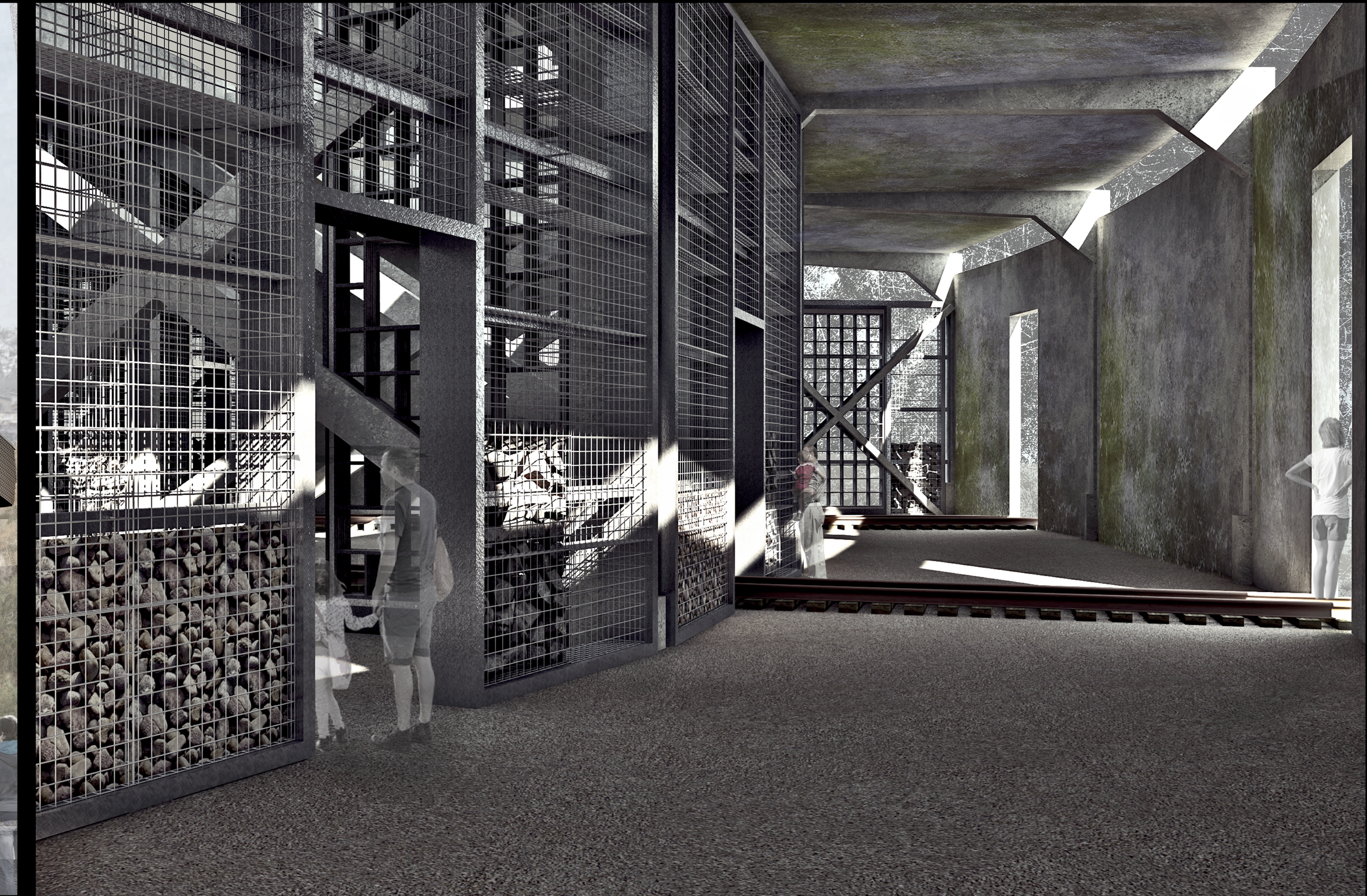

Memory vessels within the walls of the sanctuary/memorial. Encouraging people to let go, to share their stories, donating artifacts and possessions as part of the ritual and healing process. A collective memory project, constantly transforming itself