

C

O

N

T



I

N

U

U

M

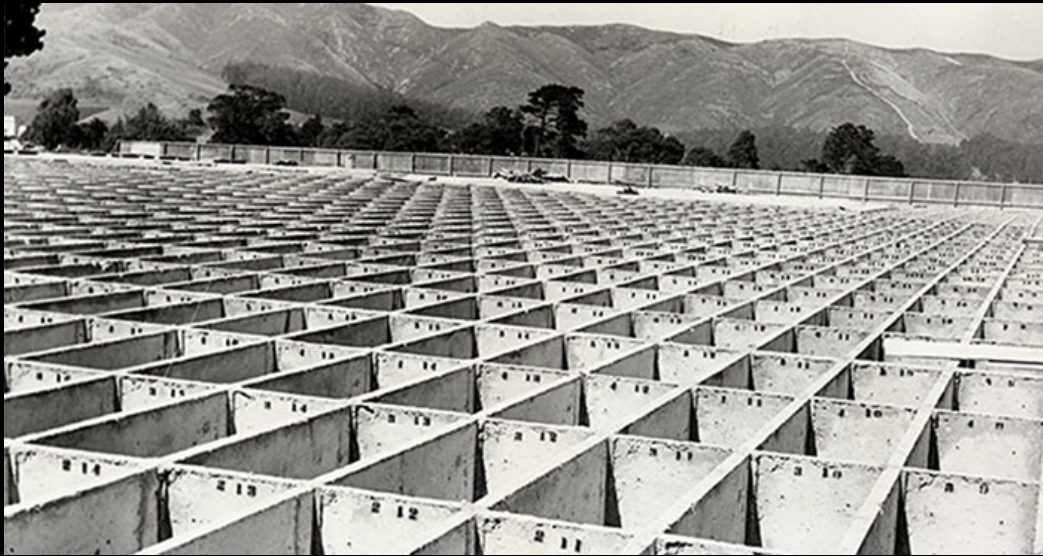

Construction of Colma Burial Vaults | Justin Crowe

“And yet there is perhaps no other experience in human life which so clearly marks the limits placed on that modern control of nature acquired through science and technology.”

-Hans -Georg Gadamer







Heliopolis Creation Story | Alamy

“The ancients, like the modern savages, saw man always as part of society, and society as embedded in nature and dependent on cosmic forces. For them nature and man did not stand in opposition and did not, therefore, have to be apprehended by different modes of cognition.”

-Henri Frankfurt



Anubis Attending Sennedjem's Mummy | Bridgeman Images

“The survival of the dead and their continued relationship with man were assumed as a matter of course, for the dead were involved in the indubitable reality of man's own anguish, expectation, or resentment.”

-Henri Frankfurt



Bennu Bird "The Myth of the Phoenix" | Fandon

"Death is not, as for us, an event – the act or fact of dying as Webster has it. It is somehow a substantial reality"

-Henri Frankfurt





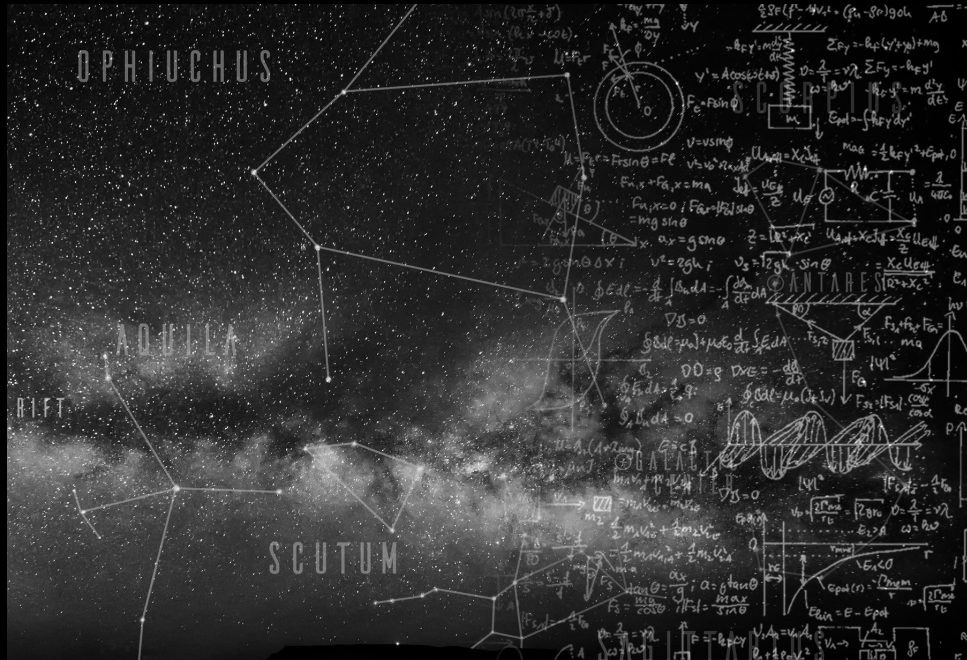

“Cartesian rationality finally destroyed the “fleshy” cosmos, revealing the world worked according to mathematical rules, Nature was invented. “Nature” (with a capital N) is that system, then, whereby everything non-human, but nevertheless subject to human-derived laws, is defined as Nature.”

-David Winterton



Dirt | Walker Young

“Nature must again be recuperated as the radical base for speculation in Western culture - not “Nature” as a mere observable fact, to be later assuaged into some use, but as the fleshy, foliate, earthy, and olfactory extension of ourselves.”

-David Winterton



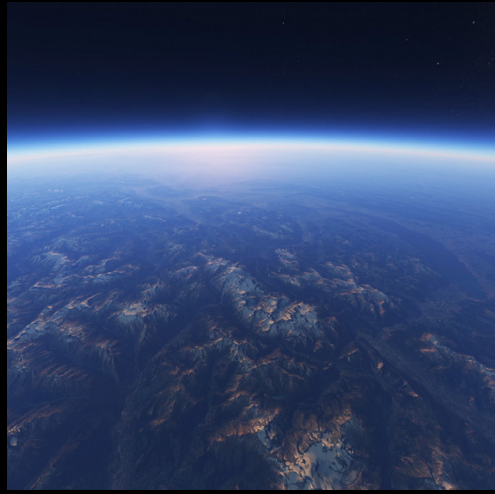













At the Foot of the Mountain | Sergiba

“It does not just connect banks that are already there. The banks emerge only as banks as the bridge crosses the stream. The bridge designedly causes them to lie across from each other...It brings stream and bank and land into each other’s neighborhood.”

-Martin Heidegger



Old Arch Bridge | Getty Images

“Always and ever differently the bridge escorts the lingering and hastening ways of men to and from, so that they may get to other banks and in the end, as mortals, to the other side.”

-Martin Heidegger





The History of US | HC

“Temporal reality is established as a historical order in which the individual stands, an order that assigns us our place and charges us with responsibility. This is to say, just as buildings establish regions, wrest place from space, so they establish temporal situations, place the individual in time, and not just in time, but in a communally shared time, in history...this revision of Heidegger’s understanding of dwelling calls for building responsively, not just to our mortality, but to a love that lets us experience ourselves as essentially incomplete, in need of others, in need of community.”

-Karsten Harries





“When memories blur and blot our vision, when we swallow that “lump” in our throat, or hear that “crack” in our voices, we can emotionally perceive that loved ones are behind it, that they are still there still intermingled, intermingling with us, as they must have been-all along.”

-Suzanne Cataldi



Justin Crowe | The Decline of San Francisco's Cemeteries



Justin Crowe | Removal of Cemeteries and Transfer to Colma





Justin Crowe | Colma



History of Psychology | Mary Fakhori

“Each person’s self has become his principal burden; to know oneself has become an end, instead of a means through which one know the world.”

-Richard Sennett





Soil | Getty Images

“By ignoring the soil’s own work, we destroy it and harm ourselves.”

-William Bryant Logan



Modern Funeral Procession | Dan Zichen

“The funeral procession – prompting everyone to remove their hats before the majesty of death as it drew past – is something that has disappeared from the life of the town.”

-Hans-Georg Gadamer

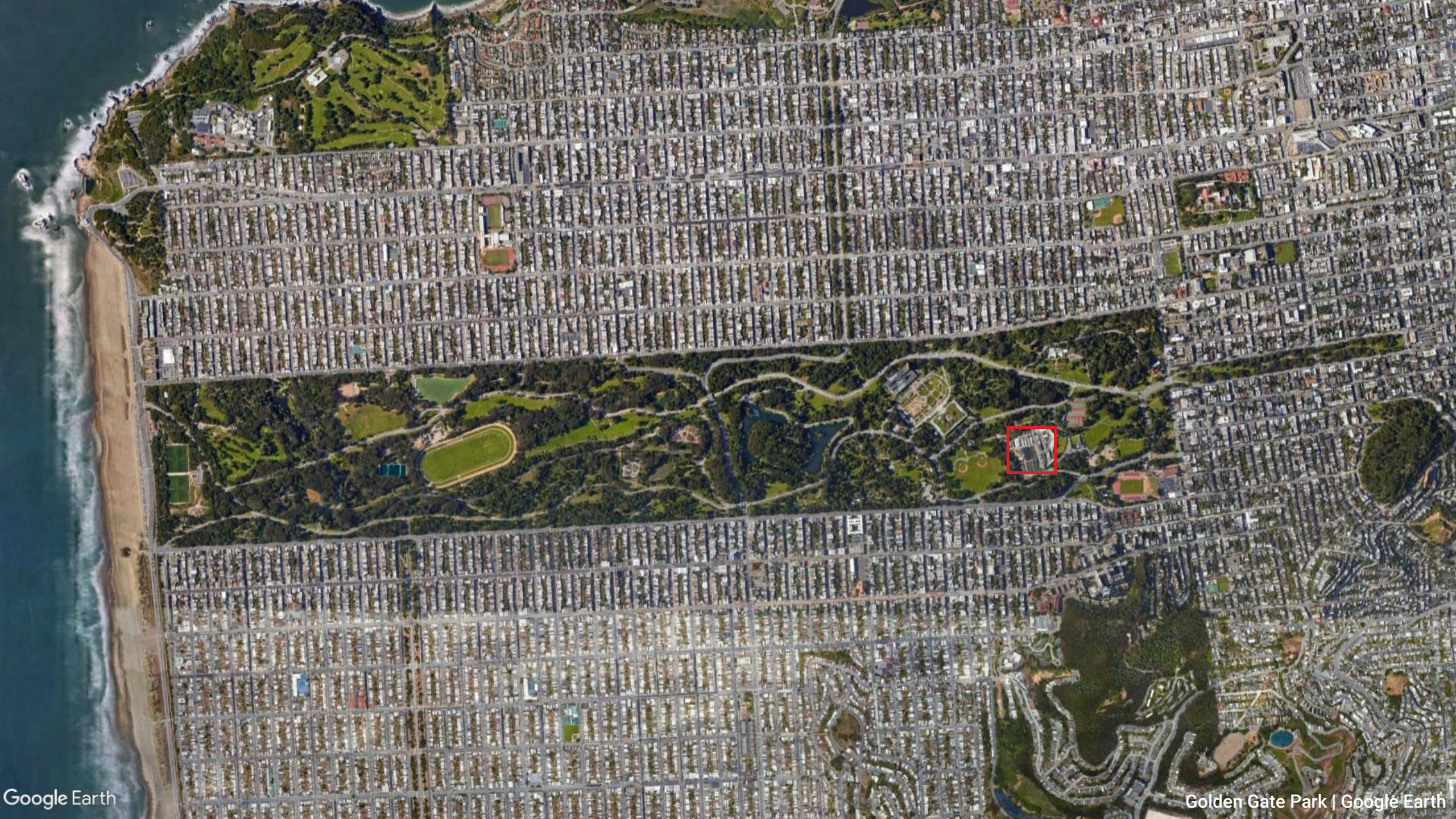

A satellite map showing the San Francisco Peninsula and the surrounding Redwood Forest. The city of San Francisco is visible in the lower right, with a red box highlighting a specific site in Golden Gate Park. The Redwood Forest is shown in the upper left, with a red box highlighting a specific area. The map is oriented with the city at the bottom and the forest at the top.

Muir Woods National Monument

Site in Golden Gate Park

San Francisco and the Redwood Forest









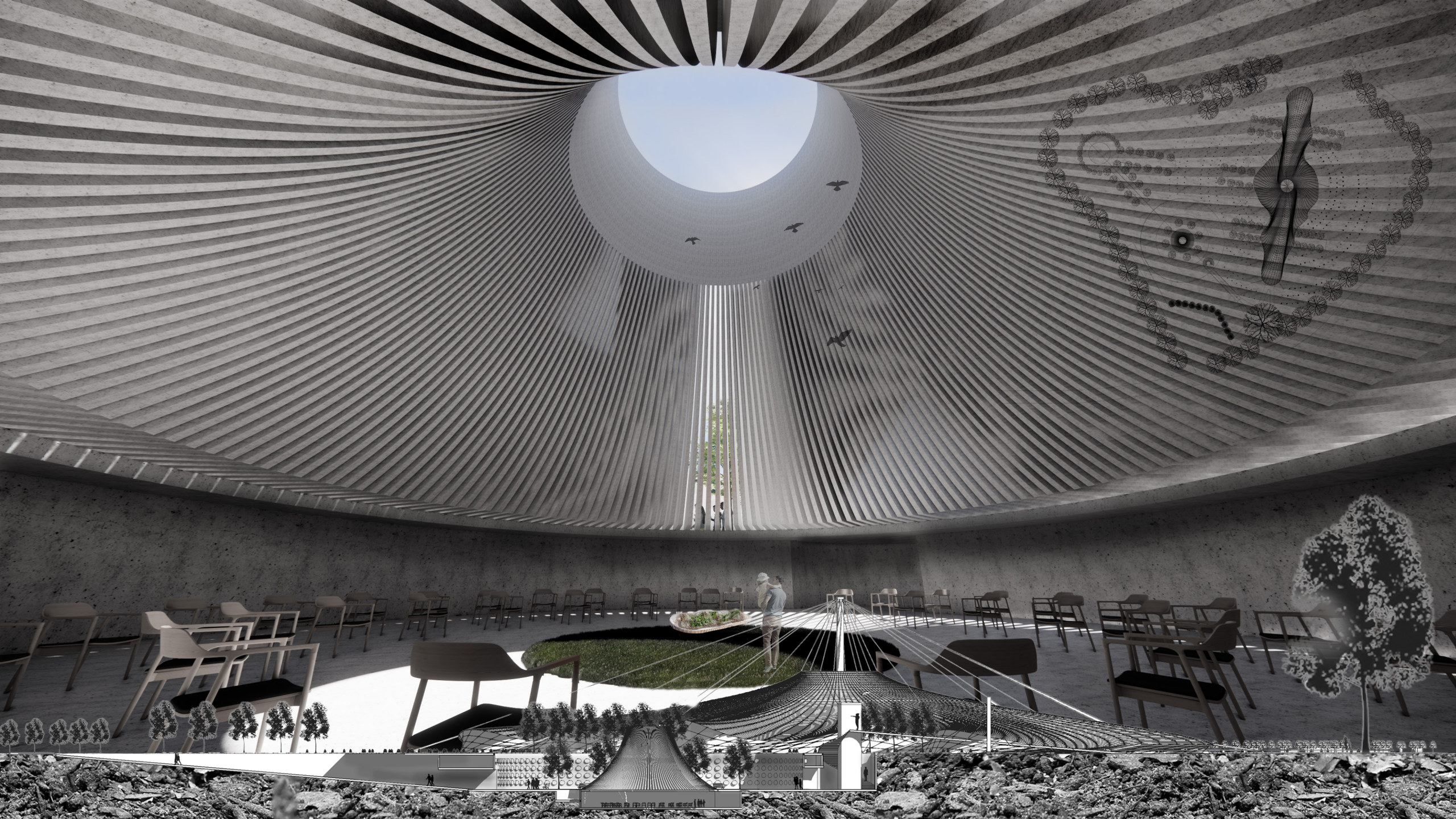



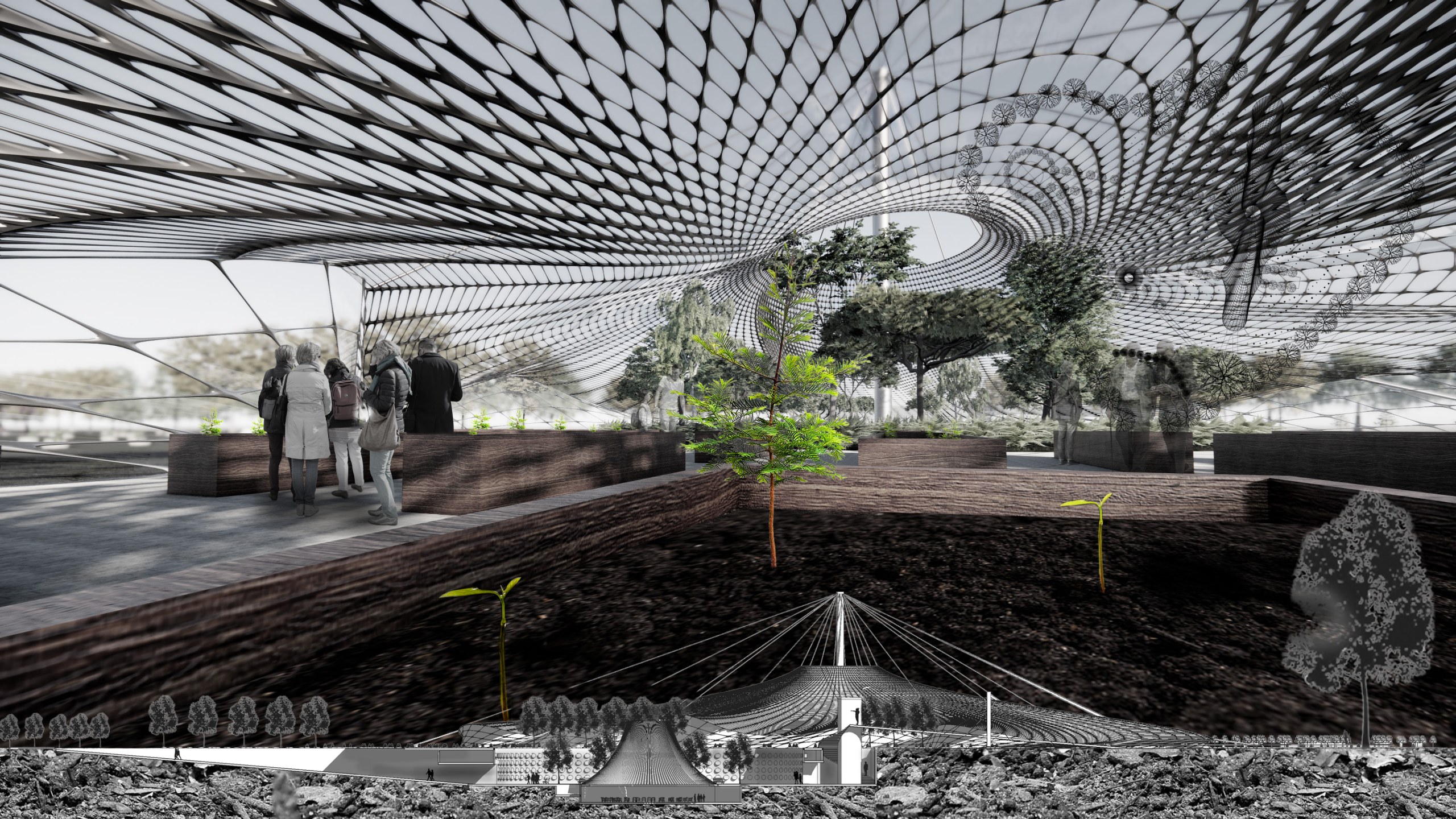

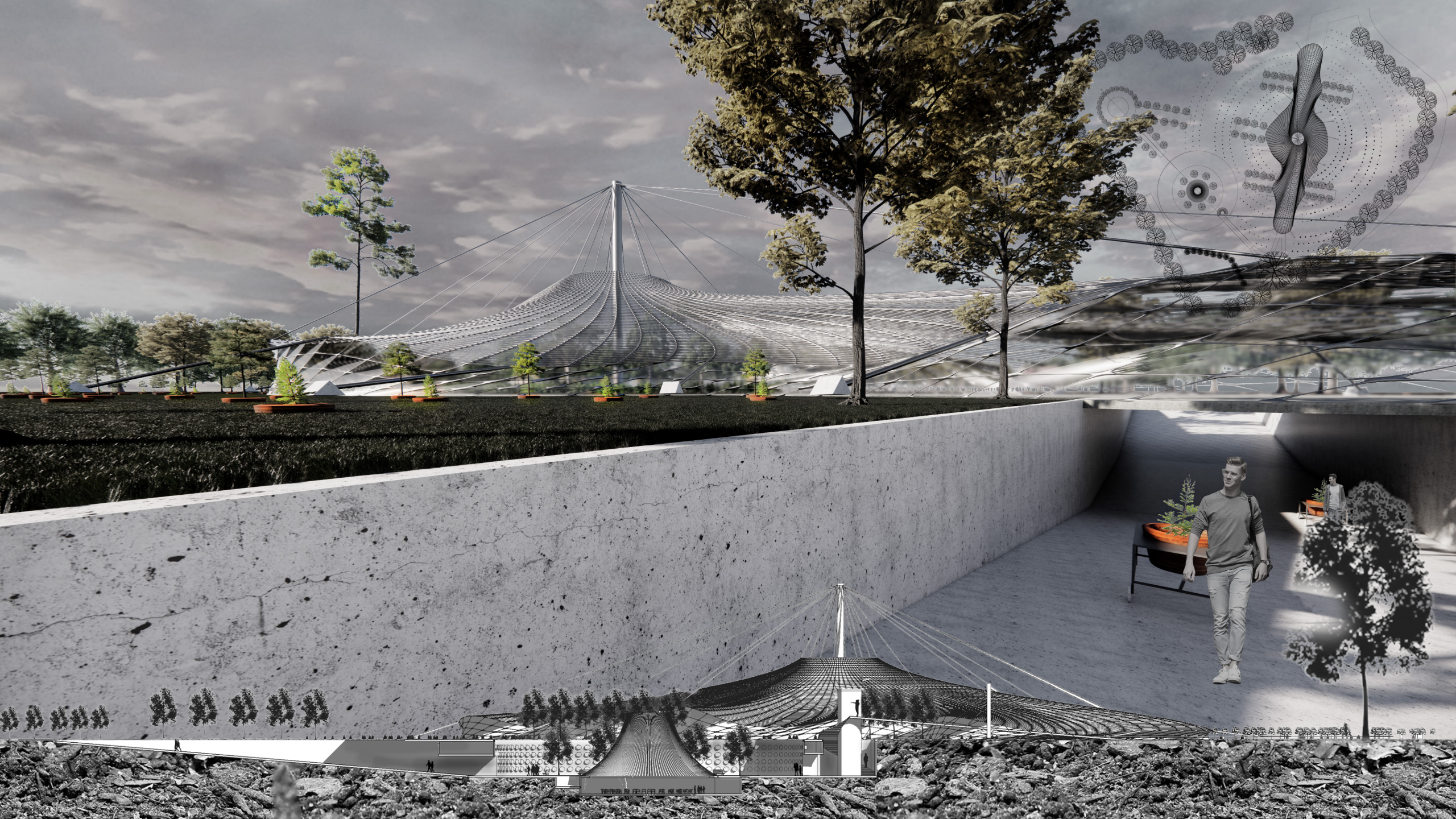



“Nothing gives man fuller satisfaction than participation in processes that supersede the span of individual life.”

-Gothard Booth

