

“

“EVERY LIE WE TELL INCURS A DEBT TO THE TRUTH.
SOONER OR LATER THAT DEBT IS PAID.”

— VALERY LEGASOV



C H E R N O B Y L

B E Y O N D D I S A S T E R

H O N O R I N G T H E P A S T , P R E S E R V I N G T H E F U T U R E







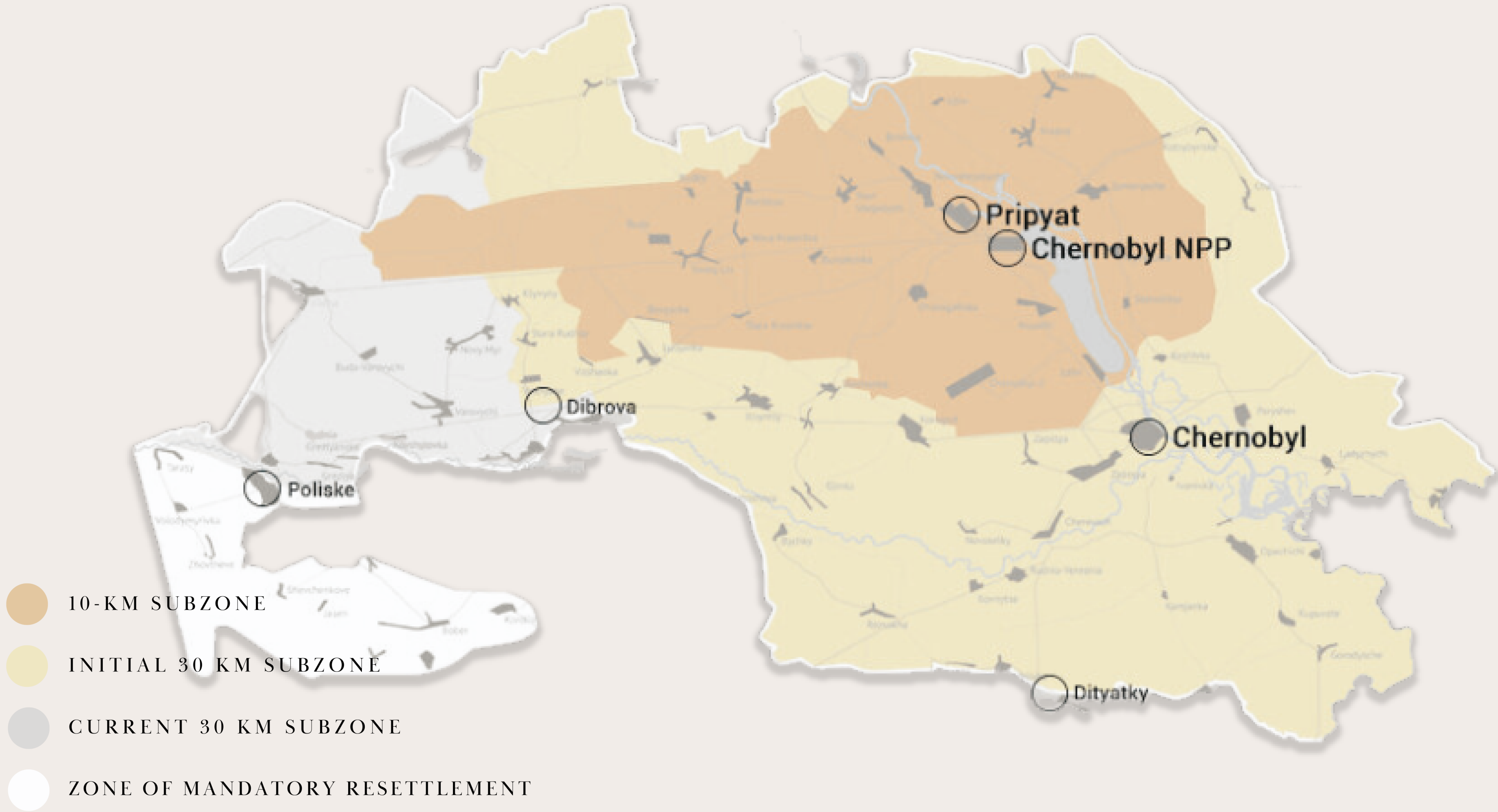









- 10-KM SUBZONE
- INITIAL 30 KM SUBZONE
- CURRENT 30 KM SUBZONE
- ZONE OF MANDATORY RESETTLEMENT

HOW MUCH RADIATION?

	Airport backscatter scanner	0.0001 mSv
	Bone density scan	0.001 mSv
	One day in Chernobyl Zone	0.003 - 0.005 mSv
	Dental posterior bitewing X-ray series	0.005 to 0.055 mSv
	Two days in Denver	0.006 mSv
	Panoramic dental X-ray	0.009 to 0.024 mSv
	Cross-country flight 	0.04 mSv
	Single chest X-ray	0.1 mSv
	Digital mammogram	0.4 mSv
	Average yearly dose from the sun etc.	3 mSv
	Chest CT	7 mSv
	Virtual (CT) colonoscopy 	10 mSv
	PET/CT (often use to diagnose cancer)	25 mSv
	Smoking a pack a day for a year	53 mSv

*1 mSv = 1 milisievert = 0.001 Sv

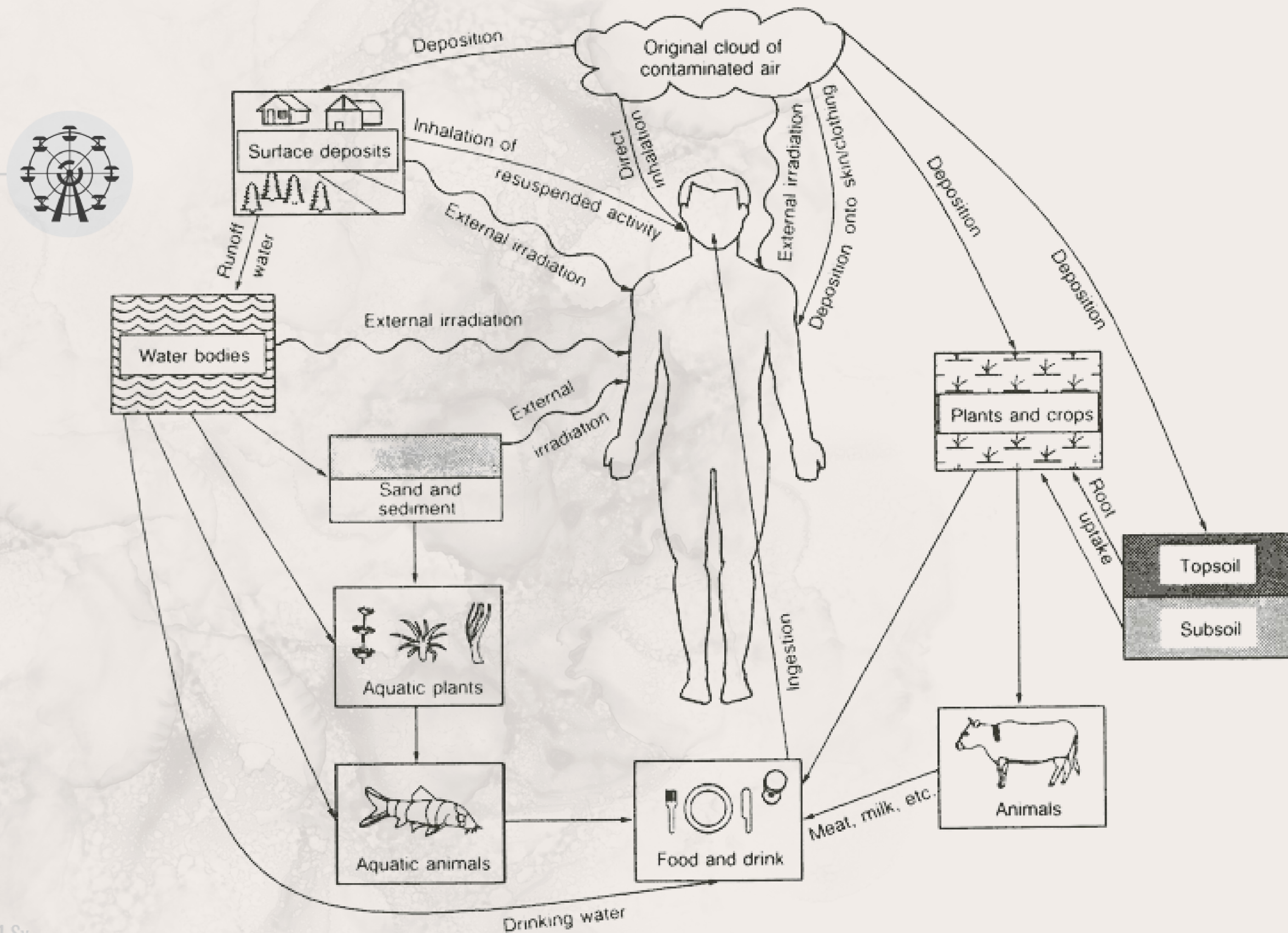





DARK TOUR·ISM

noun

Tourism directed to places that are identified with death and suffering, places where some of the darkest events of human history have unfolded.





ПРАЖДАТЬ

ДОБРО ПОЖАЛОВАТЬ

В АЗИИ
1970



A black and white photograph showing several workers in full-body protective suits and respirators working at the Chernobyl site. They are in a large, open area with industrial structures in the background. The workers are engaged in various tasks, some using tools like shovels. The scene is desolate and industrial, capturing the aftermath of the disaster.

HOW CAN WE CREATE A MEMORIAL THAT ENSURES
THE SAFETY AND EDUCATION OF VISITORS, WHILE
ALSO PROMOTING THE PROTECTION AND
PRESERVATION OF THE HISTORICAL CHERNOBYL SITE?

“

“CHERNOBYL SHOULD NOT BECOME A WILD PLAYGROUND
FOR ADVENTURE HUNTERS,”

“PEOPLE SHOULD LEAVE THE EXCLUSION ZONE WITH THE
AWARENESS OF THE HISTORICAL MEMORY OF THIS PLACE AND
ITS IMPORTANCE FOR ALL MANKIND.”

--UKRAINIAN CULTURE MINISTER OLEKSANDR TKACHENKO

PROJECT GOALS

01

Preservation &
Education of History
& Culture

02

Conservation of
Natural Heritage

03

Sustainable &
Responsible tourism

04

Safety & risk
Management

PRIPYAT, UKRAINE



An aerial photograph of the Prip'yat River and the Chernobyl Nuclear Power Plant (NPP). The river flows from the top left towards the bottom right. The Chernobyl NPP is located in the lower center of the image. A large white circle on the left side of the image highlights a section of the river. A horizontal white line extends from the right edge of this circle to the text 'PRIPYAT'. A smaller white circle highlights the Chernobyl NPP. A horizontal white line extends from the right edge of this circle to the text 'CHERNOBYL NPP'. A dashed white line connects the two circles, with the text '2 MILES' written along it.

PRIPYAT

2 MILES

CHERNOBYL NPP









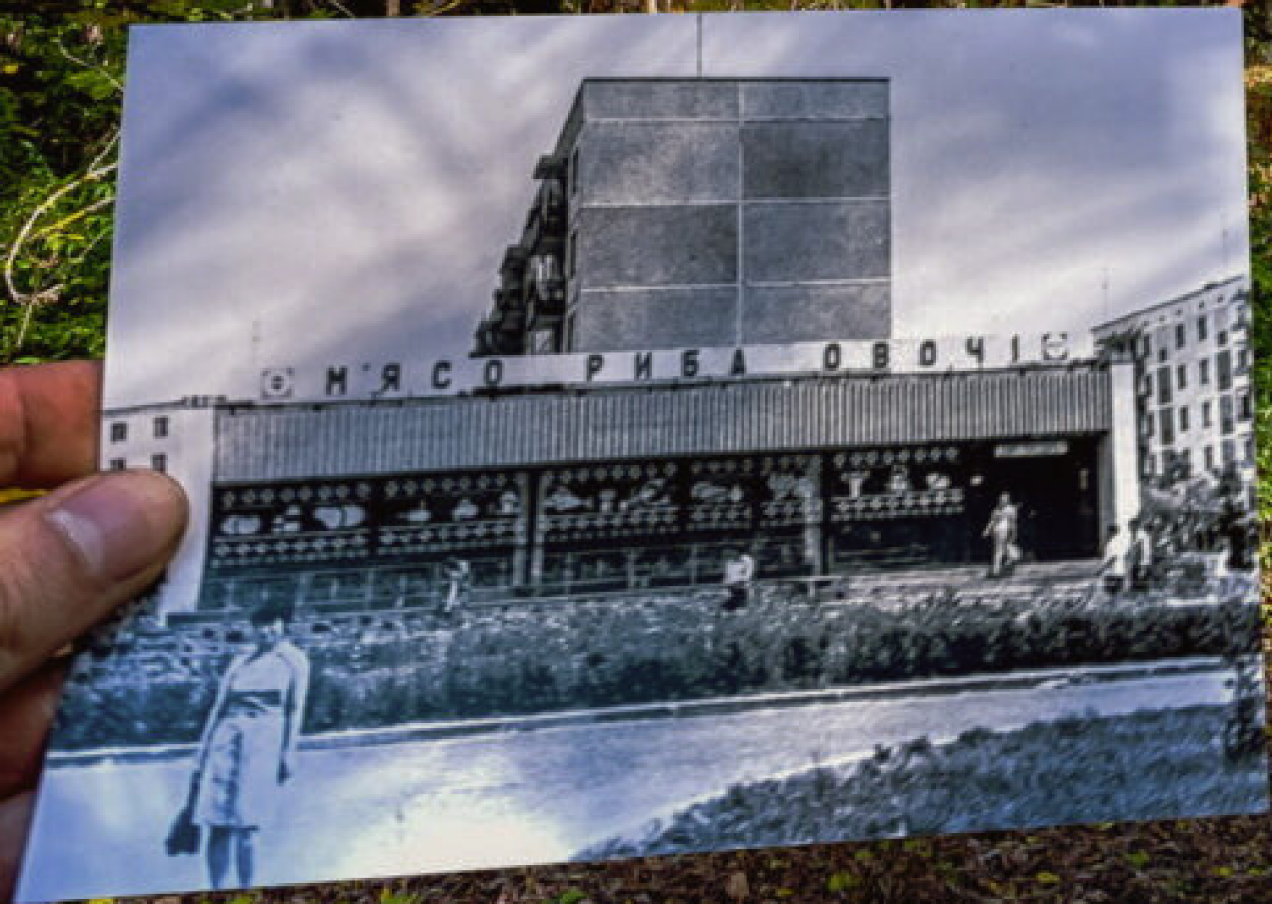





AMUSEMENT PARK

AZURE SWIMMING POOL

HOTEL POLISSYA

PALACE OF CULTURE



Allows visitor to view nature without disrupting/destroying it

Animals can move freely under

Path weaves through town to ensure safety give views into facilities

viewing decks shaded structure

Path weaves through town

PHYTOREMEDIATION FIELD

PEDESTRIAN PATHWAY

HOTEL PODS

VISITORS CENTER



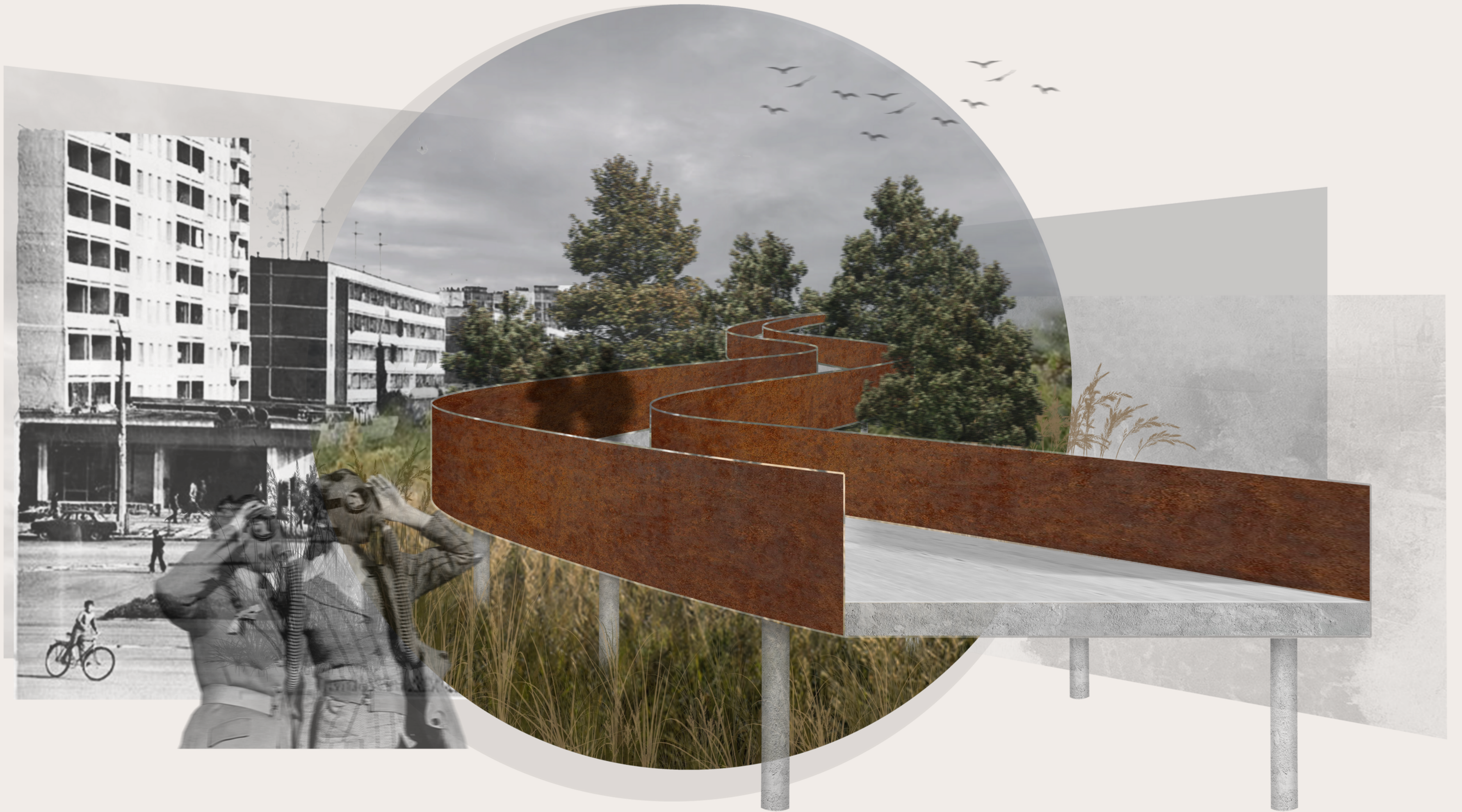

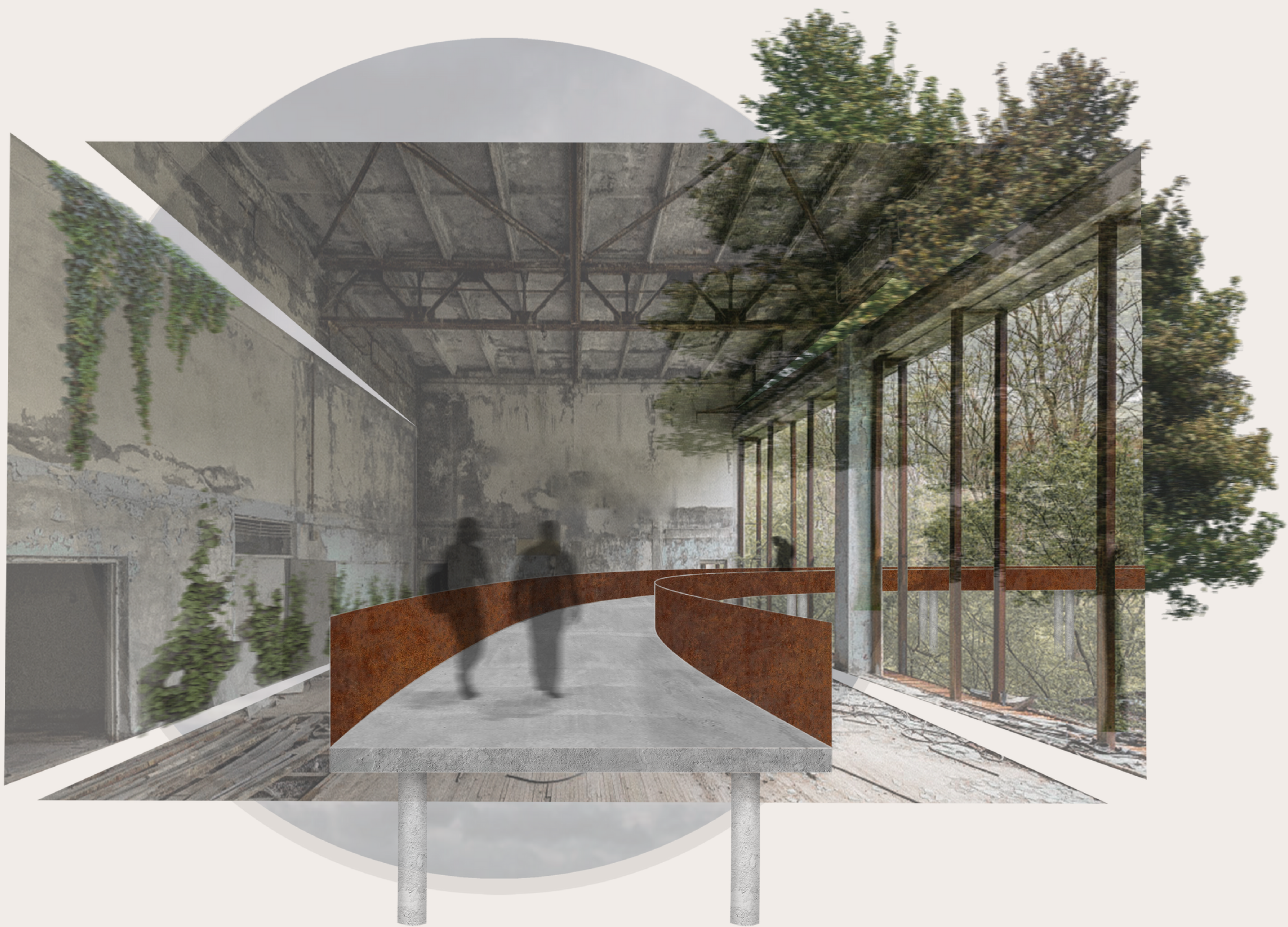

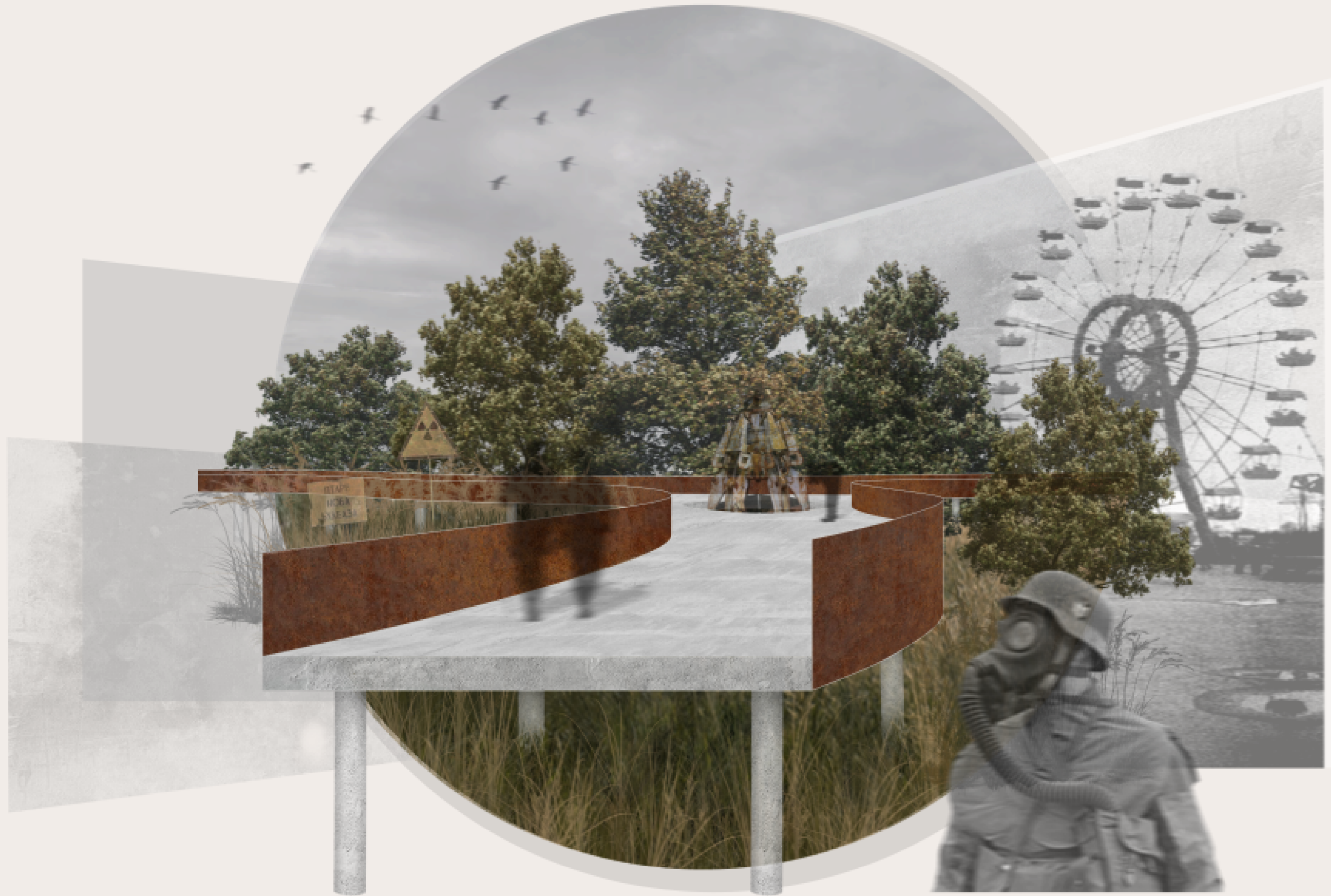



Operable louvers provide an open air ventilation systems to help prevent the buildup of radioactive particles in indoor spaces, creating a safer and healthier environment for occupants.

The implementation of plants into the memorial garden aid to absorb and filter out radioactive particles from the soil, reducing the risk of exposure to humans and animals.

The use of concrete is an effective shielding material against radiation, with a thickness of 12 inches, it reduces gamma radiation by up to 50%.

VISITORS CENTER

CHECK IN LOBBY



VENDOR SPACE



GALLERY SPACE

EXHIBIT SPACE

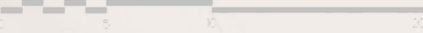



GALLERY SPACE



FLEX SPACE

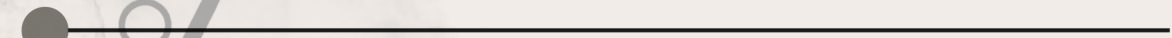



BREAKOUT SPACE

MAINTENANCE

RESTROOMS

VENDOR STORAGE

STAFF BOH

GALLERY STORAGE





MEMORIAL GARDENS





MEMORIAL GARDEN

HOTEL PODS

Lead-lined glass is an effective solution for filtering up to 99% of radiation, providing protection while also allowing natural light into the space.

A modular prefabricated concrete structure reduces the spread of excess radioactive dust particles by enabling a controlled, efficient, and safe construction process.

A simple elevated metal structure provides an efficient construction process and provides protection to visitors and the surrounding landscape.

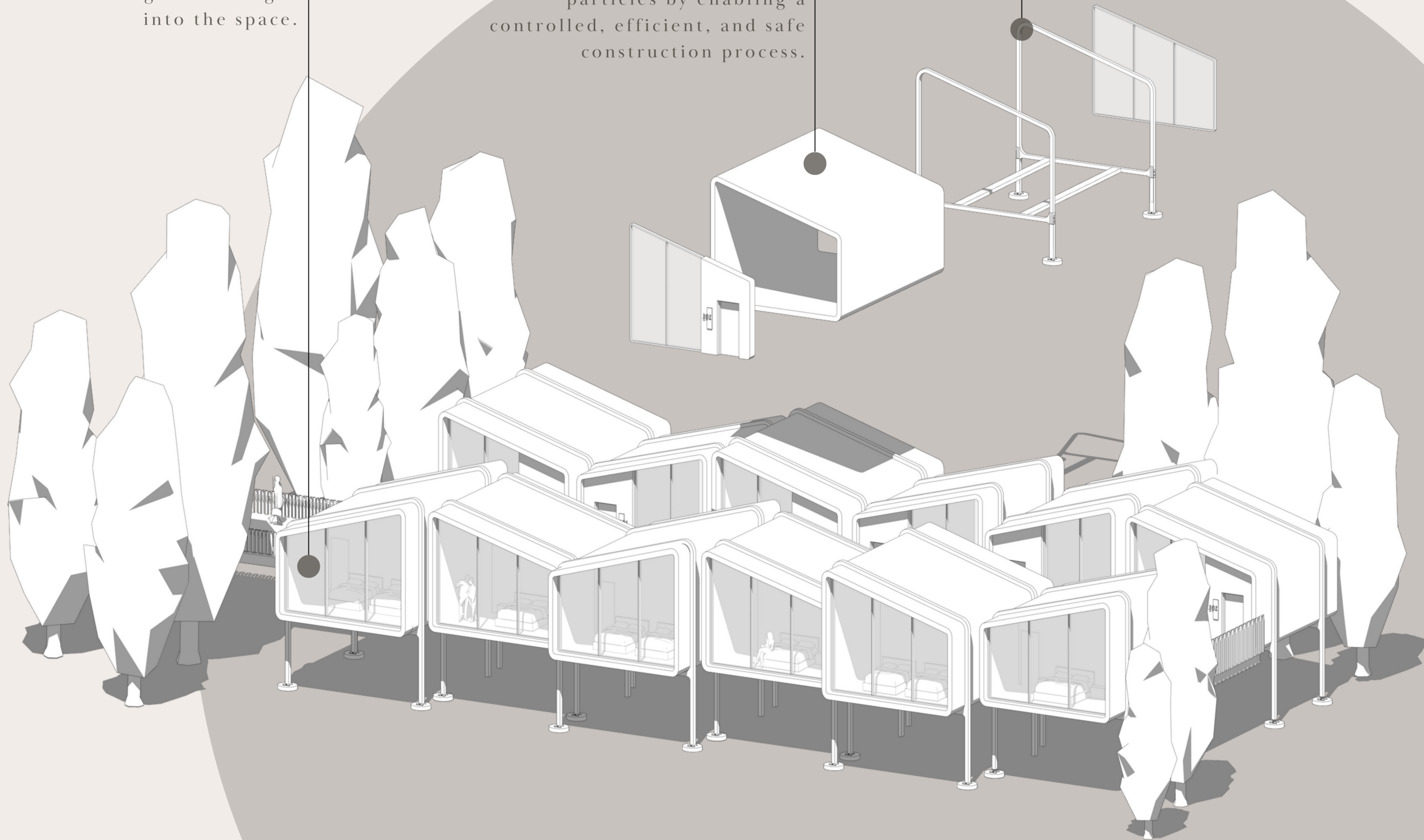

HOTEL POD LAYOUT



- 1 DECONTAMINATION
- 2 STORAGE
- 3 BATHROOM
- 4 KITCHENETTE
- 5 LIVING



HOTEL PODS

A wide-angle photograph showing a vast field of sunflowers in the foreground. In the background, a dense line of trees separates the field from an industrial facility, which includes several buildings and tall smokestacks, one of which has red and white bands. The sky is a pale, clear blue with several birds in flight. The overall scene suggests a juxtaposition of nature and industry.

THE PRESERVATION OF THE FUTURE LIES IN THE CAREFUL CULTIVATION OF THE PRESENT.

PHYTOREMEDIATION

THANK YOU



PROJECT OVERVIEW

The Chernobyl disaster of 1986 was a catastrophic event that left a scar on the land and a wound in the hearts of all who lived through it. The disaster had a devastating impact on the people of Ukraine, leaving families separated, children without parents, and entire communities in mourning. However, amidst the tragedy, there has been a desire to honor the lives lost, to remember the victims, and to look towards the future. The concept has evolved from a place of remembrance, education, healing, and growth. This architectural thesis presents the concept for a memorial development located in the ghost town of Prypiat.

The vision for Chernobyl: Beyond Disaster is to create a beacon of hope for the survivors, a place of learning and reflection for visitors, and a way to honor the memory of those affected by the disaster. The proposed development serves to become a tribute to the beauty of nature, and a symbol of the human spirit's ability to create something beautiful out of darkness. The project aims to provide a place where the memory of the past is honored, and a brighter future is forged.

The objective of the proposed development is to commemorate the resilience of the human spirit and demonstrate the potential for rebirth after such devastation. This thesis shares the design of a memorial development that not only honors the victims but also pays tribute to the natural beauty of the site. The proposed development is a space that is sustainable, flexible, and aligned to the existing requirements of the location and its inhabitants. A place where security, safety, and nature work of the former inhabitants, but where time and growth could still flourish. The project aims to serve as a place for visitors to reflect, learn, and grow while also ensuring that the lessons of the past are not forgotten.

HOTEL PODS

1 DECONTAMINATION
2 STORAGE
3 BATHROOM
4 KITCHENETTE
5 LIVING

The hotel pods offer visitors an immersive and safe experience while also preserving the surrounding natural environment. The elevated design of the pods helps minimize the risk of contamination through air and contact. These pods are designed to blend into the existing landscape and are equipped with modern amenities to ensure comfort during the stay. The architectural design provides a necessary separation between the pods and the surrounding environment, ensuring their safety while still allowing them to be part of the Chernobyl experience while ensuring the utmost safety and comfort.

VISITORS CENTER

The proposed visitors center is a central component of the memorial development serving as a hub for visitors and a central location for learning and reflection. The center is strategically located at the convergence of both sides of the elevated path, representing the coming together of people from all sides of the world in their desire to see their impacts to the victims of the disaster and honor the ongoing efforts to address and reverse the crisis. Visitors are encouraged to follow the paths taking in the surrounding landscape and allowing themselves to be immersed in the experience of the memorial garden, featuring a single tree standing as a symbol of hope, regeneration, and the resilience of human ability to overcome disaster.

The visitors center is also designed to incorporate educational gallery spaces throughout, providing visitors with a comprehensive understanding of the disaster and its aftermath. The center is envisioned as a place of remembrance, education, and healing, offering visitors a safe and informative space to see their impacts to those affected by the disaster, while also learning about the importance of nuclear safety and the ongoing efforts to mitigate the effects of nuclear disasters. The memorial garden serves as a poignant reminder of the impact of the disaster, while also offering a space for growth and hope for the future.

- LOBBY
- STAFF BOH
- VENDOR
- STORAGE
- MAINTENANCE
- RESTROOM
- GALLERY FLEX SPACE
- EDUCATION BREAK OUT
- MEMORIAL GARDEN
- PATH ENTRANCE & EXIT

Disposable filters provide an easy-to-use ventilation system to help prevent the risk of radioactive particles in the indoor spaces, creating a safe and healthful environment for occupants.

The implementation of plants into the memorial garden aid to absorb and filter out radioactive particles from the soil, reducing the risk of exposure to humans and animals through phytoextraction.

The use of concrete is an effective shielding material against radiation, with a thickness of 10 inches, a radiation gamma reduction by up to 90%.

ELEVATED PEDESTRIAN PATH

An elevated pedestrian path through Chernobyl offers visitors a safe and immersive way to explore the site. The path is designed to provide a safe and informative way to see the impacts of the disaster and the ongoing efforts to address and reverse the crisis. The path is designed to be a safe and informative way to see the impacts of the disaster and the ongoing efforts to address and reverse the crisis. The path is designed to be a safe and informative way to see the impacts of the disaster and the ongoing efforts to address and reverse the crisis.

CHERNOBYL REACTOR T4
PRIPYAT

