



RETROFITTING
ARCHITECTURAL
ENVIRONMENTS
IN RESPONSE
TO AN EVOLVING
WORKPLACE



HI!

I'm Lexi!

- Western North Dakota native
- Community enthusiast
- History marvel
- Covid-19 education conqueror



HOW CAN OUR ARCHITECTURAL
ENVIRONMENTS AFFECT OUR
PRODUCTIVITY?

HOW CAN WE, AS DESIGNERS,
RESPOND TO THE DEMAND OF THE
SHIFTING WORKPLACE?



Why Office Buildings Are Still in Trouble

Hybrid work, layoffs and higher interest rates are leaving lots of office space vacant and hurting the commercial real estate business.

Don't Fret About Empty Office Space—Repurpose It

Tech Layoffs Mean Even More Empty Offices in NYC, San Francisco

A pullback by tech tenants means trouble for landlords already struggling with empty buildings.

There's no easy fix for Midtown's post-COVID half-empty offices

By *Nicole Gelinis*

February 27, 2023 | 7:56pm | Updated

SOCIETY

What Should We Do With All the Empty Offices?

January 3, 2023

What's Going to Happen to All Those Empty Office Buildings?

Getting Creative With Vacant Office Space: Storage, Gym, Film Set

Some landlords are skipping residential conversion and instead seeking alternatives that are cheaper and easier to manage.

COMMERCIAL · Published April 13, 2023 6:18am EDT

Commercial real estate industry on edge as downtown empty office space goes unused

INITIAL QUESTIONS

for vacant office buildings post Covid-19 pandemic

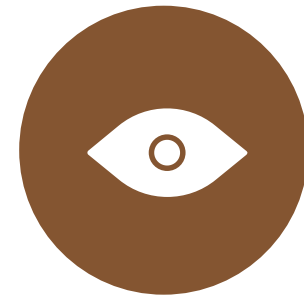

What are these vacant office buildings doing now?



What new amenities is the workplace demanding?



How can we best repurpose buildings?



Are there any design principles we should be abiding by?



Who are these building destined to serve?



How can we redesign and repurpose + still respect community history?



6 WAYS CORONAVIRUS WILL CHANGE THE WORLD OF WORK

1.
Remote work will become a widely accepted alternative to location-based work.

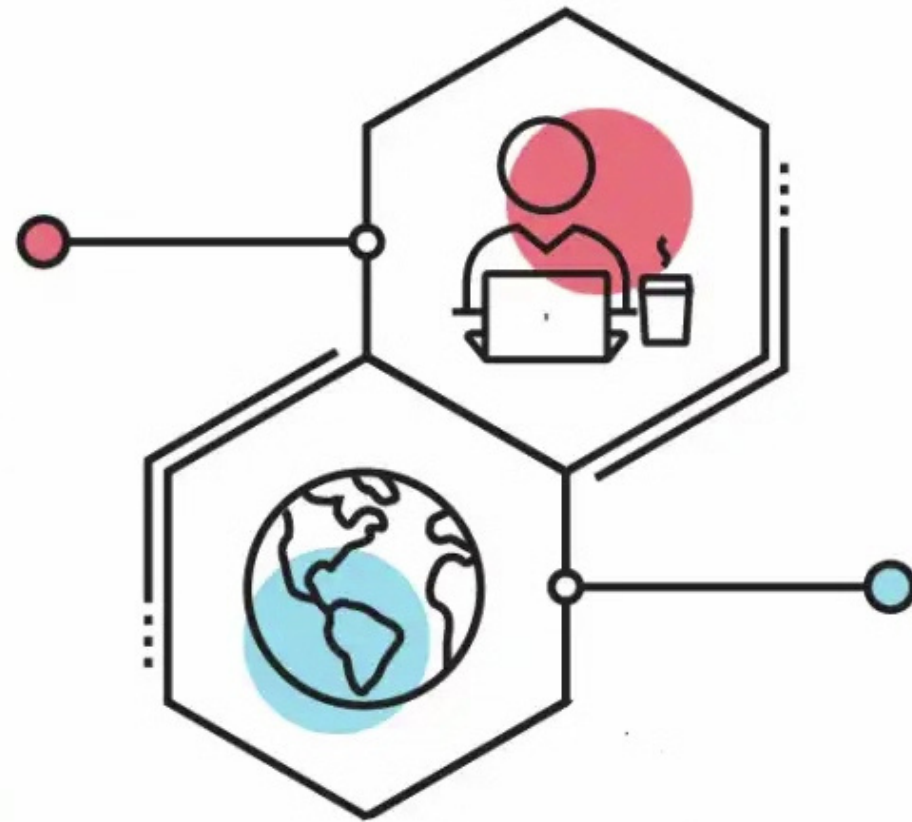

2.
Finding talent will become easier as new hires will be available globally via remote work.

Work is changing...
and our environments need to be a reflection of that.

map of vacant offices in New York City

Patterns to
inform
redesign...



Prototype Project

This project uses universal tendencies and design patterns to sculpt a series of design principles that are desired in our new workplace.

Intentional Interventions

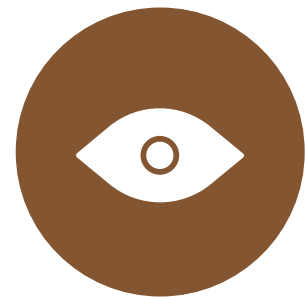

Affordable

- competitive to lease
- maximizing the square foot
- product selection

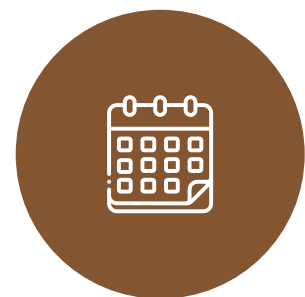

Accessible

- big city vs small town
- all remote working people & investors

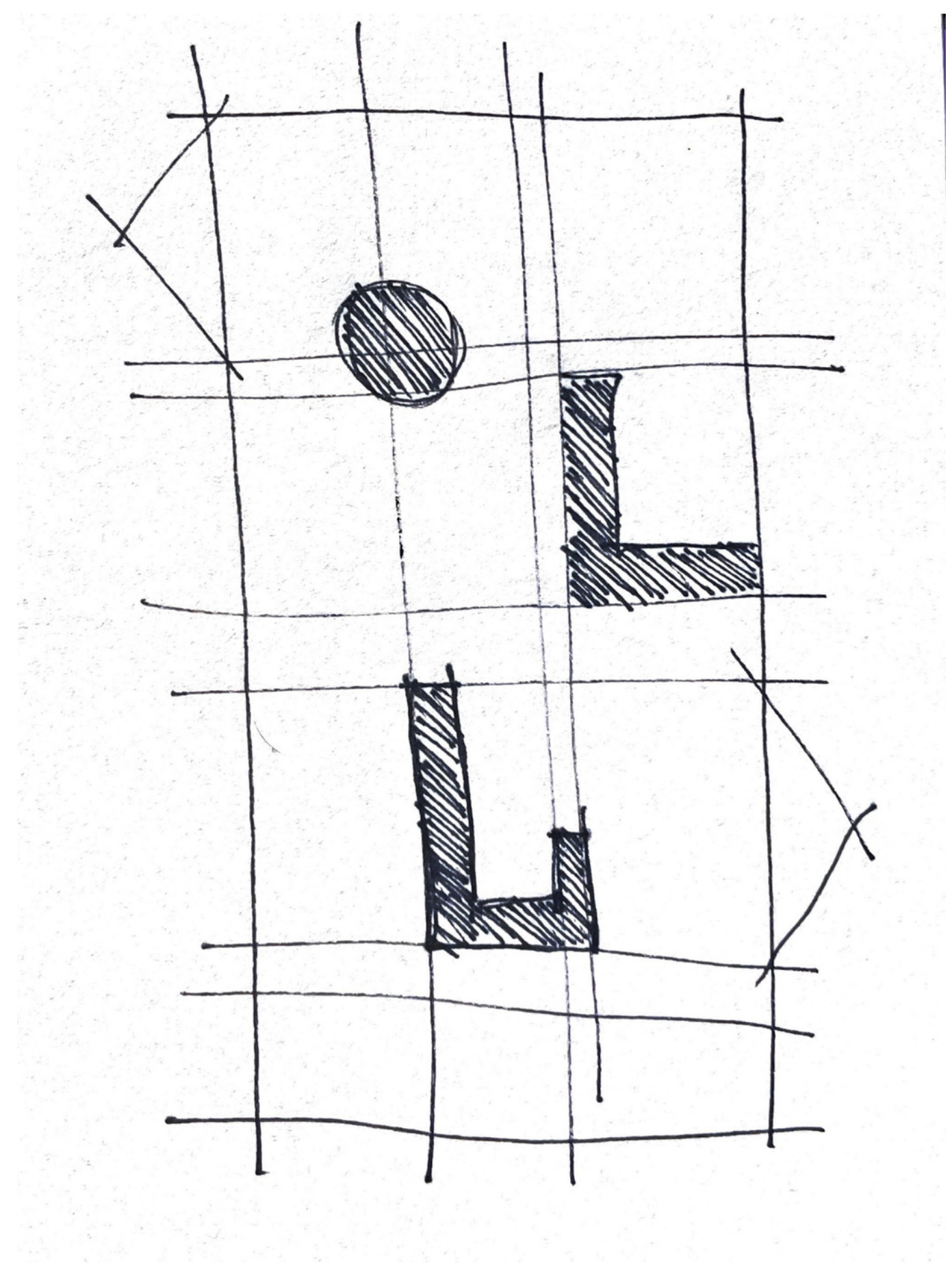

What makes an environment feel comfortable?

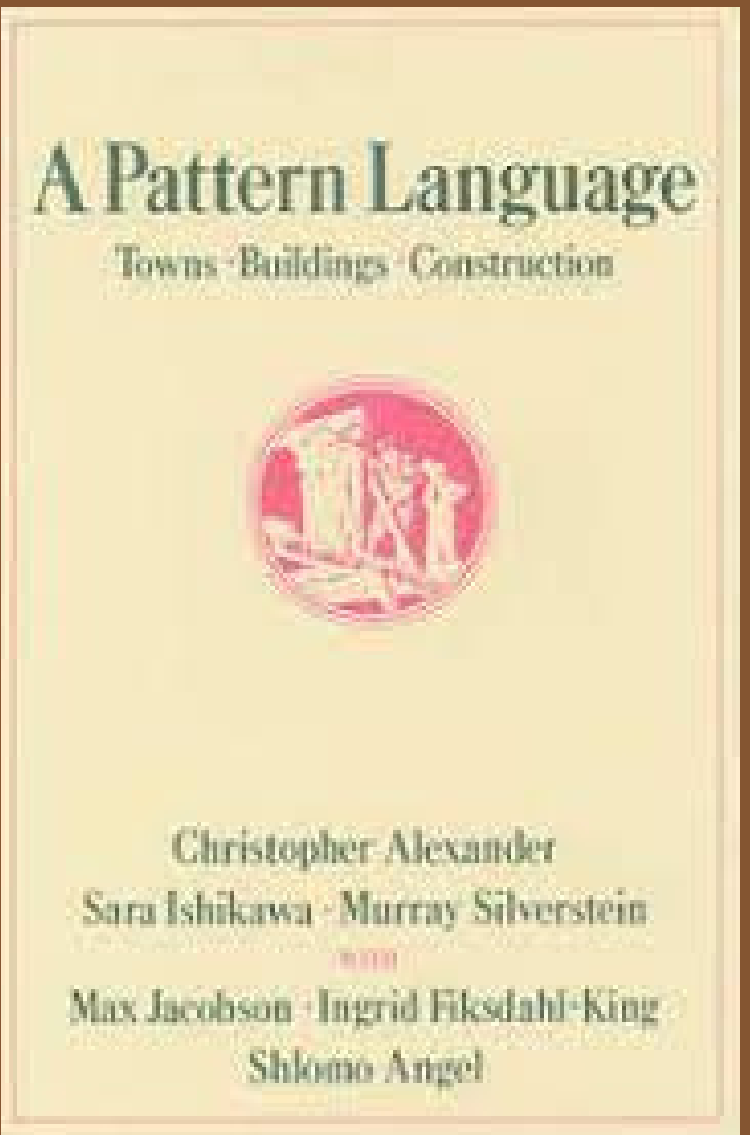
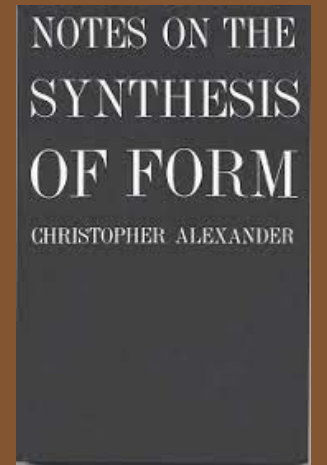
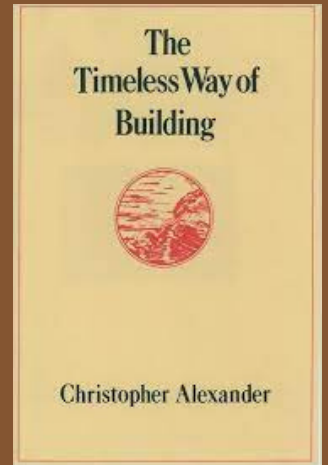
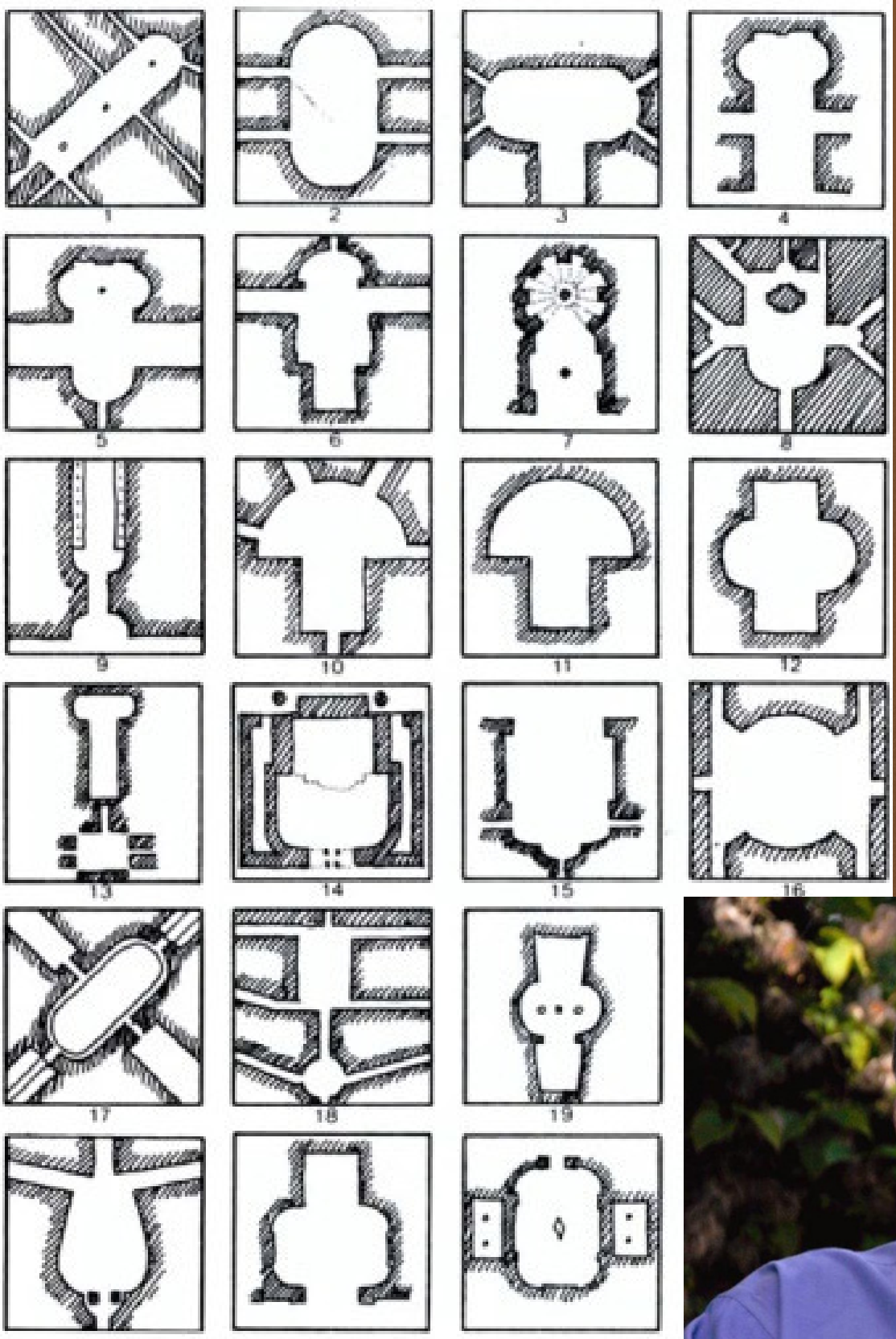
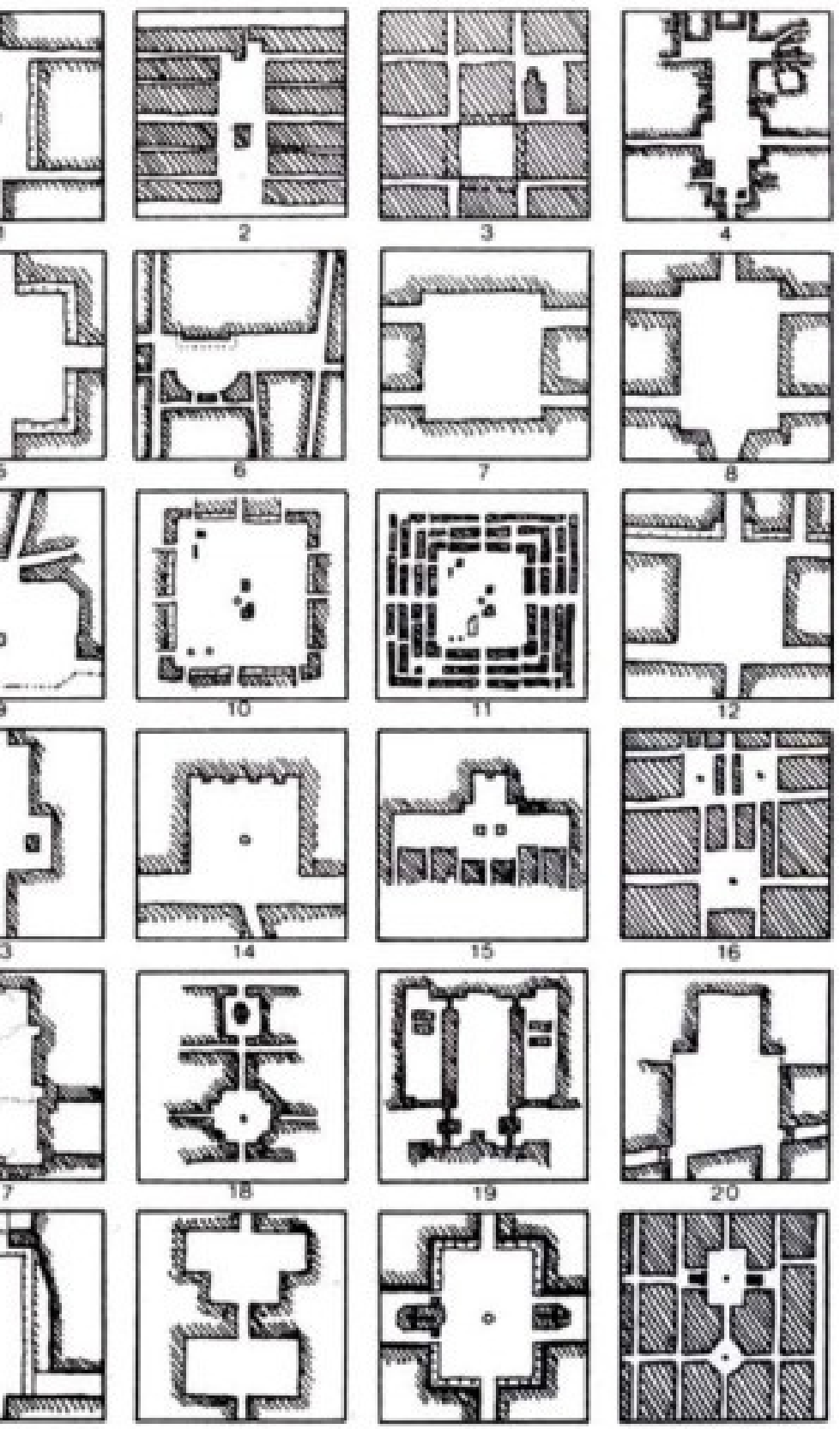

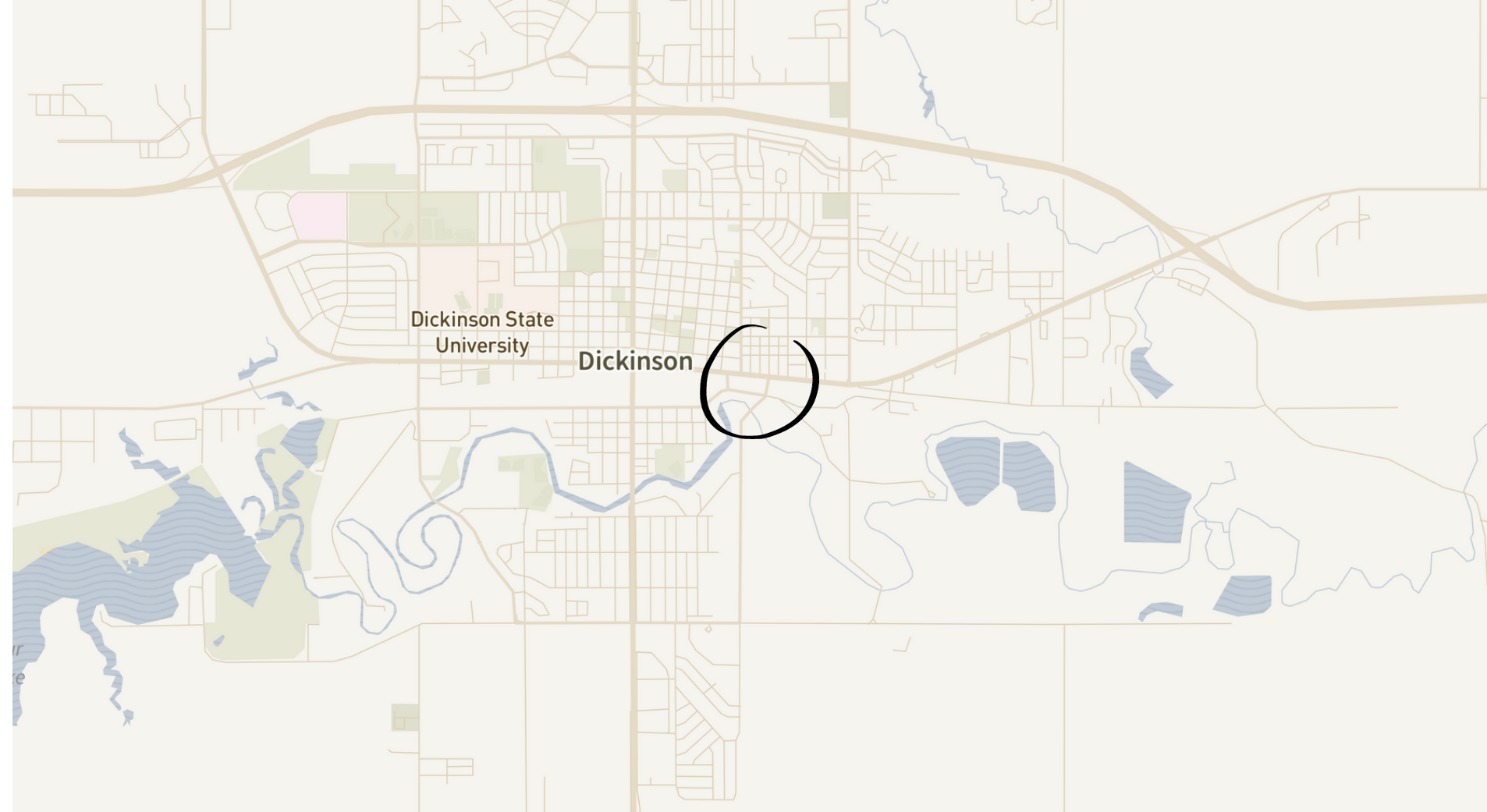
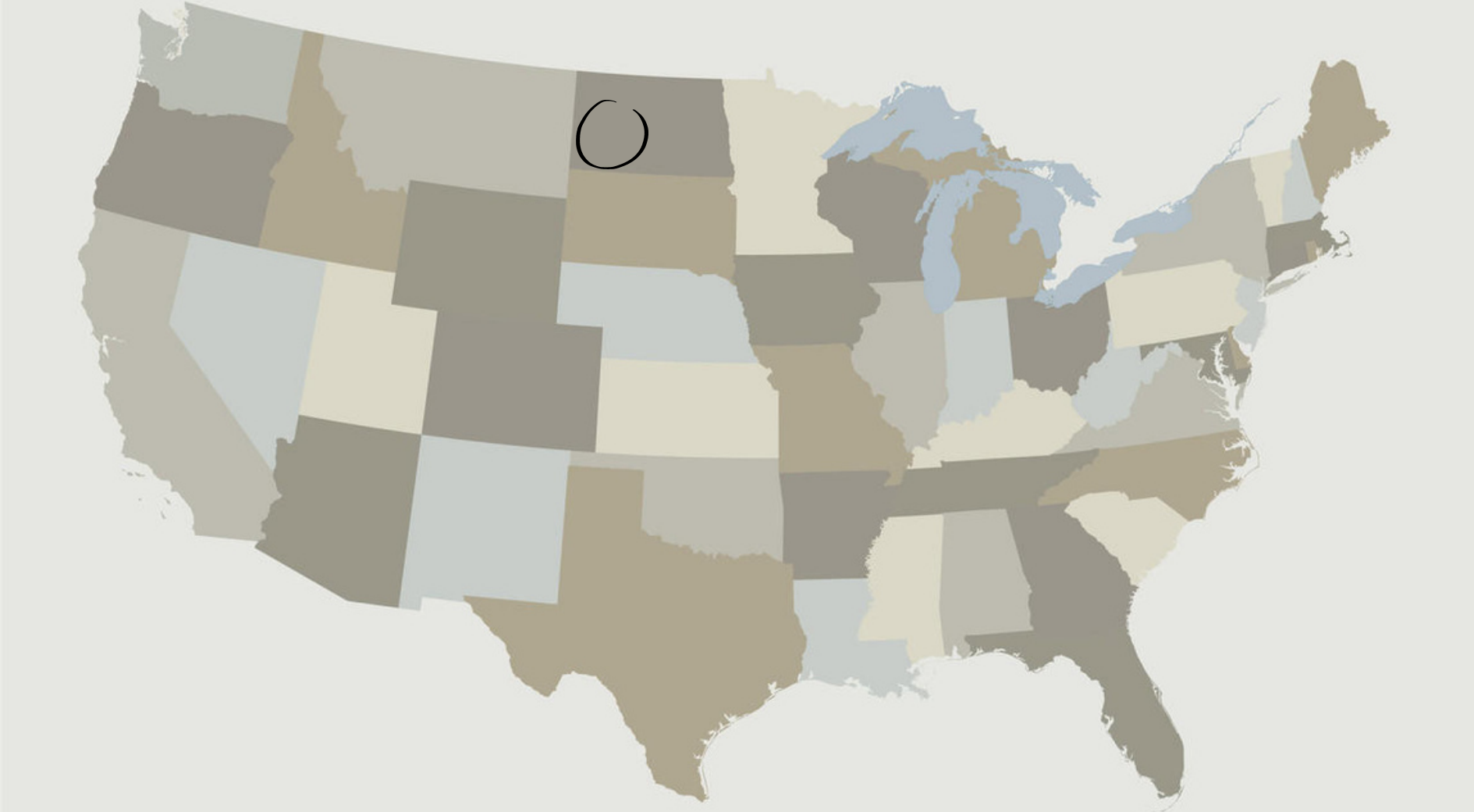

Site + Building Selection





41 East Villard St.

a landmark in hopes of a new life

- Fire burnt the building to ground in 1950
- Ray Hotel functioned from 1952-1970
- Ivanhoe Inn functioned from 1971-1987
 - home to many travelers (being adjacent from railroad station)
- Plaza took modern day ownership approach in 1995



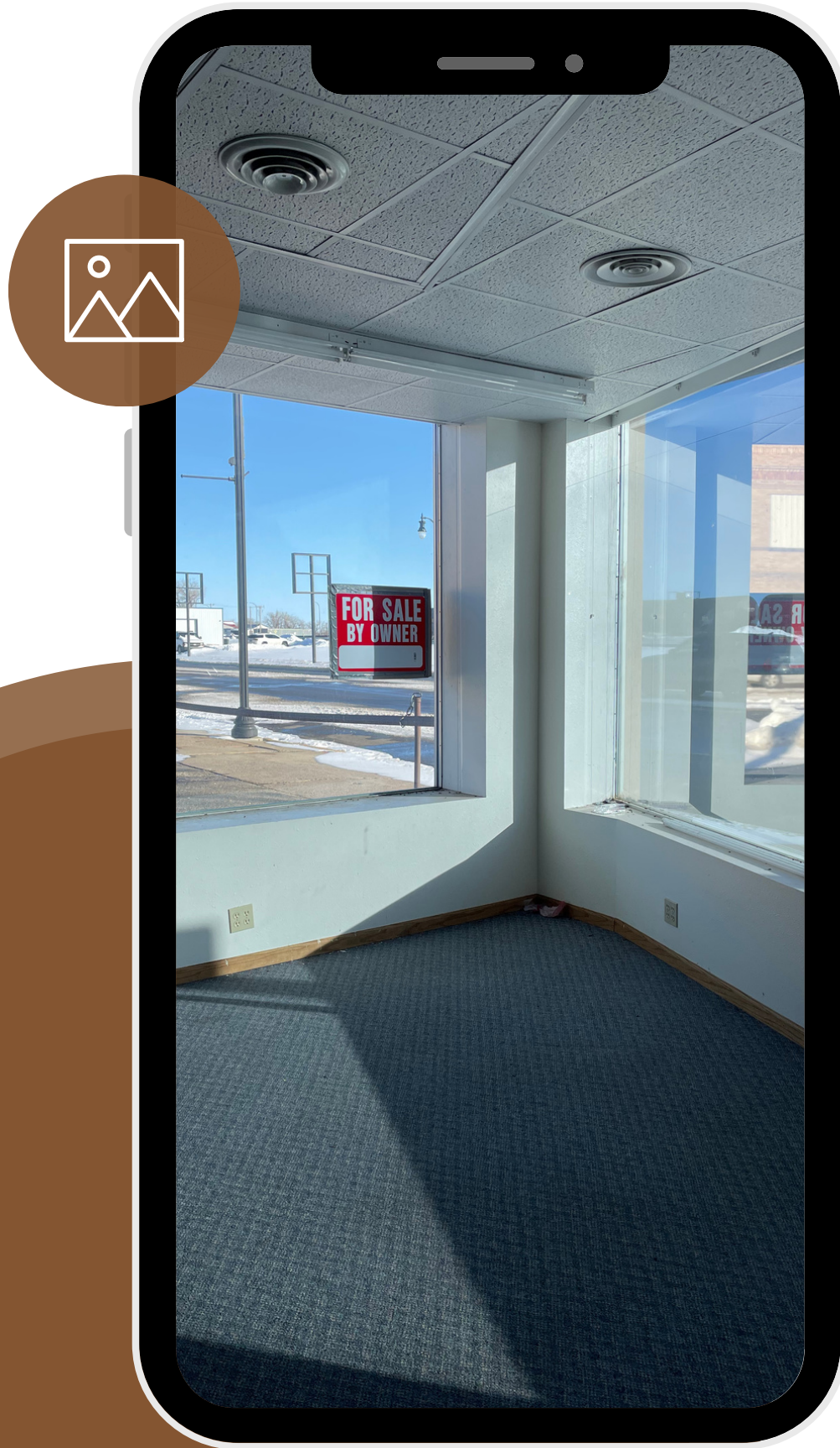

Project Emphasis

"...to design a place that people love to be in, that is the ultimate form of sustainability."



Retrofit

Designing subtle interventions that use Christopher Alexander's timeless design principles as a pathway



Materiality

Choosing products that are affordable, accessible, and sustainable for the environment they came from, and the environment they will go to (VOC conscious).



Marketability

How can we design sustainable buildings that will withstand "crisis" in the future?



Medora

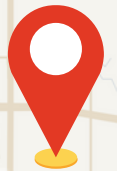

Dickinson

Belfield

South Heart



DIK



N

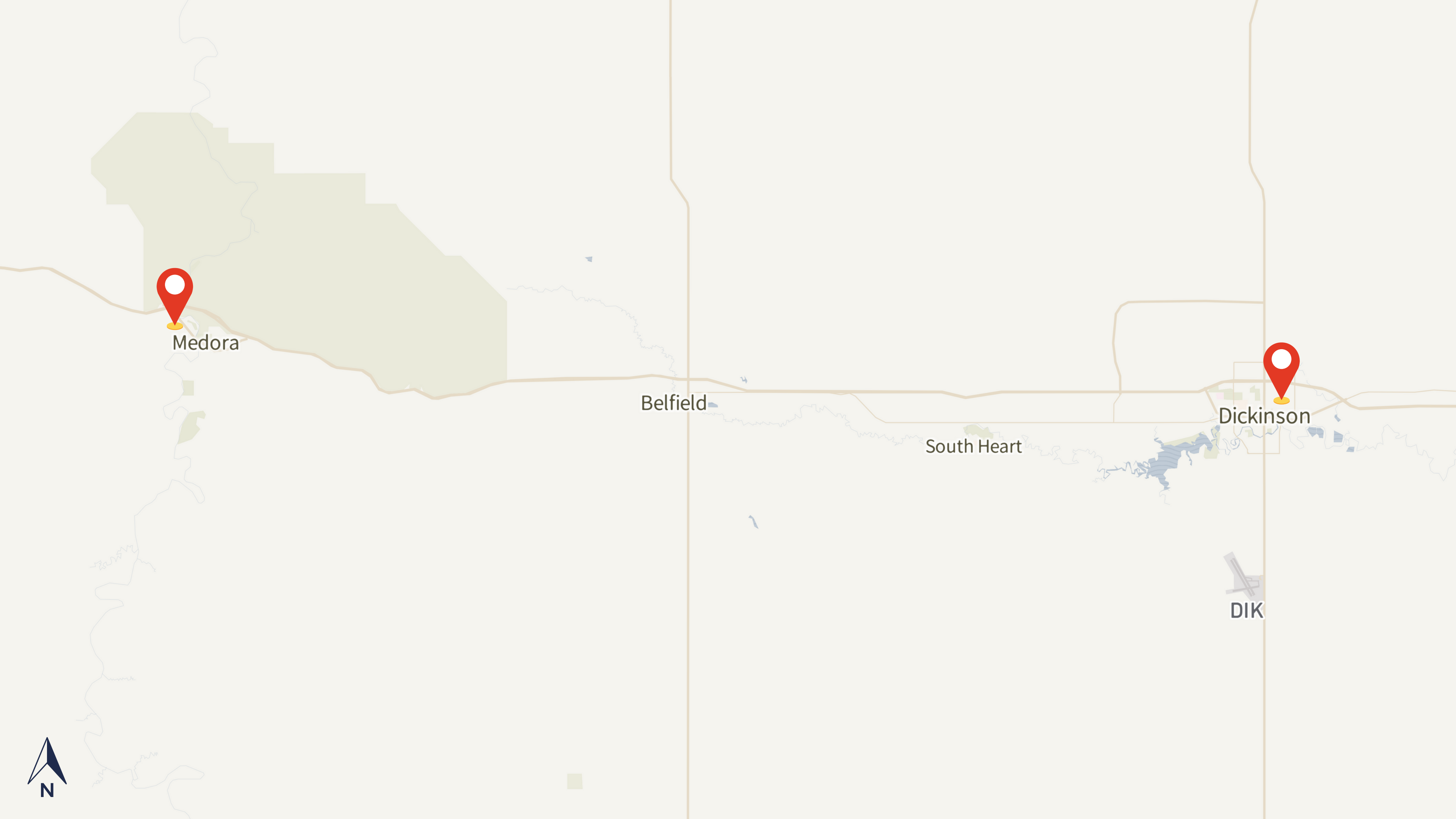



Existing Conditions

41 East Villard Street, Dickinson, ND 58601





Existing Conditions

41 East Villard Street, Dickinson, ND 58601



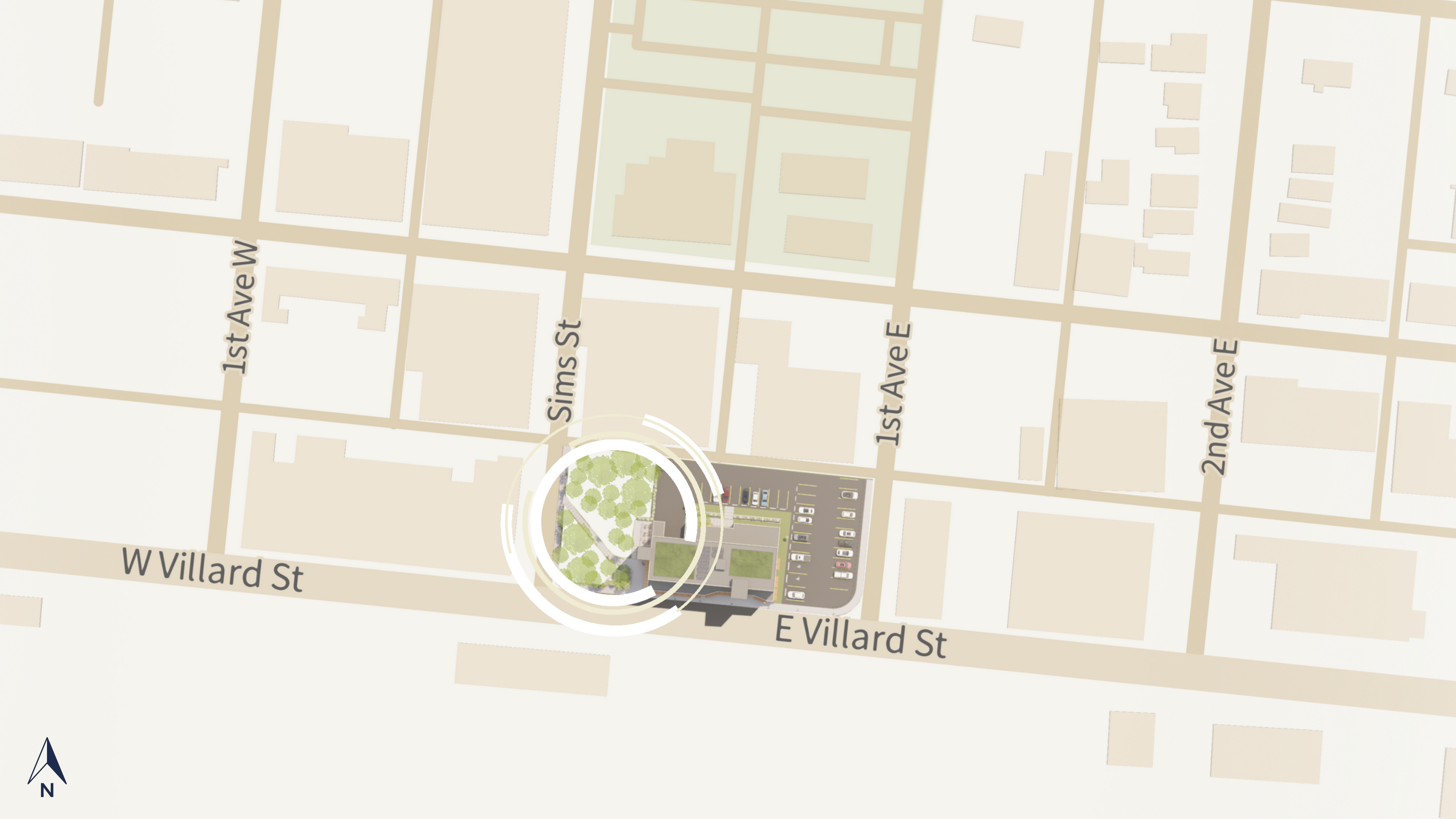

PRESENT DAY



PROPOSED



PRESENT DAY



PROPOSED





Challenges turn into opportunities

Finding the proper resources, products, and making the right design decisions.



Employees and business owners face new challenges in the workforce since the covid-19 pandemic and will continue to do so.



LUMION



LUMION





LUMION





 LUMION



LUMION



LUMION



LUMION



 LUMION



LUMION

Material Selections

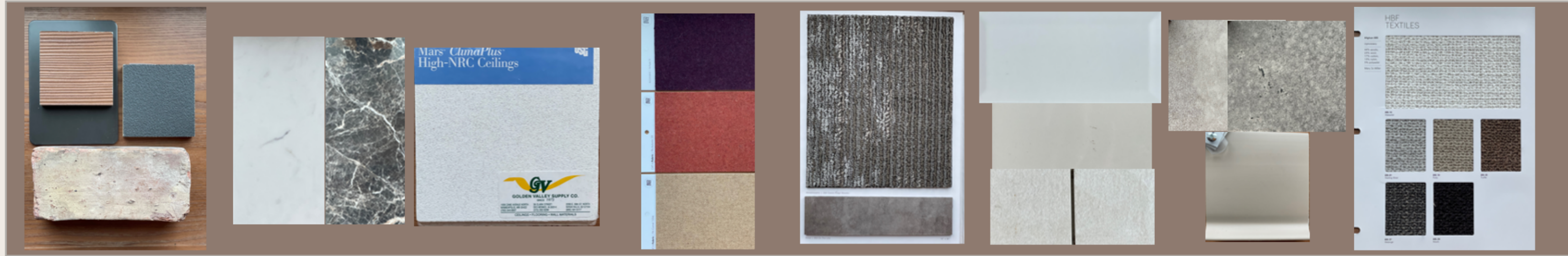

EXTERIOR

Local brick: Hebron Brick Co.

Nichiha fiber cement wall panels with built-in rainscreen (Riftsawn and Tuffblock)

Alucobond aluminum composite cladding

ACOUSTIC CEILING TILES

MARS ClimaPlus High-NRC Panels

2'x2'x7/8" – Low VOC – 77% recycled content

Grid option Centricitee

Buzzi Pod FABRICS

Felt to assist in acoustical balance + colors to differentiate and excite workers

LVT + Iconic Earth CARPET TILE

Metalmorphic tufted 18"x36" carpet planks, 20 mil, 10-year warranty, built-in acoustical layer, 2x as thick as conventional LVT, 8% bio-based renewable resource content, LEED, WELL, and LBC certified

TILE

Daltile tile, LEED certified

LVT FLOORING + TRIM

Criterion Classic LVT, 100% carbon neutral, fully recyclable, 22 mil

High grade resin and TP rubber trim

HBF TEXTILES + UPHOLSTRY

Flame resistant, 40% rapidly renewable content, SCS Indoor Advantage Gold, HHI V2 Compliant

PORCELIN SURFACES

Durable, easy to clean and maintain, stain resistant, low absorption rate for bacteria, low maintenance (no sealing/special cleaning), economical

level one

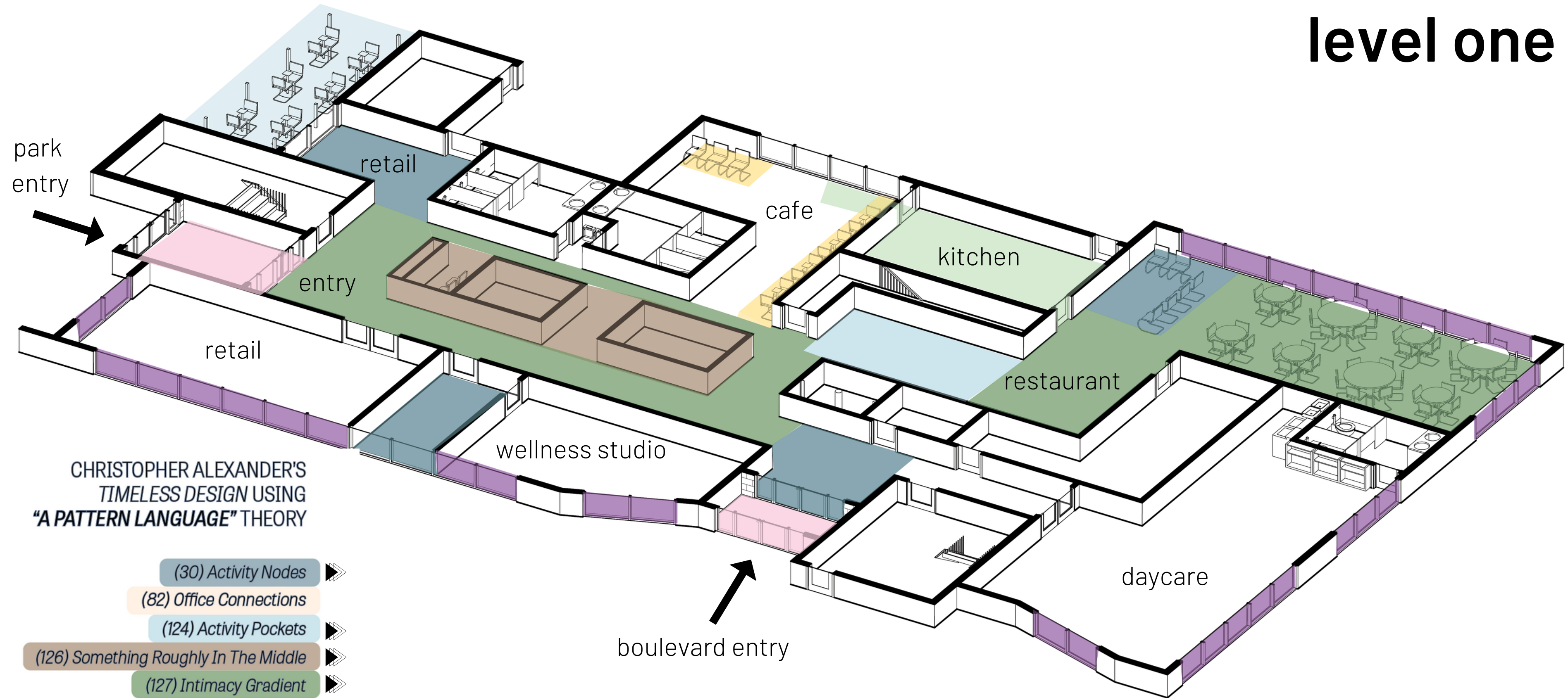

CHRISTOPHER ALEXANDER'S
TIMELESS DESIGN USING
"A PATTERN LANGUAGE" THEORY

- (30) Activity Nodes
- (82) Office Connections
- (124) Activity Pockets
- (126) Something Roughly In The Middle
- (127) Intimacy Gradient
- (130) Entrance Room
- (131) The Flow Through Rooms
- (132) Short Passages
- (142) Sequence of Sitting Spaces
- (159) Light on Two Sides of Every Room
- (171) Tree Places

boulevard entry

level two

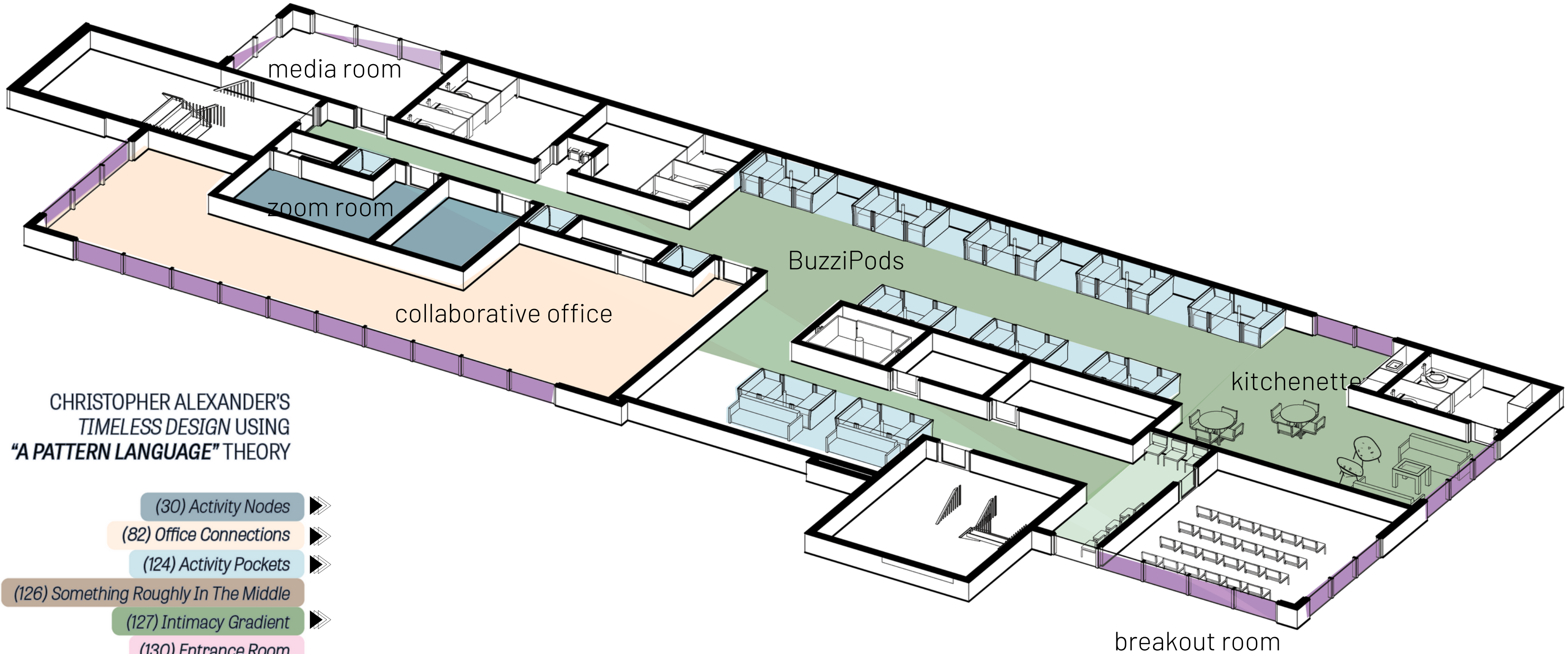

CHRISTOPHER ALEXANDER'S
TIMELESS DESIGN USING
"A PATTERN LANGUAGE" THEORY

(30) Activity Nodes

(82) Office Connections

(124) Activity Pockets

(126) Something Roughly In The Middle

(127) Intimacy Gradient

(130) Entrance Room

(131) The Flow Through Rooms

(132) Short Passages

(142) Sequence of Sitting Spaces

(159) Light on Two Sides of Every Room

(171) Tree Places

level three

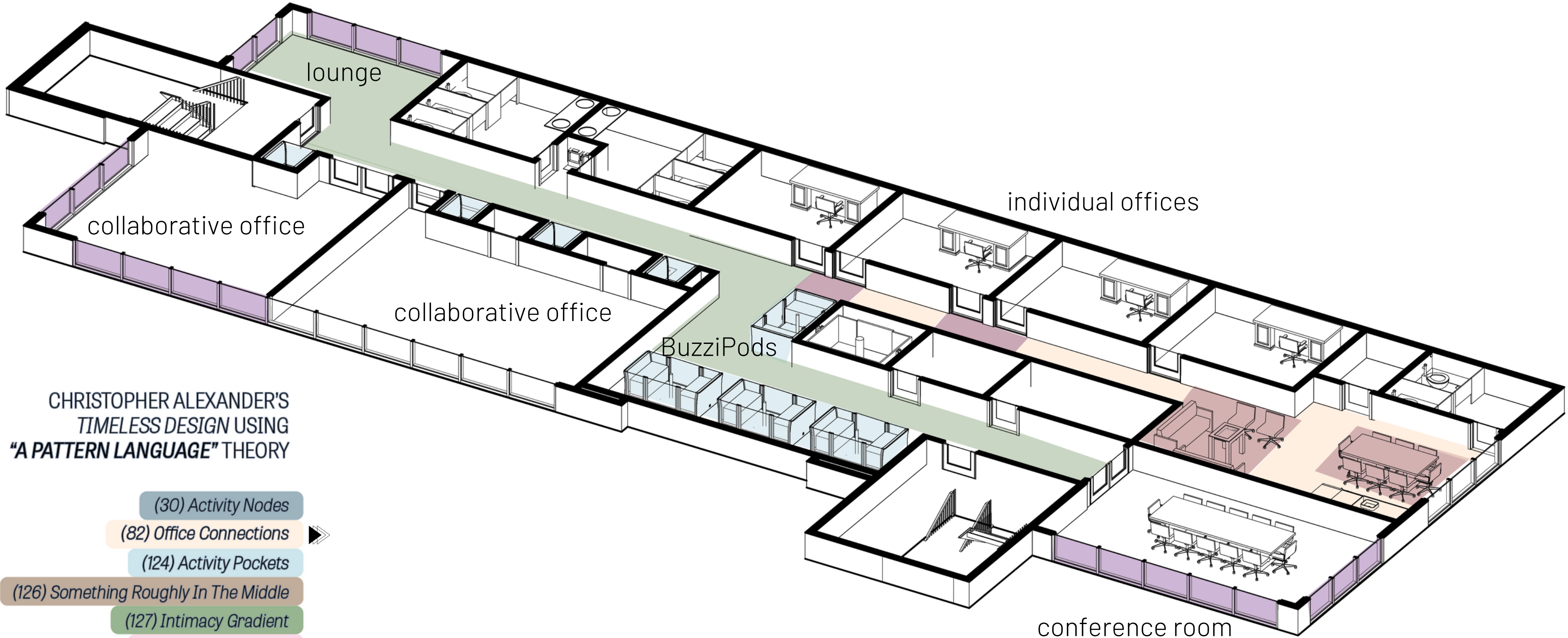

CHRISTOPHER ALEXANDER'S
TIMELESS DESIGN USING
"A PATTERN LANGUAGE" THEORY

(30) Activity Nodes

(82) Office Connections

(124) Activity Pockets

(126) Something Roughly In The Middle

(127) Intimacy Gradient

(130) Entrance Room

(131) The Flow Through Rooms

(132) Short Passages

(142) Sequence of Sitting Spaces

(159) Light on Two Sides of Every Room

(171) Tree Places

levels four-six

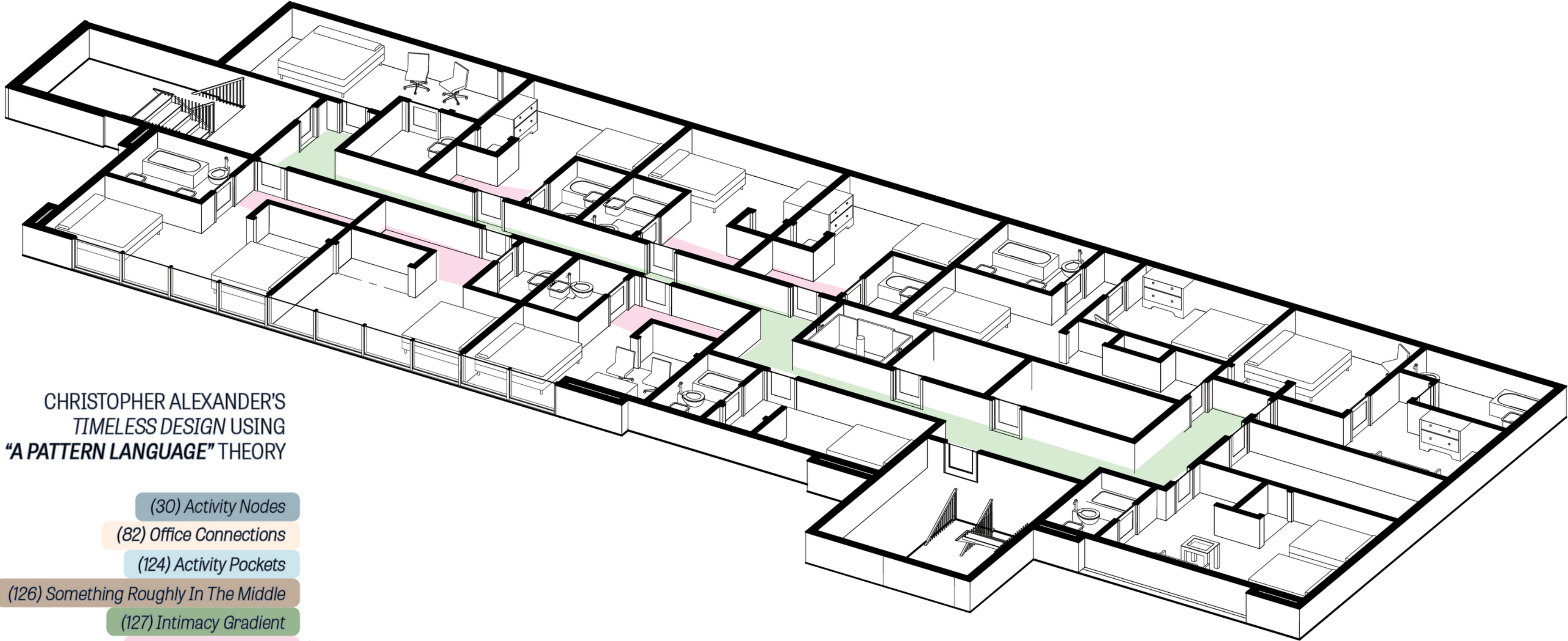

CHRISTOPHER ALEXANDER'S
TIMELESS DESIGN USING
"A PATTERN LANGUAGE" THEORY

- (30) Activity Nodes
- (82) Office Connections
- (124) Activity Pockets
- (126) Something Roughly In The Middle
- (127) Intimacy Gradient
- (130) Entrance Room
- (131) The Flow Through Rooms
- (132) Short Passages
- (142) Sequence of Sitting Spaces
- (159) Light on Two Sides of Every Room
- (171) Tree Places



Important Spatial Adjacencies

- BuzziPods
- Conference Rooms
- Collaborative Work Areas
- Cafe
- Restaurant
- Daycare



My project answers the question...

Can we, as designers, retrofit vacant and under-utilized commercial office buildings into clever, thoughtful, and pattern-driven architectural environments that will not only benefit our economy's new style of remote work, but also provide employees and communities with useful spaces that will set them up for their optimal form of work/lifeproductivity?

THANK YOU

Lexi Jordheim

Ultimately, the key to creating useful and profitable architecture in a post-pandemic world is to focus on designing spaces that are adaptable, flexible, and responsive to changing needs. By embracing new technologies and incorporating sustainable design principles, architects can create buildings that not only meet the needs of their occupants and property owners but also contribute to a more sustainable and resilient future.

The presentation board features a central architectural rendering of a modern multi-story office building with large glass windows and a brick facade. To the left, a 'PROJECT FOCUS' section includes icons for 'Sustainable', 'Adaptable', and 'Resilient' design. Below this, a text block discusses the challenges of the post-pandemic workplace and the role of architecture. A 'what makes an environment feel comfortable?' section lists material and lighting specifications. On the right, a 'CHRISTOPHER ALEXANDER'S TIMELESS DESIGN USING "A PATTERN LANGUAGE" THEORY' section includes a list of design principles such as 'Activity Rooms', 'Office Connections', and 'Something Roughly In The Middle'. A 'BUILDING OCCUPANTS USER PROFILE' section lists various professional roles. At the bottom, a material palette board displays various fabric and color swatches. The board also includes a site map showing the building's location at the intersection of Sims St, 1st Ave E, and 2nd Ave E, and a street view of E Villard St.



[HTTPS://YOUTU.BE/E00GXC_CM0Q](https://youtu.be/E00GXC_CM0Q)

