

# Nash Motors Historical Park

Designing for proposed open space within the Kenosha Innovation Neighborhood through ethnographic assessment and historical research

Kaitlyn Trifone | MLA Candidate | Landscape Architecture 772 | Landscape Architecture Graduate Thesis  
LADREM | SoDAA | NDSU | Spring 2024 | Dominic Fischer | Jay Kost

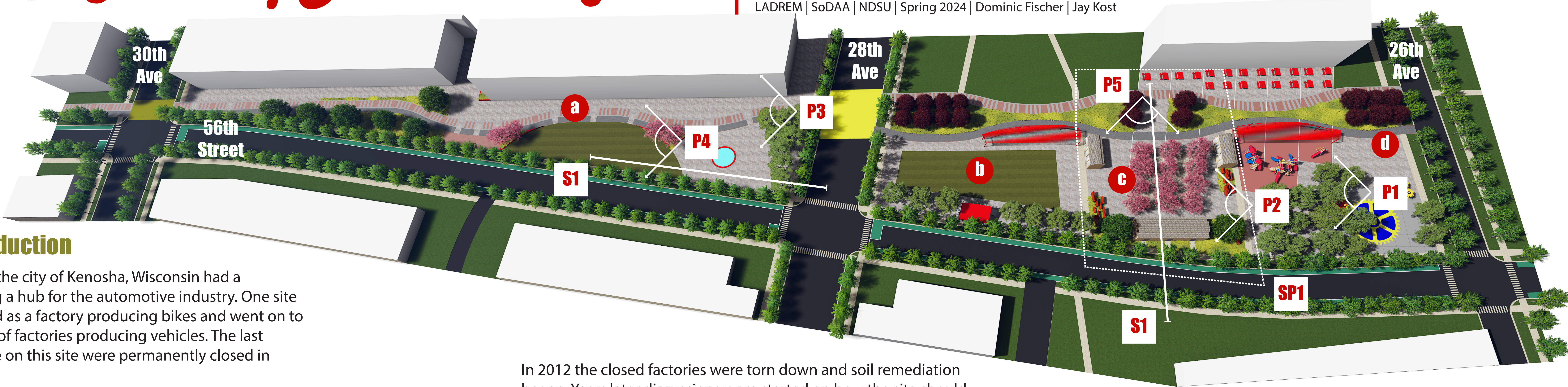

## project introduction

For over 100 years the city of Kenosha, Wisconsin had a reputation as being a hub for the automotive industry. One site in particular started as a factory producing bikes and went on to become 100-acres of factories producing vehicles. The last factories still in use on this site were permanently closed in December of 1988.

In 2012 the closed factories were torn down and soil remediation began. Years later discussions were started on how the site should be used once soil remediation efforts were completed. It was determined that this site would be the Kenosha Innovation Neighborhood. A new neighborhood used for tech start-ups, technology institutes, and multi-family housing. This thesis aims to prove by use of ethnographic assessments the history of the site can be implemented into the proposed Kenosha Innovation Neighborhood through park design.

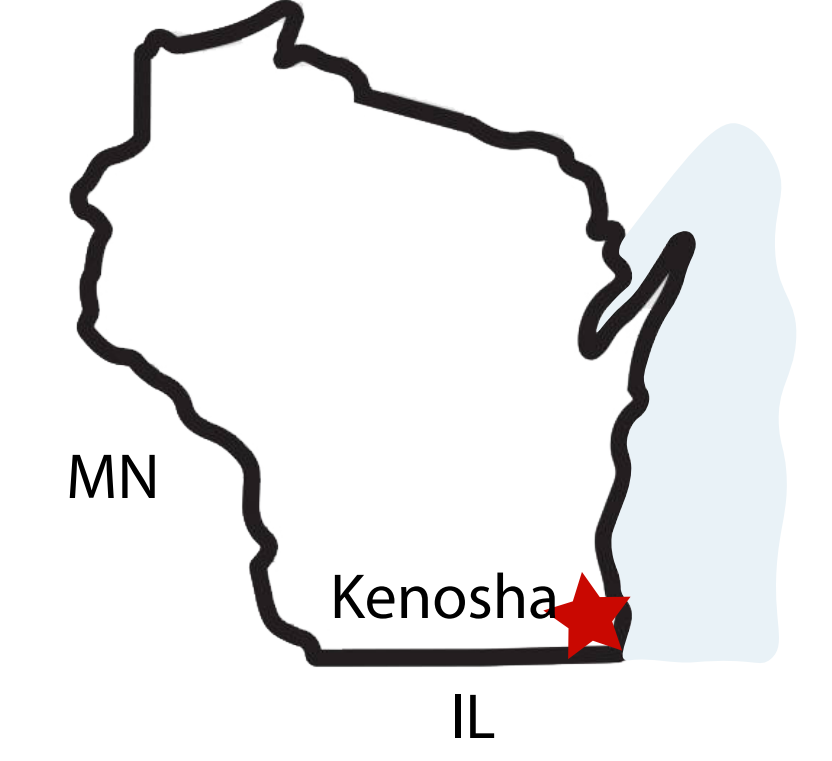

**KEY**

- a** American Bicycle Co. Plaza
- b** Local 72 Performance Pavilion
- c** The Breakroom
- d** Shipping Playground





**P1** The Shipping Playground is in the same space Chrysler once used for shipping and receiving. This area of the park is the primary active space made up of splash pads and custom water features, several play structures for different age groups, large canopy trees, outdoor seating, and a shade structure.



**P2** The Breakroom, named with past employees who needed a break in mind, is an area meant for people to relax, try new restaurants, and enjoy company. The large privacy panels have space to be designed by local artists and create the feeling of privacy while within The Breakroom. Three food stalls will feature cuisine from local establishments on a rotating schedule.

## S1 | the breakroom

section | scale: 1" = 5'-0"

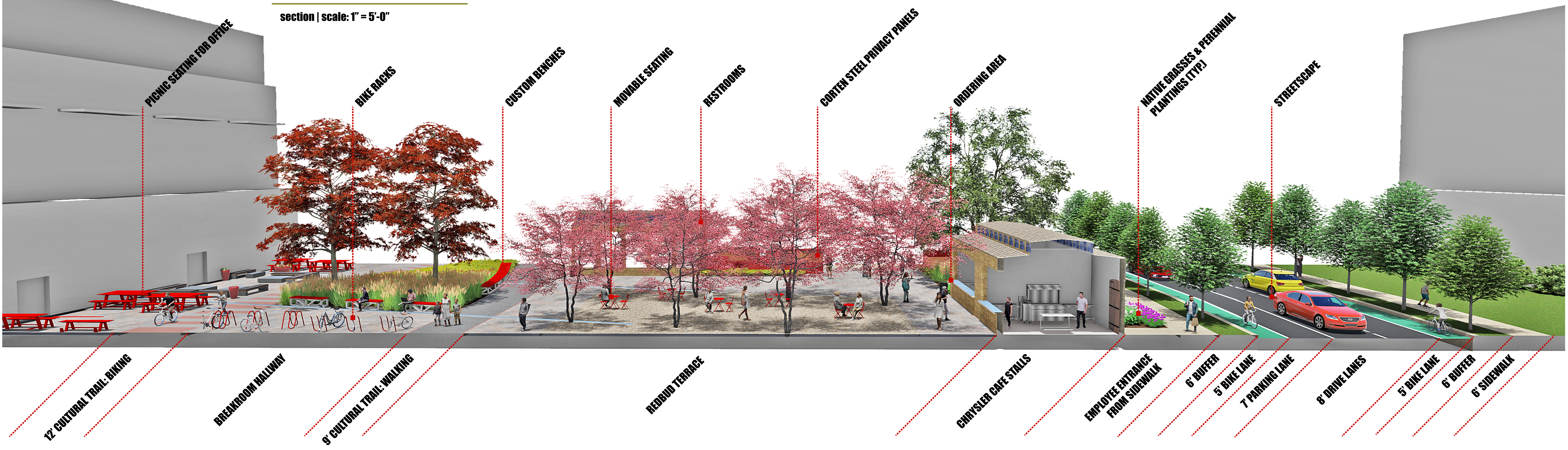





**P3** The American Bicycle Co. Plaza is meant for patrons to shop locally or enjoy lunch outside while on break from work. The Plaza features the Kenosha Cultural Trail, large canopy trees with outdoor seating, an open lawn, raised planters and a water fountain.



**P4** The open lawn within The American Bicycle Co. Plaza can be used for children to safely play while their parents shop or enjoy the shade of the Honey Locusts. The open lawn is meant to be used for play or relaxation.



**P5** The Hallway, which connects office patios to The Breakroom, is the perfect place to hop off the Kenosha Cultural Trail and park your bike or take a rest on the custom park benches. This area is a key connection between the neighboring office, the cultural trail, and The Breakroom.

**D1 | cultural trail**

detail

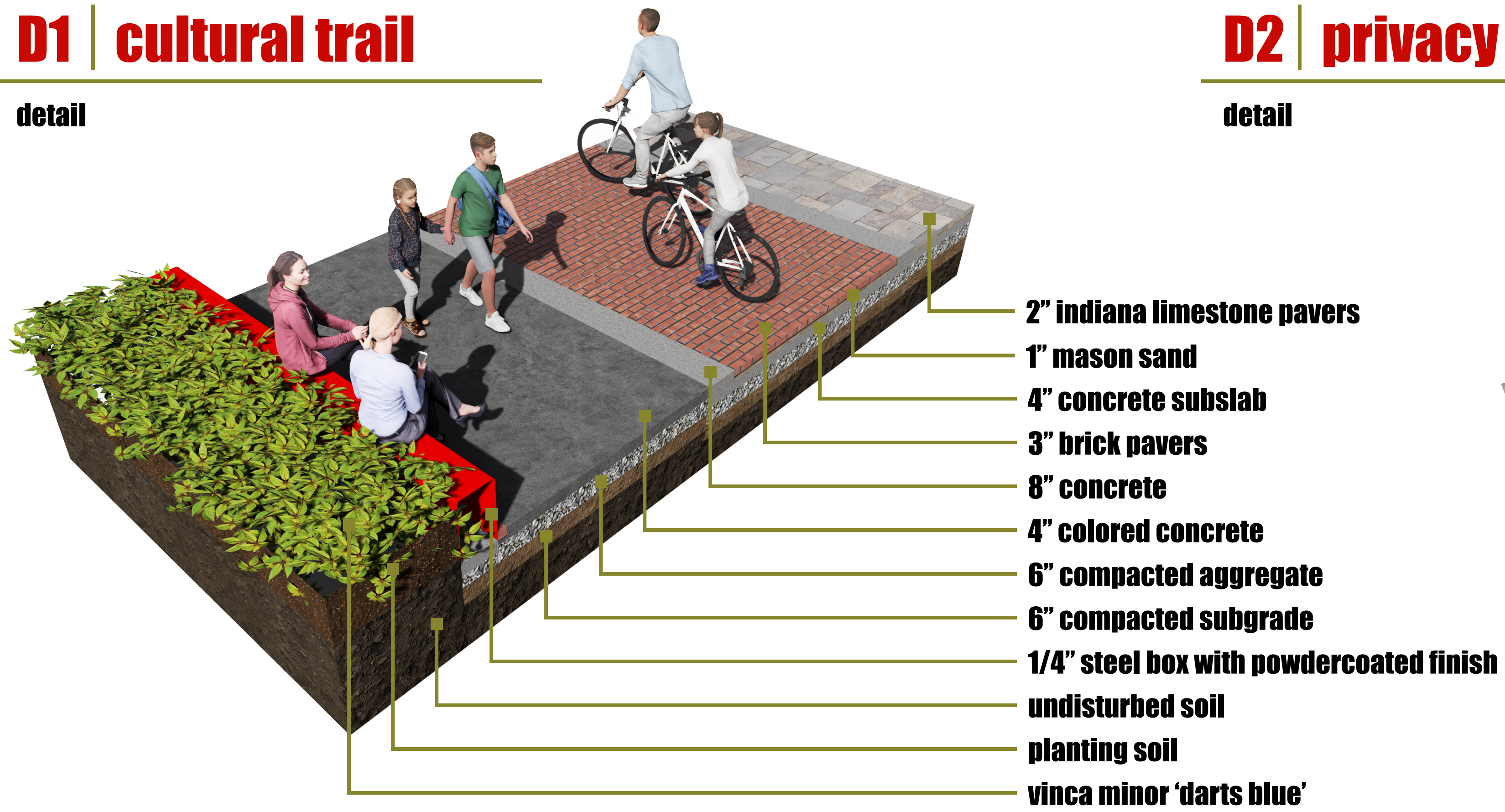

**D2 | privacy panel**

detail

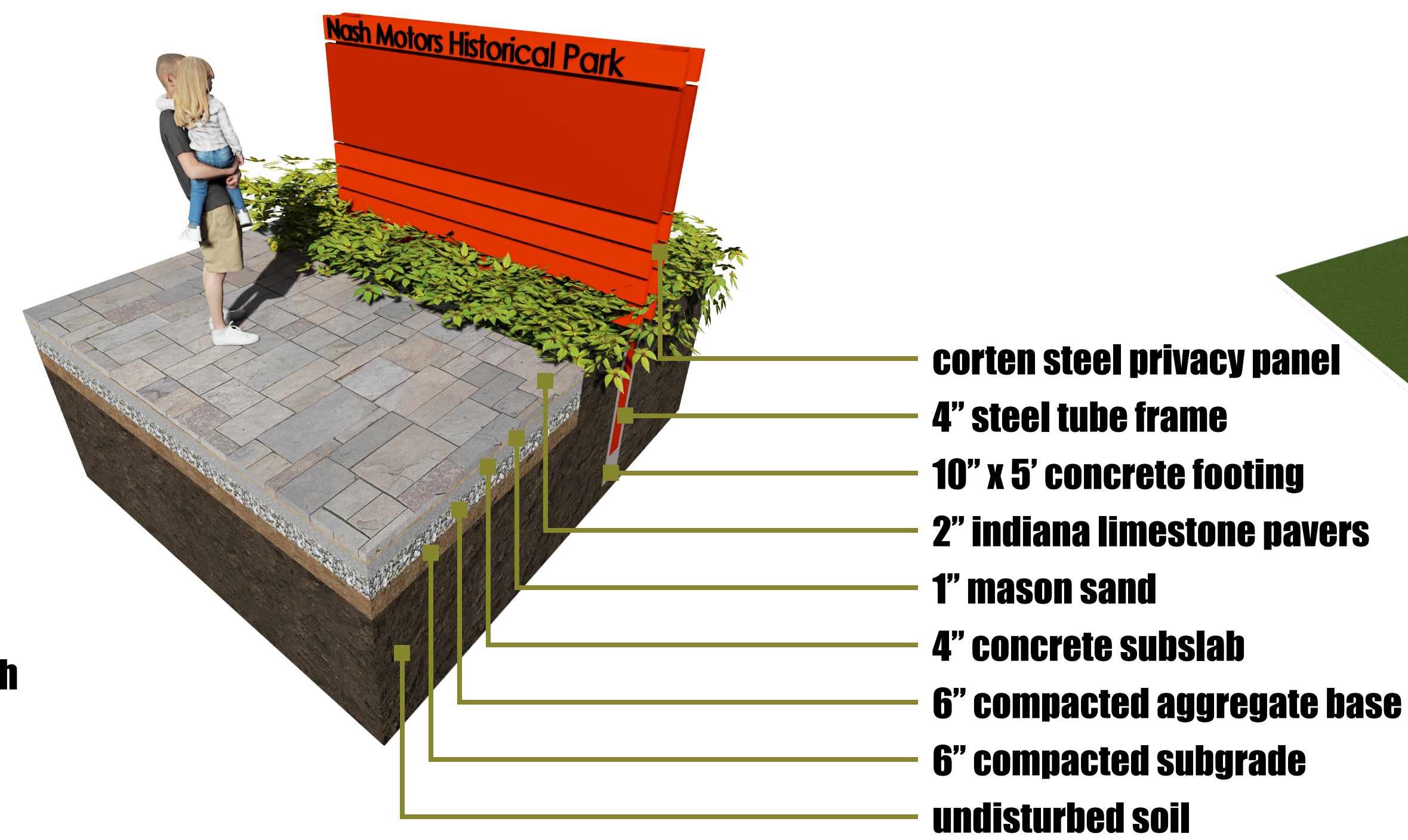

**SP1 | the breakroom**

site plan

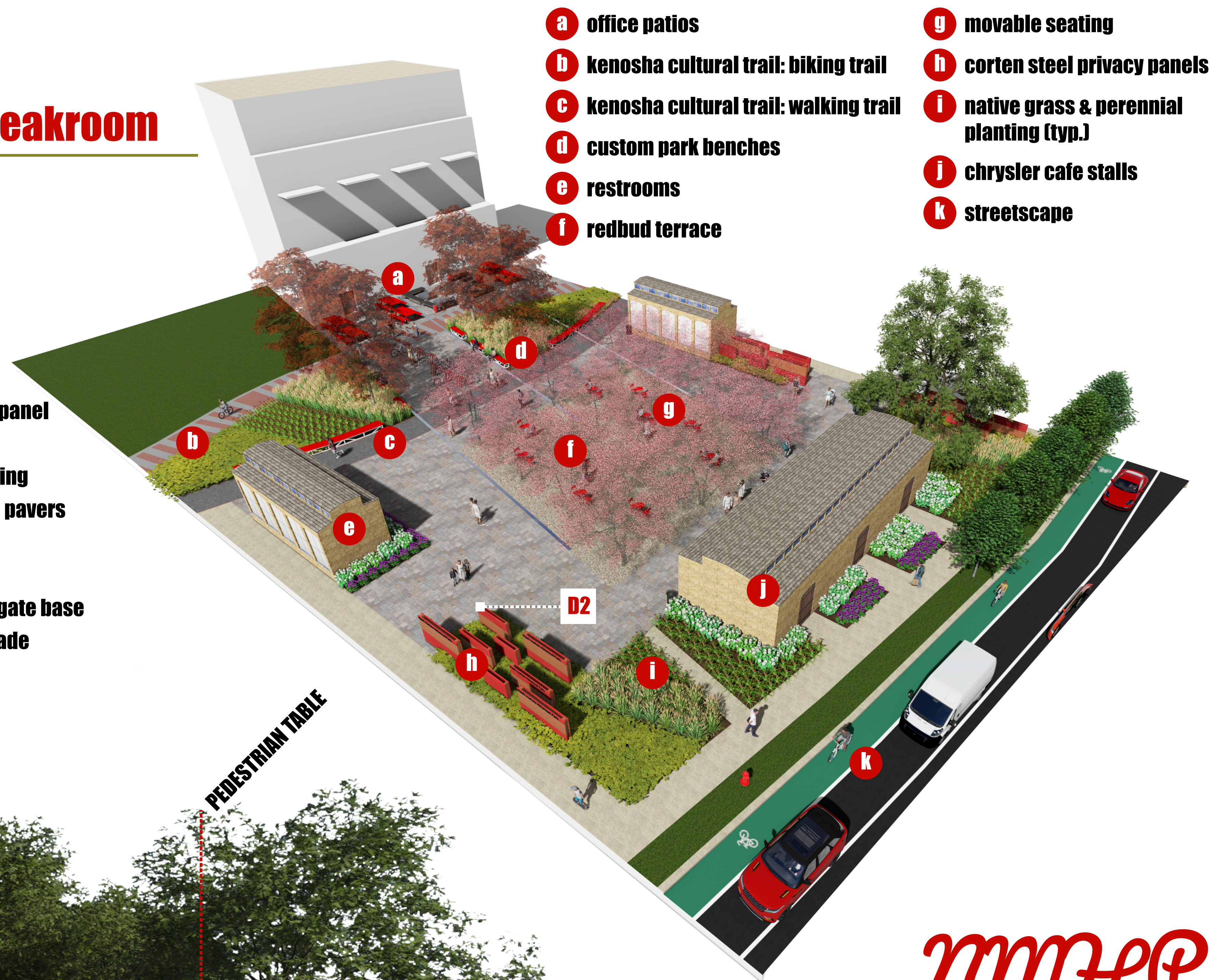

**S2 | american bicycle co. plaza**

section | scale: 1" = 4'-0"

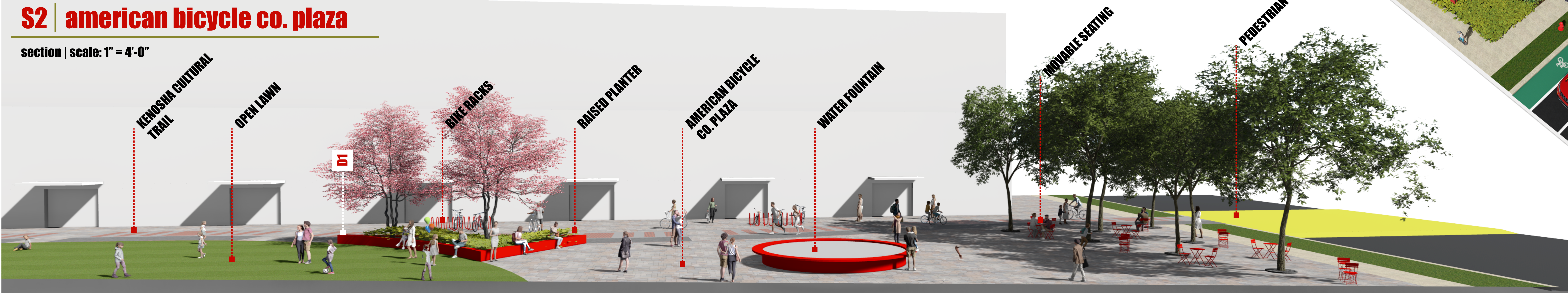

Designing for proposed open space within the Kenosha Innovation Neighborhood through ethnographic assessment and historical research