

RETHINKING THE AMERICAN DREAM

Redesigning Suburbia for the 21st Century

This research aims to redefine the "New American Dream" for the 21st century. In a new era where single-family homes no longer align with the preferences of this generation along with a large demographic shift to more dense urban living, it is time to rethink the role of the suburbs. Through investigation of California's housing trends, migratory shifts, and the opportunity for medium-density housing, this study will explore strategies to make suburban neighborhoods more affordable and aligned with current societal needs. As a final result, the suburbs will evolve to play a new role in equitable housing and resource availability in the hope of solving California's housing affordability crisis.

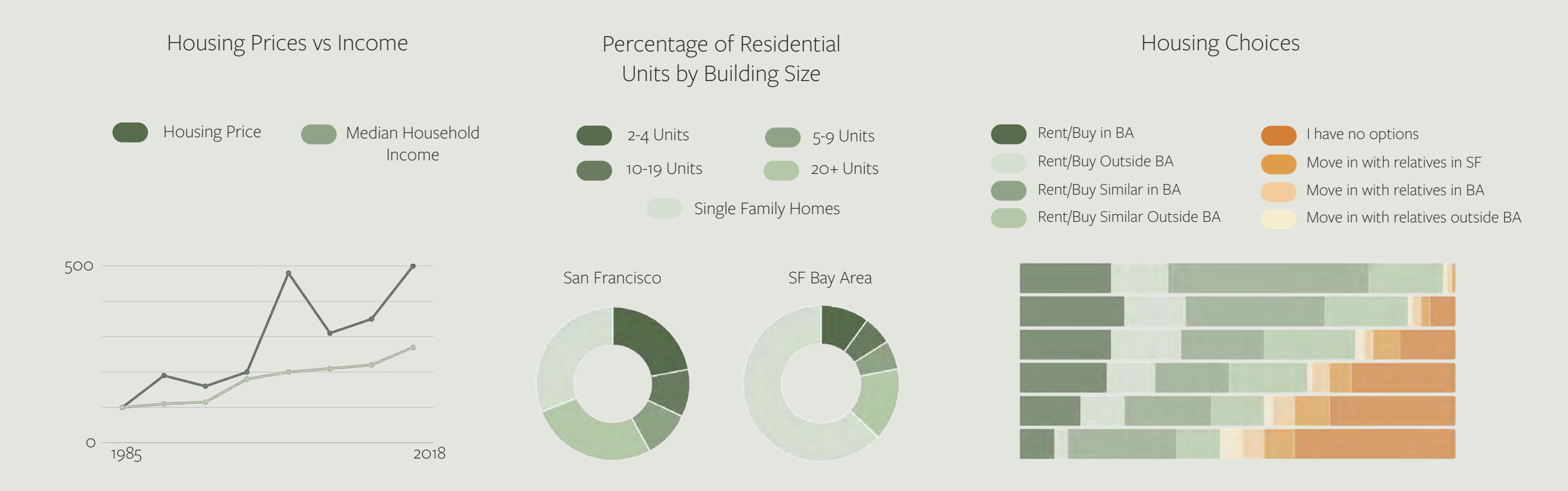

This so-called American Dream is just a dream today. Due to the continuous affordability crisis across the nation along with unparalleled wage and housing prices, people are no longer able to afford housing. The costs for housing throughout America vastly outpace any median American wage making it impossible for the middle- and lower-income class to keep up. Given the current economic conditions, there is a need for a paradigm shift in American housing. This shift should not only redefine one's perception of the American Dream but also address whether it provides an equitable and attainable goal for everyone.

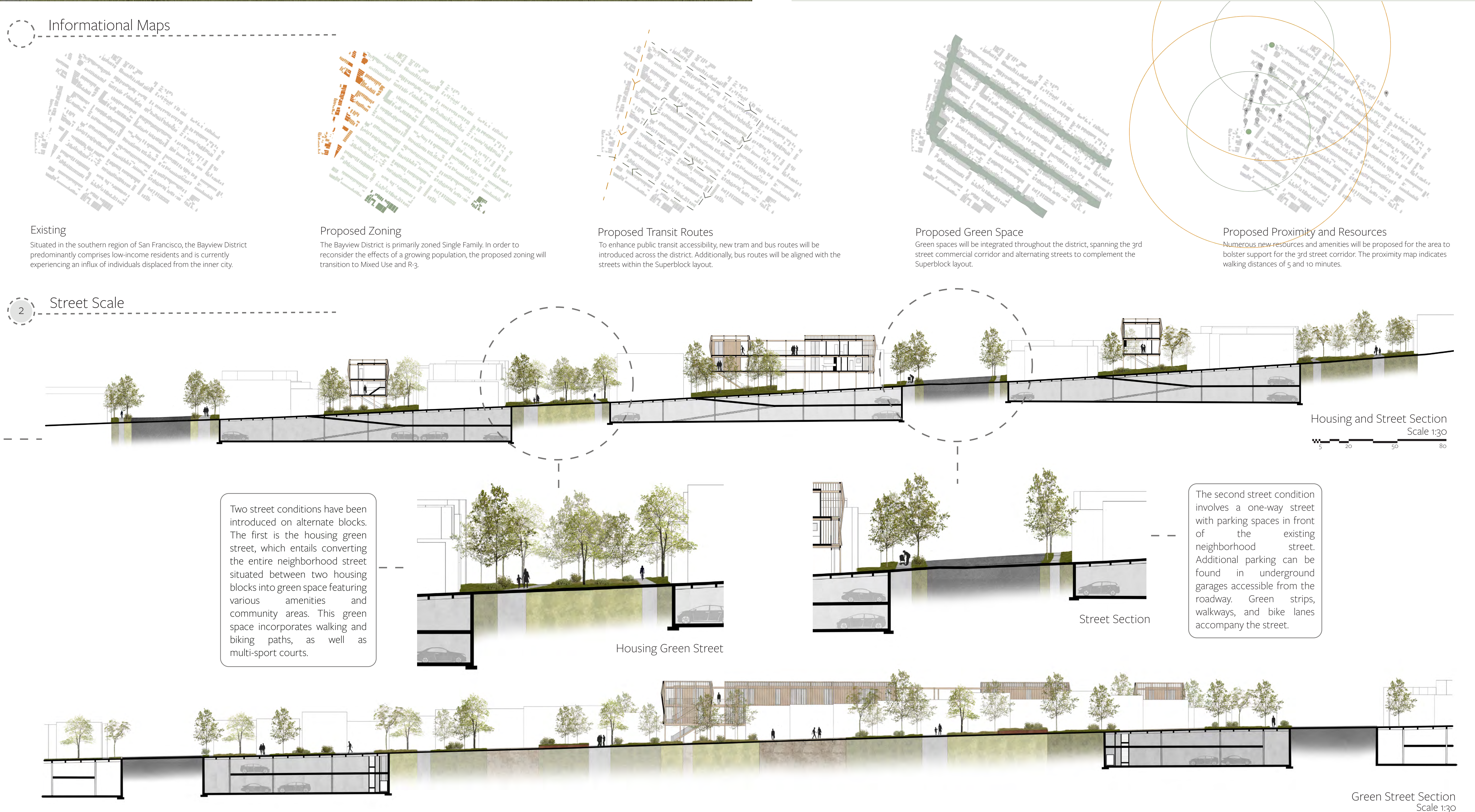
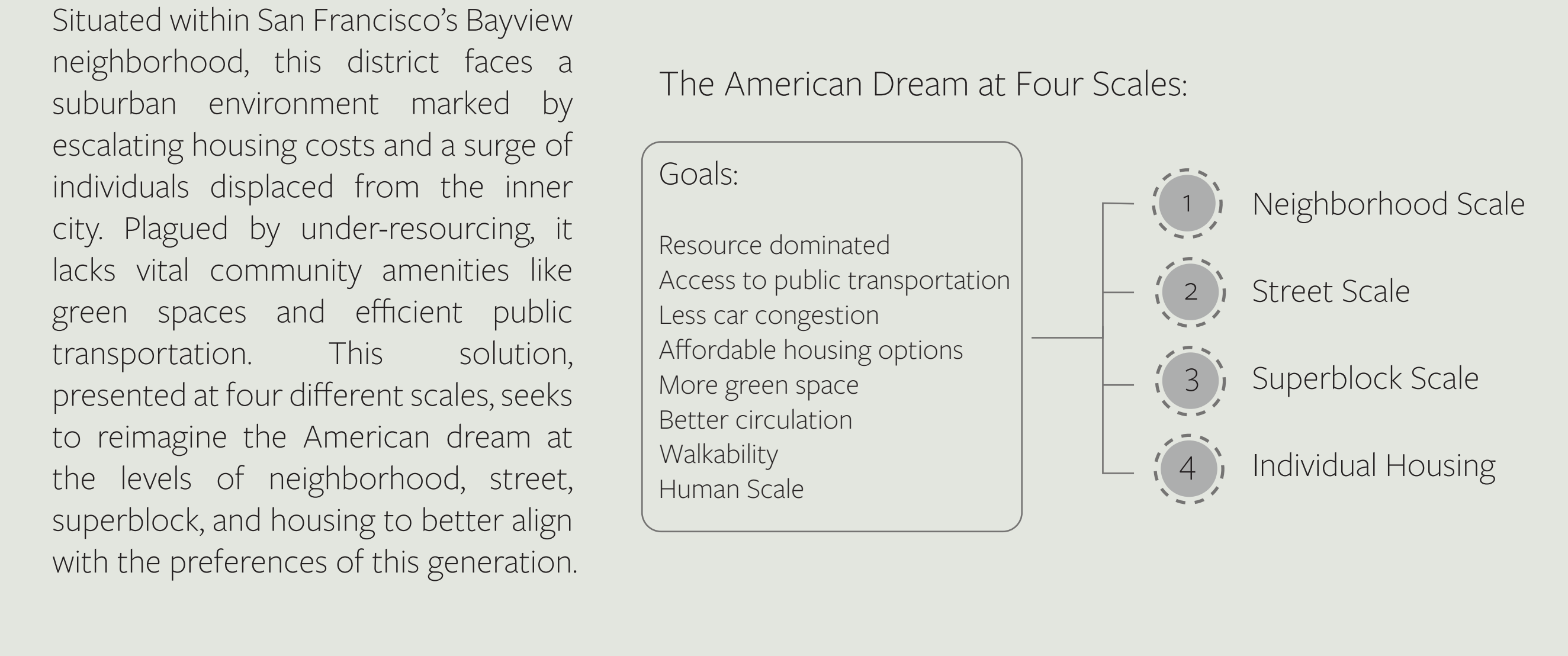

The 3rd Street green corridor serves as the primary access point and transit link to downtown San Francisco. To foster a cohesive connection and gathering hub for the district, all vehicular and public transit routes will be situated beneath the corridor. This area will be seeded with resources, amenities, ample greenery, and shared community spaces. Multi-sport courts, playgrounds, sandboxes, seating areas, and walking paths will define the exterior space surrounding four proposed community buildings. These new structures will accommodate a food market, public laundry facilities, a gym, and other amenities tailored to the community's needs. The objective is to establish a 10-minute city within this neighborhood, ensuring residents can access their necessities within a short walking distance.

The proposed housing system includes three unit types of varying sizes, designed to adapt to residents' diverse needs. The housing is adaptable to the specific blocks, utilizing abandoned housing lots and backyards to create connections between streets within the neighborhood. This design offers a medium-density solution for individuals who don't require a single-family detached home.

