

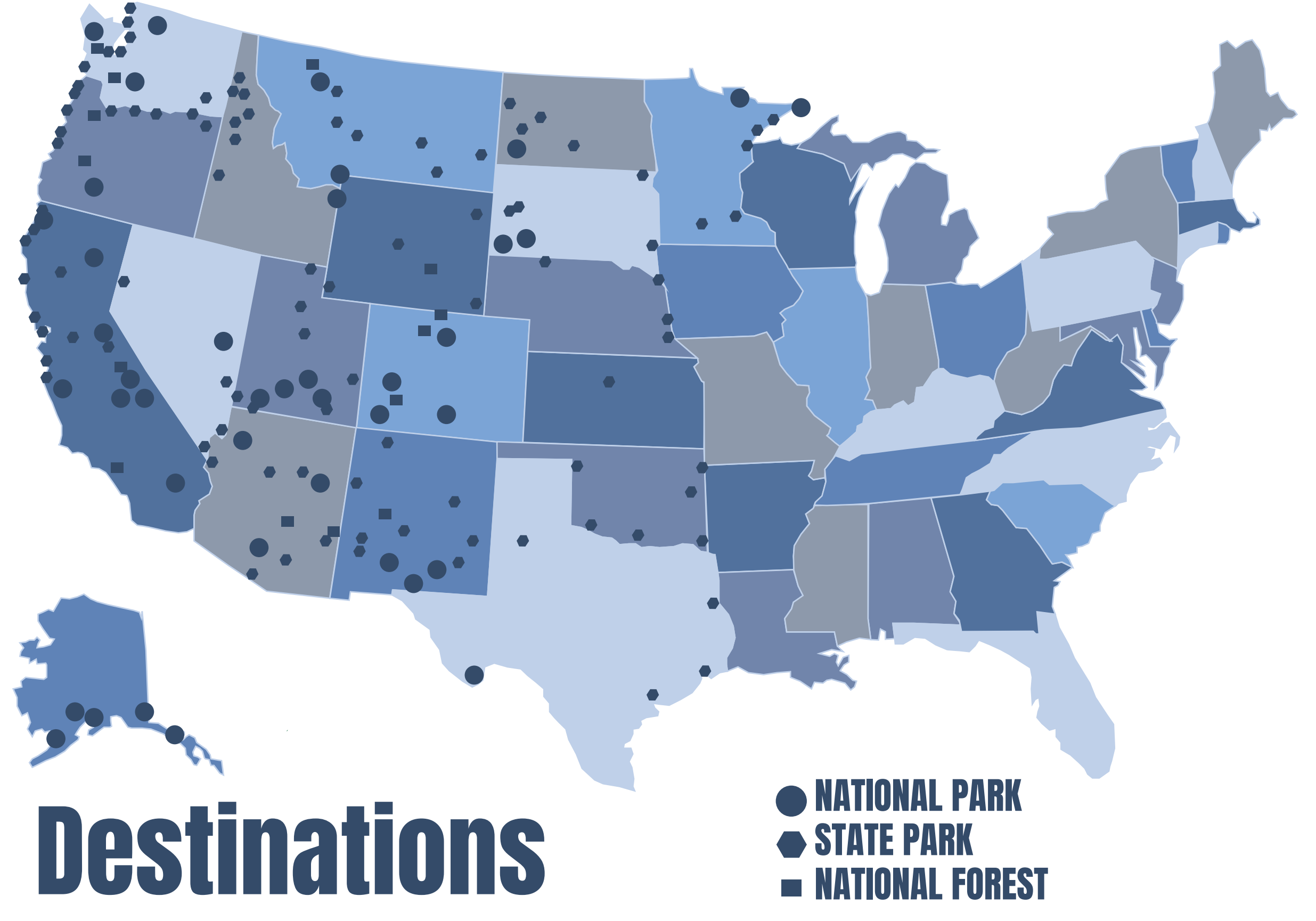

Adaptive Re-Use of The American School Bus

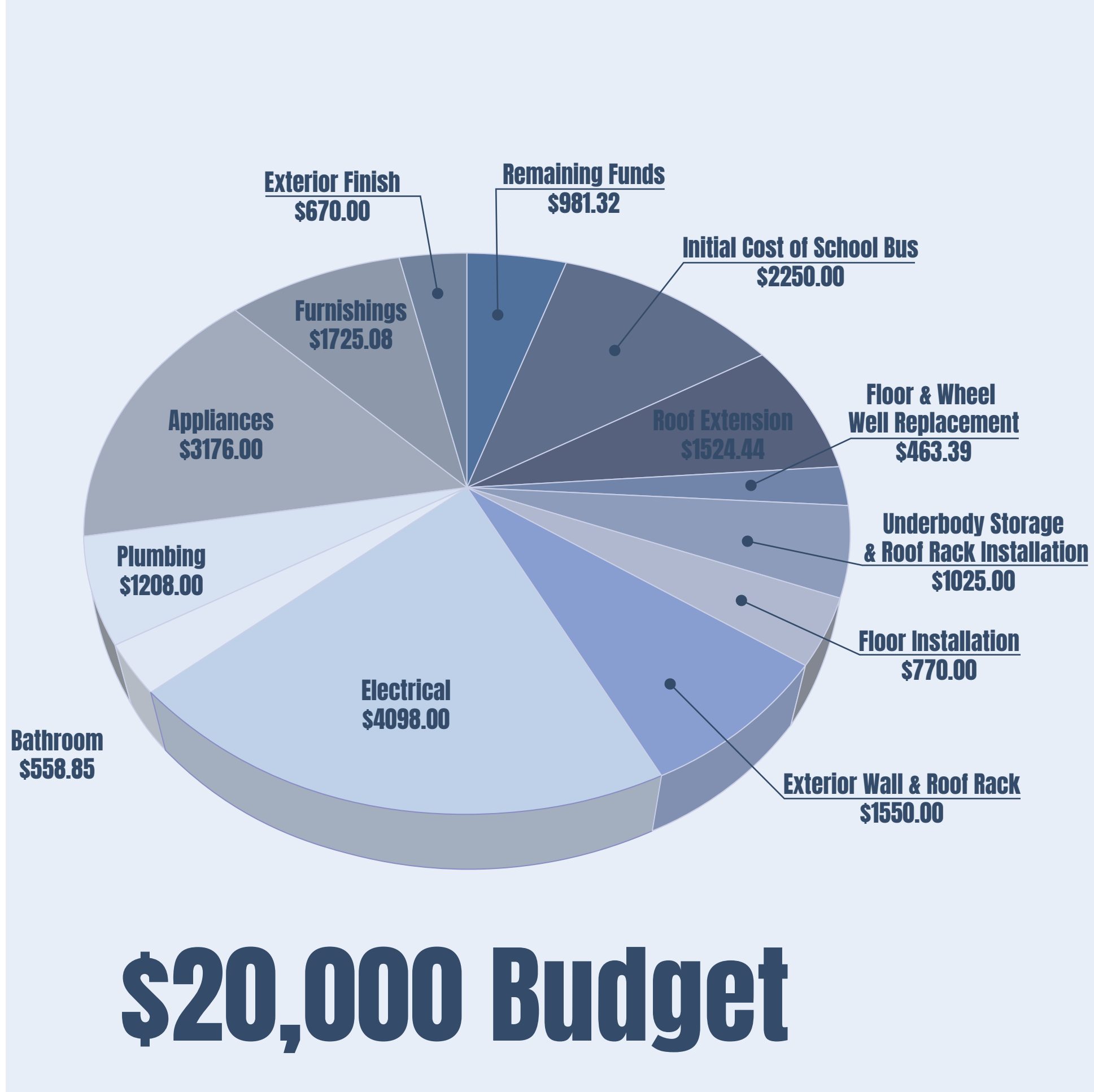

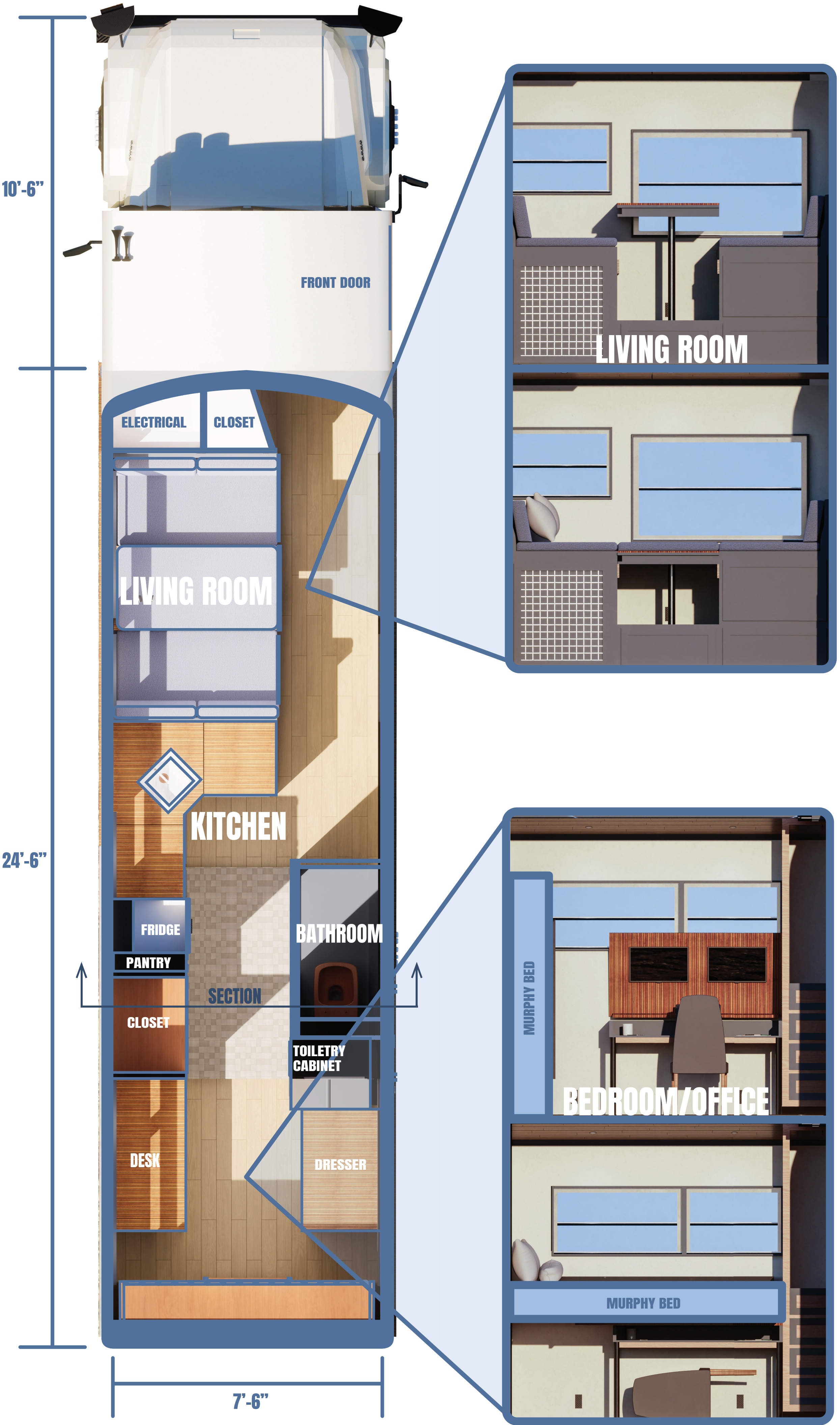
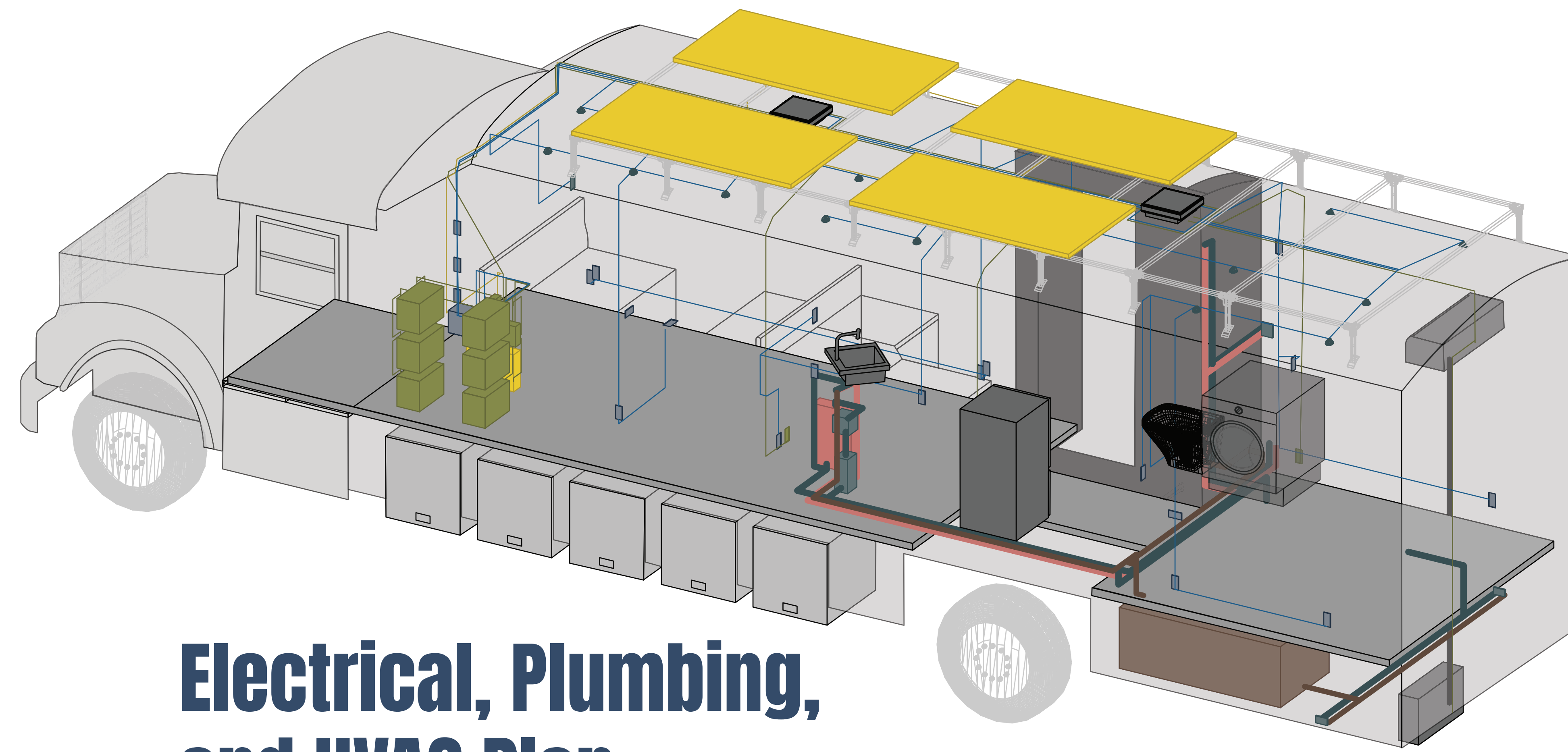
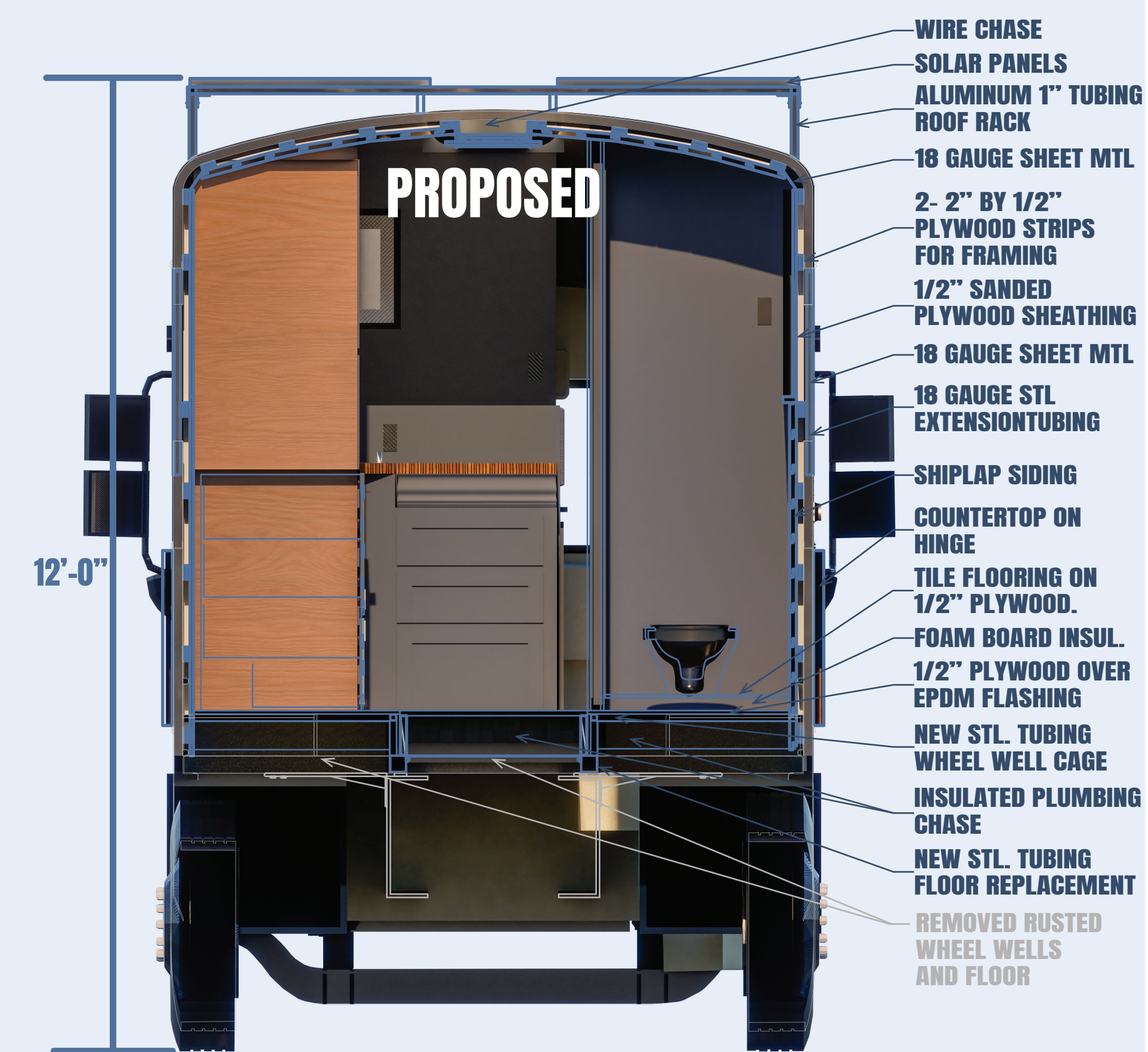
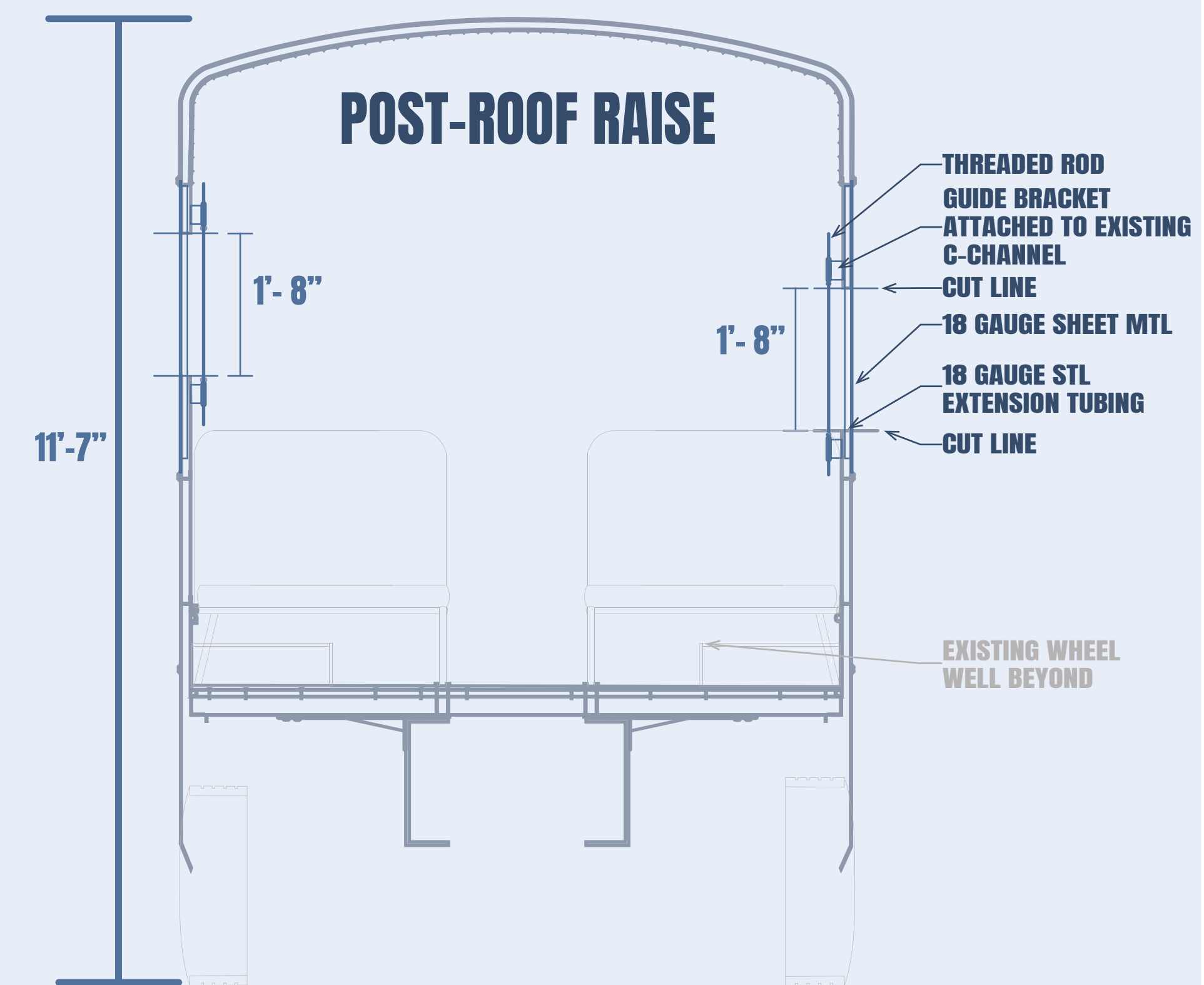
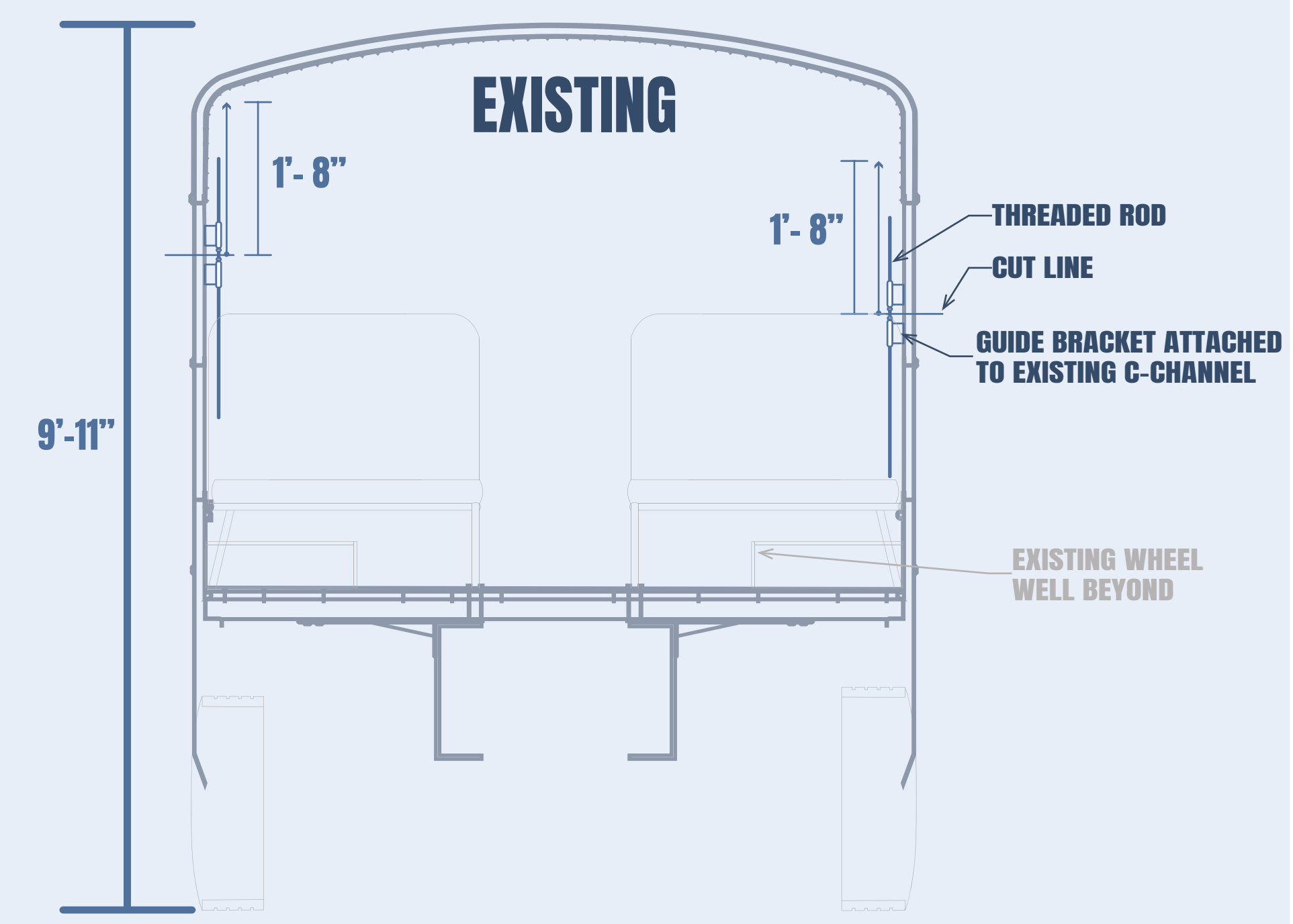

Electrical, Plumbing, and HVAC Plan

- SOLAR
- HOT WATER
- 12V ELECTRICAL
- COLD WATER
- 120V ELECTRICAL
- GRAY WATER
- APPLIANCES

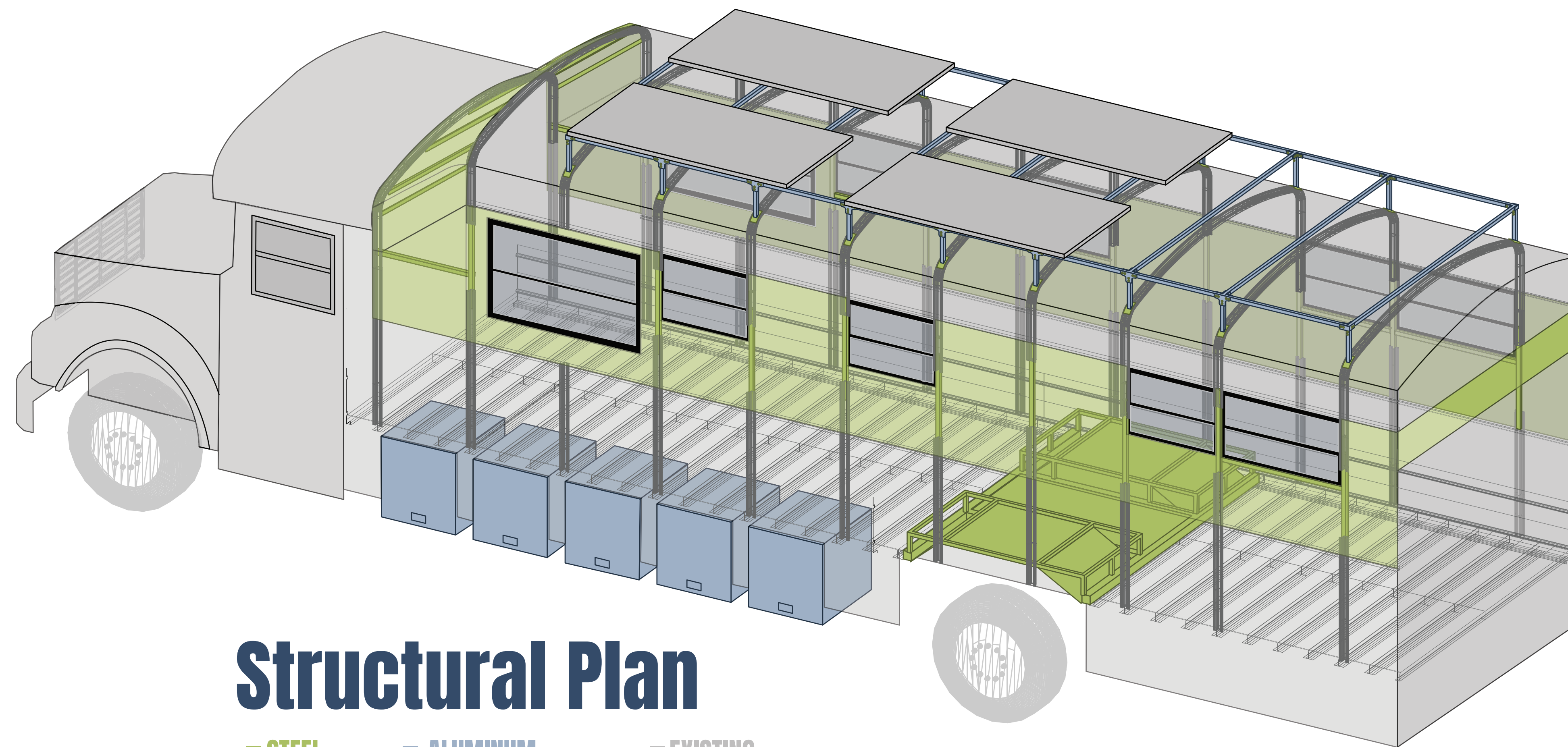

Structural Plan

- STEEL
- ALUMINUM
- EXISTING

