

# Adaptive Re-Use of The American School Bus

Designing an Affordable Nomadic Environment Suitable for Live, Work and Play

Jonathan Deitz  
Arch 772 Design Thesis  
Studio Professor: Regin Schwaen



# Nomadism

HAVING NO PERMANENT ABODE, A WANDERER.

(John Krauer, How Chris McCandless Died, 2013 )

# Destinations

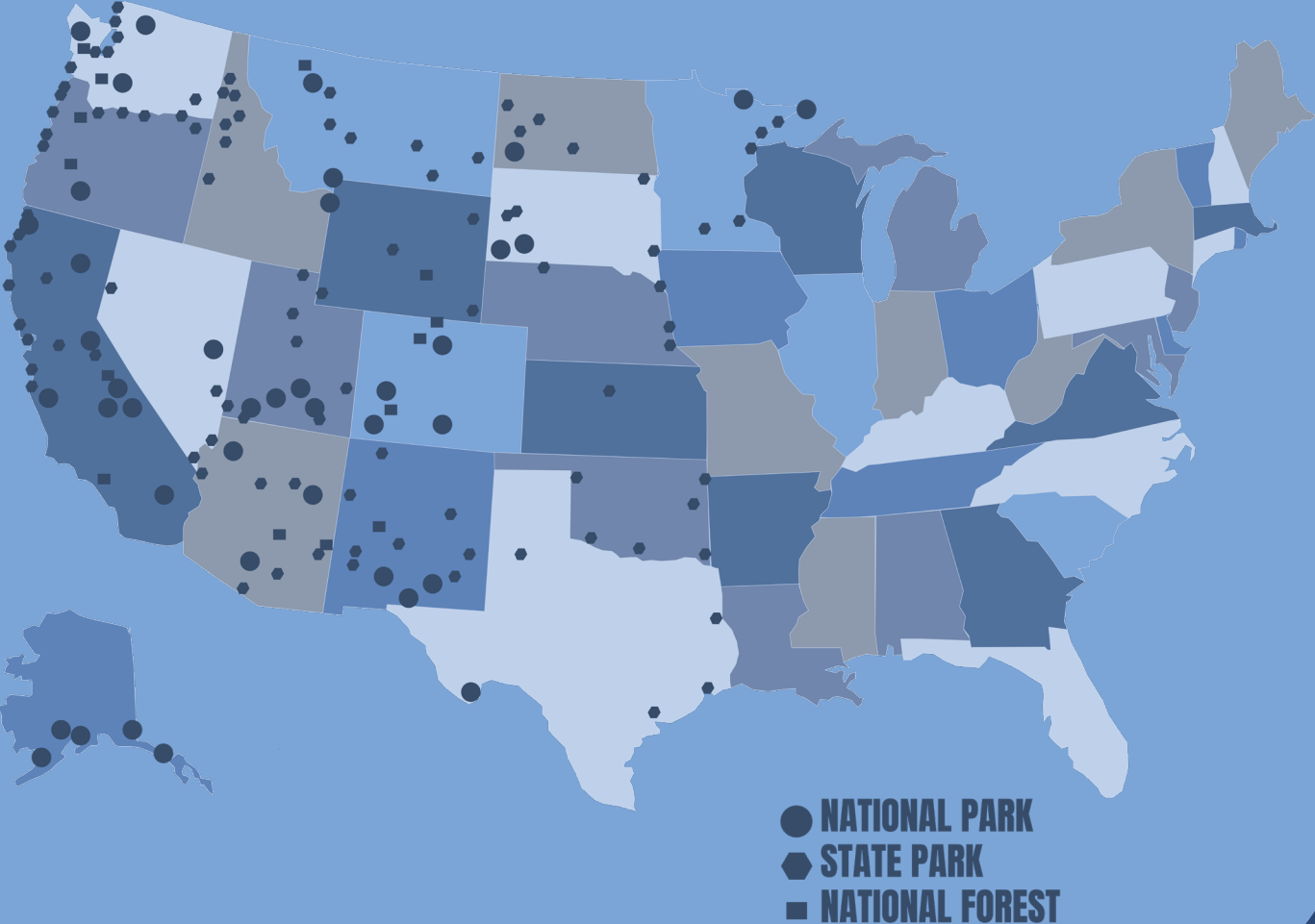

# Found out I wasn't entirely Alone...

- **“Nothing is art if it does not come from nature.” – Antoni Gaudi**
- **“Form must have a content, and that content must be linked with nature.” – Alvaro Alto**
- **“Study nature, love nature, stay close to nature. It will never fail you.” - Frank Lloyd Wright**

# The Irony

- **Adapting An American Object to avoid American Materialism**
- **Adapting a Vehicle into a Home, to avoid buying a Home**
- **An Architect who designs Houses, avoids living in one**
- **Pursuit of the Wild, just to bring civilization with**

# Is Nomadic Architecture, Architecture?

- **Architecture (n): the art or practice of designing and constructing buildings**
- **What is a building? Can it Not Have Wheels?**
- **Does a building have to be built on site?**
- **Is the redesign of Renaissance Hall Architecture?**

# Brief History of Nomadism

- **Defined by Method of Transportation**
  - **Animals, Engines, and now an internet connection**
- **Defined by the Environment**
  - **Needs over Wants**
  - **Available Materials**
  - **Adaptability**

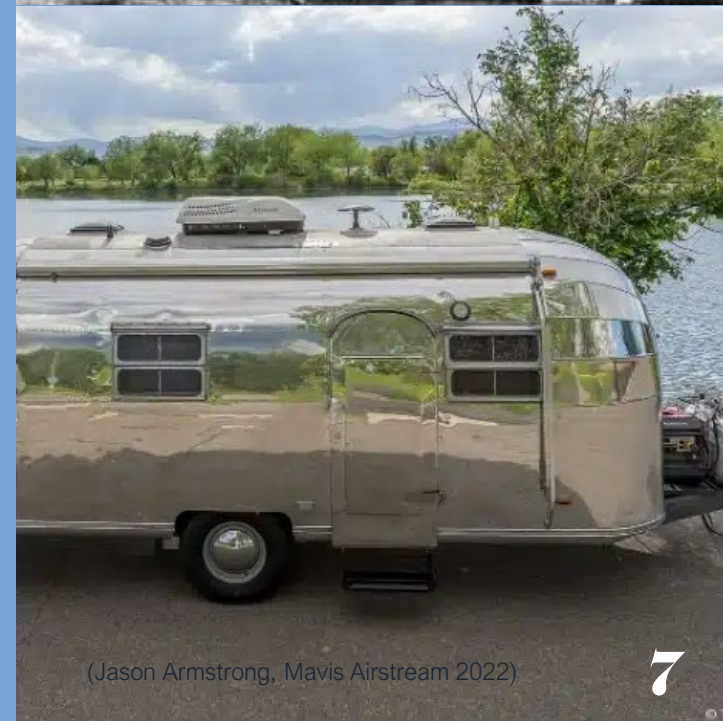

# Why A School Bus?

- **Sustainable?**
- **Affordable**
- **Adaptable**
- **Cultural**

(Lenz L, A Brief History of  
the School Bus, 2022)



# Sustainable?

- Better to Re-use or Re-Build?
- MPG & Emissions Concerns
- Over 6 Tons of material otherwise left to waste
  - Other Buses Sold were Used for Storage by Farmers



# Affordable

- Safety Code for educational use leads to Buses being sold before they are past their “Prime”
- Purchased my School Bus for only \$2,250 from Breckenridge MN during a blind auction
- Average School Bus Found on Facebook Market Place is roughly \$4,500

# Adaptable

- Over-designed to ensure safety of original intended users
- Compartmentalization
  - Floor above crash zone
  - Hat-Channel Framing creates “Zones” in damage when it
  - 1/7<sup>th</sup> as deadly as a standard vehicle collision
- All of this helps with the ability to adapt the School Bus into a space that will better fit the needs of Nomadic Life Style



# Cultural



(Lenz L, A Brief History of the School Bus, 2022)

- **Uniquely American, specifically the Yellow Paint**
  - **School Buses trace their roots back to Puritan Colony's compulsory education**
- **In 1939, Frank Cyr, organized a conference on School Bus Safety Standards**
  - **Led to the choosing of "School Bus Chrome Yellow" for all school busses nationally**
  - **Other design choices such as all steel framing, compartmentalization, and other national requirements followed in years to come.**

# How a School Bus is Built

## BODY TO FRAME ATTACHMENT DETAIL

- **2 Parts:**
  - **Frame:** Houses the mechanical portions of a vehicle including the cab
  - **Body:** Houses the passengers, main part that will be redesigned.

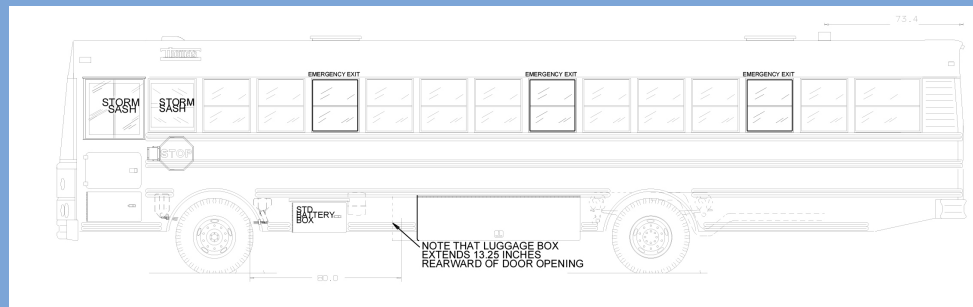

(Gattis J.L., Howard M., Large School Bus Design Vehicle Dimensions 1998)

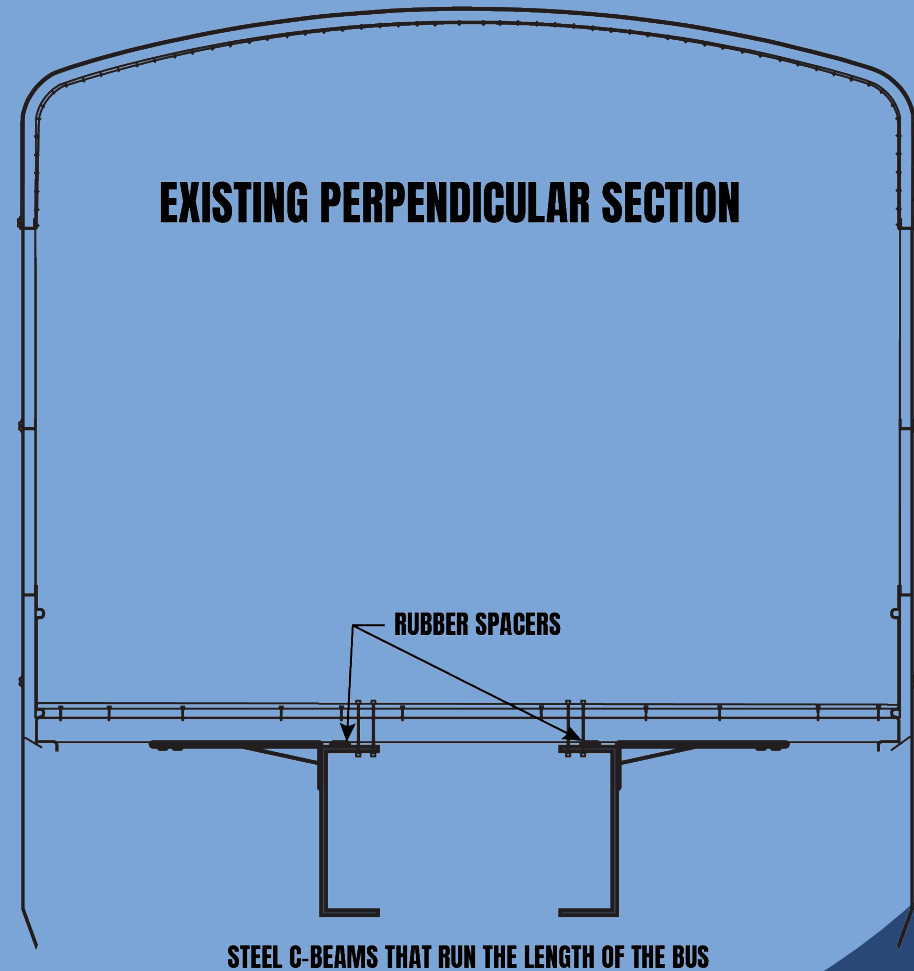

**1. Sheet MTL.  
Bent into C-  
Channels &  
Welded Together**



## 2. Hat-Channels bent to create “void” of School Bus





**3. Connect  
Hat-Channels  
together and  
attach seat rail**

**4. Slide C-  
Channel Floors  
into Seat Rail**





# 5. Framing of Windows, Wheel Wells & Back Wall





## **6. Exterior Sheet Metal Attached & Ceiling fire escape framed**



## **7. Body Attached to Frame**

# Methodology

## 1. Affordability

1. Staying to Budget
2. Needs over Wants
3. Buildable

## 2. Sustainability

- Recycling of Materials
- Purchasing Materials from Alternative Sources

## • 3. Flexibility

- Adaptable Design to Increase space Utilization
- Sqf to represent time spent  
Traveling, Boondocking, or Wet-Camping

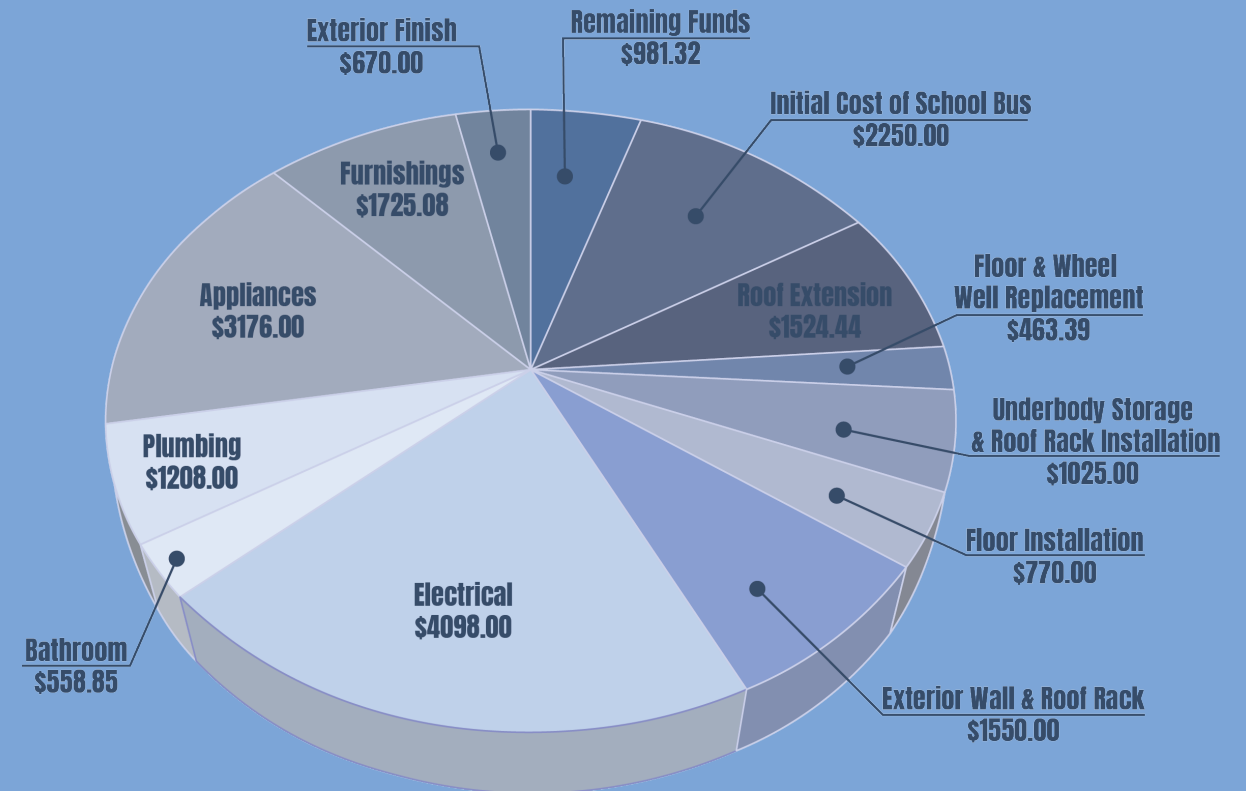

# \$20,000 Budget



(Jason Armstrong, Mavis  
Airstream 2022)

# Inspiration



(Jeff Osborne, Some  
Drifters Studio, 2019)



(McGraw, 1973-1978  
GMC Motorhome 2016)

# Design Changes to School Bus Body Exterior

- Roof Extension
- Wheel Well Replacement
- Floor Treatment
- Window Replacement
- Roof Rack
- Underbody Storage

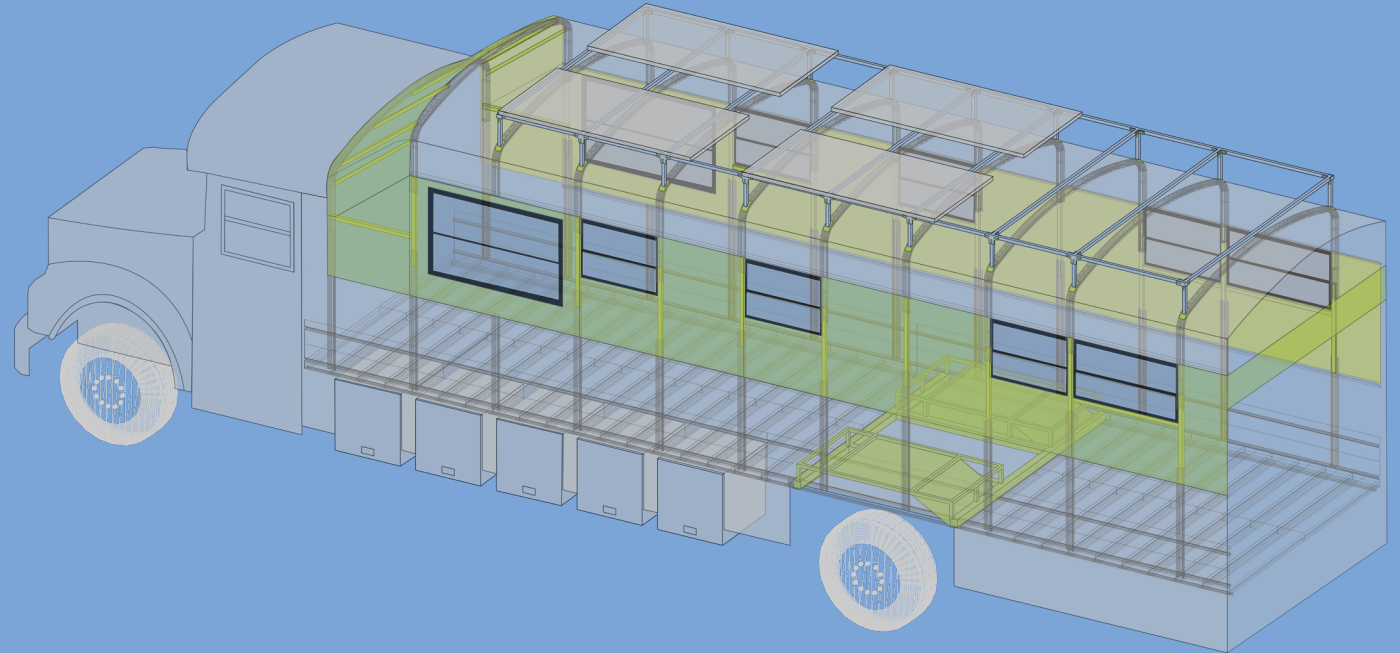

# 20" Roof Raise

- Existing Floor to Ceiling in Center: 6'-03"
- Insulation Concerns

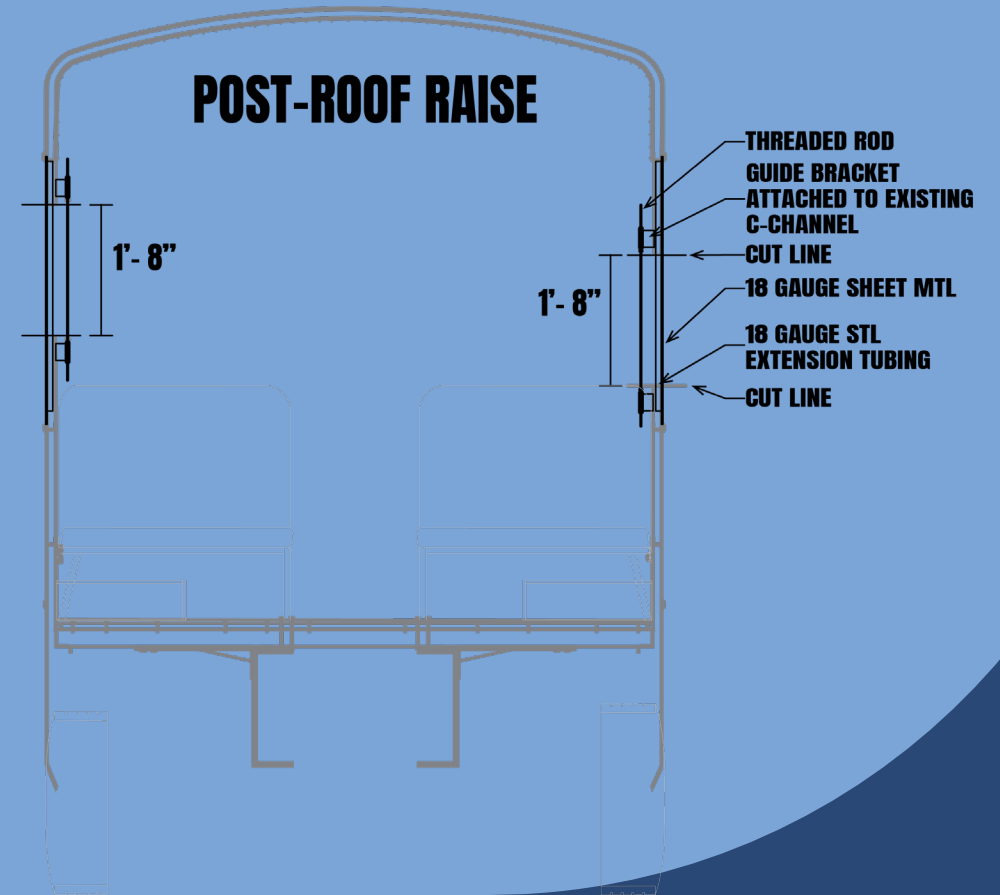
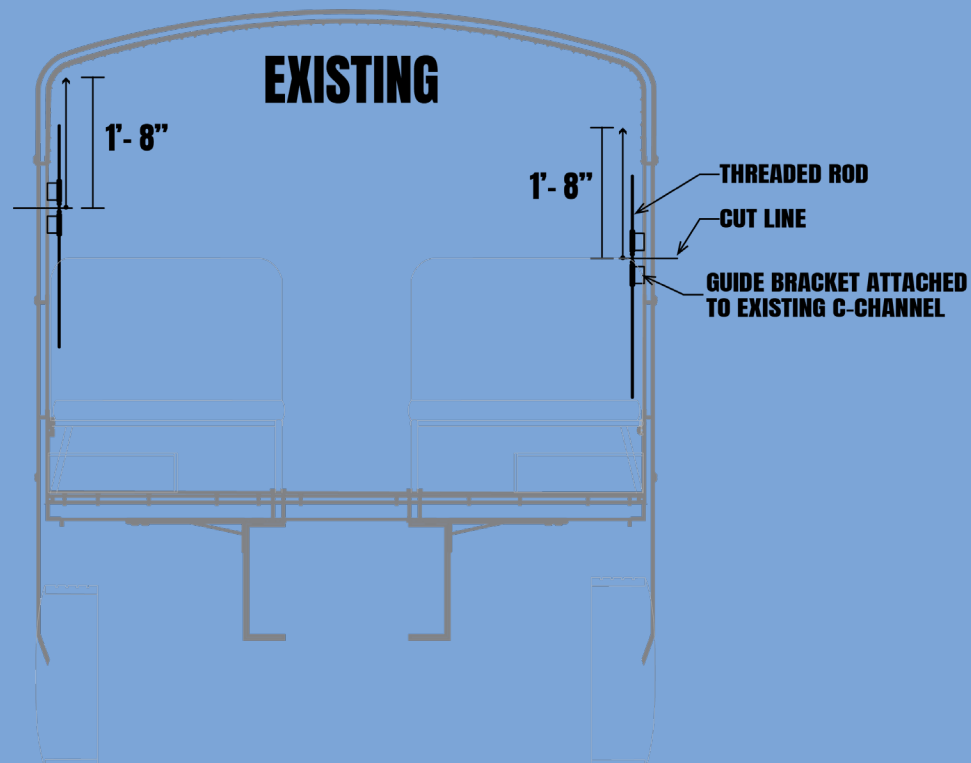

# Transition

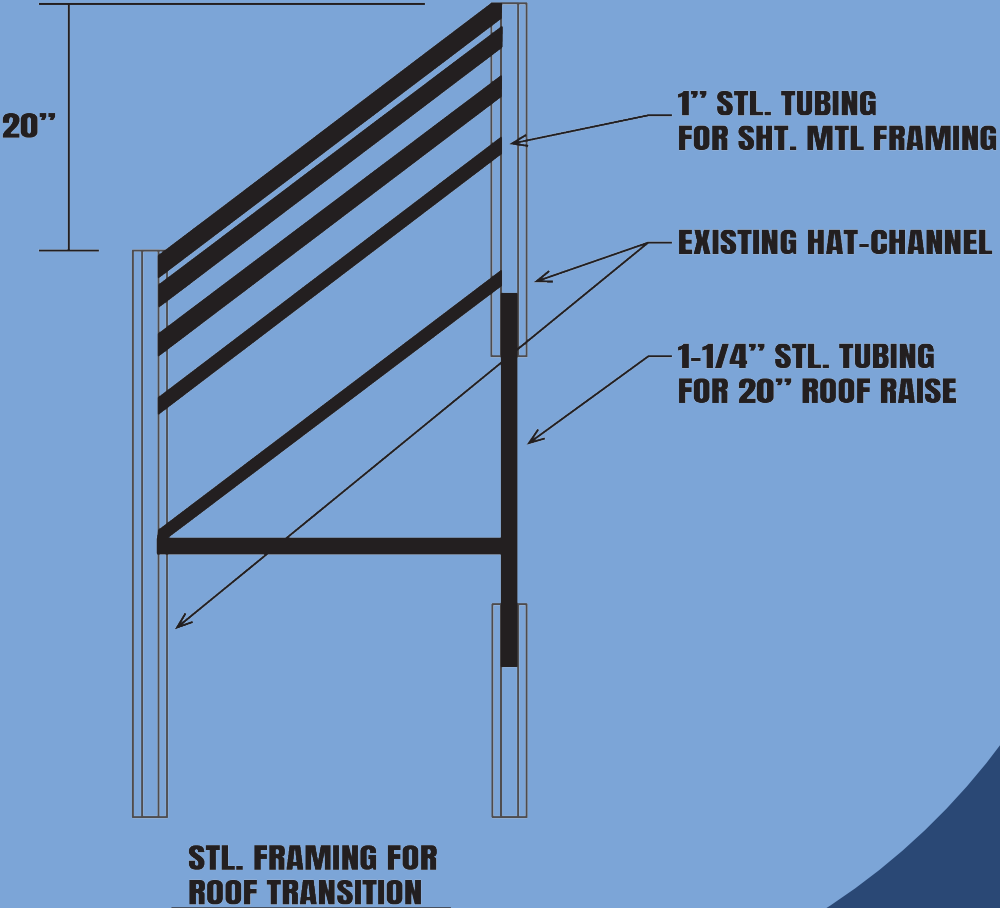
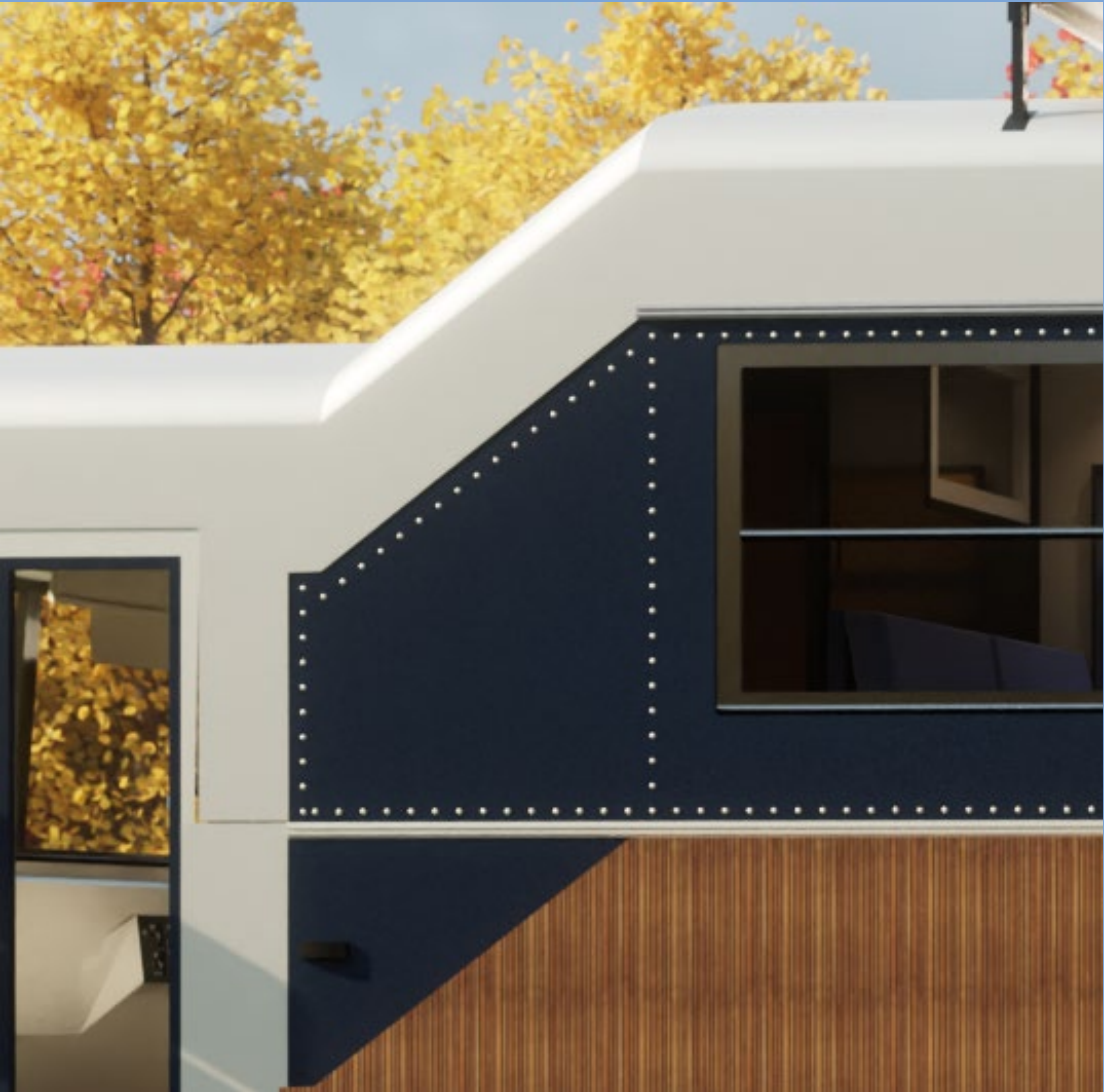





# Before/After



EMERGENCY EXIT

EMERGENCY EXIT

BRECKENRIDGE PUBLIC SCHOOL DIST 948

DIESEL ONLY 60 GAL

65 PASS

Thomas  
SCHOOL BUSES

# Wheel Well Replacement



# Wheel Well Replacement Plan

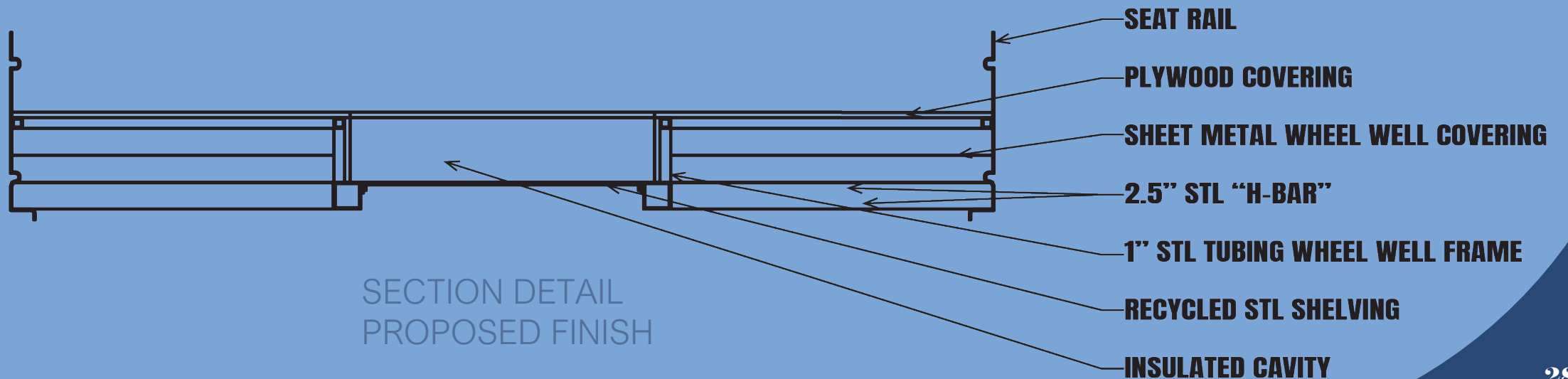
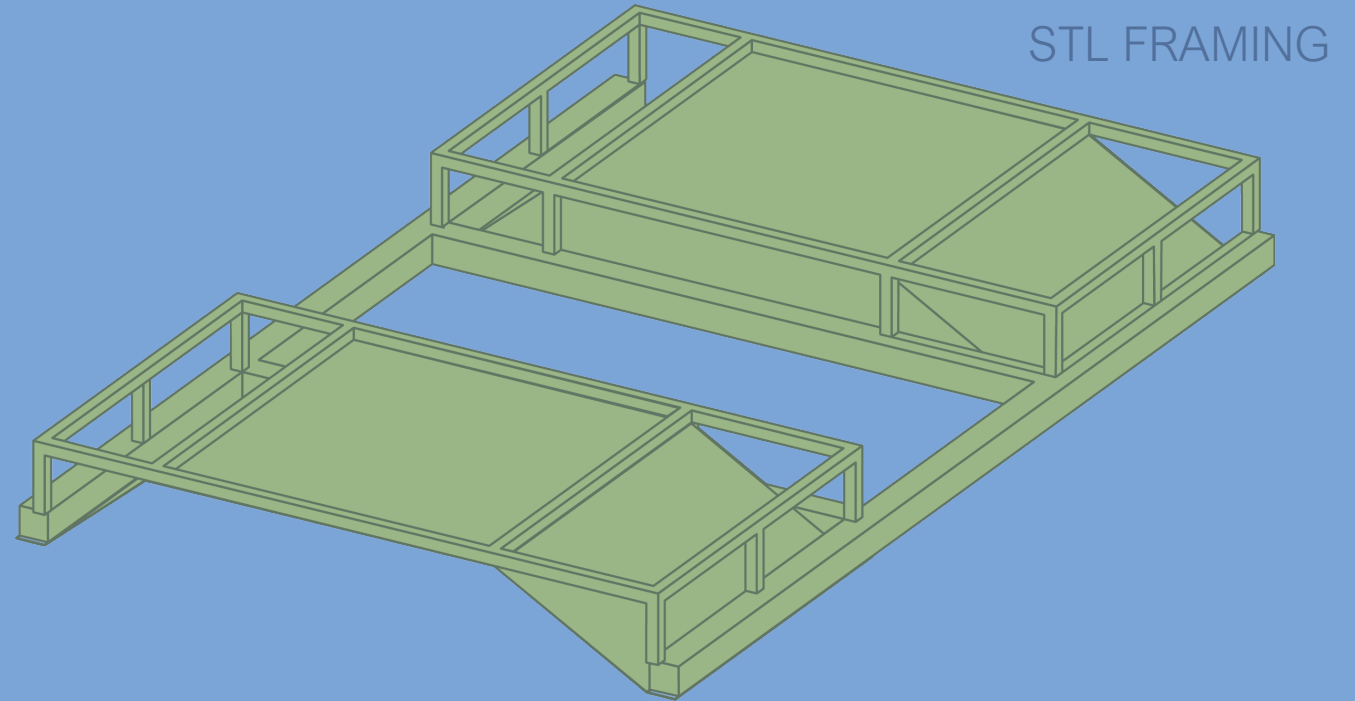



# New Wheel Framing

# New Wheel Framing

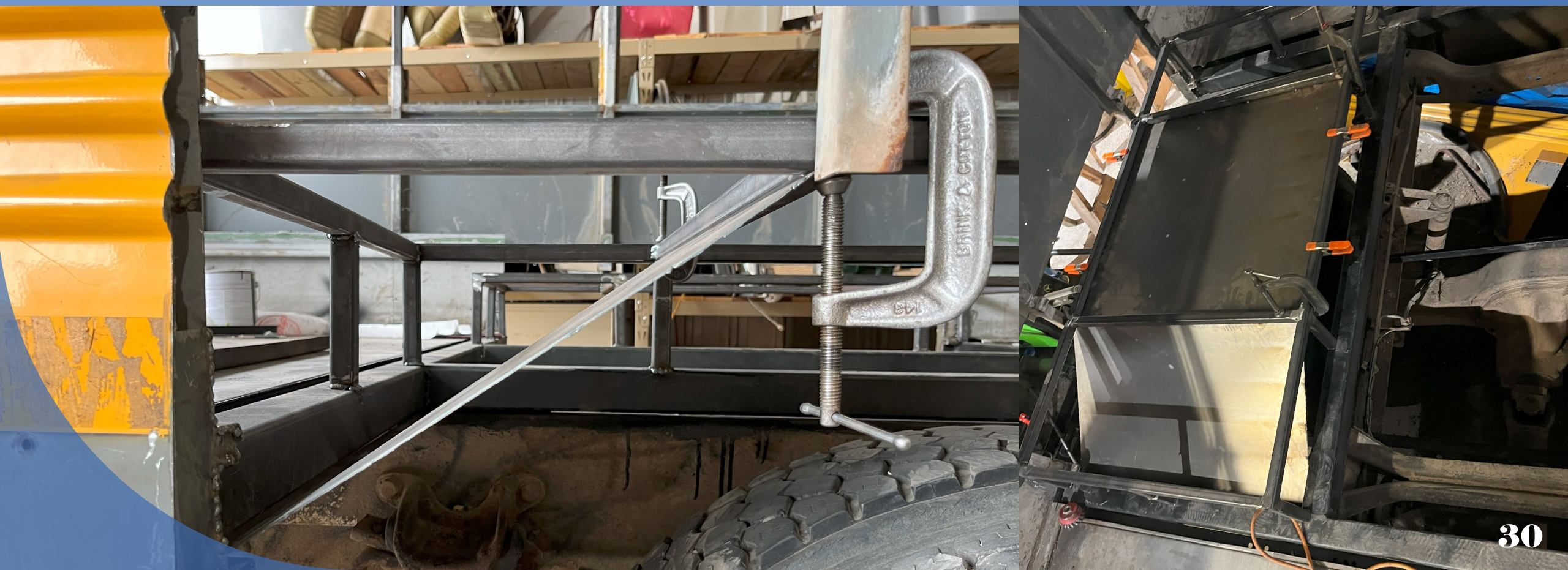

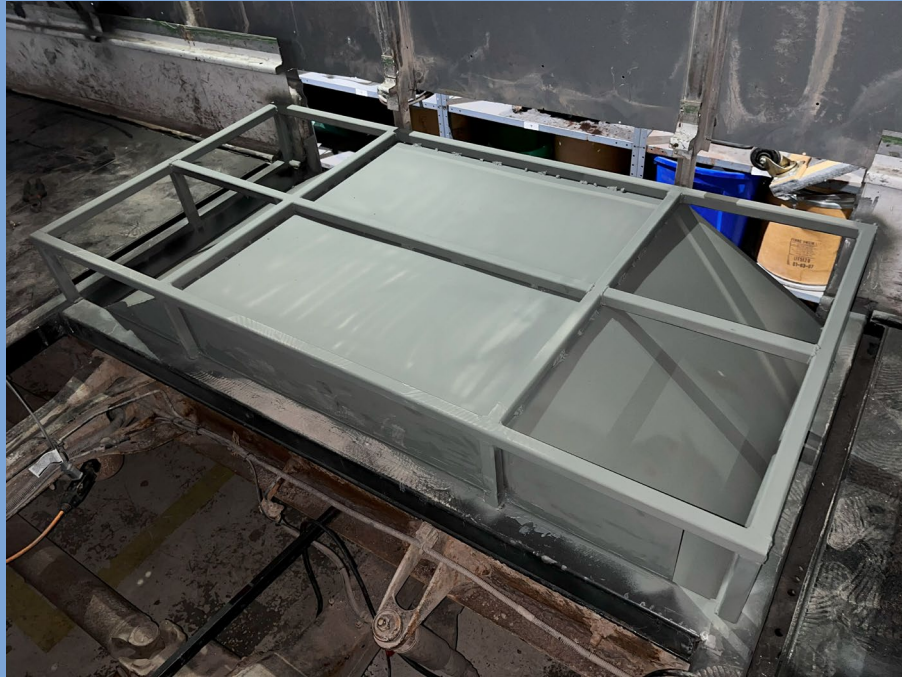

# Wheel Well Finish



# Floor Treatment



# Windows/Door

- **Recycle Existing Windows**
  - Cheapest and Most Sustainable
  - Poor Condition, Heat Sink and Limited Size
- **RV Windows**
  - Large Sizes, more Customization, reduced Framing and Increased Performance
  - Expensive and less sustainable

# Roof Rack

- Aluminum Framing
  - Solar Panels
  - Extra Storage Potential

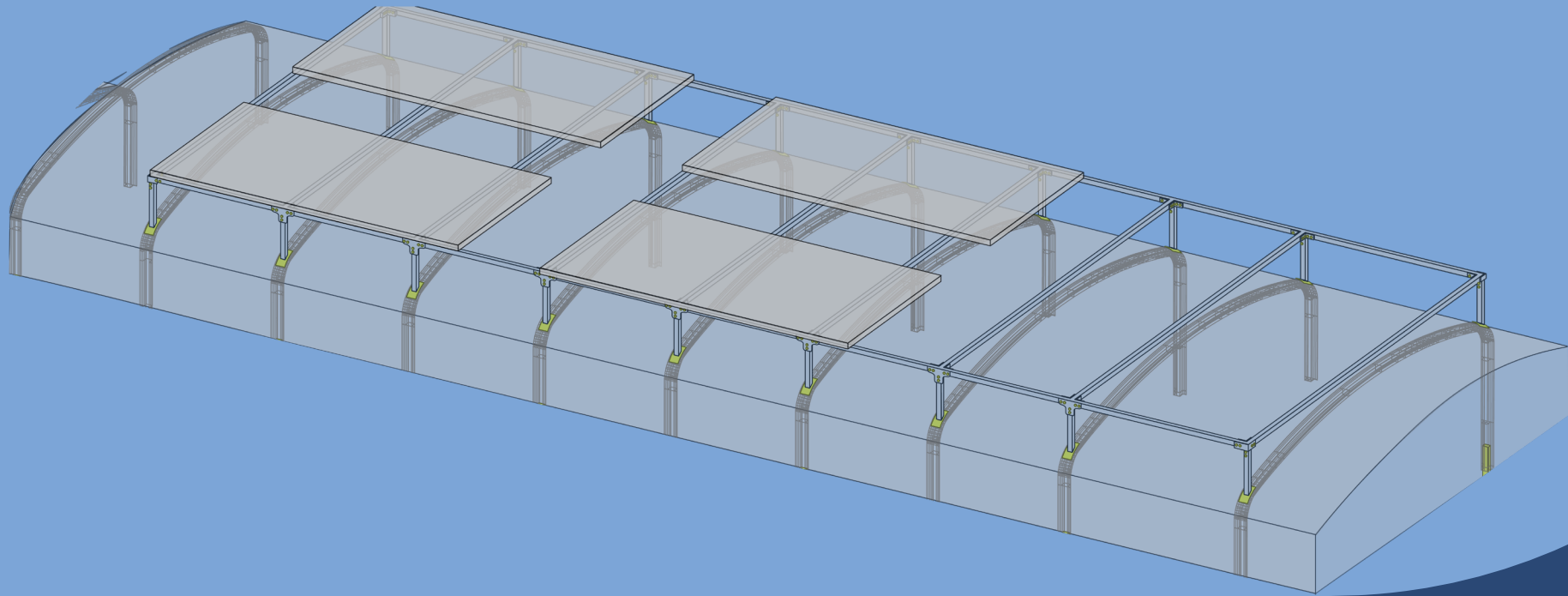

# Under Body Storage

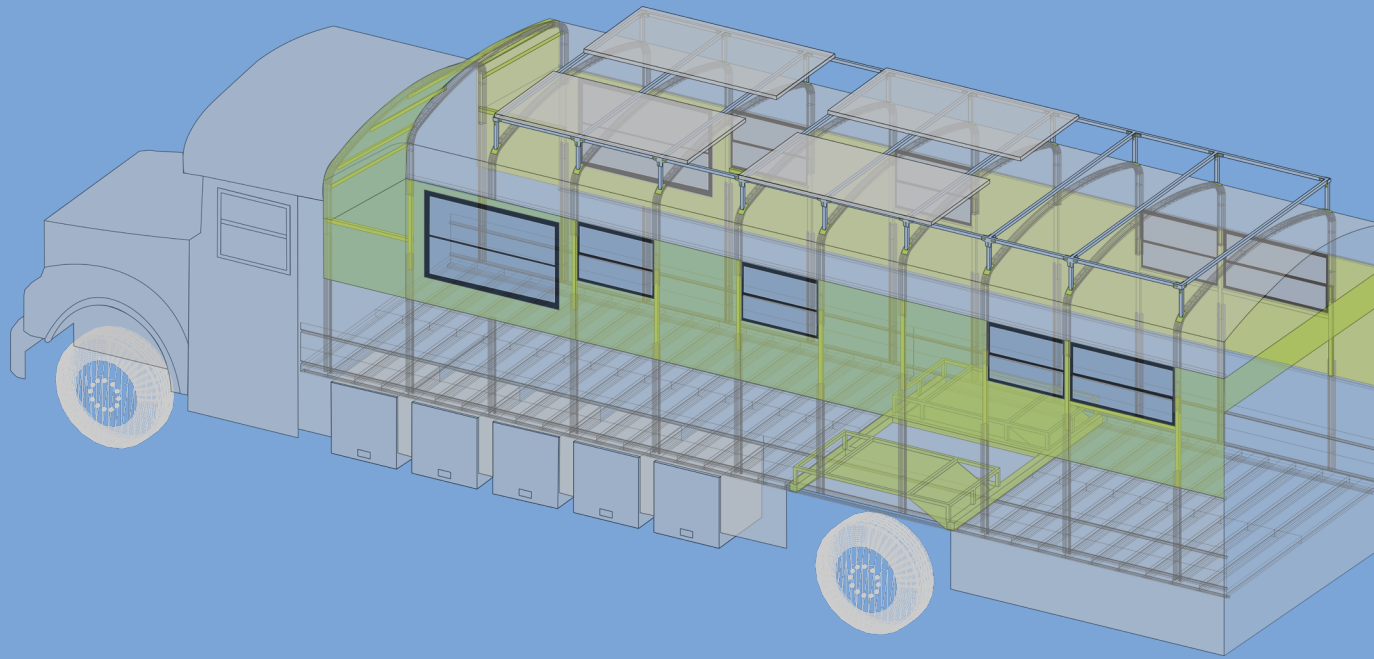
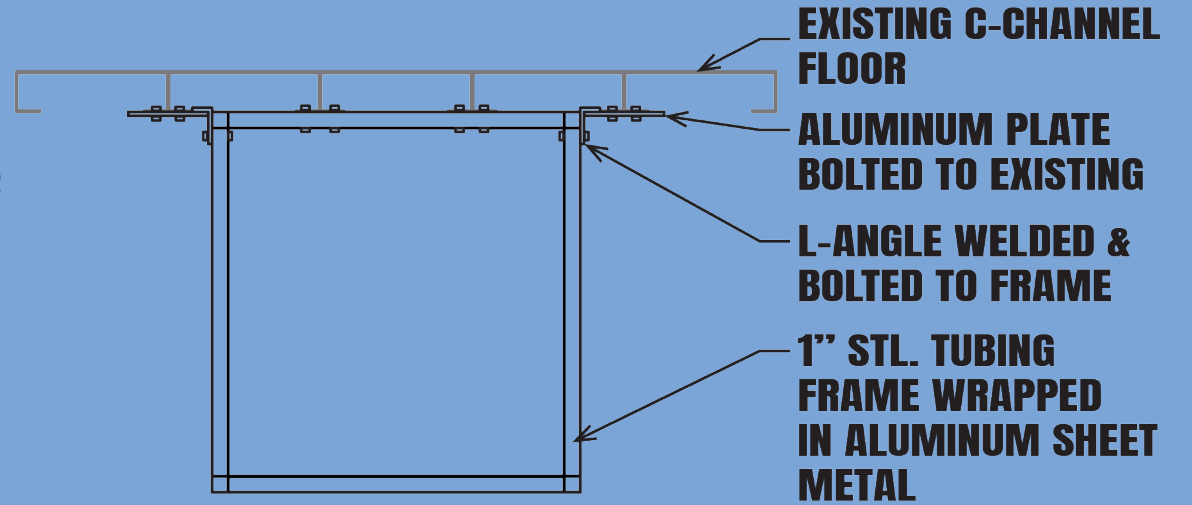



# FRAMING PLAN

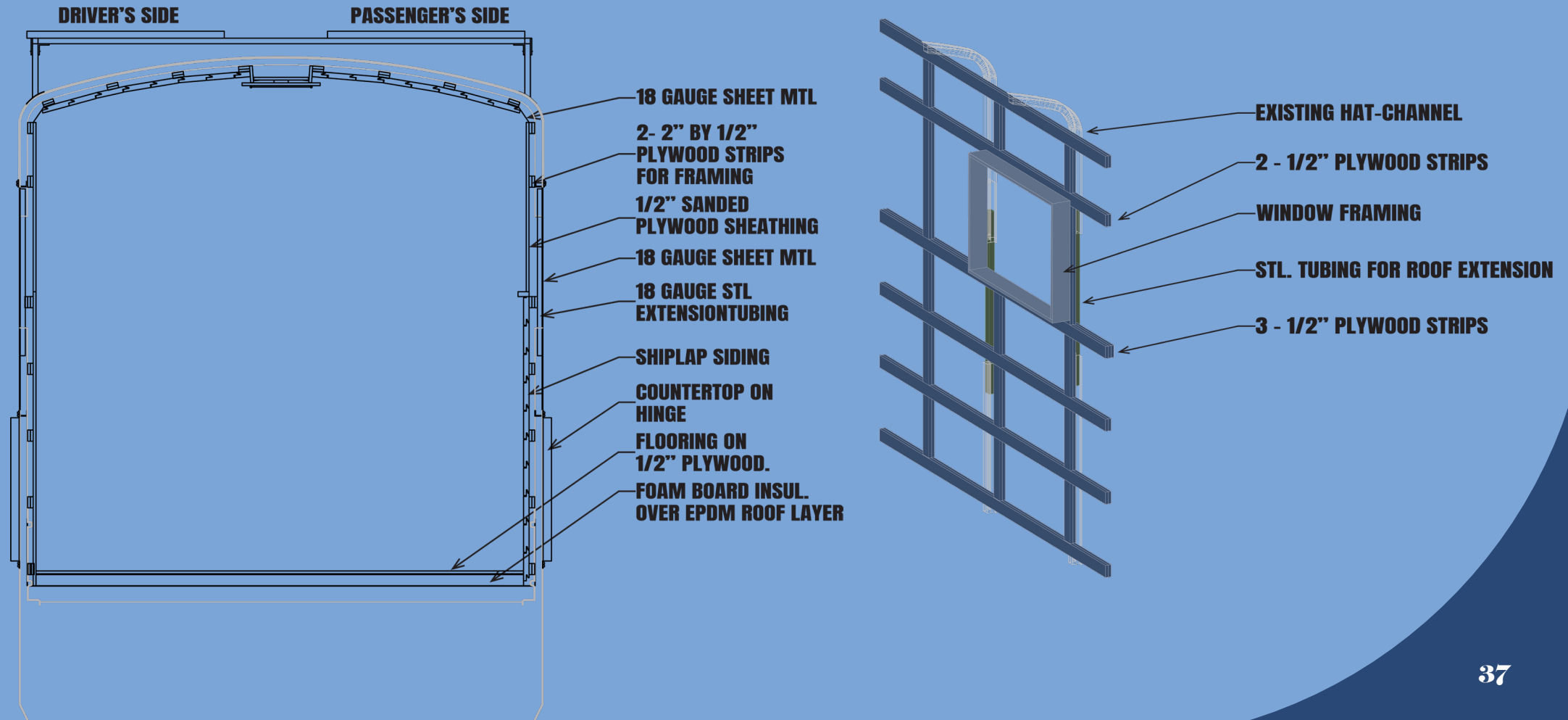

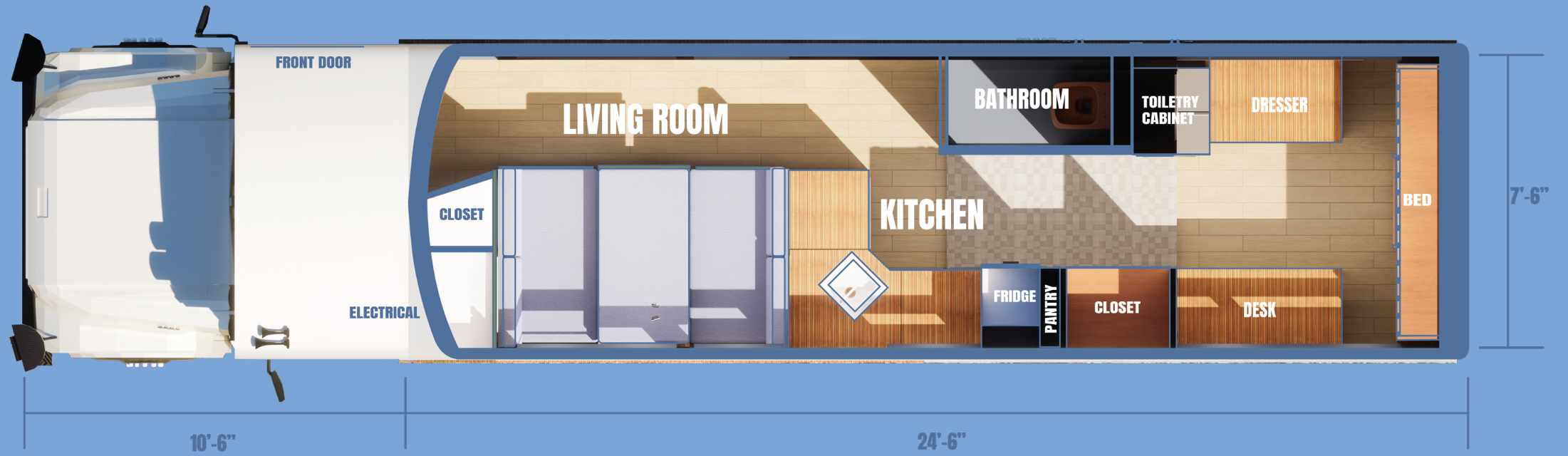

# FLOOR PLAN

# Driver's Side Section



# Passenger's Side Section









**Adaptable**



# Adaptable



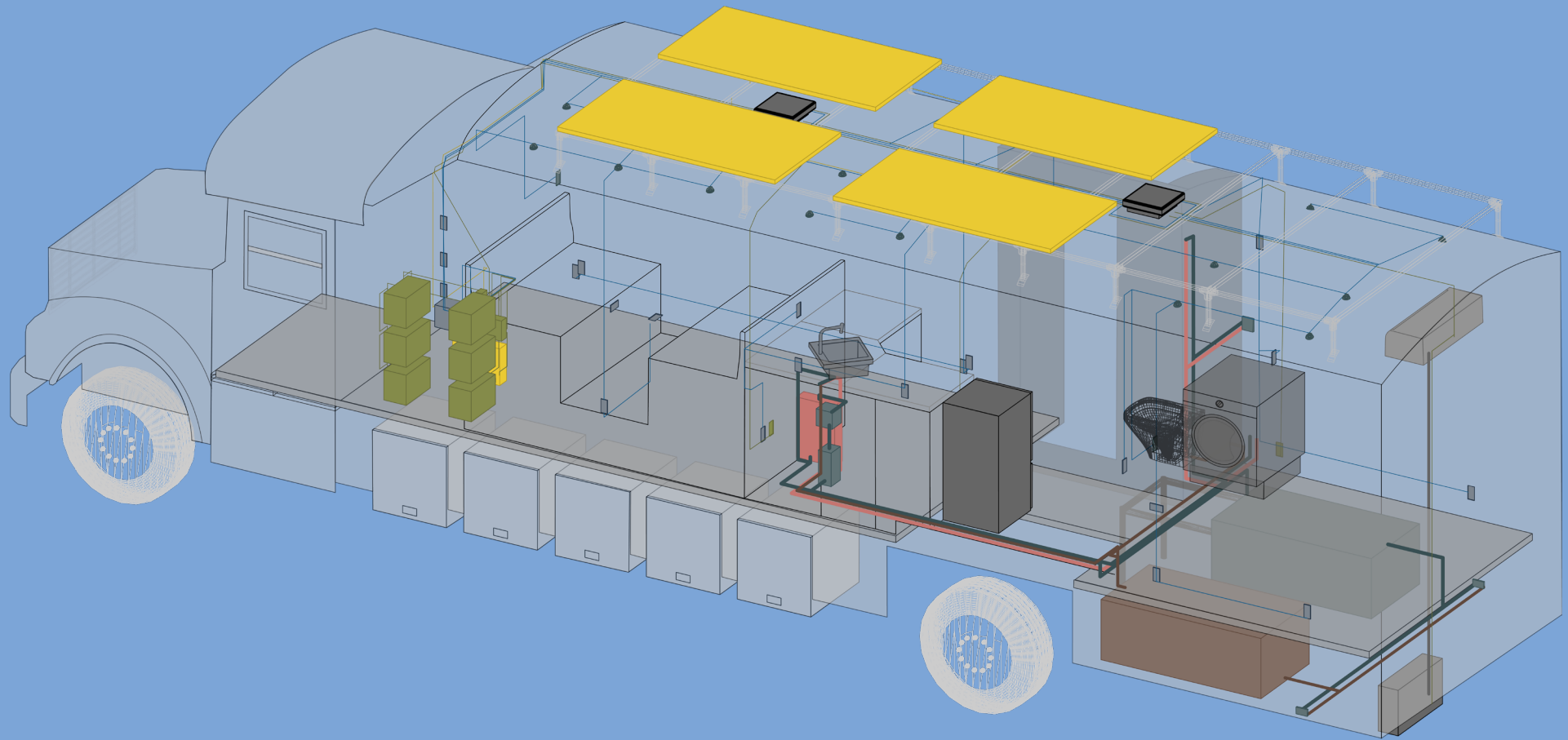

- SOLAR
- 12V ELECTRICAL
- 120V ELECTRICAL
- APPLIANCES
- HOT WATER
- COLD WATER
- GRAY WATER

# HVAC

# Final Interior

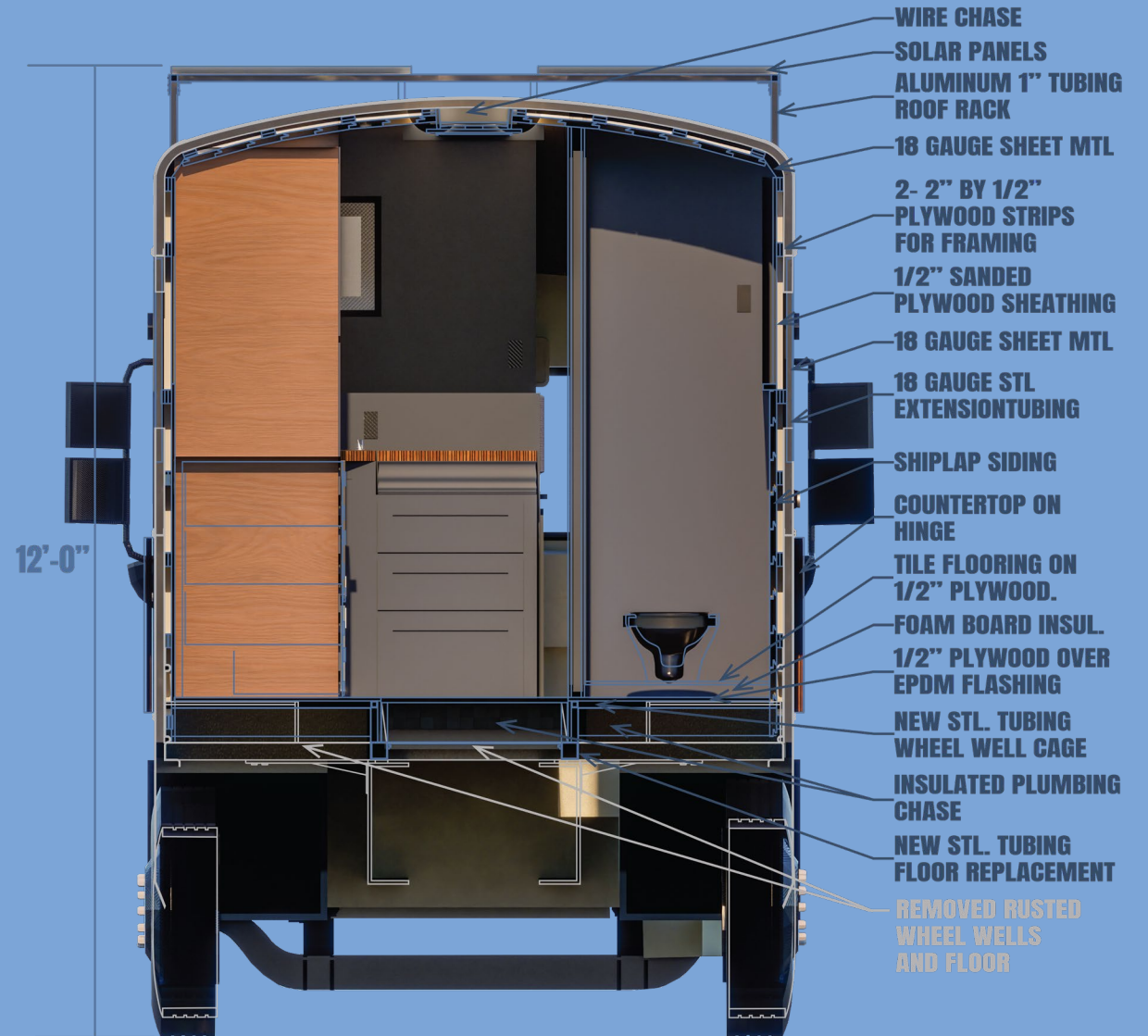



# Progress Pictures





# Progress Pictures



# Progress Pictures



# Progress Pictures



# Progress Pictures





**Thank You!**

# Works Cited

Airstream. (2018, December 21). Heritage: Airstream history. Airstream Heritage.

<https://www.airstream.com/heritage/>

Barron, J. (2013, February 19). Why the school bus never comes in red or green. The New York Times.

[https://archive.nytimes.com/cityroom.blogs.nytimes.com/2013/02/19/why-are-school-buses-yellow-a-teachers-college-professor-said-so/?\\_r=0](https://archive.nytimes.com/cityroom.blogs.nytimes.com/2013/02/19/why-are-school-buses-yellow-a-teachers-college-professor-said-so/?_r=0)

Dey, M., Frazis, H., Loewenstein, M., & Sun, H. (2020). Ability to work from home: Evidence from two

surveys and implications for the labor market in the COVID-19 pandemic. *Monthly Labor Review*. <https://doi.org/10.21916/mlr.2020.14>

Farrow, A., Taylor, H., & Golding, J. (1997). Time spent in the home by different family members.

*Environmental Technology*, 18(6), 605–613. <https://doi.org/10.1080/09593331808616578>

Garrote Sanchez, D., Gomez Parra, N., Ozden, C., Rijkers, B., Viollaz, M., & Winkler, H. (2020). Who on

earth can work from home ? *Oxford University*, 75–77. <https://doi.org/10.1596/1813-9450-9347>

Hennessey, James, and Victor J. Papanek. *Nomadic Furniture 2*. [1st ed.]. New York: Pantheon

Books, 1974. Print.

Harris, J. (2016). On the Buses: Mobile Architecture in Australia and the UK, 1973-

75. *Architectural Histories*, 4(1), 1–14. <https://doi.org/10.5334/ah.186>

Katz, M. (1976). *A History of Compulsory Education Laws*. Phi Delta Kappa, Bloomington, Ind.

Khajehzadeh, I., & Vale, B. (2016). How New Zealanders distribute their daily time between home

indoors, home outdoors and out of home. *Kōtuitui: New Zealand Journal of Social Sciences Online*, 12(1), 17–31. <https://doi.org/10.1080/1177083x.2016.1187636>

Khasanov, A. O. (2021). Residential Yurts Of The Ancient Nomads Of Central Asia And The Use Of Yurts

In *Tourism*. *The American Journal of Engineering and Technology*, 3(1).

# Works Cited

Krakauer, J., & Vann, D. (2018). *Into the wild*. Picador.

Kronenburg, Robert. *Portable Architecture : Design and Technology*. New ed. Basel: Birkhäuser, 2008. Print.

Lenz, L. (2022, September 1). A brief history of the school bus. *Smithsonian.com*.

<https://www.smithsonianmag.com/innovation/history-school-bus-180980554/>

McCraw, J. (2021, October 5). 1973-1978 GMC Motorhome: General Motors' grand RV experiment.

1973-1978 GMC Motorhome: General Motors' Grand RV Experiment.

<https://www.macsmotorcitygarage.com/1973-1978-gmc-motorhome-general-motors-grand-rv-experiment/>

Such, R. (2008). Vehicle for Changing. *Domus*, 920, 1

Oygür, I., Göçer, Ö., & Karahan, E. E. (2022). Hybrid Workplace: Activity-based Office Design

in a Post-pandemic Era†. *Journal of Interior Design*, 47(3), 3–10.

<https://doi.org/10.1111/joid.12218>

R. P. (2021). Can live-work units make WFH more enjoyable, efficient and equitable? *Frame*, 143, 20–21

Trisno, R., Husin, D., & Lianto, F. (2023). Reconceptualising nomadic architecture: From the body to the space creation. *City, Territory and Architecture*, 10(1). <https://doi.org/10.1186/s40410-022-00191>