

KIBERA PUBLIC SCHOOL

EMPOWERING KENYA THROUGH LOCAL MATERIALS AND LABOR

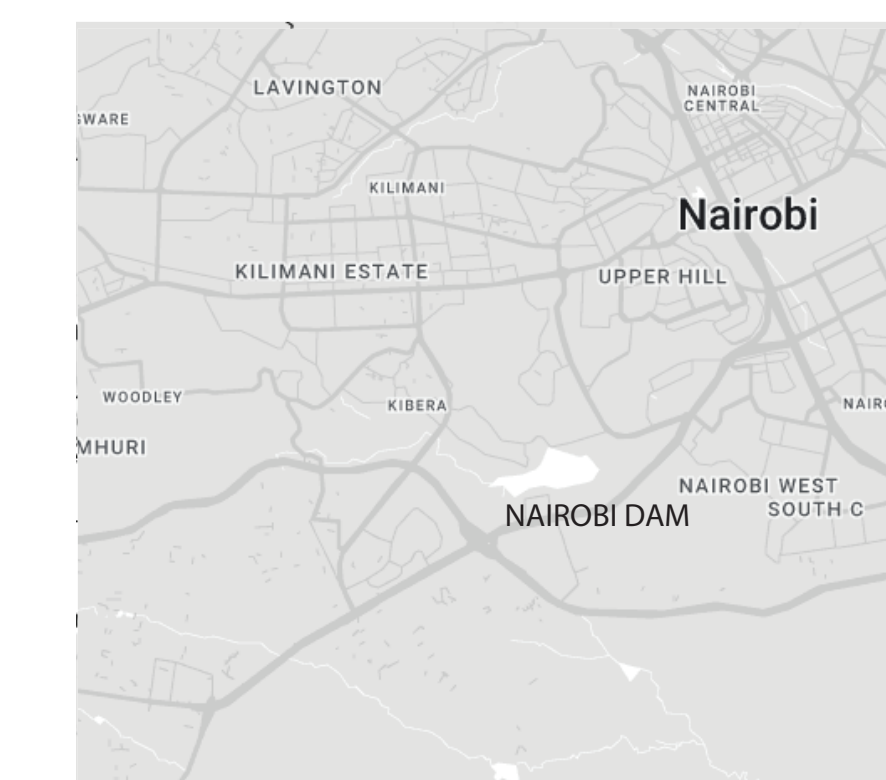

AFRICA'S LARGEST URBAN SLUM, KIBERA SLUM, EXPERIENCES A HIGH PERCENTAGE OF BOYS AND GIRLS WHO DO NOT ATTEND SCHOOL. UNFORTUNATELY, WHILE EDUCATION SERVES AS THE BIGGEST RESOURCE FOR INDIVIDUALS LIVING IN POVERTY TO RISE ABOVE THEIR CIRCUMSTANCES, THE COST TO SEND STUDENTS TO PRIVATE SCHOOLS IS TOO EXPENSIVE. THIS IS PRIMARILY DUE TO PUBLIC SCHOOLS BEING GOVERNMENT-FUNDED AND LACKING PROPER ORGANIZATIONAL STRUCTURE. THIS THESIS SEEKS TO ENGAGE THE KIBERA COMMUNITY THROUGH THE USE OF BOTH LOCAL MATERIALS AND LOCAL LABOR; EMPOWERING NOT ONLY THE STUDENTS BUT ALSO THE SURROUNDING COMMUNITY.



CLASSROOM SECTION CUT

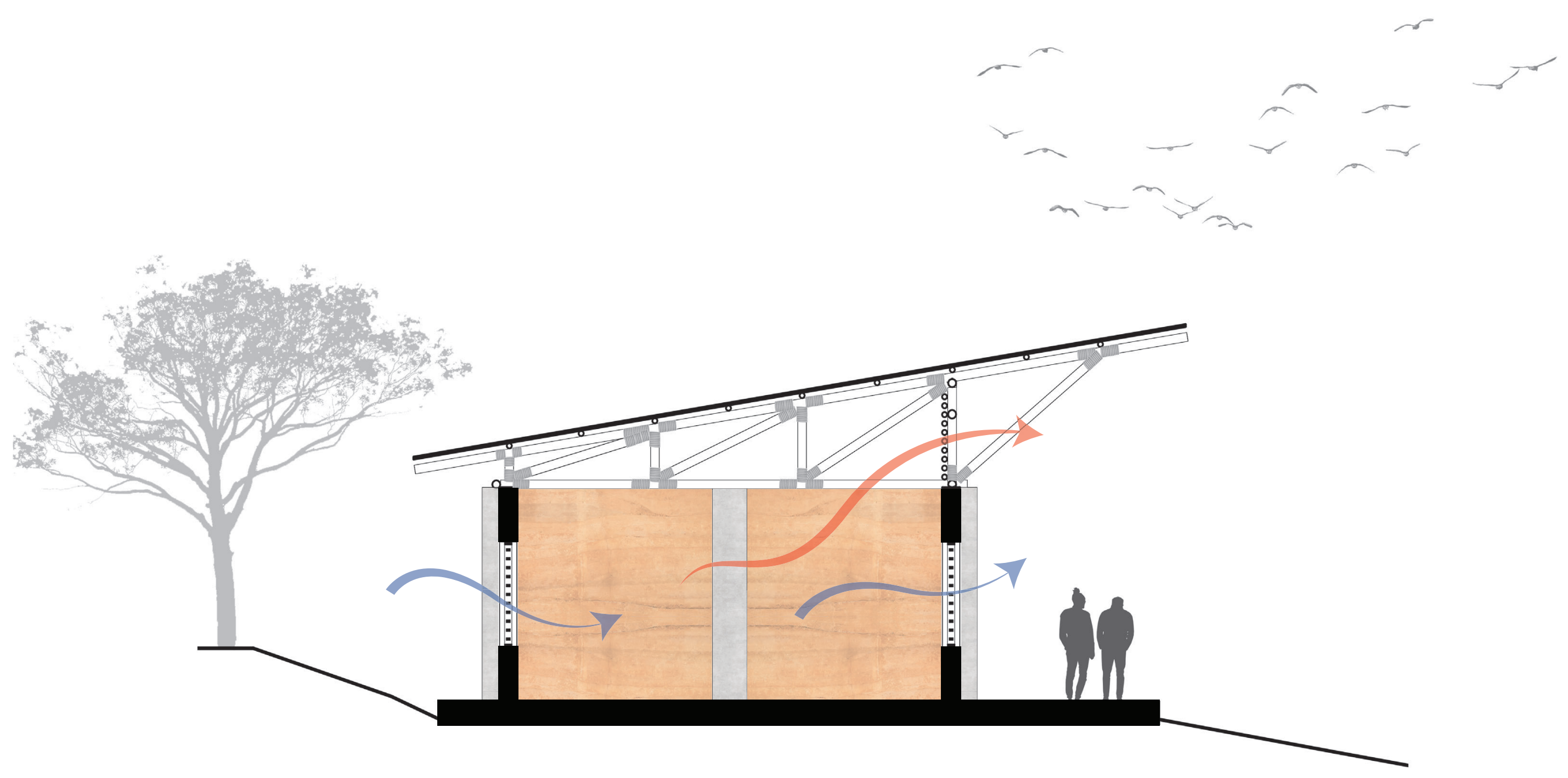

ISOMETRIC SITE PLAN + AXONOMETRIC DIAGRAM

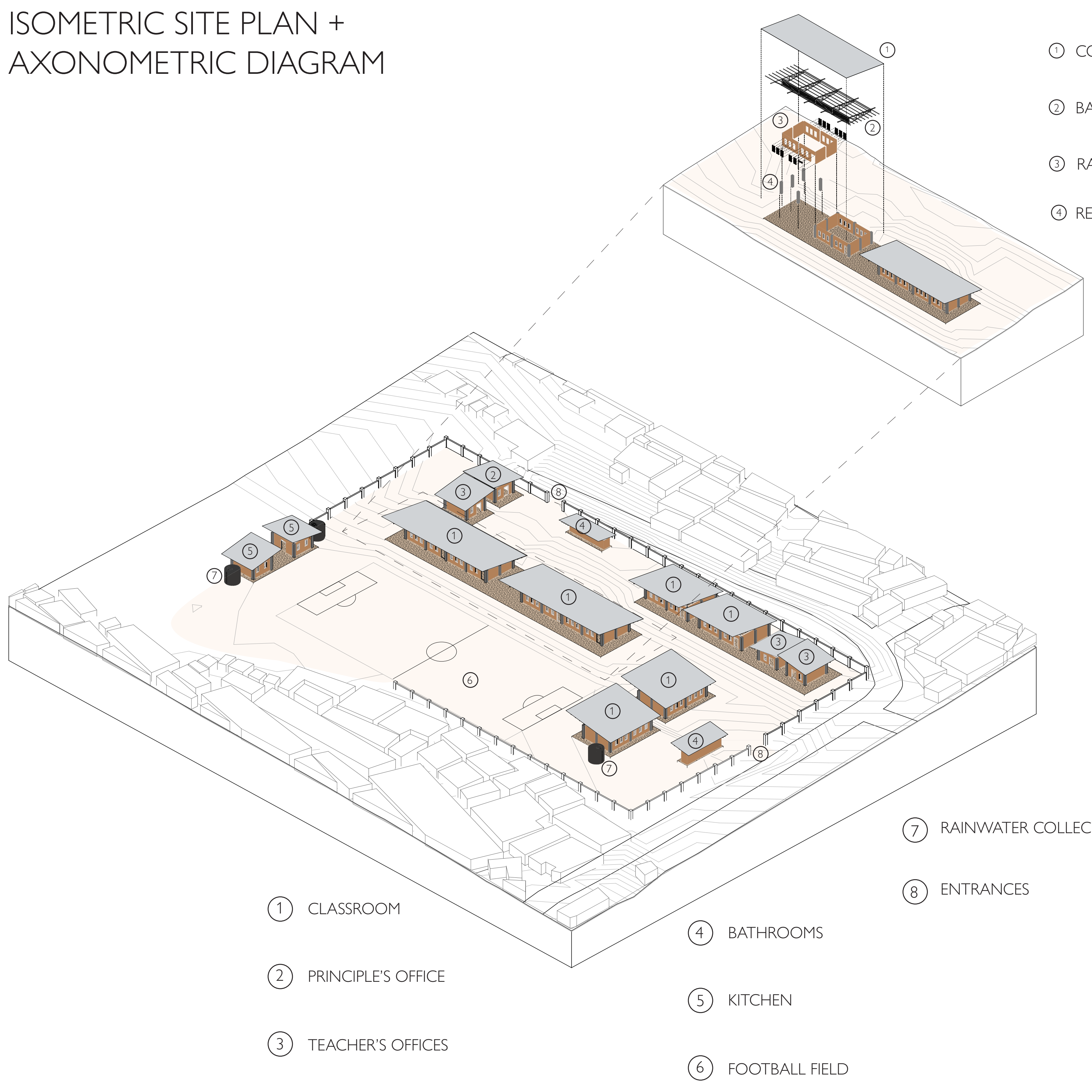

- ① CORRUGATED METAL DECKING
- ② BAMBOO STRUCTURAL TRUSS
- ③ RAMMED EARTH WALL
- ④ RECYCLED PLASTIC BRICK COLUMNS

- ① CLASSROOM
- ② PRINCIPLE'S OFFICE
- ③ TEACHER'S OFFICES
- ④ BATHROOMS
- ⑤ KITCHEN
- ⑥ FOOTBALL FIELD

- ⑦ RAINWATER COLLECTION TANK
- ⑧ ENTRANCES

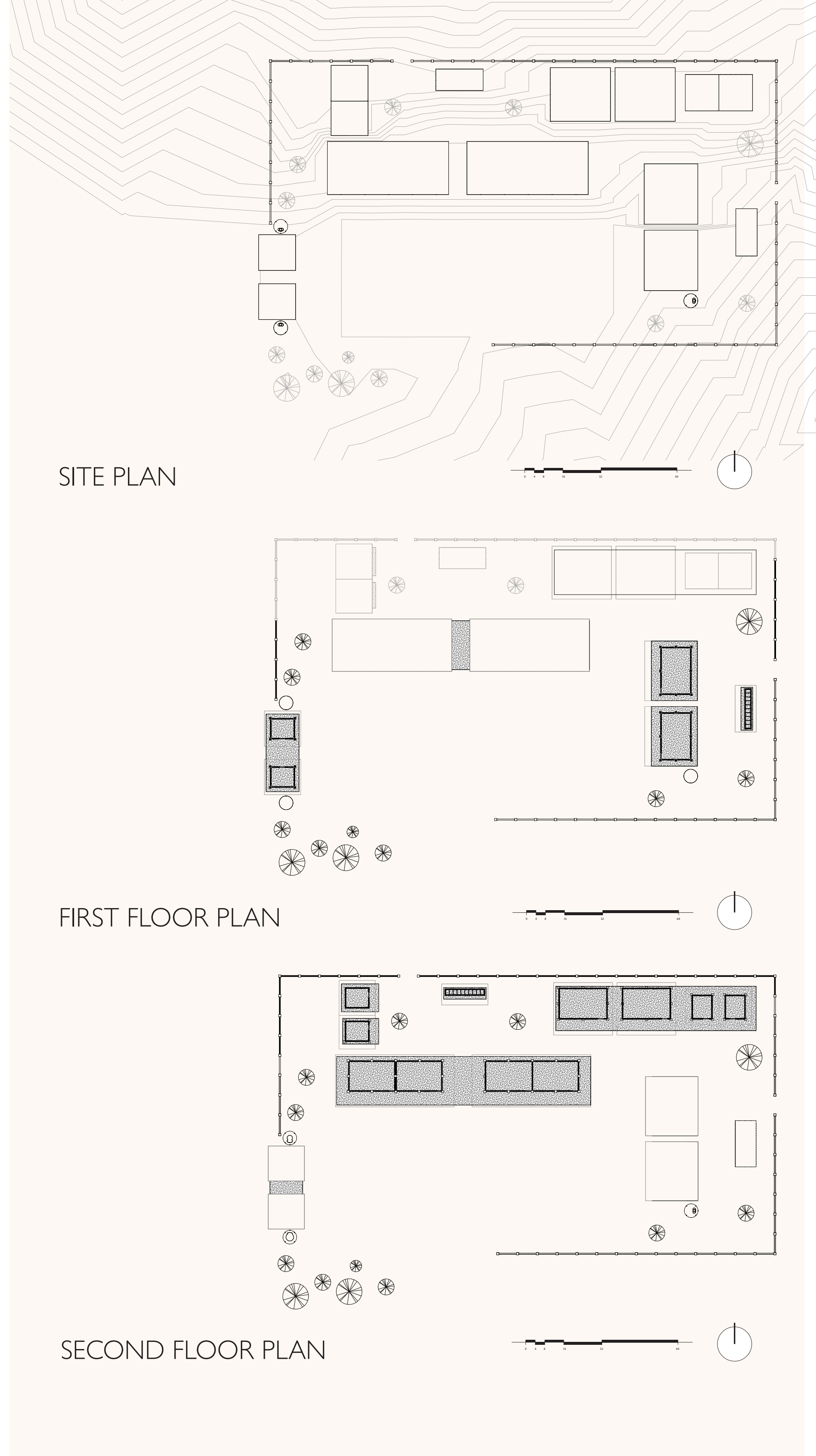

RAMMED EARTH WALL PROCESS

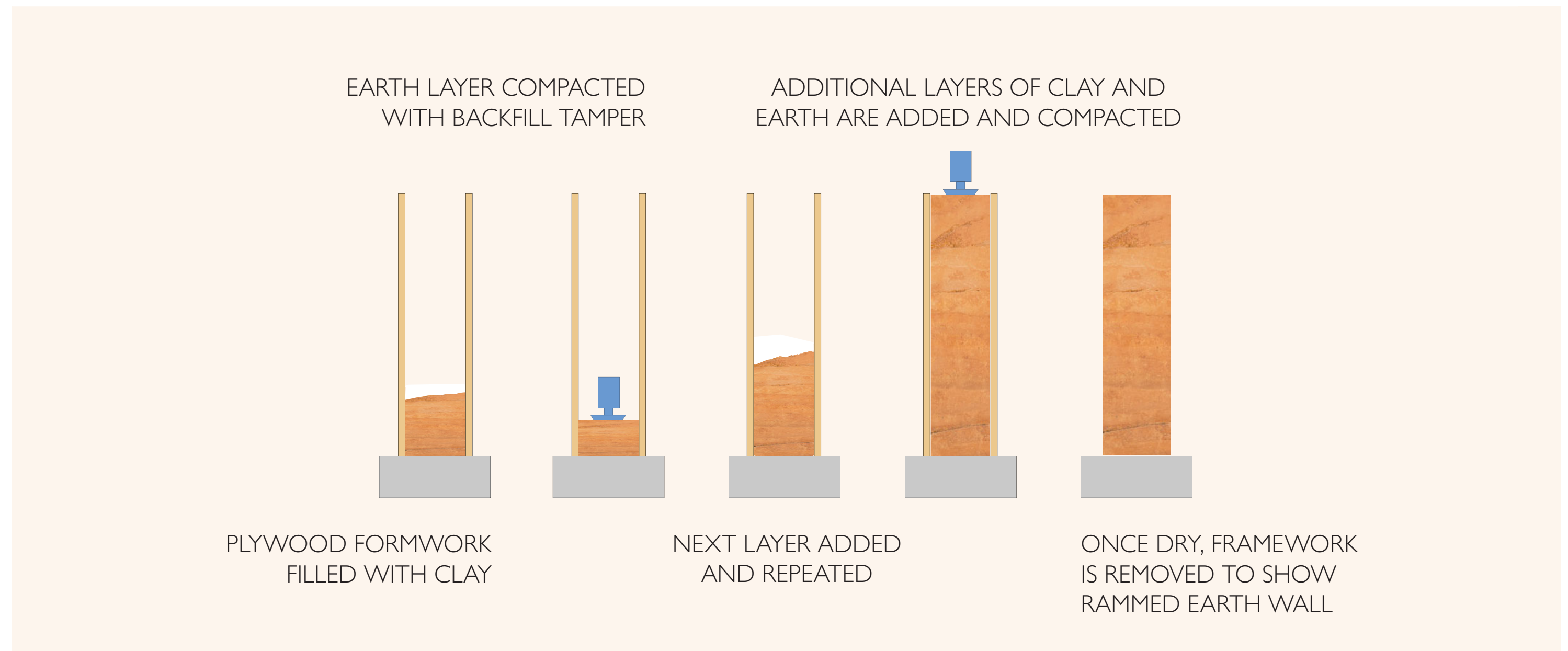

SECTION CUT

