

CHRYSOPOEIA:

A TRANSCENDENTAL METAMORPHOSIS OF CONSCIOUSNESS

THE IDEA OF CHRYSOPOEIA, THE TRANSFORMATIVE ACT OF TRANSCENDENCE, OF TURNING LEAD TO GOLD, SERVES AS THE FOUNDATION TO THIS DUAL SITE MENTAL HEALTH REHABILITATION CENTER. AS OF TODAY, OREGON IS ONE OF THE WORST STATES FOR MENTAL HEALTH IN THE U.S. AS OF 2023, OREGON LEGALIZED THE USE OF PSILOCYBIN, THE ACTIVE INGREDIENT IN PSYCHEDELIC MUSHROOMS, FOR THERAPEUTIC AND MEDICAL USE DUE TO THE SIGNIFICANT EFFECTS IT HAS ON TREATING MENTAL ILLNESSES. THE PROJECT IS DESIGNED TO FOCUS ON THE USE OF PSYCHEDELIC ASSISTED THERAPY WHILE BEING SUPPLEMENTED WITH OTHER FORMS OF THERAPY AND PRACTICES OF WELLBEING SUCH AS COLD EXPOSURE THERAPY, PSYCHOTHERAPY, IMMERSION IN NATURE, COMMUNITY BUILDING, ARTISTIC EXPRESSION, AND EXERCISE TO CREATE A HOLISTIC MENTAL HEALING EXPERIENCE.

THE INSPIRATION FOR THIS PROJECT AND DESIGN LARGELY COMES FROM THE WORK OF RENOWNED PSYCHIATRIST CARL JUNG AND HIS STUDY OF ANCIENT ALCHEMY. IN STUDYING THE ANCIENT TRADITIONS OF ALCHEMY, JUNG DISCOVERED A PROFOUND RELATIONSHIP BETWEEN THE PRACTICES OF ALCHEMY AND THE TRANSFORMATION OF ONE'S SELF AND INNER PSYCHE FOR THE BETTER. IN A SENSE, THE PRACTICES OF ALCHEMY CAN BE TRANSLATED INTO PRACTICES OF SELF BETTERMENT, SPECIFICALLY IN THE REALM OF MENTAL HEALTH. THE ALCHEMIST'S MAIN PURSUIT OF TURNING LEAD INTO GOLD IS AKIN TO THE CLIENT'S PURSUIT OF TRANSFORMING THEIR INNER BEING INTO A HIGHER STATE OF CONSCIOUSNESS.

THE PARTICIPANTS IN THE PROGRAM COME TO THE FIRST SITE IN PORTLAND, OREGON KNOWN AS THE AETHER, A PLACE OF LIGHT, BEYOND, ABOVE, AND PREPARATION. IT IS HERE WHERE THOSE WHO WISH TO UNDERGO THE METAMORPHOSIS OF THEIR INNER BEING BEGIN THEIR MONTH-LONG JOURNEY AND STAY AT THE CENTERS. FOR TWO WEEKS, PARTICIPANTS DEVELOP THE PURPOSE OF THEIR JOURNEY AND PREPARE THEMSELVES FOR WHICH THEY HOPE TO ADDRESS THROUGH THEIR PSYCHEDELIC THERAPIES. THEY PREPARE BY ESTABLISHING ROUTINE ACTS OF WELLNESS AND FOCUS THROUGH MEDITATION, EXERCISE, COMMUNITY BUILDING, ART, AND PSYCHOTHERAPY AS WELL AS GETTING ACCLIMATED TO THE PSYCHEDELIC EXPERIENCE THROUGH MICRO-DOSING.

AFTER THE FIRST TWO WEEKS, THE PARTICIPANTS THEN TRANSITION TO THE SECOND SITE IN MT. HOOD VILLAGE, OREGON KNOWN AS THE NETHER, A PLACE OF SHADOW, CONFRONTATION, BELOWNESS, AND REVELATION. THIS IS WHERE THE PARTICIPANTS DIVE DEEP INTO THEIR MINDS AND INNER BEING TO ADDRESS THEIR TRUE SELVES AND DO THE MUCH NEEDED 'SHADOW WORK' THROUGH THE USE OF COLD-EXPOSURE AND THERMAL THERAPIES AS WELL AS THE POWER OF PSILOCYBIN. THEIR PREPARATION HAS MADE THEM READY TO EMBARK ON THE FULL THERAPEUTIC PSYCHEDELIC EXPERIENCE IN A COMPREHENSIVE WELLNESS FACILITY CARVED INTO THE EARTH OF THE MOUNTAINS. THROUGH THEIR EXPERIENCES HERE THEY COME TO REALIZE A COMPLETELY DIFFERENT REALITY TO THEMSELVES AND THE WORLD AROUND THEM WHICH THEY THEN INTEGRATE INTO THEMSELVES. THERE IS A SENSE OF ENLIGHTENMENT AND PEACE WITHIN THE BEING OF THE PARTICIPANTS. AS THEY SHED THE OLD SKIN OF THEIR PAST SELVES, THEY BEGIN TO LOOK BEYOND INTO A WORLD WITH A WHOLE NEW OUTLOOK, EAGER TO STRETCH THEIR NEWLY DAWNED WINGS OF ENLIGHTENED CONSCIOUSNESS.

A PSYCHEDELIC RENAISSANCE IS UPON US, AND WE MUST ANSWER TO THE CALL IN PROPER FASHION. AS THESE THERAPIES BECOME MORE MAINSTREAM, WE MUST ACCOMMODATE THEM WITH PROPER PLACES OF MENTAL HEALING SO THAT PEOPLE CAN HAVE TRULY TRANSFORMATIVE AND LASTING HEALING EXPERIENCES... SO THAT THEY CAN EXPERIENCE CHRYSOPOEIA.

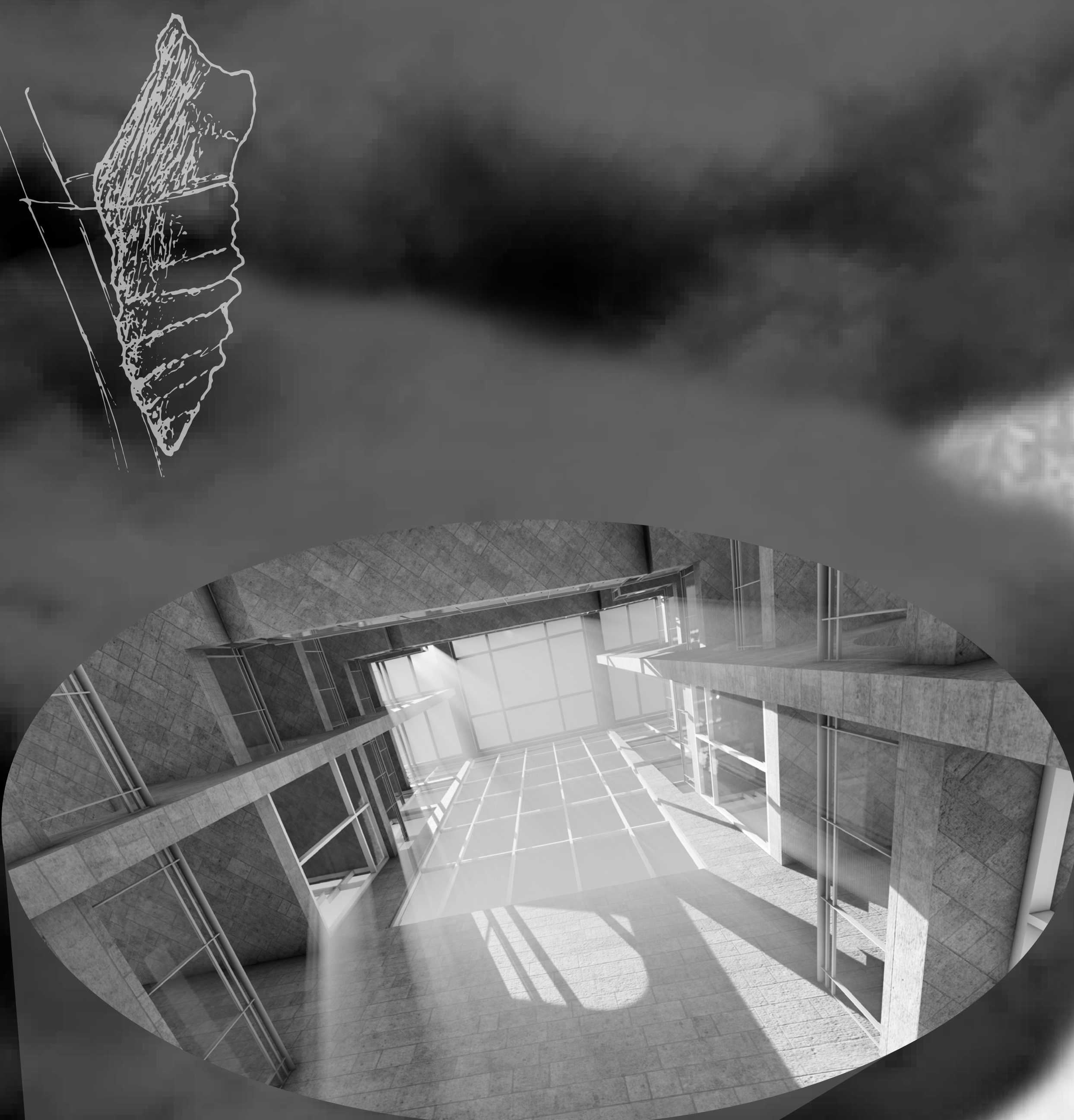

AETHER

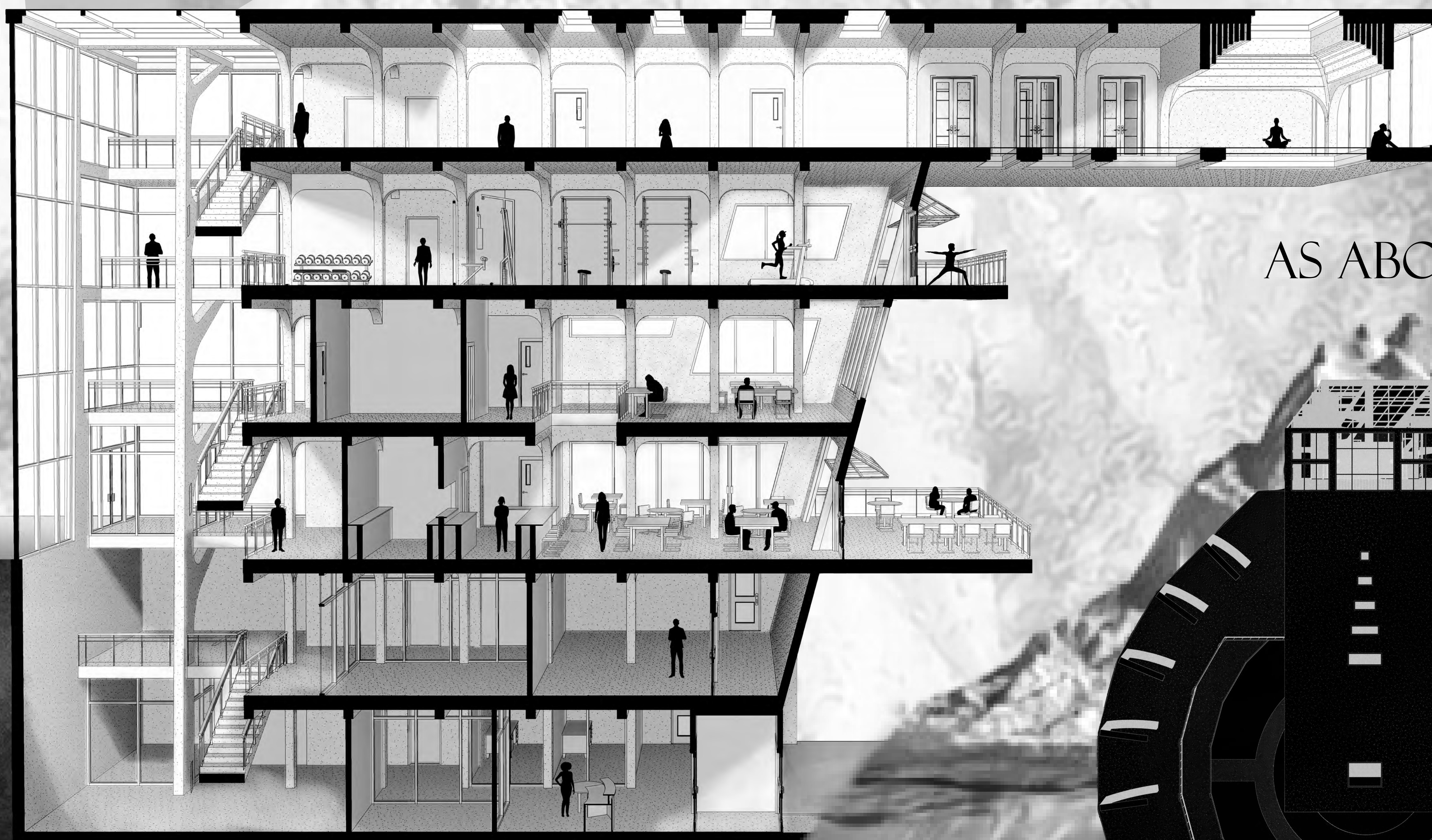

AS ABOVE ...

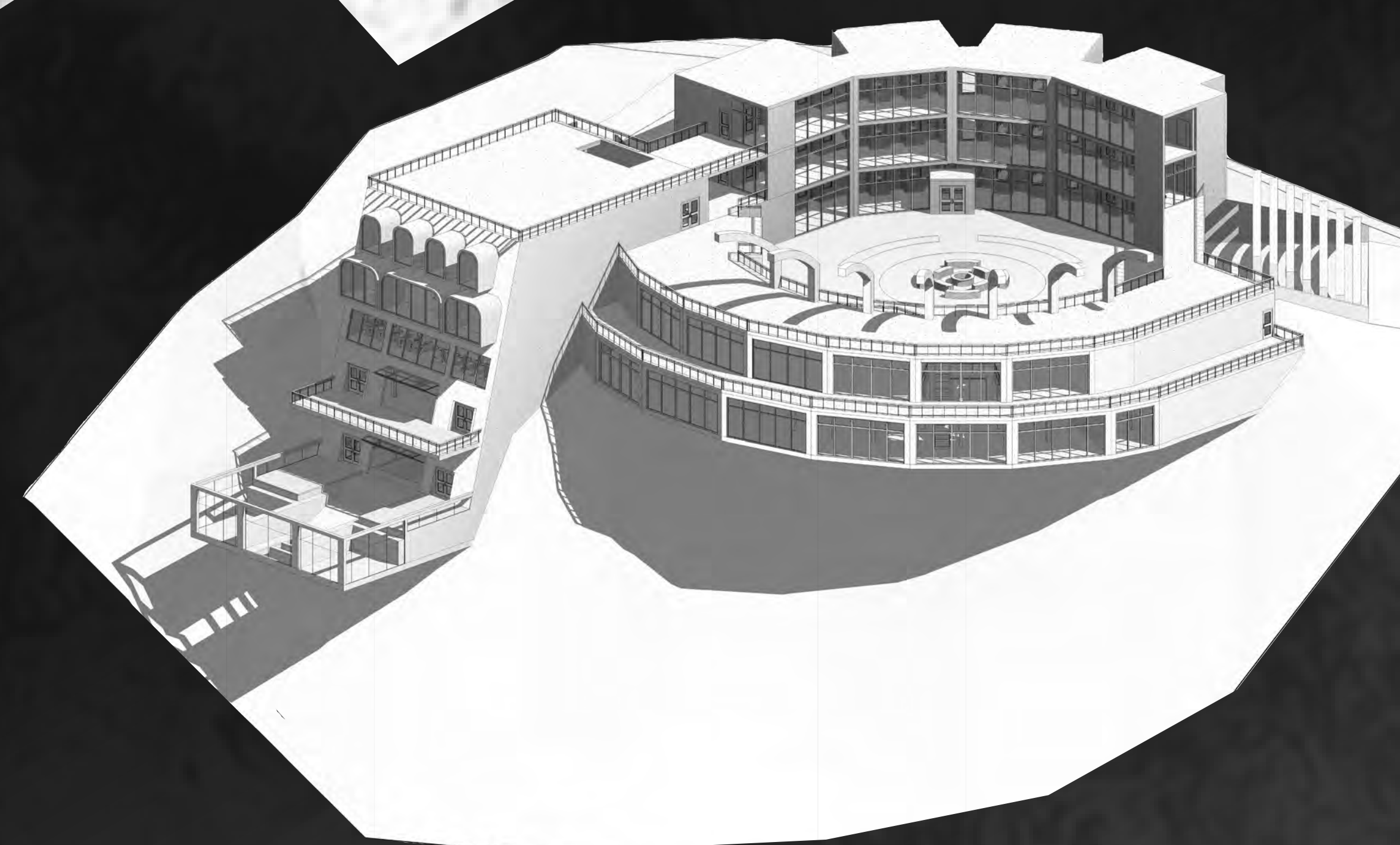
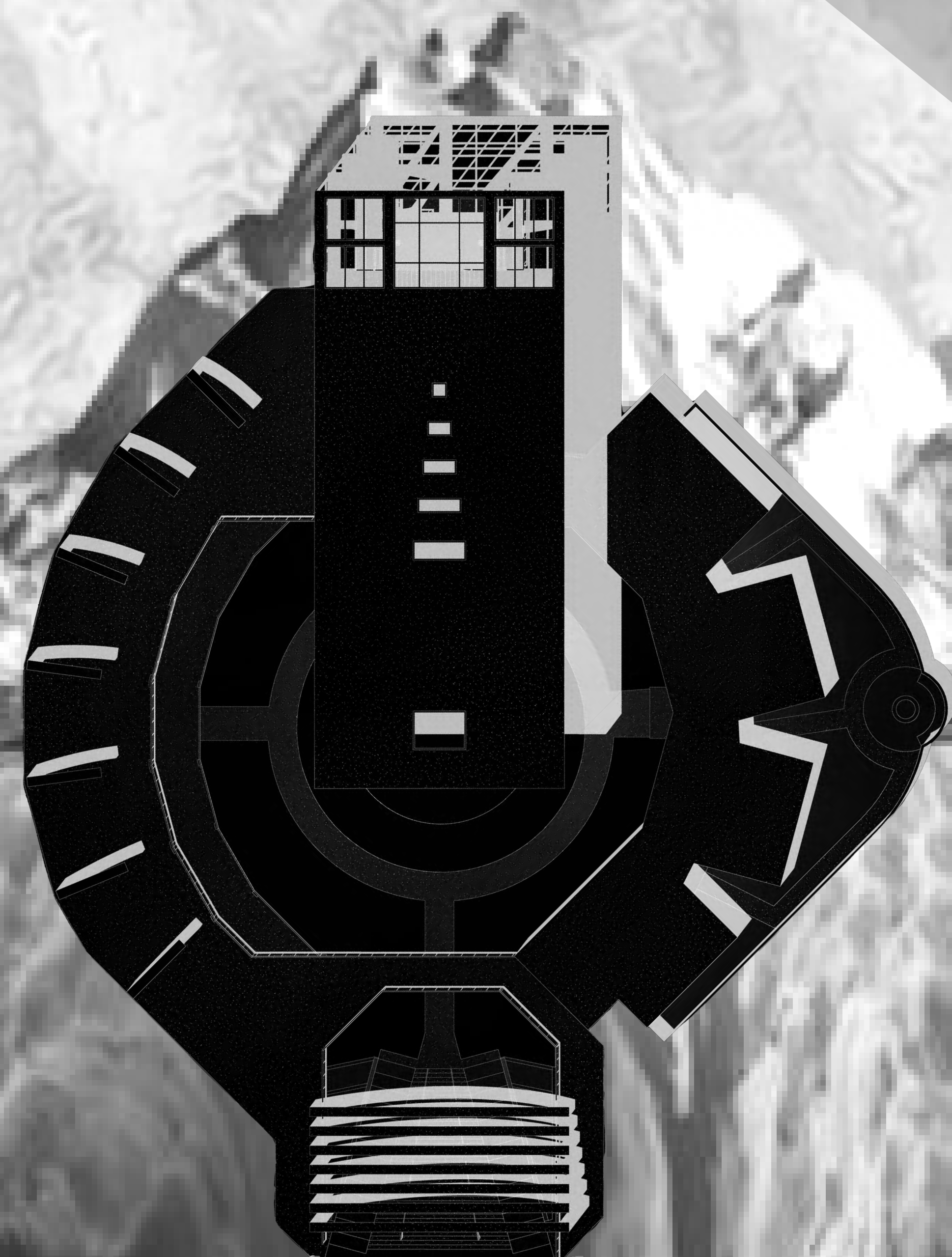
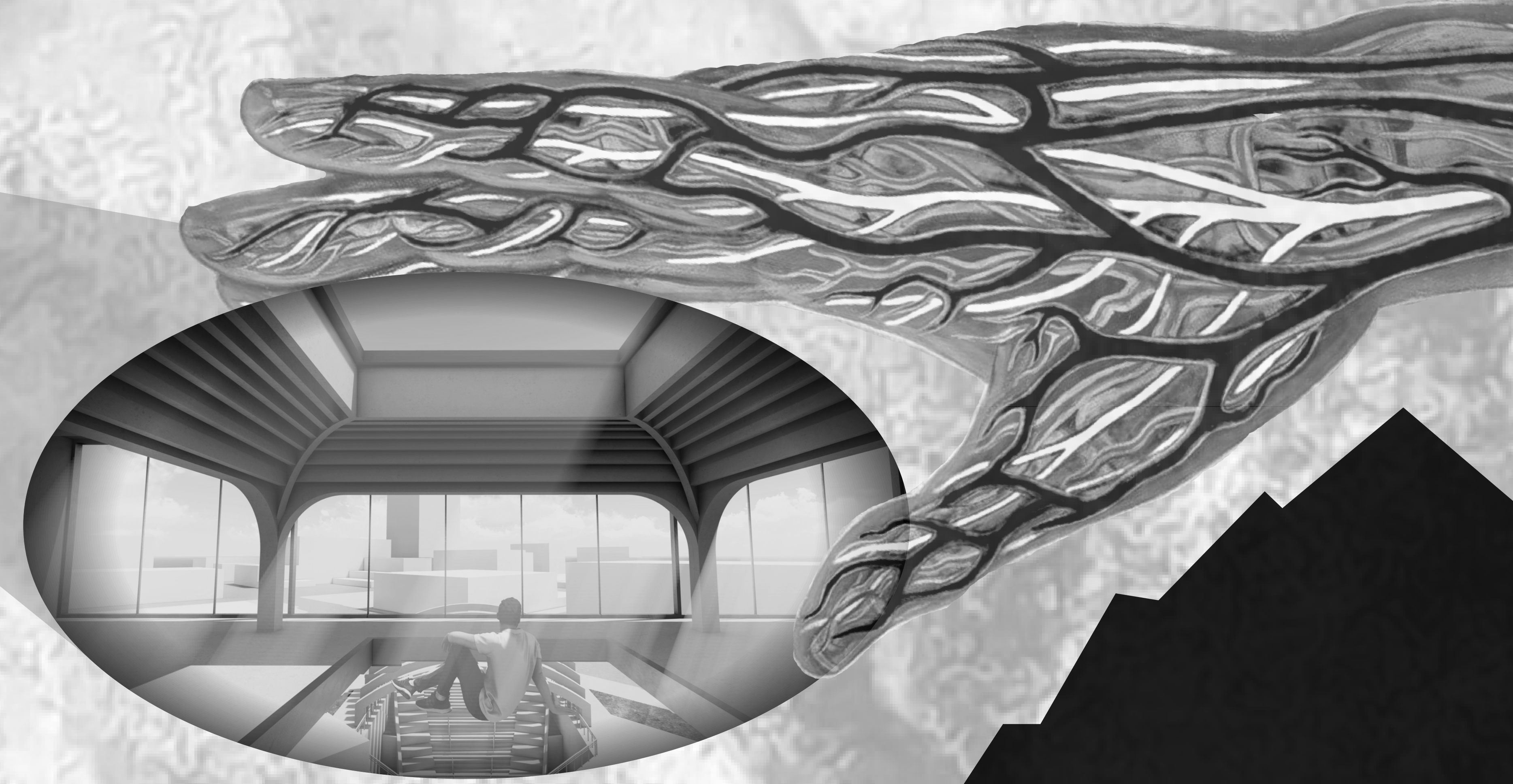

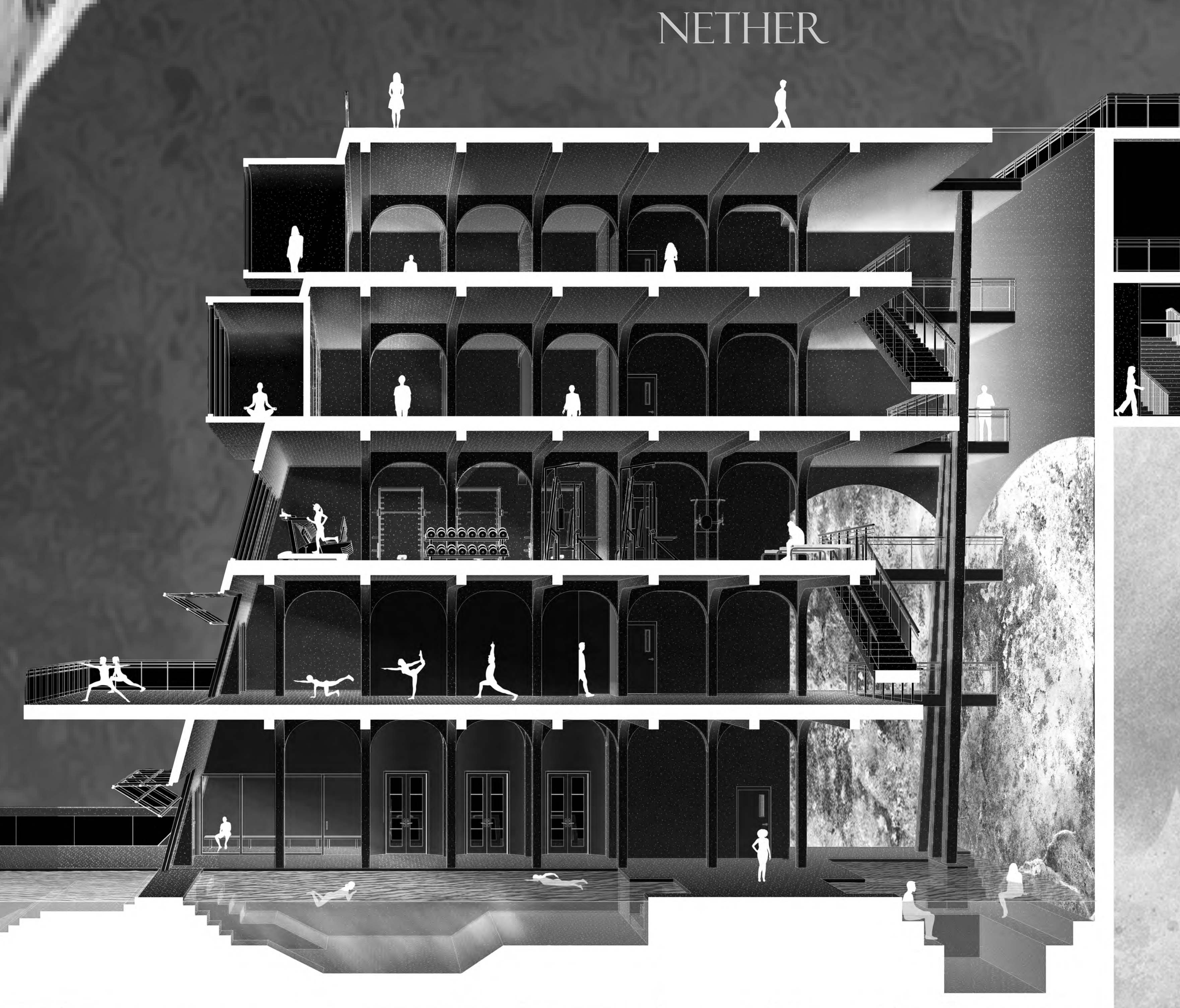
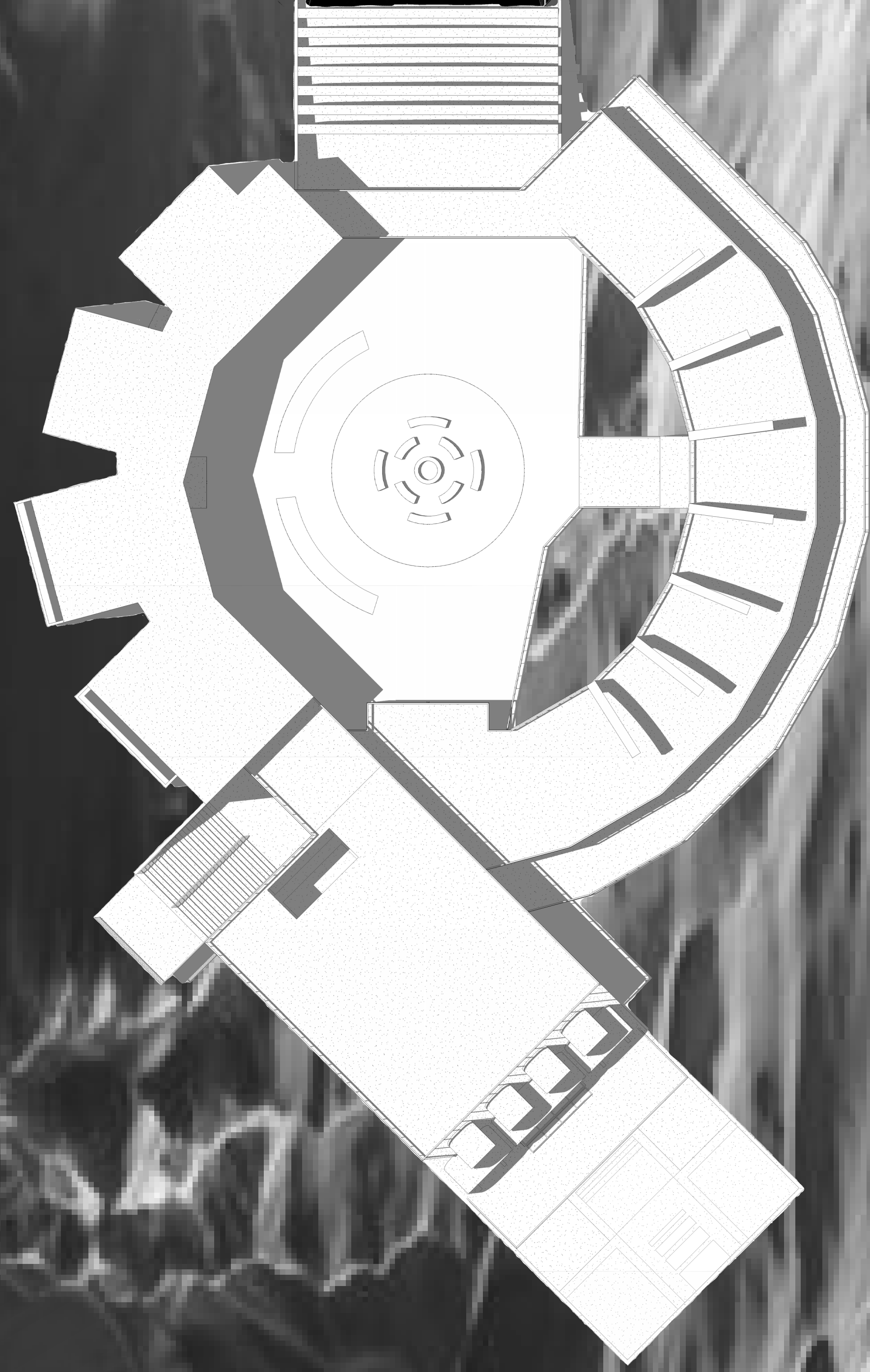

... SO BELOW



ARCHETYPE
[ÄRK-(E)-TIPE]:

A RECURRENT SYMBOL OR MOTIF IN LITERATURE, ART, OR MYTHOLOGY (IN JUNGIAN PSYCHOLOGY) A PRIMITIVE MENTAL IMAGE INHERITED FROM THE EARLIEST HUMAN ANCESTORS, AND SUPPOSED TO BE PRESENT IN THE COLLECTIVE UNCONSCIOUS.

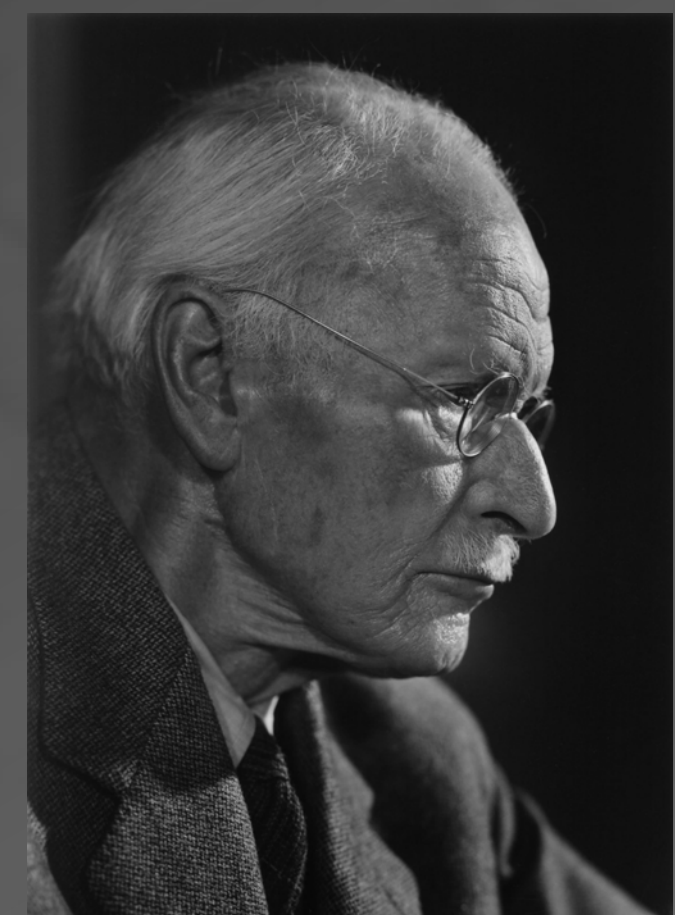

"NO TREE, IT IS SAID, CAN GROW TO HEAVEN UNLESS ITS ROOTS REACH DOWN TO HELL"

-CARL JUNG

ARTIFACT

